

UNITED STATES  
DEPARTMENT OF THE INTERIOR  
GEOLOGICAL SURVEY

## APPLICATION FOR PERMIT TO DRILL, DEEPEN, OR PLUG BACK

## 1a. TYPE OF WORK

DRILL ☒DEEPEN ☐PLUG BACK ☐

## b. TYPE OF WELL

OIL  
WELL ☐GAS  
WELL ☒

OTHER

SINGLE  
ZONE ☒MULTIPLE  
ZONE ☐

## 2. NAME OF OPERATOR

GETTY OIL COMPANY

## 3. ADDRESS OF OPERATOR

P.O. Box 3360  
Casper, Wyoming 82602

## 4. LOCATION OF WELL (Report location clearly and in accordance with any State requirements.\*)

At surface

1715' FSL, 2310' FEL

At proposed prod. zone

Same

## 14. DISTANCE IN MILES AND DIRECTION FROM NEAREST TOWN OR POST OFFICE\*

12 miles Southwest, Bloomfield, New Mexico

## 15. DISTANCE FROM PROPOSED\*

LOCATION TO NEAREST  
PROPERTY OR LEASE LINE, FT.  
(Also to nearest drig. unit line, if any)

925'

## 16. NO. OF ACRES IN LEASE

280

17. NO. OF ACRES ASSIGNED  
TO THIS WELL

S. 320

18. DISTANCE FROM PROPOSED LOCATION\*  
TO NEAREST WELL, DRILLING, COMPLETED,  
OR APPLIED FOR, ON THIS LEASE, FT.

1320'

## 19. PROPOSED DEPTH

6325' Dakota

## 20. ROTARY OR CABLE TOOLS

Rotary

## 21. ELEVATIONS (Show whether DF, RT, GR, etc.)

5875 Gr.

## 22. APPROX. DATE WORK WILL START\*

6-15-1980

## 23.

## PROPOSED CASING AND CEMENTING PROGRAM

SIZE OF HOLE	SIZE OF CASING	WEIGHT PER FOOT	SETTING DEPTH	QUANTITY OF CEMENT
12 $\frac{1}{8}$	8-5/8	24#	350	340 SX CIRCULATE
7-7/8	5-1/2	14#	5650	
7-7/8	5-1/2	15.5#	6325	1100 SX

SEE ATTACHMENTS

New Mexico State approval for a  
pipeline connection at the above  
location is not included in the  
approval of this application for  
Permit to Drill.

gas lubricated

IN ABOVE SPACE DESCRIBE PROPOSED PROGRAM: If proposal is to deepen or plug back, give data on present productive zone and proposed new productive zone. If proposal is to drill or deepen directionally, give pertinent data on subsurface locations and measured and true vertical depths. Give blowout preventer program, if any.

## 24.

SIGNED

*[Signature]*

TITLE

Area Supt.

DATE

5-8-1980

(This space for Federal or State office use)

PERMIT NO.

APPROVAL DATE

APPROVED BY

TITLE

CONDITIONS OF APPROVAL, IF ANY:

*ch 3 and*

W-11C-104 for NSL

DRILLING OPERATIONS AUTHORIZED ARE  
SUBJECT TO COMPLIANCE WITH ATTACHED  
"GENERAL REQUIREMENTS"

APPROVED AS AMENDED
JUN 19 1980
JAMES F. SIMS
DISTRICT ENGINEER

All distances must be from the outer boundaries of the Section.

Operator <b>GETTY OIL COMPANY</b>			Lease <b>FEDERAL 3S COM</b>		Well No. <b>1E</b>
Unit Letter <b>J</b>	Section <b>3</b>	Township <b>27N</b>	Range <b>12W</b>	County <b>San Juan</b>	
Actual Footage Location of Well:					
<b>1715</b>		feet from the <b>South</b>	line and <b>2310</b>	feet from the <b>East</b>	line
Ground Level Elev. <b>5875</b>	Producing Formation <b>Dakota</b>		Pool <b>Basin Dakota</b>		Dedicated Acreage: <b>320</b> Acres

1. Outline the acreage dedicated to the subject well by colored pencil or hachure marks on the plat below.
2. If more than one lease is dedicated to the well, outline each and identify the ownership thereof (both as to working interest and royalty).
3. If more than one lease of different ownership is dedicated to the well, have the interests of all owners been consolidated by communitization, unitization, force-pooling, etc?

☐ Yes ☐ No If answer is "yes," type of consolidation \_\_\_\_\_

If answer is "no," list the owners and tract descriptions which have actually been consolidated. (Use reverse side of this form if necessary.) \_\_\_\_\_

No allowable will be assigned to the well until all interests have been consolidated (by communitization, unitization, forced-pooling, or otherwise) or until a non-standard unit, eliminating such interests, has been approved by the Commission.

	<p align="center"><b>CERTIFICATION</b></p> <p>I hereby certify that the information contained herein is true and complete to the best of my knowledge and belief.</p> <p><i>Claude C. Kennedy</i></p> <p>Name <b>Claude C. Kennedy</b></p> <p>Position <b>Agent</b></p> <p>Company <b>Getty Oil Company</b></p> <p>Date <b>5-8-1980</b></p>
	<p>I hereby certify that the well location shown on this plat was plotted from field notes of actual surveys made by me or under my supervision, and that the same is true and correct to the best of my knowledge and belief.</p> <p>Date Surveyed <b>May 1, 1980</b></p> <p>Registered Professional Engineer and/or Land Surveyor</p> <p><i>Fred B. Kern Jr.</i></p> <p><b>Fred B. Kern Jr.</b></p> <p>Certificate No. <b>3950</b></p> <p><b>KERN, JR.</b></p>

## FORMATION INFORMATION AND DRILLING PRACTICES

Getty Oil Company  
#1E Federal 3-S Com.  
1715'FSL, 2310'FEL  
Sec. 3, T27N, R12W  
San Juan County, New Mexico

1. SURFACE FORMATION: See attached schedule.
2. ESTIMATED GEOLOGIC MARKERS: See attached schedule.
3. WATER, OIL AND GAS ZONES: See attached schedule.
4. PROPOSED CASING PROGRAM: (ALL NEW) See attached schedule.
5. PRESSURE CONTROL EQUIPMENT  
Schematic attached,  
Type: 9 or 10" - 900 Series - Double Gate  
Pressure Rating: 3000 psi  
Testing Procedure: Equipment will be pressure tested to 1500 psi prior to drilling out from under surface and operational checks will be made daily and recorded on tour sheet.
6. MUD PROGRAM (Visual Monitoring) See attached schedule.
7. AUXILIARY EQUIPMENT
  1. A Kelly cock will be kept in the string at all times.
  2. Periodic checks will be made each tour of the mud system.
  3. A stabbing valve will be kept on the derrick floor to be stabbed into the drill pipe whenever the Kelly is not in the string.
  4. No bit float will be used.

8. EVALUATION PROGRAM

Logs: Induction Electric and Neutron Formation Density

Cores: None

DST's: None

9. ABNORMAL CONDITIONS:

It is not anticipated that abnormal temperatures, pressures or toxic gases will be encountered.

10. DRILLING ACTIVITY:

Anticipated commencement date: 6-15-1980

Required drilling days: 16 days.

Required completion days: 12 days.

Federal 3S Com #1E

Surface Formation: Unnamed sand and shale

Fm. Tops.	Pictured Cliffs	1515'
	Lewis	1687'
	Mesaverde	2405'
	Mancos	4270'
	Gallup	5120'
	Greenhorn	5935'
	Dakota	6025'
	Proposed TD	6325'

Est. Depths of Anticipated Water, Oil, Gas, or Minerals

1515'-1590'	Gas
6025'-6325'	Gas

Casing Program

Hole Size	Interval	Section Length	Size	Weight, Grade & Joint	New or Used	Mud Wt	SF <sub>ten</sub>	SF <sub>cor</sub>	SF <sub>brst</sub>
12 1/4"	0'-350'	350'	8 5/8"	24.0#, K-55 8rd-ST&C	New	8.8	31.3	8.55	14.75
7 7/8"	0'-5650'	5650'	5 1/2"	14.0#, K-55 8rd-ST&C	New	8.9	2.08	1.125	1.42
7 7/8"	5650'-6325'	675'	5 1/2"	15.5#, K-55 8rd-ST&C	New	8.9	19.89	1.315	1.60

Cement Program

Surface: 290 cu.ft. (340 sks) of Class B containing 2% CaCl and 1/4 #/sk Flocele

Production: 1st Stage: Lead w/ 390 cu.ft. (230 sks) of "Lite" containing 6% gel & 1/4 #/sk Flocele.  
Tail in w/ 135 cu.ft. (105 sks) of Class B containing 1.0% Fluid loss agent & 1/4 #/sk Flocele

2nd Stage: 804 cu.ft. (470 sks) of "Lite" containing 6% gel & 1/4 #/sk Flocele

3rd Stage: 500 cu.ft. (295 sks) of "Lite" containing 2% CaCl & 1/4 #/sk Flocele

Mud Program

Interval	Mud Type	Mud Wt (ppg)	Viscosity	W.L.	pH	Additives
0'-350'	Gel/Lime	8.4-8.8	50-70	NC	-	Gel, Lime
350'-1500'	Gel/Lime	8.4-8.8	30-32	NC	-	Gel, Lime
1500'-6000'	LSND	8.4-8.8	30-32	10-15	-	Gel, Starch, CMC
6000'-6325'	LSND	8.4-8.9	34-38	10	-	Gel, Starch, CMC

BLOWOUT PREVENTER DIAGRAM  
3000# W.P.

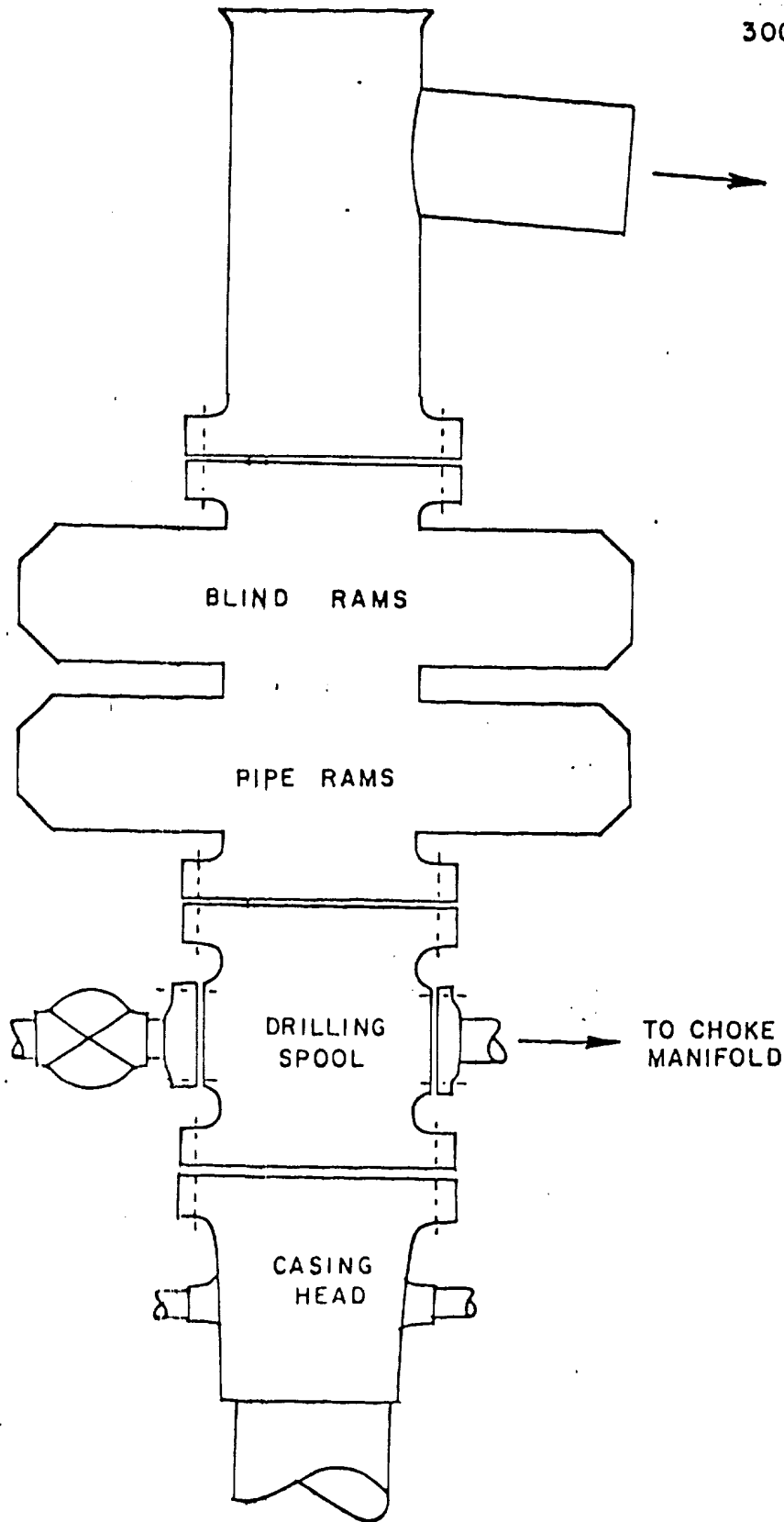

13 POINT SURFACE USE PLAN

Getty Oil Company  
#1E Federal 3-S Com.  
1715' FSL, 2310' FEL  
Sec. 3, T27N, R12W  
San Juan County, New Mexico

1. EXISTING ROADS: (Shown in Green)

The attached topographic map shows all existing roads within (3) miles of the proposed location. All roads are in fair condition and will require a minimal amount of work to upgrade them to handle normal drilling activity traffic.

2. PLANNED ACCESS ROAD (Shown in Red)

Width: 20' flat bladed.

Maximum Grades: 2% or less, road is flat.

New road required: NONE

No cut, fill, turnouts, culverts or gates will be required.

Water bars will be consistent with existing drainage pattern.

3. LOCATION OF EXISTING WELLS:

Map attached.

4. LOCATION OF EXISTING OR PROPOSED PRODUCTION FACILITIES:

A. All production facilities are to be contained within the proposed location.

B. Production facilities are present on wells as per 3. above.

5. LOCATION AND TYPE OF WATER SUPPLY:

Hilltop water well.

6. SOURCE OF CONSTRUCTION MATERIAL:

Any construction material required for road or location will be excess materials accumulated during building of such sites.

7. METHOD FOR HANDLING WASTE DISPOSAL:

1. The cuttings will be retained in the reserve pit.

2. Drilling fluids will be contained in a reserve pit or mud tanks until well is completed.

3. Oil will be collected in tanks. Little or no water is anticipated at this location. If volume of oil is sufficient, it will be trucked from location.

4. A portable toilet will be provided.

5. A fenced pit will be provided for trash. The trash pit will be enclosed with small mesh wire. The reserve pit will be fenced.

6. Location and mud pits will be leveled and seeded as soon as feasible after well is completed. The area will be cleaned of all trash and materials.

13 POINT SURFACE USE PLAN - continued

Page - 2

8. ANCILLARY FACILITIES:

No camps or airstrips will be constructed.

9. WELL SITE LAYOUT:

The attached layout shows the drilling rig with all supporting facilities. Cut and fill, required for pad construction, is also shown.

10. SURFACE RESTORATION PLANS:

Restoration of the well site and access road will begin within 90 days of well completion, weather permitting.

Should the well be abandoned, the drilling site will be reshaped to its approximate former contour. The access road will be plowed and leveled. Both road and location will have top soil replaced and will be reseeded when germination can occur.

Should the well be commercial, that portion of location not needed for operation will be repaired as above. The portion of the location needed for daily production operations, and the access road, will be kept in good repair and clean.

In either case, cleanup of the site will include burning any safely burnable material, filling of all pits, and proper disposal of any nonburnable material that can not be safely buried. Any oil that has accumulated on the pits will be trucked away.

11. OTHER INFORMATION:

A. General topography of the area may be seen on the attached map.

B. There were no archaeological or cultural sites visible on the location. The archaeologist's report is forthcoming.

C. Animal life: Small wild life

D. Dwellings: None

E. Drainage: Sprinkler irrigated field

F. Surface Owner: BLM

G. General location: 8 miles Southwest, Bloomfield, New Mex.

12. OPERATOR REPRESENTATIVES:

Paul Berhost  
Farmington, New Mex.  
Phone: (505) 325-9682  
327-3622

H. E. Aab  
Area Supt.  
P.O. Box 3360  
Casper, Wyoming 82602  
Phone: (307) 265-8386



13 POINT SURFACE USE PLAN - continued

Page - 3

13. CERTIFICATION:

I hereby certify that I or persons under my direct supervision, have inspected the proposed drill site and access route; that I am familiar with the conditions which presently exist; that the statements made in the plan are to the best of my knowledge; true and correct; and, that the work associated with the operations proposed herein will be performed by operator, and his contractors and sub-contractors in conformity with this plan and the terms and conditions under which it is approved.

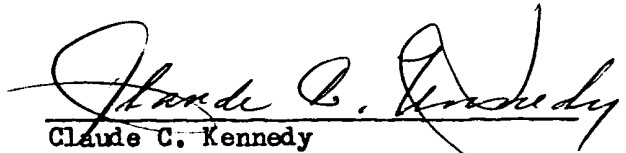
  
Claude C. Kennedy

Date: 5-8-1980

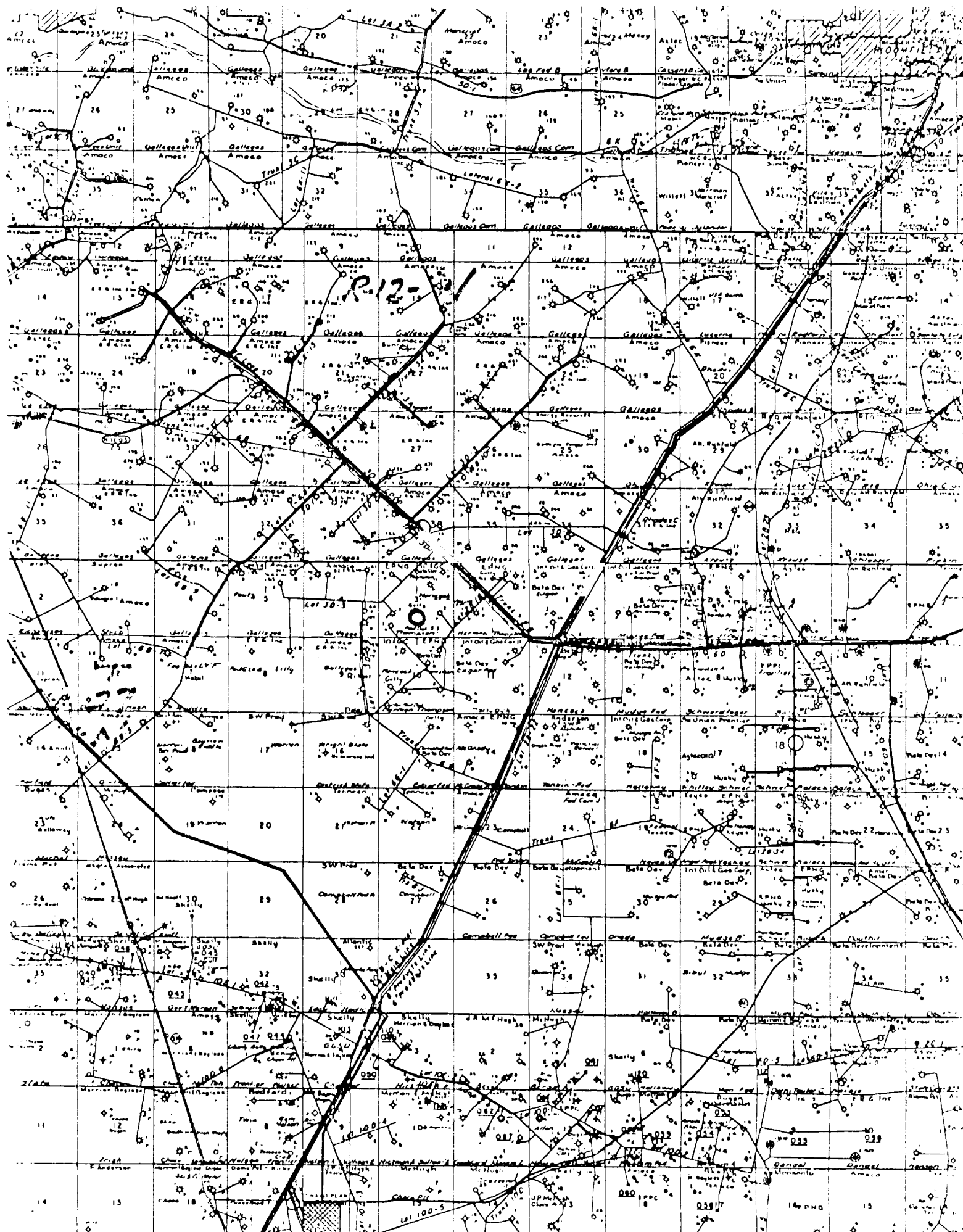

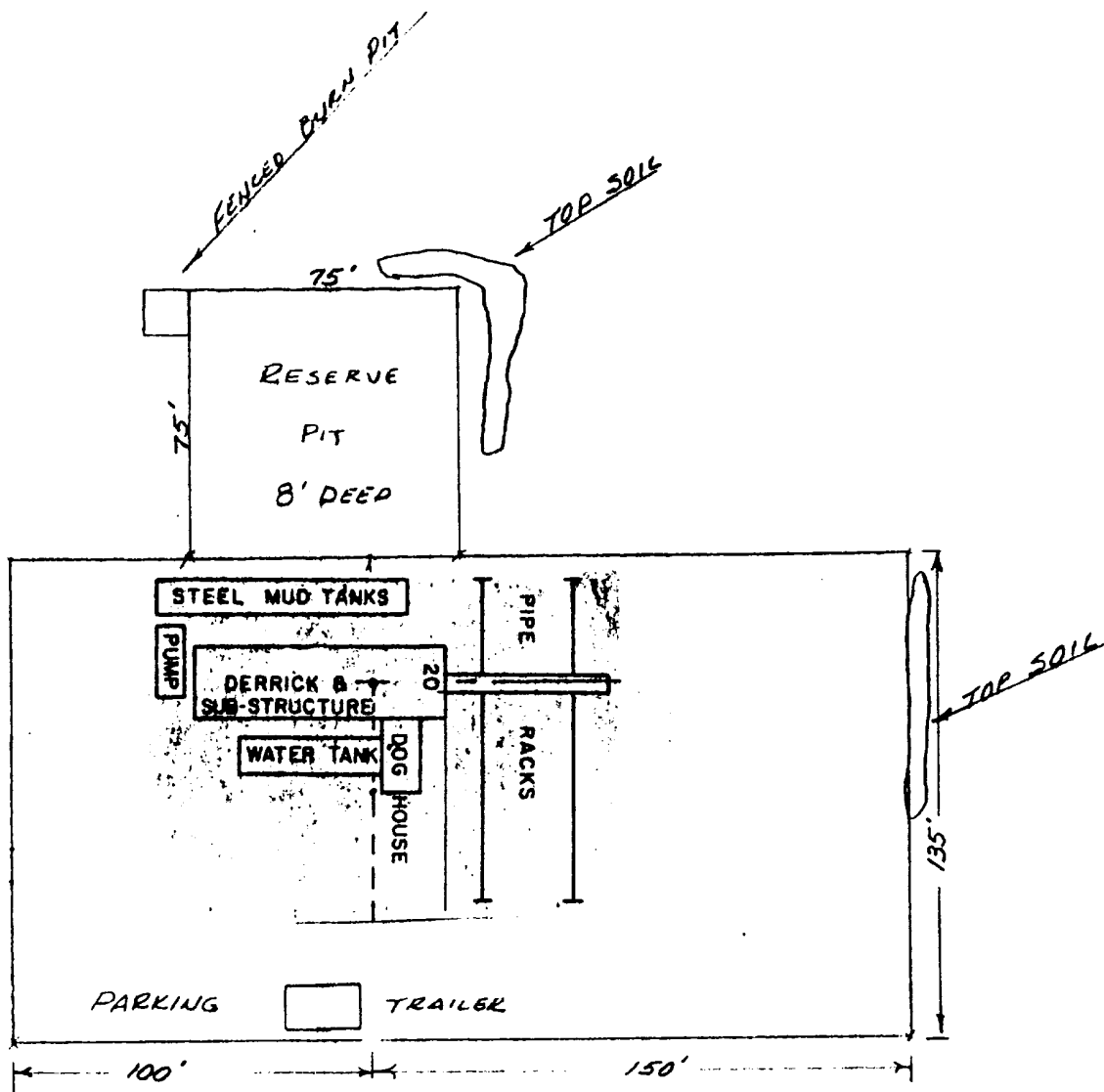

RIG LAYOUT

SCALE 1" = 50'

Vicinity Map for  
GETTY OIL COMPANY #1E FEDERAL 3S COM  
1715'FSL 2310'FEL Sec. 3-T27N-R12W  
SAN JUAN COUNTY, NEW MEXICO

5  
 6  
 7  
 8  
 9  
 10  
 11  
 12  
 13  
 14  
 15  
 16  
 17  
 18  
 19  
 20  
 21  
 22  
 23  
 24  
 25  
 26  
 27  
 28  
 29  
 30  
 31  
 32  
 33  
 34  
 35  
 36  
 37  
 38  
 39  
 40  
 41  
 42  
 43  
 44  
 45  
 46  
 47  
 48  
 49  
 50  
 51  
 52  
 53  
 54  
 55  
 56  
 57  
 58  
 59  
 60  
 61  
 62  
 63  
 64  
 65  
 66  
 67  
 68  
 69  
 70  
 71  
 72  
 73  
 74  
 75  
 76  
 77  
 78  
 79  
 80  
 81  
 82  
 83  
 84  
 85  
 86  
 87  
 88  
 89  
 90  
 91  
 92  
 93  
 94  
 95  
 96  
 97  
 98  
 99  
 100  
 101  
 102  
 103  
 104  
 105  
 106  
 107  
 108  
 109  
 110  
 111  
 112  
 113  
 114  
 115  
 116  
 117  
 118  
 119  
 120  
 121  
 122  
 123  
 124  
 125  
 126  
 127  
 128  
 129  
 130  
 131  
 132  
 133  
 134  
 135  
 136  
 137  
 138  
 139  
 140  
 141  
 142  
 143  
 144  
 145  
 146  
 147  
 148  
 149  
 150  
 151  
 152  
 153  
 154  
 155  
 156  
 157  
 158  
 159  
 160  
 161  
 162  
 163  
 164  
 165  
 166  
 167  
 168  
 169  
 170  
 171  
 172  
 173  
 174  
 175  
 176  
 177  
 178  
 179  
 180  
 181  
 182  
 183  
 184  
 185  
 186  
 187  
 188  
 189  
 190  
 191  
 192  
 193  
 194  
 195  
 196  
 197  
 198  
 199  
 200  
 201  
 202  
 203  
 204  
 205  
 206  
 207  
 208  
 209  
 210  
 211  
 212  
 213  
 214  
 215  
 216  
 217  
 218  
 219  
 220  
 221  
 222  
 223  
 224  
 225  
 226  
 227  
 228  
 229  
 230  
 231  
 232  
 233  
 234  
 235  
 236  
 237  
 238  
 239  
 240  
 241  
 242  
 243  
 244  
 245  
 246  
 247  
 248  
 249  
 250  
 251  
 252  
 253  
 254  
 255  
 256  
 257  
 258  
 259  
 260  
 261  
 262  
 263  
 264  
 265  
 266  
 267  
 268  
 269  
 270  
 271  
 272  
 273  
 274  
 275  
 276  
 277  
 278  
 279  
 280  
 281  
 282  
 283  
 284  
 285  
 286  
 287  
 288  
 289  
 290  
 291  
 292  
 293  
 294  
 295  
 296  
 297  
 298  
 299  
 300  
 301  
 302  
 303  
 304  
 305  
 306  
 307  
 308  
 309  
 310  
 311  
 312  
 313  
 314  
 315  
 316  
 317  
 318  
 319  
 320  
 321  
 322  
 323  
 324  
 325  
 326  
 327  
 328  
 329  
 330  
 331  
 332  
 333  
 334  
 335  
 336  
 337  
 338  
 339  
 340  
 341  
 342  
 343  
 344  
 345  
 346  
 347  
 348  
 349  
 350  
 351  
 352  
 353  
 354  
 355  
 356  
 357  
 358  
 359  
 360  
 361  
 362  
 363  
 364  
 365  
 366  
 367  
 368  
 369  
 370  
 371  
 372  
 373  
 374  
 375  
 376  
 377  
 378  
 379  
 380  
 381  
 382  
 383  
 384  
 385  
 386  
 387  
 388  
 389  
 390  
 391  
 392  
 393  
 394  
 395  
 396  
 397  
 398  
 399  
 400  
 401  
 402  
 403  
 404  
 405  
 406  
 407  
 408  
 409  
 410  
 411  
 412  
 413  
 414  
 415  
 416  
 417  
 418  
 419  
 420  
 421  
 422  
 423  
 424  
 425  
 426  
 427  
 428  
 429  
 430  
 431  
 432  
 433  
 434  
 435  
 436  
 437  
 438  
 439  
 440  
 441  
 442  
 443  
 444  
 445  
 446  
 447  
 448  
 449  
 450  
 451  
 452  
 453  
 454  
 455  
 456  
 457  
 458  
 459  
 460  
 461  
 462  
 463  
 464  
 465  
 466  
 467  
 468  
 469  
 470  
 471  
 472  
 473  
 474  
 475  
 476  
 477  
 478  
 479  
 480  
 481  
 482  
 483  
 484  
 485  
 486  
 487  
 488  
 489  
 490  
 491  
 492  
 493  
 494  
 495  
 496  
 497  
 498  
 499  
 500  
 501  
 502  
 503  
 504  
 505  
 506  
 507  
 508  
 509  
 510  
 511  
 512  
 513  
 514  
 515  
 516  
 517  
 518  
 519  
 520  
 521  
 522  
 523  
 524  
 525  
 526  
 527  
 528



B-E'

[illegible]

5820	
5810	
5800	