

(JUNE 1993)

UNITED STATES  
DEPARTMENT OF THE INTERIOR  
BUREAU OF LAND MANAGEMENT

FORM APPROVED

Budget: Bureau No. 1004-0135

Expire: March 31, 1993

SUNDRY NOTICES AND REPORTS ON WELLS

Do not use this form for proposals to drill or to deepen or reentry to a different reservoir.  
Use "APPLICATION FOR PERMIT--" for such proposals

SUBMIT IN TRIPLICATE

1. Type of Well

☐ Oil Well

☐ Gas Well

☒ Other

Gas Gathering Line

2. Name of Operator

Texaco E&P Inc.

3. Address and Telephone No.

3300 N. Butler, Farmington, New Mexico 87401 (505)325-4397

4. Location of Well (Footage, Sec., T., R., M., or Survey Description)

Sec. 13 T27N, R09W

5. Lease Designation and Serial No.

1-148-IND-2464 8466

6. If Indian, Allottee or Tribe Name

Navajo Tribe

7. If Unit or CA, Agreement Designation

John Charles Lease

8. Well Name and No.

9. API Well No.

10. Field and Pool, or Exploratory Area

11. County or Parish, State

San Juan County, New Mexico

12. CHECK APPROPRIATE BOX(S) TO INDICATE NATURE OF NOTICE, REPORT, OR OTHER DATA

TYPE OF SUBMISSION

☒

Notice of Intent

☐

Subsequent Report

☐

Final Abandonment Notice

TYPE OF ACTION

☐

Abandonment

☐

Recompletion

☐

Plugging Back

☐

Casing Repair

☐

Altering Casing

☐

Other

☐

Change of Plans

☒

New Construction

☐

Non-Routine Fracturing

☐

Water Shut-Off

☐

Conversion to Injection

☐

Dispose Water

(Note: Report results of multiple completion on well  
Completion or Recompletion Report and Log form)

13. Describe Proposed or Completed Operations (Clearly state all pertinent details, and give pertinent dates, including estimated date of starting and proposed work. If well is directionally drilled, give subsurface locations and measured and true vertical depths for all markers and zones pertinent to this work.)\*

Texaco E&P Inc. requests approval to lay a gas gathering line on the subject lease. This line will stay within the bounds of the lease and will service only wells on this lease. All construction will be contained within the NW 1/4 of Section 13, T27N-R09W.

This 1470' line will consist of two segments. The first segment will be 870' in length from John Charles #7A to John Charles #7E and will be buried partially within the road ROW. The second segment will be 600' in length and will go overland from John Charles #7E to John Charles #2.

Provisions and Materials:

- '1470' of 2" & 2 1/2" wrapped, schedule 40, steel line pipe. Connections will be welded.
- Pipeline road crossing will be marked and buried to 36"
- Line will be pressure tested to 1000 psi... (Anticipated working pressure will be 70 psi)
- Maximum width of disturbance will be 30'

Archaeological clearance has been received. Please refer to Archaeological Report from Moore Anthropological Research - Technical Report No. 95-002.

RECEIVED  
SEP - 8 1995

OIL CON. DIV.  
DIST. 2

14. I hereby certify that the foregoing is true and correct

Signed

*[Signature]*

Title Operations Manager

APPROVED  
SEP 5 1995

(This space for Federal or State office use)

Approved by

Title

Date

SEP 5 1995

Conditions of approval, if any:

DISTRICT MANAGER

(Under 18 U.S.C. Section 1001, it is a crime for any person knowingly and willfully to make to any department or agency of the United States any false, fictitious or fraudulent statements or representations as to any matter within its jurisdiction.)

Copies: BLM /5 BIA /2

LNS

NMOCD

Flowline Installation (John Charles Lease)

To consolidate compression, Texaco proposes to install two (2) flowlines on the John Charles lease.

Lease locations involved:

LEASE	NUMBER	AP. NO.	TYPE	Q1	Q2	SP	SEC	T1/2	RANGE	LEGAL	TD	LEASE NO.	STATE	COUNTY
JOHN CHARLES	7A	3004522673	GAS	NE	NW	C	13	T27N	R09W	890' FNL/1550' FWL	4460	1-149-IND-8466	NM	SAN JUAN
JOHN CHARLES	7E	3004524812	GAS	NW	NW	D	13	T27N	R09W	980' FNL/820' FWL	6639	1-149-IND-8466	NM	SAN JUAN
JOHN CHARLES	2	3004506480	GAS	SW	NW	E	13	T27N	R09W	1650' FNL/990' FWL	2181	1-149-IND-8466	NM	SAN JUAN

Proposed flowline installations:

<u>From Location</u>	<u>To Location</u>	<u>Distance of Line<sup>1</sup></u>	<u>Total Disturbance</u> <u>(Acre)</u>	<u>Comments</u>
John Charles #7A	John Charles #7E	870'	0.3	Previously disturbed area; Road ROW
John Charles #2	John Charles #7E	600'	0.21	Overland; New disturbance
		<b>Total Acreage</b>	<b>0.51</b>	

<sup>1</sup> Distance is calculated from point to point. Distance on location has not been subtracted.

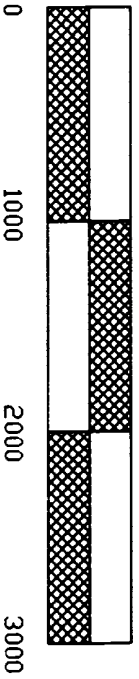
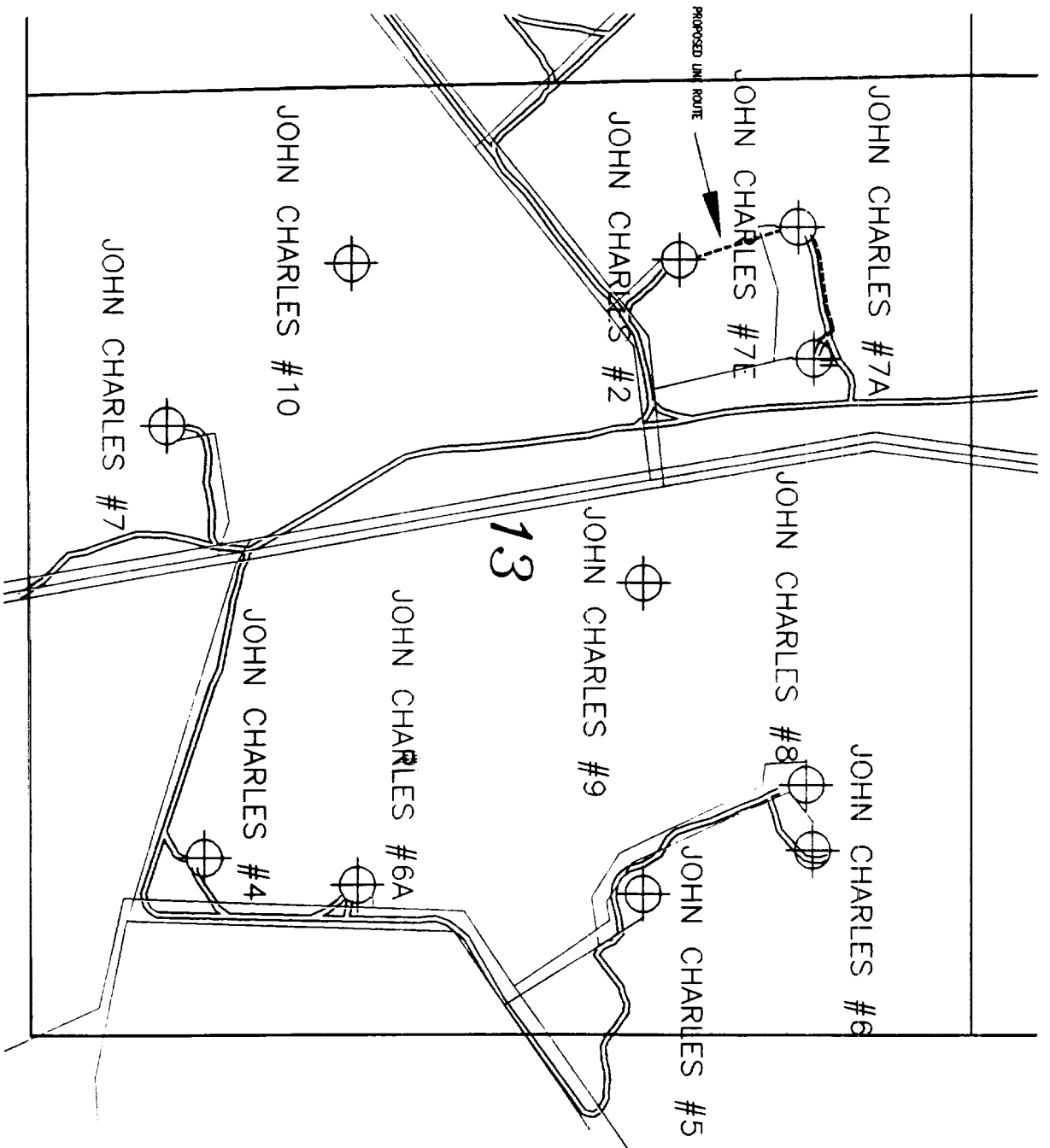

**TEXACO** FARMINGTON OPERATING UNIT  
DENVER BRANCH  
DENVER, COLORADO

ACT: JOHN CHARLES LEASE  
SEC. 13, T. 22 N., R. 7 E., S. 4 W.  
DESCRIPTION: WELL LOCATIONS

DATE: 2/20/80  
BY: [Signature]  
CHECKED: [Signature]  
APPROVED: [Signature]