

UNITED STATES  
DEPARTMENT OF THE INTERIOR  
GEOLOGICAL SURVEY

## APPLICATION FOR PERMIT TO DRILL, DEEPEN, OR PLUG BACK

1a. TYPE OF WORK DRILL <input checked="" type="checkbox"/> DEEPEN <input type="checkbox"/> PLUG BACK <input type="checkbox"/>		5. LEASE DESIGNATION AND SERIAL NO. SF-078499A	
b. TYPE OF WELL OIL WELL <input type="checkbox"/> GAS WELL <input checked="" type="checkbox"/> OTHER <input type="checkbox"/>		6. IF INDIAN, ALLOTTEE OR TRIBE NAME	
2. NAME OF OPERATOR LIVELY EXPLORATION COMPANY		7. UNIT AGREEMENT NAME	
3. ADDRESS OF OPERATOR c/o Walsh Engr. & Prod. Corp. P. O. Box 254 Farmington, N.M. 87401		8. FARM OR LEASE NAME Lively	
4. LOCATION OF WELL (Report location clearly and in accordance with any State requirements.) At surface 1060'FNL, 1780'FEL At proposed prod. zone Same		9. WELL NO. 11-E	
14. DISTANCE IN MILES AND DIRECTION FROM NEAREST TOWN OR POST OFFICE* 11 miles southeast of Blanco, New Mexico		10. FIELD AND POOL, OR WILDCAT Basin Dakota	
15. DISTANCE FROM PROPOSED* LOCATION TO NEAREST PROPERTY OR LEASE LINE, FT. (Also to nearest drlg. unit line, if any) 1060'		11. SEC. T., R., M., OR BLK. AND SURVEY OR AREA Sec. 16-T28N-R8W B N.M.P.M.	
18. DISTANCE FROM PROPOSED LOCATION* TO NEAREST WELL, DRILLING, COMPLETED, OR APPLIED FOR, ON THIS LEASE, FT. 300'		12. COUNTY OR PARISH 13. STATE San Juan N. M.	
16. NO. OF ACRES IN LEASE 857.8		17. NO. OF ACRES ASSIGNED TO THIS WELL E 320	
19. PROPOSED DEPTH 7350		20. ROTARY OR CABLE TOOLS Rotary	
21. ELEVATIONS (Show whether DF, RT, GR, etc.) 6423'GL, 6436'DF, 6437'KB		22. APPROX. DATE WORK WILL START* 8/10/81	

23. PROPOSED CASING AND CEMENTING PROGRAM				
SIZE OF HOLE	SIZE OF CASING	WEIGHT PER FOOT	SETTING DEPTH	QUANTITY OF CEMENT
12-1/4"	9-5/8"	36.0	275'	250 sacks to surface
8-3/4"	7"	23.0	3400'	500 sacks (Cover Ojo Alamo)
6-1/4"	4-1/2"	10.50&11.60	7350'	400 sacks

All producing intervals in Dakota Formation will be perforated and stimulated as necessary.

## EXHIBITS

"A" Location and Elevation Plat	"E" Access Road to Location
"B" Ten Point Compliance Program	"F" Radius Map of Field
"C" Blowout Preventer Diagram	"G" Drill Rig Layout
"D" Multi-Point Requirements for APD	"H" Fracturing Program Layout
	"I" Location Profile

The gas from this well is committed.  
The E/2, Section 16 is dedicated to this well.

IN ABOVE SPACE DESCRIBE PROPOSED PROGRAM: If proposal is to deepen or plug back, give data on present productive zone and proposed new productive zone. If proposal is to drill or deepen directionally, give pertinent data on subsurface locations and measured and true vertical depths. Give blowout preventer program, if any.

24. FOR: LIVELY EXPLORATION COMPANY  
ORIGINAL SIGNED BY President, Walsh Engr. & Production Corp.  
SIGNED Ewell N. Walsh, E. N. WALSH DATE 4/29/81  
(This space for Federal or State office use)

PERMIT NO. APPROVAL DATE

APPROVED BY TITLE  
CONDITIONS OF APPROVAL, IF ANY:

\*See Instructions On Reverse Side

APPROVED  
AS AMENDED

MAY 19 1981  
Dean Elliott  
For JAMES F. SIMS  
DISTRICT ENGINEER

All distances must be from the outer boundaries of the Section.

Operator <b>LIVELY EXPLORATION COMPANY</b>			Lease <b>LIVELY</b>		Well No. <b>11E</b>
Unit Letter <b>B</b>	Section <b>16</b>	Township <b>28N</b>	Range <b>8W</b>	County <b>San Juan</b>	
Actual Footage Location of Well: <b>1060</b> feet from the <b>North</b> line and <b>1780</b> feet from the <b>East</b> line					
Ground Level Elev. <b>6423</b>	Producing Formation <b>Dakota</b>		Pool <b>Basin Dakota</b>		Dedicated Acreage: <b>320</b> Acres

1. Outline the acreage dedicated to the subject well by colored pencil or hatchure marks on the plat below.

2. If more than one lease is dedicated to the well, outline each and identify the ownership thereof (both as to working interest and royalty).

3. If more than one lease of different ownership is dedicated to the well, have the interests of all owners been consolidated by communitization, unitization, force-pooling, etc?

☐ Yes ☐ No If answer is "yes," type of consolidation \_\_\_\_\_

If answer is "no," list the owners and tract descriptions which have actually been consolidated. (Use reverse side of this form if necessary.) \_\_\_\_\_

No allowable will be assigned to the well until all interests have been consolidated (by communitization, unitization, forced-pooling, or otherwise) or until a non-standard unit, eliminating such interests, has been approved by the Commission.

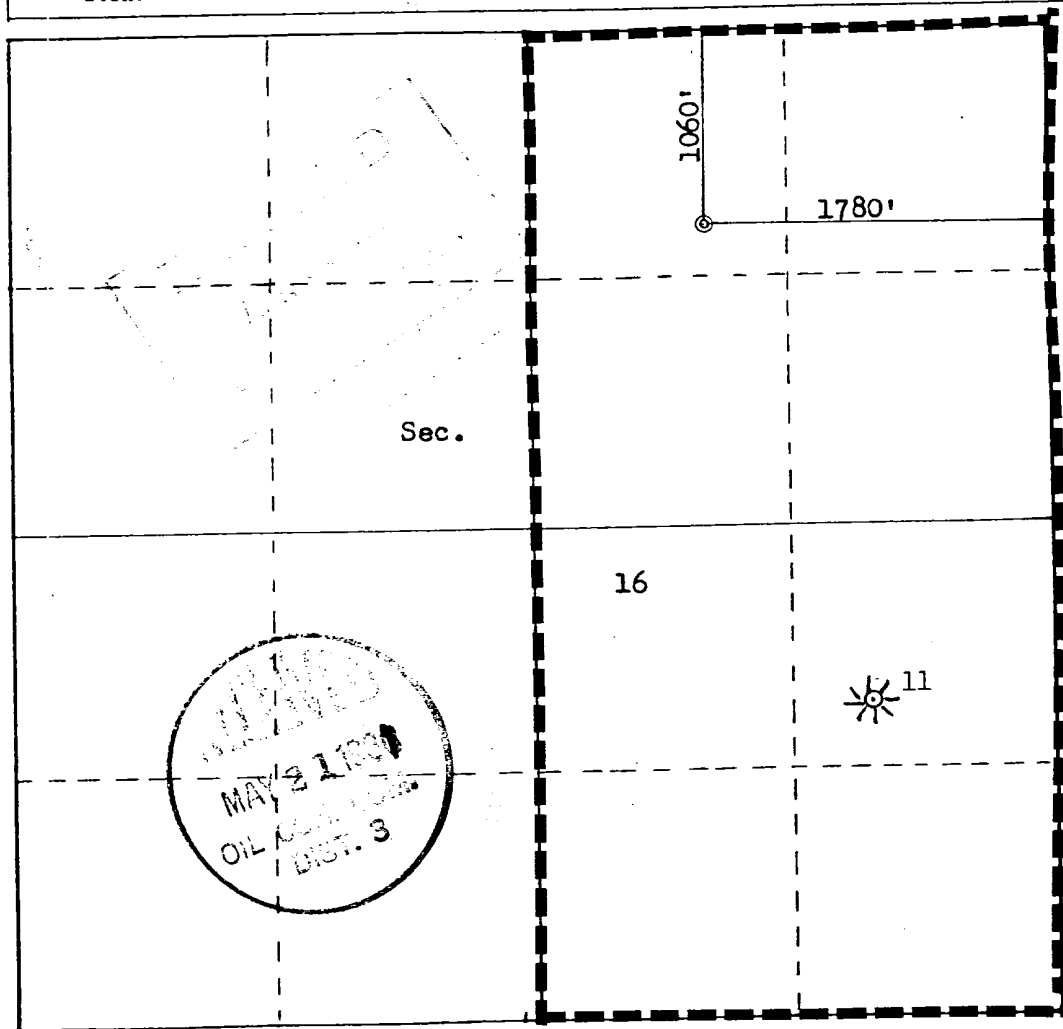

Scale: 1"=1000'

## CERTIFICATION

I hereby certify that the information contained herein is true and complete to the best of my knowledge and belief.

FOR: LIVELY EXPLORATION CO.  
ORIGINAL SIGNED BYName **EWELL N. WALSH**  
Ewell N. Walsh, P.E.Position  
PresidentCompany  
Walsh Engr. & Prod. Corp.Date  
4/29/81

I hereby certify that the well location shown on this plat was plotted from field notes of actual surveys made by me or under my supervision, and that the same is true and correct to the best of my knowledge and belief.

Date Surveyed

April 3, 1981

Registered Professional Engineer  
and Land Surveyor

Fred B. Kerr, Jr.

Certificate No.

1950

7°45' 25.500m E 70°00' 10.100m N

2 p. 40

INAV 82

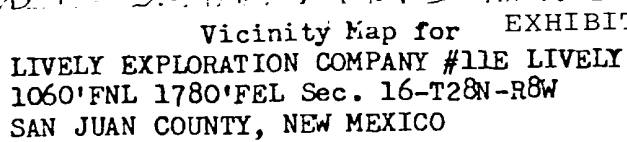

UNITED STATES  
DEPARTMENT OF THE INTERIOR  
GEOLOGICAL SURVEY

SUNDRY NOTICES AND REPORTS ON WELLS

(Do not use this form for proposals to drill or to deepen or plug back to a different reservoir. Use Form 9-331-C for such proposals.)

1. oil ☐ gas ☒ other ☐

2. NAME OF OPERATOR  
Lively Exploration Company

3. ADDRESS OF OPERATOR Houston, Texas 77002  
1010 First City National Bank Building

4. LOCATION OF WELL (REPORT LOCATION CLEARLY. See space 17 below.)  
AT SURFACE: 1060' FNL, 1780' FEL  
AT TOP PROD. INTERVAL:  
AT TOTAL DEPTH:

16. CHECK APPROPRIATE BOX TO INDICATE NATURE OF NOTICE, REPORT, OR OTHER DATA

REQUEST FOR APPROVAL TO:

TEST WATER SHUT-OFF ☐  
FRACTURE TREAT ☒  
SHOOT OR ACIDIZE ☒  
REPAIR WELL ☐  
PULL OR ALTER CASING ☐  
MULTIPLE COMPLETE ☐  
CHANGE ZONES ☐  
ABANDON\* ☐  
(other) ☐

SUBSEQUENT REPORT OF:

☐  
☐  
☐  
☐  
☐  
☐  
☐  
☐  
☐

5. LEASE  
SF 078414A  
6. IF INDIAN, ALLOTTEE OR TRIBE NAME  
7. UNIT AGREEMENT NAME  
8. FARM OR LEASE NAME  
Lively  
9. WELL NO.  
11E  
10. FIELD OR WILDCAT NAME  
Basin Dakota  
11. SEC., T., R., M., OR BLK. AND SURVEY OR AREA  
Sec. 16, T28N, R8W, NMPM  
12. COUNTY OR PARISH  
San Juan  
13. STATE  
New Mexico  
14. API NO.  
30 045 25 045  
15. ELEVATIONS (SHOW DF, KDB, AND WD)  
6423' GL, 6436' DF, 6437' KB

(NOTE: Report results of multiple completion or zone change on Form 9-330.)

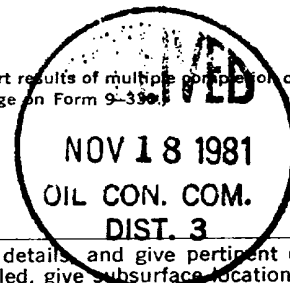

17. DESCRIBE PROPOSED OR COMPLETED OPERATIONS (Clearly state all pertinent details, including estimated date of starting any proposed work. If well is directionally drilled, give subsurface locations and measured and true vertical depths for all markers and zones pertinent to this work.)\*

Open hole completion with an estimated total depth of 7346'. Plan to complete from 7235' to 7346'. Acidize with 2500 gals HCL. Frac with 80,000 gals frac fluid.

Subsurface Safety Valve: Manu. and Type \_\_\_\_\_ Set @ \_\_\_\_\_ Ft.

18. I hereby certify that the foregoing is true and correct

SIGNED Raymond W. Vinyard TITLE Exec. V. P. DATE 11 November 1981

(This space for Federal or State office use)

APPROVED BY (Orig. Sgd.) RAYMOND W. VINYARD TITLE ACTING DISTRICT SUPERVISOR DATE NOV 16 1981  
CONDITIONS OF APPROVAL, IF ANY:

5 USGS, 1 VS, 1 Conoco, 1 EPNGC, 1 JIMCO, 1 HBL

\*See Instructions on Reverse Side

NMCC