

UNITED STATES
DEPARTMENT OF THE INTERIOR
GEOLOGICAL SURVEY

30-045-25404
5. LEASE DESIGNATION AND SERIAL NO.
I-149-IND-8181

APPLICATION FOR PERMIT TO DRILL, DEEPEN, OR PLUG BACK

1a. TYPE OF WORK
DRILL DEEPEN PLUG BACK

6. IF INDIAN, ALLOTTEE OR TRIBE NAME
Navajo Indian 059305

7. UNIT AGREEMENT NAME

8. FARM OR LEASE NAME
Navajo "D"

9. WELL NO.
1-E

10. FIELD AND POOL, OR WILDCAT
Basin Dakota

11. SEC., T., R., M. OR BLK. AND SURVEY OR AREA
L
Sec. 1, T-27N, R-13W, N.M.P.M

12. COUNTY OR PARISH 13. STATE
San Juan New Mexico

b. TYPE OF WELL
OIL WELL GAS WELL OTHER
SINGLE ZONE MULTIPLE ZONE

2. NAME OF OPERATOR
Supron Energy Corporation

3. ADDRESS OF OPERATOR
P.O. Box 808, Farmington, New Mexico 87401

4. LOCATION OF WELL (Report location clearly and in accordance with any State requirements.)*
At surface 1565 Ft./South; 885 Ft./West line

At proposed prod. zone Same as above

14. DISTANCE IN MILES AND DIRECTION FROM NEAREST TOWN OR POST OFFICE*
7 Miles South of Farmington, New Mexico

15. DISTANCE FROM PROPOSED* LOCATION TO NEAREST PROPERTY OR LEASE LINE, FT. (Also to nearest drlg. unit line, if any)
885 Ft. 885 Ft.

16. NO. OF ACRES IN LEASE
319.91

17. NO. OF ACRES ASSIGNED TO THIS WELL
W/2 319.91

18. DISTANCE FROM PROPOSED LOCATION* TO NEAREST WELL, DRILLING, COMPLETED, OR APPLIED FOR, ON THIS LEASE, FT.
1855 Ft.

19. PROPOSED DEPTH
6200 Ft.

20. ROTARY OR CABLE TOOLS
Rotary

21. ELEVATIONS (Show whether DF, RT, GR, etc.)
5838 GR

22. APPROX. DATE WORK WILL START*
March 25, 1981

23. PROPOSED CASING AND CEMENTING PROGRAM

SIZE OF HOLE	SIZE OF CASING	WEIGHT PER FOOT	SETTING DEPTH	QUANTITY OF CEMENT
12-1/4"	8-5/8"	24.00	250	150 Sx. Circulated
7-7/8"	4-1/2"	10.50	6200	1050 Sx. Cover Ojo Alamo

We desire to drill 12-1/4" surface hole to T.D. of approximately 250 ft. Run new 8-5/8", 24.00# casing and cement. Circulate cement back to surface. Test casing. Drill 7-7/8" hole to T.D. of approximately 6200 ft. using a permaloid non dispersed mud as the circulating medium. Log the well. Run new 4-1/2", 10.50# casing with D.V. tools at approximately 4140 ft. and 1525 ft. Cement as follows: 1st stage approx. 350 sx. of 50-50 poz. 2nd stage: approx. 400 sx. of 50-50 poz. followed by 50 sx of class "B", 3rd stage: approx. 150 sx. of 65-35 poz followed by 100 sx of 50-50 poz. Pressure test the casing. Perforate and fracture the Dakota zone. Clean the well up. Nipple down the wellhead. Test the well. Connect to a gathering system.

The gas from this well has previously been dedicated to a transporter.

IN ABOVE SPACE DESCRIBE PROPOSED PROGRAM: If proposal is to deepen or plug back, give data on present productive zone and proposed new productive zone. If proposal is to drill or deepen directionally, give pertinent data on subsurface locations and measured and true vertical depths. Give blowout preventer program, if any.

24. SIGNED [Signature] TITLE Area Superintendent DATE March 20, 1981
(This space for Federal or State office use)

PERMIT NO. _____

APPROVED BY _____ TITLE _____
CONDITIONS OF APPROVAL, IF ANY:

ok

NMOC

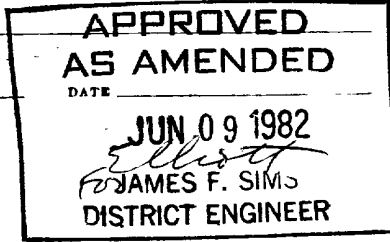

NEW MEXICO OIL CONSERVATION COMMISSION
WELL LOCATION AND ACREAGE DEDICATION PLAT

Form C-102
Superseded C-178
Effective 1-1-65

All distances must be from the outer boundaries of the Section.

Operator SUPRON ENERGY CORPORATION		Lease NAVAJO "D"		Well No. 1-E	
Unit Letter L	Section 1	Township 27 NORTH	Range 13 WEST	County SAN JUAN	
Actual Footage Location of Well: 1565 feet from the SOUTH line and 885 feet from the WEST line					
Ground Level Elev. 5838	Producing Formation Dakota	Pool Basin	Dedicated Acreage: W 1/2 319.91 Acres		

1. Outline the acreage dedicated to the subject well by colored pencil or hachure marks on the plat below.
2. If more than one lease is dedicated to the well, outline each and identify the ownership thereof (both as to working interest and royalty).
3. If more than one lease of different ownership is dedicated to the well, have the interests of all owners been consolidated by communitization, unitization, force-pooling, etc?

Yes No If answer is "yes," type of consolidation _____

If answer is "no," list the owners and tract descriptions which have actually been consolidated. (Use reverse side of this form if necessary.) _____

No allowable will be assigned to the well until all interests have been consolidated (by communitization, unitization, forced-pooling, or otherwise) or until a non-standard unit, eliminating such interests, has been approved by the Commission.

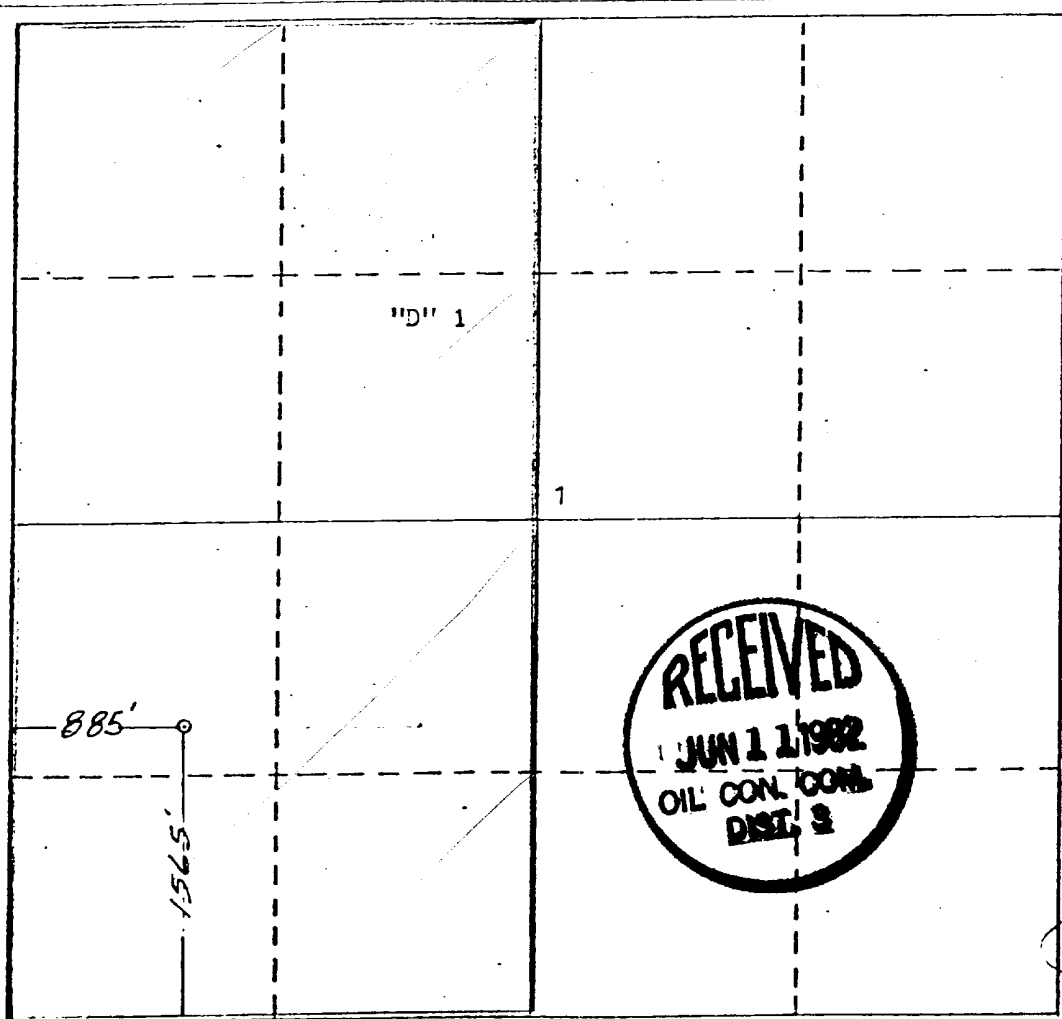

CERTIFICATION

I hereby certify that the information contained herein is true and complete to the best of my knowledge and belief.

Rudy D. Motto

Name

Rudy D. Motto

Position

Area Superintendent

Company

SUPRON ENERGY CORPORATION

Date

October 13, 1980

I hereby certify that the well location shown on this plat was plotted from field notes of actual surveys made by me or under my supervision, and that the same is true and correct to the best of my knowledge and belief.

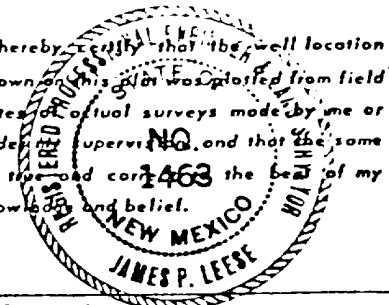

Date Surveyed

October 1, 1980

Registered Professional Engineer and/or Land Surveyor

James P. Leese

James P. Leese

Certificate No.

1463

