

UNITED STATES
DEPARTMENT OF THE INTERIOR
GEOLOGICAL SURVEY

APPLICATION FOR PERMIT TO DRILL, DEEPEN, OR PLUG BACK

1a. TYPE OF WORK

DRILL ☒DEEPEN ☐PLUG BACK ☐

b. TYPE OF WELL

OIL
WELL ☐GAS
WELL ☒

OTHER

SINGLE
ZONE ☒MULTIPLE
ZONE ☐

2. NAME OF OPERATOR

DUGAN PRODUCTION CORP.

3. ADDRESS OF OPERATOR

P. O. Box 208, Farmington, NM 87499

4. LOCATION OF WELL (Report location clearly and in accordance with any State requirements.)

At surface

790' FSL - 1850' FEL

At proposed prod. zone

14. DISTANCE IN MILES AND DIRECTION FROM NEAREST TOWN OR POST OFFICE*

Farmington, N. M. is 16 miles north

15. DISTANCE FROM PROPOSED*

LOCATION TO NEAREST
PROPERTY OR LEASE LINE, FT.

(Also to nearest drlg. unit line, if any)

790'

18. DISTANCE FROM PROPOSED LOCATION*

TO NEAREST WELL, DRILLING, COMPLETED,
OR APPLIED FOR, ON THIS LEASE, FT.

1/4 Mile

16. NO. OF ACRES IN LEASE

480

19. PROPOSED DEPTH

1250'

17. NO. OF ACRES ASSIGNED
TO THIS WELL

160

20. ROTARY OR CABLE TOOLS

Rotary

21. ELEVATIONS (Show whether DF, RT, GR, etc.)

5912' GL

DRILLING OPERATIONS AUTHORIZED ARE
SUBJECT TO COMPLIANCE WITH ATTACHED

22. APPROX. DATE WORK WILL START*

May 30, 1983

23.

GENERAL REQUIREMENTS
PROPOSED CEMENTING AND CEMENTING PROGRAMThis action is subject to a mandatory
appeal pursuant to 50 CFR 290.

SIZE OF HOLE	SIZE OF CASING	WEIGHT PER FOOT	SETTING DEPTH	QUANTITY OF CEMENT
8-3/4"	7"	26#	90'	41 cu.ft. to surface
5-1/8"	2-7/8"	6.4#	1250'	200 cu.ft. to surface

Plan to drill with spud mud to 90' to set surface casing. Will then drill with as little mud as possible, using the slim hole technique to test the Pictured Cliffs formation. Will run IES log, and if the well appears productive, will run 2-7/8" casing, selectively perforate, frac, clean out after frac, and complete the well using 1-1/4" tubing.

GAS NOT DEDICATED.

RECEIVED

MAY 31 1983

OIL CON. DIV.
DIST. 3

IN ABOVE SPACE DESCRIBE PROPOSED PROGRAM: If proposal is to deepen or plug back, give data on present productive zone and proposed new productive zone. If proposal is to drill or deepen directionally, give pertinent data on subsurface locations and measured and true vertical depths. Give blowout preventer program, if any.

24.

SIGNED

Jerry McHugh

TITLE Well Site Coordinator

DATE 4-29-83

(This space for Federal or State office use)

PERMIT NO.

APPROVAL DATE

APPROVED BY

TITLE

CONDITIONS OF APPROVAL, IF ANY:

APPROVED
AS AMENDED

MAY 26 1983

JAMES F. SIMS
DISTRICT ENGINEER

*See Instructions On Reverse Side

NMCC

All distances must be from the outer boundaries of the Section.

Operator Dugan Production Corporation			Lease Kennebec		Well No. 1
Well Letter 0	Section 32	Township 27 North	Range 12 West	County San Juan	
Actual Footage Location of Well: 790 feet from the South line and 1850 feet from the East line					
Ground Level Elev. 5912	Producing Formation Pictured Cliffs	Pool Pictured Cliff Wildcat		Dedicated Acreage: 160 Acres	

1. Outline the acreage dedicated to the subject well by colored pencil or hachure marks on the plat below.
2. If more than one lease is dedicated to the well, outline each and identify the ownership thereof (both as to working interest and royalty).
3. If more than one lease of different ownership is dedicated to the well, have the interests of all owners been consolidated by communitization, unitization, force-pooling, etc?

☐ Yes ☐ No If answer is "yes," type of consolidation _____

If answer is "no," list the owners and tract descriptions which have actually been consolidated. (Use reverse side of this form if necessary.) _____

No allowable will be assigned to the well until all interests have been consolidated (by communitization, unitization, forced-pooling, or otherwise) or until a non-standard unit, eliminating such interests, has been approved by the Division.

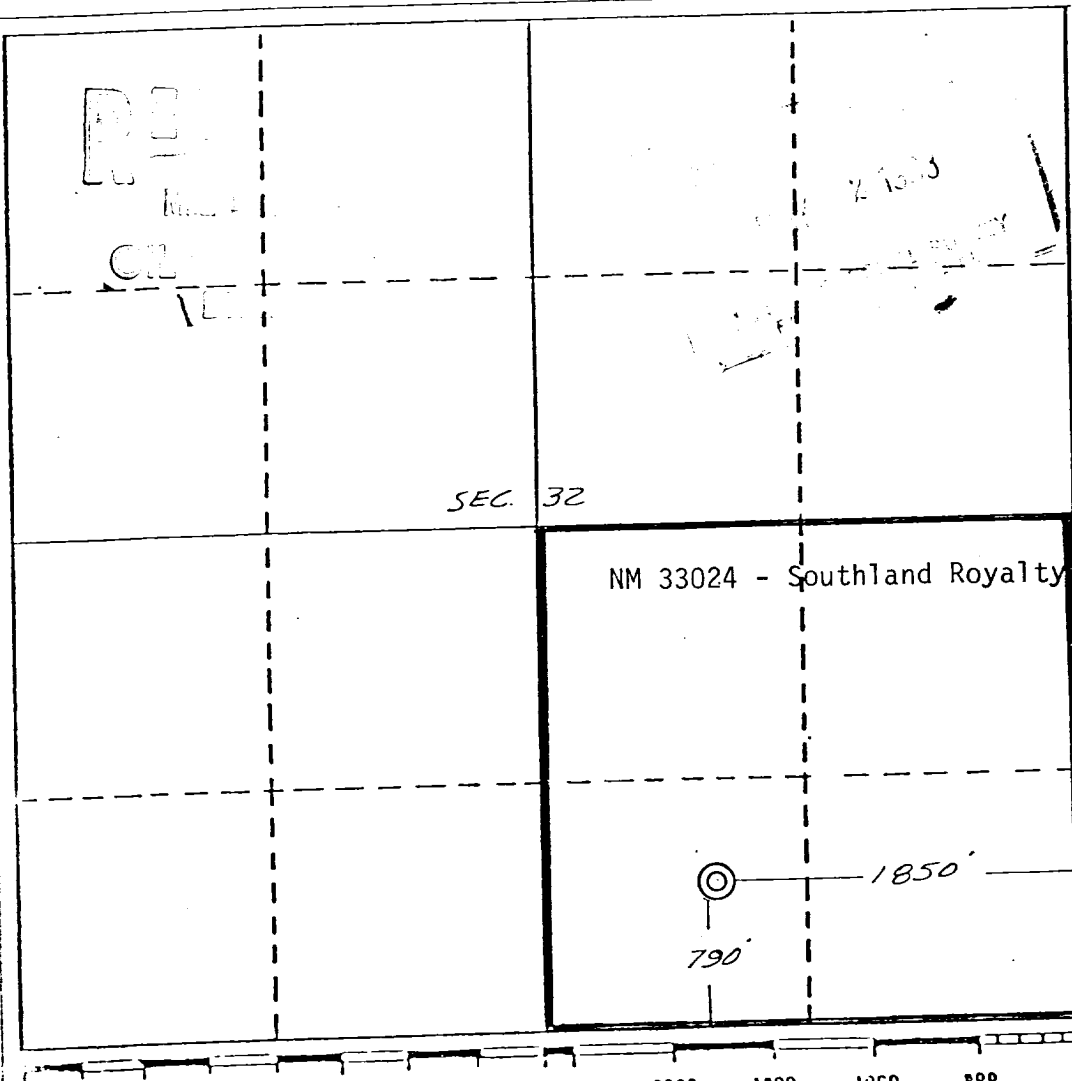

CERTIFICATION

I hereby certify that the information contained herein is true and complete to the best of my knowledge and belief.

Name Jerry McHugh
Jerry McHugh
Position Well Site Coordinator
Company Dugan Production Corp.
Date 4-29-83

I hereby certify that the well location shown on this plat was obtained from field notes of actual surveys made by me or under my supervision, and that the same is true and correct to the best of my knowledge and belief.

Date Surveyed April 25, 1983
Registered Professional Engineer and/or Land Surveyor

Edgar L. Risenhoover
Certificate No. 5979
Edgar L. Risenhoover, L.S.