

UNITED STATES
DEPARTMENT OF THE INTERIOR
BUREAU OF LAND MANAGEMENT

APPLICATION FOR PERMIT TO DRILL, DEEPEN, OR PLUG BACK

1a. TYPE OF WORK

DRILL ☒

DEEPEN ☐

PLUG BACK ☐

b. TYPE OF WELL

OIL
WELL ☐

GAS
WELL ☒

OTHER

SINGLE
ZONE ☒

MULTIPLE
ZONE ☐

2. NAME OF OPERATOR

Amoco Production Co.

3. ADDRESS OF OPERATOR

501 Airport Drive, Farmington, N M 87401

4. LOCATION OF WELL (Report location clearly and in accordance with any State requirements.)*

At surface
790' FNL x 1700' FWL

At proposed prod. zone

same

14. DISTANCE IN MILES AND DIRECTION FROM NEAREST TOWN OR POST OFFICE

6 1/2 miles SE of Bloomfield, NM

15. DISTANCE FROM PROPOSED

LOCATION TO NEAREST

PROPERTY OR LEASE LINE, FT.

(Also to nearest drg. unit line, if any)

790'

18. DISTANCE FROM PROPOSED LOCATION*

TO NEAREST WELL, DRILLING, COMPLETED,
OR APPLIED FOR, ON THIS LEASE, FT.

900' SW

16. NO. OF ACRES IN LEASE

489.3 - 2108.35

19. PROPOSED DEPTH

1873'

17. NO. OF ACRES ASSIGNED

TO THIS WELL

160 165.53

20. ROTARY OR CABLE TOOLS

rotary

21. OPERATIONS (Show whether DR, DT, GR, or CR)

5768' GR

DRILLING OPERATIONS AUTHORIZED ARE
SUBJECT TO COMPLIANCE WITH ATTACHED
"GENERAL REQUIREMENTS"

22. APPROX. DATE WORK WILL START*

as soon as permitted

23.

"GENERAL REQUIREMENTS" CASING AND CEMENTING PROGRAM

This action is subject to administrative
appeal pursuant to 30 CFR 290.

SIZE OF HOLE	SIZE OF CASING	WEIGHT PER FOOT	SETTING DEPTH	QUANTITY OF CEMENT
12-1/4"	8-5/8"	24#, J-55	300'	354 cf Class B
7-7/8"	4-1/2"	10.5#, K-55	1873'	640 cf Class B

Amoco proposes to drill the above well to further develop the Blanco Pictured Cliffs reservoir. The well will be drilled to the surface casing point using native mud. The well will then be drilled to TD with a low solids nondispersed mud system. Completion design will be based on open hole logs. Copy of all logs will be filed upon completion. Amoco's standard blowout prevention will be employed; see attached drawing for blowout preventer design. Upon completion the well site will be cleaned and the reserve pit filled and leveled. The gas from this well is undedicated at this time.

RECEIVED

OCT 07 1985

IN ABOVE SPACE DESCRIBE PROPOSED PROGRAM: If proposal is to deepen or plug back, give data on present productive zone and proposed new productive zone. If proposal is to drill or deepen directionally, give pertinent data on subsurface locations and measured and vertical depths. If blowout prevention program, if any.

24.

SIGNED

B D Shaw

TITLE

Adm. Supervisor

DATE

4/12/85

(This space for Federal or State office use)

PERMIT NO.

APPROVAL DATE

APPROVED BY

TITLE

CONCURRENCE OF APPROVAL, IF ANY:

DATE

OCT 03 1985

/s/ J. Stan McKee

M. MILLENBACH
AREA MANAGER

NMOCC

*See Instructions On Reverse Side

Title 18 U.S.C. Section 1001, makes it a crime for any person knowingly and willfully to make to any department or agency of the United States any false, fictitious or fraudulent statements or representations as to any matter within its jurisdiction.



All distances must be from the outer boundaries of the Section.

Operator AMOCO PRODUCTION COMPANY			Lease MADELINE N. GALT		Well No. # 2
Unit Letter C	Section 6	Township 27N	Range 10W	County San Juan	
Actual Footage Location of Well: 790 feet from the North line and 1700 feet from the West line					
Ground Level Elev: 5768	Producing Formation Pictured Cliffs		Pool Blanco Pictured Cliffs	Dedicated Acreage: 160/6553 Acres	

1. Outline the acreage dedicated to the subject well by colored pencil or hatchure marks on the plat below.
2. If more than one lease is dedicated to the well, outline each and identify the ownership thereof (both as to working interest and royalty).
3. If more than one lease of different ownership is dedicated to the well, have the interests of all owners been consolidated by communitization, unitization, force-pooling, etc?

☐ Yes ☒ No If answer is "yes," type of consolidation _____

If answer is "no," list the owners and tract descriptions which have actually been consolidated. (Use reverse side of this form if necessary.) _____

No allowable will be assigned to the well until all interests have been consolidated (by communitization, unitization, forced-pooling, or otherwise) or until a non-standard unit, eliminating such interests, has been approved by the Commission.

Scale: 1"=1000'

CERTIFICATION

I hereby certify that the information contained herein is true and complete to the best of my knowledge and belief.

B. D. Shaw

Name
B. D. Shaw

Position
Admin. Supervisor

Company
Amoco Production Co.

Date
4/11/85

I hereby certify that the well location shown on this plat was plotted from field notes of actual surveys made by me or under my supervision, and that the same is true and correct to the best of my knowledge and belief.

Date Surveyed
January 16, 1985

Registered Professional Engineer and Land Surveyor

Fred B. Kerr Jr.
Fred B. Kerr Jr.

Certificate No. 3950

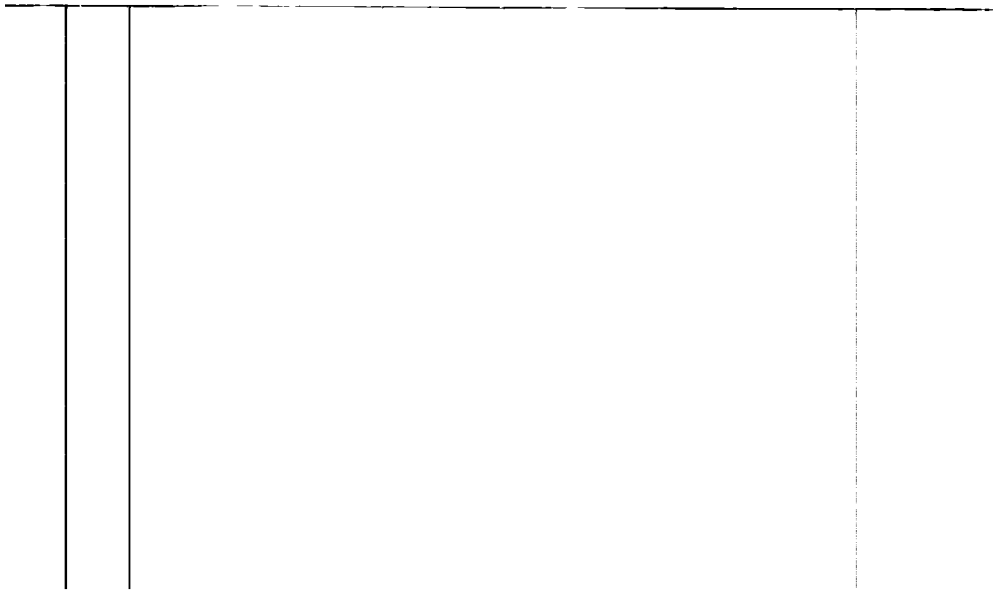

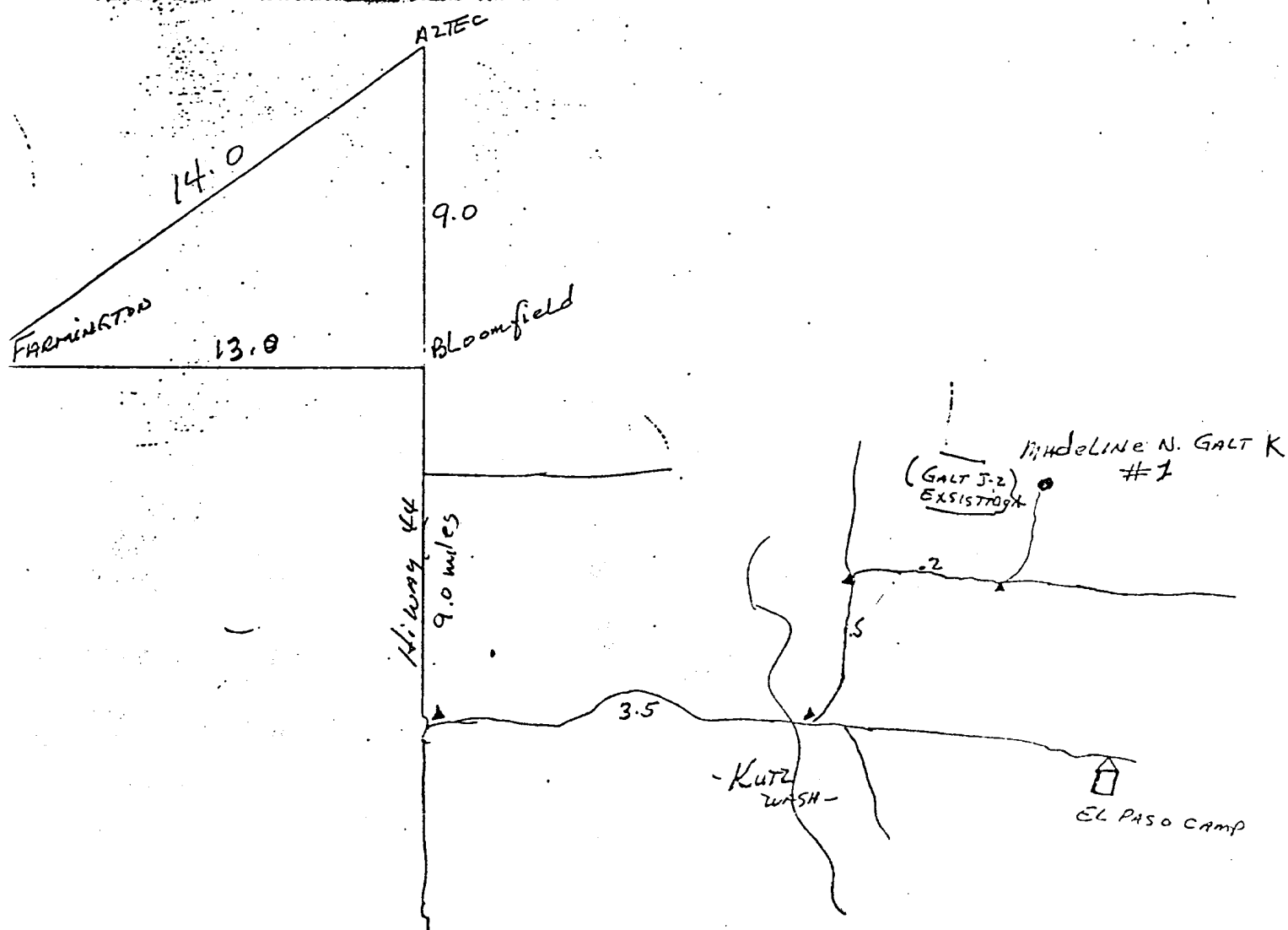
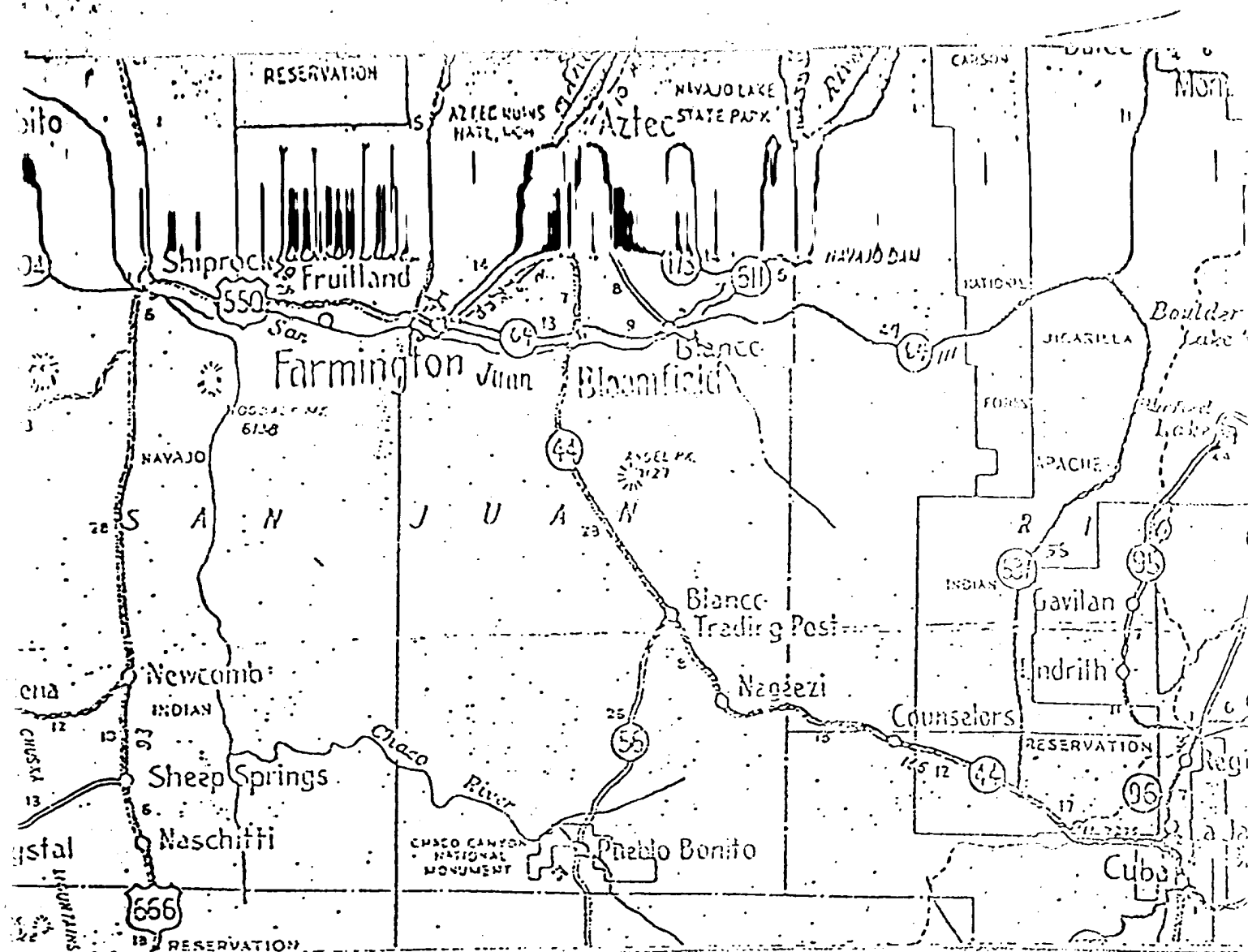

MADeline N. GALT "K" #1

UNITED STATES
DEPARTMENT OF THE INTERIOR
BUREAU OF LAND MANAGEMENT

SUBMIT IN TRIPLICATE*
(Other instructions on re-
verse side)

Budget Bureau No. 1004-0135
Expires August 31, 1985

5. LEASE DESIGNATION AND SERIAL NO.

SF-077384

6. IF INDIAN, ALLOTTEE OR TRIBE NAME

7. UNIT AGREEMENT NAME

8. FARM OR LEASE NAME

Madeline N. Galt "B"

9. WELL NO.

10. FIELD AND POOL, OR WILDCAT

Fulcher RSTB
Blanco Pictured Cliffs

11. SEC., T., R., M., OR BLK. AND
SURVEY OR AREA

NE/NW Sec. 6, T27N, R10W

12. COUNTY OR PARISH

San Juan

13. STATE

NM

SUNDRY NOTICES AND REPORTS ON WELLS

(Do not use this form for proposals to drill or to deepen or plug back to a different reservoir.
Use "APPLICATION FOR PERMIT—" for such proposals.)

1. ☐ OIL WELL ☐ GAS WELL ☒ OTHER

2. NAME OF OPERATOR

Amoco Production Co.

3. ADDRESS OF OPERATOR

501 Airport Drive, Farmington, N M. 87401

4. LOCATION OF WELL (Report location clearly and in accordance with State requirements.
See also space 17 below.)
At surface

790' FNL x 1700' FWL

RECEIVED

AUG 2 1985

14. PERMIT NO.

15. ELEVATIONS (Show whether DF, RT, GR, etc.)

5768' GR

16.

Check Appropriate Box To Indicate Nature of Notice, Report, or Other Data

NOTICE OF INTENTION TO:

TEST WATER SHUT-OFF

FRACTURE TREAT

SHOOT OR ACIDIZE

REPAIR WELL

(Other) Name Chande

PCLL OR ALTER CASING

MULTIPLE COMPLETE

ABANDON*

CHANGE PLANS

X

SUBSEQUENT REPORT OF:

WATER SHUT-OFF

FRACTURE TREATMENT

SHOOTING OR ACIDIZING

(Other)

REPAIRING WELL

ALTERING CASING

ABANDONMENT*

(NOTE: Report results of multiple completion on Well
Completion or Recompletion Report and Log form.)

17. DESCRIBE PROPOSED OR COMPLETED OPERATIONS (Clearly state all pertinent details, and give pertinent dates, including estimated date of starting any proposed work. If well is directionally drilled, give subsurface locations and measured and true vertical depths for all markers and zones pertinent to this work.)

Amoco Production Company is changing the above referenced well from the Madeline N. Galt K #1 to the Madeline N. Galt B #2.

RECEIVED
OCT 07 1985
OIL CON. DIV.
DIST. 3

18. I hereby certify that the foregoing is true and correct

SIGNED

B. D. Shaw

TITLE Adm. Supervisor

(This space for Federal or State office use)

APPROVED BY

CONDITIONS OF APPROVAL, IF ANY:

TITLE

APPROVED
DATE 8/3/85
AS AMENDED

DATE OCT 03 1985
/s/ J. Stan McKee

for M. MILLENBACH
AREA MANAGER

*See Instructions on Reverse Side
NMOCC

Title 18 U.S.C. Section 1001, makes it a crime for any person knowingly and willfully to make to any department or agency of the United States any false, fictitious or fraudulent statements or representations as to any matter within its jurisdiction.