

UNITED STATES
DEPARTMENT OF THE INTERIOR
BUREAU OF LAND MANAGEMENT

30-045-27719

APPLICATION FOR PERMIT TO DRILL, DEEPEN, OR PLUG BACK

1a. TYPE OF WORK DRILL		5. LEASE NUMBER NM-02861	
1b. TYPE OF WELL GAS		6. IF INDIAN, ALL. OR TRIBE NAME	
2. OPERATOR UNION OIL CO. OF CAL.		7. UNIT AGREEMENT NAME	
3. ADDRESS OF OPERATOR P O BOX 2074 FARMINGTON, NM, 87401 (505)-325-8786		8. FARM OR LEASE NAME Lodewick	
		9. WELL NO. # 15	
4. LOCATION OF WELL 1840' FSL, 875' FWL		10. FIELD, POOL, OR WILDCAT BASIN FRUITLAND COAL	
		11. SEC. 30, T27N, R9W	
14. DISTANCE FROM NEAREST TOWN 20 Miles SE of Bloomfield		12. COUNTY San Juan	13. STATE New Mex.
15. DISTANCE FROM PROPOSED LOCATION TO NEAREST PROPERTY OR LEASE LINE 1250 Feet	16. ACRES IN LEASE 1283.48	17. ACRES ASSIGNED TO WELL 320 Acres	
18. DISTANCE FROM PROPOSED LOCATION TO NEAREST WELL DRILLING, COMPLETED OR APPLIED FOR ON THIS LEASE: 670 Feet	19. PROPOSED DEPTH 2400 Feet	20. ROTARY OR CABLE TOOLS Rotary This action is subject to technical and procedural review pursuant to 43 CFR 316 and appeal pursuant to 43 CFR 3165.4.	
21. ELEVATIONS (DF, FT, GR, ETC.) 6514' GL		22. APPROX. DATE WORK WILL BEGIN Spring 1990	
23. PROPOSED CASING AND CEMENTING PROGRAM SEE ATTACHED DRILLING PLAN		DRILLING OPERATIONS AUTHORIZED ARE SUBJECT TO COMPLIANCE WITH ATTACHED "GENERAL REQUIREMENTS"	
24. AUTHORIZED BY: <i>Chris Runcell</i> AGENT		3/14/90 DATE	

PERMIT NO. **RECEIVED** APPROVAL DATE _____
APPROVED **APR 04 1990** TITLE _____ DATE _____

NOTE: **OIL CON. DIV.**
DIST. 3
THIS FORMAT IS ISSUED IN LIEU OF BLM FORM 3160-3

APPROVED
AS APPL. 1990
APR 03 1990
Ken Townsend
AREA MANAGER

NMOCD

88-111-111
not 0111
hold 0111
0111-111
OK
E

1039150

VIC 1905

E 120

Submit to Appropriate
District Office
State Lease - 4 copies
Fee Lease - 3 copies

State of New Mexico
Energy, Minerals and Natural Resources Department

Form C-102
Revised 1-1-89

OIL CONSERVATION DIVISION

P.O. Box 2088
Santa Fe, New Mexico 87504-2088

DISTRICT I
P.O. Box 1980, Hobbs, NM 88240

DISTRICT II
P.O. Drawer DD, Artesia, NM 88210

DISTRICT III
1000 Rio Brazos Rd., Aztec, NM 87410

WELL LOCATION AND ACREAGE DEDICATION PLAT

All Distances must be from the outer boundaries of the section

Operator UNION OIL CO. OF CALIFORNIA		Lease LODEWICK		Well No. 15
Unit Letter L	Section 30	Township T.27 N.	Range R.9 W.	County SAN JUAN COUNTY
Actual Footage Location of Well: 1840 feet from the SOUTH line and 875 feet from the WEST line				
Ground level Elev. 6514	Producing Formation Basin Fort Coal	Pool Basin Fort Coal	Dedicated Acreage: 32.86 Acres	

- Outline the acreage dedicated to the subject well by colored pencil or hatchure marks on the plat below.
- If more than one lease is dedicated to the well, outline each and identify the ownership thereof (both as to working interest and royalty).
- If more than one lease of different ownership is dedicated to the well, have the interest of all owners been consolidated by communitization, unitization, force-pooling, etc.?
☐ Yes ☐ No If answer is "yes" type of consolidation _____
If answer is "no" list the owners and tract descriptions which have actually been consolidated. (Use reverse side of this form if necessary).
No allowable will be assigned to the well until all interests have been consolidated (by communitization, unitization, forced-pooling, or otherwise) or until a non-standard unit, eliminating such interest, has been approved by the Division.

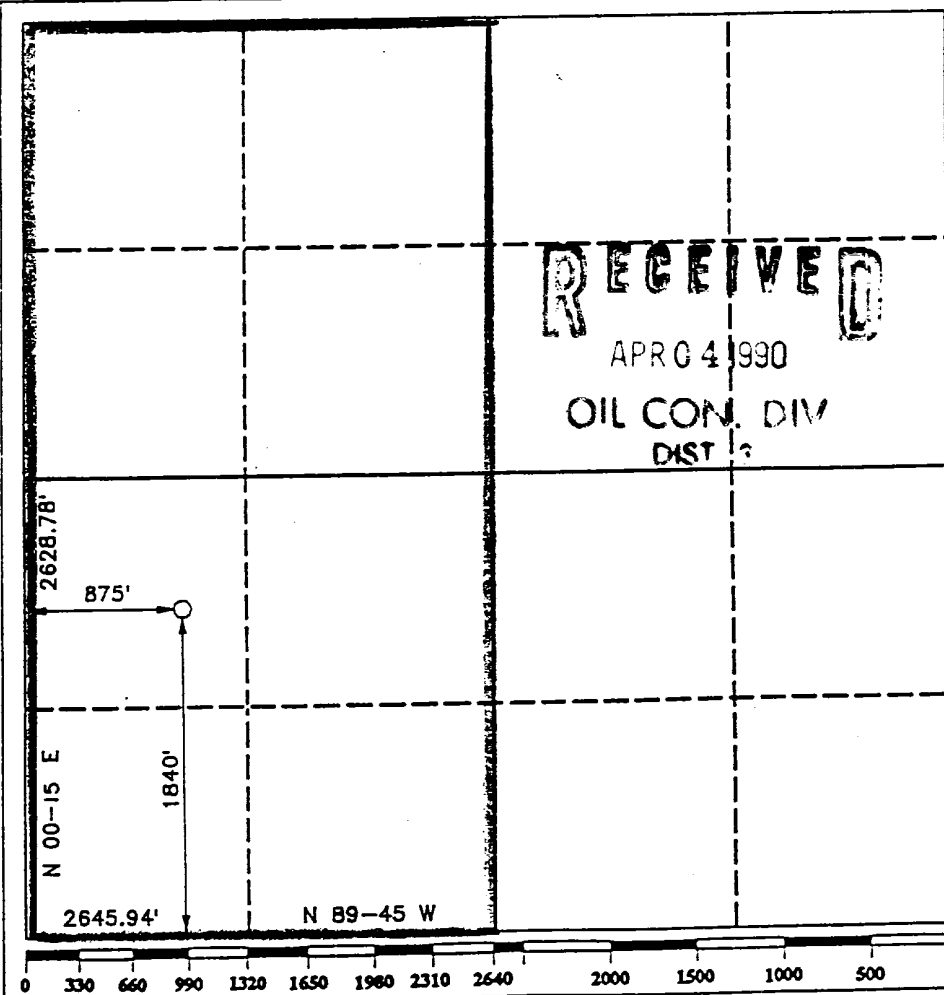

OPERATOR CERTIFICATION

I hereby certify that the information contained herein is true and complete to the best of my knowledge and belief.

Signature
Chris Russell
Printed Name
Chris Russell
Position
Agent
Company
Unocal
Date
2/14/90

SURVEYOR CERTIFICATION

I hereby certify that the well location shown on this plat was plotted from field notes of actual surveys made by me or under my supervision, and that the same is true and correct to the best of my knowledge and belief.

Date Surveyed
FEBRUARY 28 1990
Signature
R. Howard Daggett
Professional Surveyor
R. HOWARD DAGGETT
Certificate No.
9673
Registered Professional
Land Surveyor