

(SUBMIT IN TRIPLICATE)

UNITED STATES  
DEPARTMENT OF THE INTERIOR  
GEOLOGICAL SURVEY

Land Office Santa Fe  
Lease No. 077111  
Unit Storey

SUNDRY NOTICES AND REPORTS ON WELLS

NOTICE OF INTENTION TO DRILL.....	<input checked="" type="checkbox"/>	SUBSEQUENT REPORT OF WATER SHUT-OFF.....
NOTICE OF INTENTION TO CHANGE PLANS.....		SUBSEQUENT REPORT OF SHOOTING OR ACIDIZING.....
NOTICE OF INTENTION TO TEST WATER SHUT-OFF.....		SUBSEQUENT REPORT OF ALTERING CASING.....
NOTICE OF INTENTION TO RE-DRILL OR REPAIR WELL.....		SUBSEQUENT REPORT OF RE-DRILLING OR REPAIR.....
NOTICE OF INTENTION TO SHOOT OR ACIDIZE.....		SUBSEQUENT REPORT OF ABANDONMENT.....
NOTICE OF INTENTION TO PULL OR ALTER CASING.....		SUPPLEMENTARY WELL HISTORY.....
NOTICE OF INTENTION TO ABANDON WELL.....		

(INDICATE ABOVE BY CHECK MARK NATURE OF REPORT, NOTICE, OR OTHER DATA)

July 23, 1956

Well No. 4-C is located 900 ft. from [S] line and 1090 ft. from [E] line of sec. 34  
SE Section 34 23N 9W R4E  
( $\frac{3}{4}$  Sec. and Sec. No.) (Twp.) (Range) (Meridian)  
So. Blanco Extension San Juan New Mexico  
(Field) (County or Subdivision) (State or Territory)

The elevation of the derrick floor above sea level is 620 ft.

DETAILS OF WORK

(State names of and expected depths to objective sands; show sizes, weights, and lengths of proposed casings; indicate mudding jobs, cementing points, and all other important proposed work)

It is intended to drill a well thru the Pictured Cliff formation using rotary tools and to perforate and water fracture possible producing zones. Estimated Total Depth 2430'.

Casing Program:

9 5/8" at 120' with 125 sacks regular cement circulated to surface.  
 5 1/2" at 2430' with 75 sacks regular cement, 75 sacks Pozmix.

The SE  $\frac{1}{4}$  of Section 34 is dedicated to this well.  
 SE  $\frac{1}{4}$ , SF 077111.

I understand that this plan of work must receive approval in writing by the Geological Survey before operations may be commenced.

Company El Paso Natural Gas Company  
 Address Box 997  
Farmington, New Mexico  
 By [Signature]  
 Title Petroleum Engineer

NEW MEXICO  
OIL CONSERVATION COMMISSION

WELL LOCATION AND/OR GAS PRORATION PLAT

JULY 11, 1956

EL PASO NATURAL GAS COMPANY STOREY "C" SF 077111

4 34 28-N 9-W

900 SOUTH 1090 EAST

SAN JUAN 6196

PICTURED CLIFF SO. BLANCO  
EXTENSION

167.22 ACRES  
(1916 PLAT)

Note: All distances must be from outer boundaries of section.

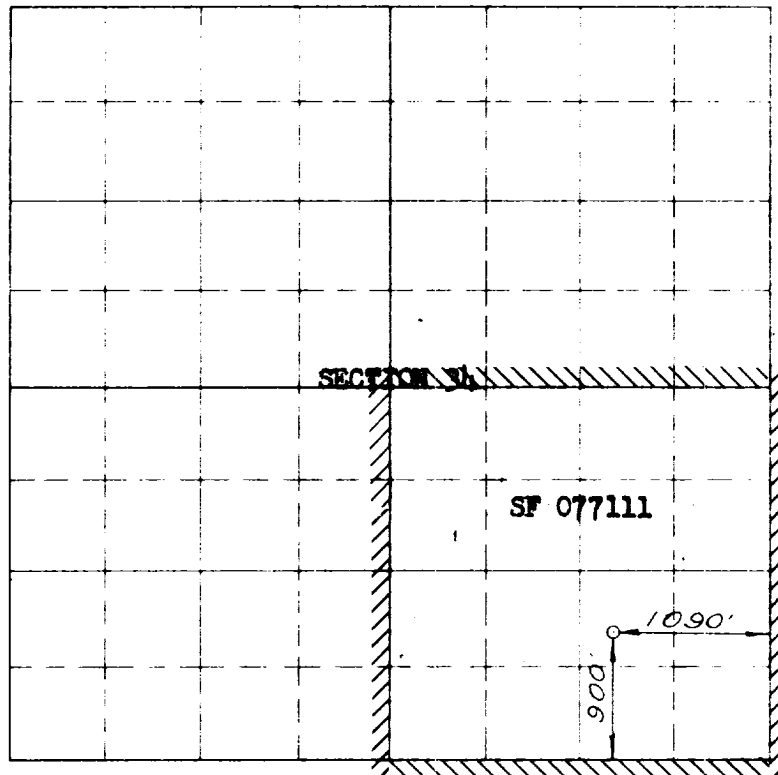

Scale 1 inch equals 1 mile

JUL 25 1956  
U. S. GEOLOGICAL SURVEY  
REGION, NEW MEXICO

NOTE

This section of  
form is to be used  
for gas wells only

This is to certify that the above plat was prepared from  
field notes of actual surveys made by me or under my  
supervision and that the same are true and correct to the  
best of my knowledge and belief.

Date Surveyed JULY 2, 1956

*E. O. Walker*  
Registered Professional Engineer and/or Land Surveyor

1. Is this well a Dual Comp.  
Yes \_\_\_\_\_ No **X**

2. If the answer to Question 1  
is yes, are there any other dually  
completed wells within the  
dedicated acreage.

Yes \_\_\_\_\_ No \_\_\_\_\_

Name *D. C. Plaster*  
Position **Petroleum Engineer**

Representing **El Paso Natural Gas Co.**

Address **Box 997, Farmington, N.M.**

(Seal)

Farmington, New Mexico