

(SUBMIT IN TRIPLICATE)

UNITED STATES
DEPARTMENT OF THE INTERIOR
GEOLOGICAL SURVEY

Land Office Santa Fe
Lease No. 079319
Unit Schwerdtfeger

SUNDRY NOTICES AND REPORTS ON WELLS

NOTICE OF INTENTION TO DRILL.....		SUBSEQUENT REPORT OF WATER SHUT-OFF.....	
NOTICE OF INTENTION TO CHANGE PLANS.....		SUBSEQUENT REPORT OF SHOOTING OR ACIDIZING.....	
NOTICE OF INTENTION TO TEST WATER SHUT-OFF.....		SUBSEQUENT REPORT OF ALTERING CASING.....	
NOTICE OF INTENTION TO RE-DRILL OR REPAIR WELL.....		SUBSEQUENT REPORT OF RE-DRILLING OR REPAIR.....	
NOTICE OF INTENTION TO SHOOT OR ACIDIZE.....		SUBSEQUENT REPORT OF ABANDONMENT.....	
NOTICE OF INTENTION TO PULL OR ALTER CASING.....		SUPPLEMENTARY WELL HISTORY.....	
NOTICE OF INTENTION TO ABANDON WELL.....			
<u>Notice of intention to recomplete old Mesa Verde well as a dual</u>			

(INDICATE ABOVE BY CHECK MARK NATURE OF REPORT, NOTICE, OR OTHER DATA)

February 15, 1960

Well No. 1-A(M) is located 990 ft. from XXXX line and 990 ft. from XXXX line of sec. 36

SW/4 Sec. 36 24N 9W N.M.P.M.
(1/4 Sec. and Sec. No.) (Twp.) (Range) (Meridian)
Blanco M.V. & So. Blanco P.C. San Juan New Mexico
(Field) (County or Subdivision) (State or Territory)

The elevation of the derrick floor above sea level is 5930 ft.

DETAILS OF WORK

(State names of and expected depths to objective sands; show sizes, weights, and lengths of proposed casings; indicate mudding jobs, cementing points, and all other important proposed work)

It is intended to recomplete the Mesa Verde zone and to complete the Pictured Cliffs formation in the following manner:

1. Either drill out through the Mesa Verde formation or whipstock.
2. Set 5 1/2" liner to Total Depth.
3. Perforate and water fracture Mesa Verde Formation.
4. Perforate and water fracture Pictured Cliffs formation.
5. Install dual completion equipment on well.



I understand that this plan of work must receive approval in writing by the Geological Survey before operations may be commenced.

Company El Paso Natural Gas Company

Address Box 991
Farmington, New Mexico

By Original Signed F. H. WOOD

Title Petroleum Engineer

NEW MEXICO OIL CONSERVATION COMMISSION

Well Location and Acreage Dedication Plat

Section A.

Date **FEBRUARY 15, 1960**

Operator **EL PASO NATURAL GAS COMPANY** Lease **SCHWERTFEGER** SF **079319**
 Well No. **1-A(PM)** Unit Letter **M** Section **36** Township **28-N** Range **9-W** NMPM
 Located **990** Feet From **SOUTH** Line, **990** Feet From **WEST** Line
 County **SAN JUAN** G. L. Elevation **5920** Dedicated Acreage **158.85 & 318.85** Acres
 Name of Producing Formation **PICTURED CLIFFS & MESA VERDE** Pool **SO. BLANCO P.C. & BLANCO M.V.**

1. Is the Operator the only owner in the dedicated acreage outlined on the plat below?
 Yes ☒ No ☐
2. If the answer to question one is "no", have the interests of all the owners been consolidated by communitization agreement or otherwise? Yes ☐ No ☐ If answer is "yes", Type of Consolidation.
3. If the answer to question two is "no", list all the owners and their respective interests below:

Owner

Land Description



Section B.

This is to certify that the information in Section A above is true and complete to the best of my knowledge and belief.

El Paso Natural Gas Company

(Operator)

Original Signed **F. H. WOOD**

(Representative)

Box 997

(Address)

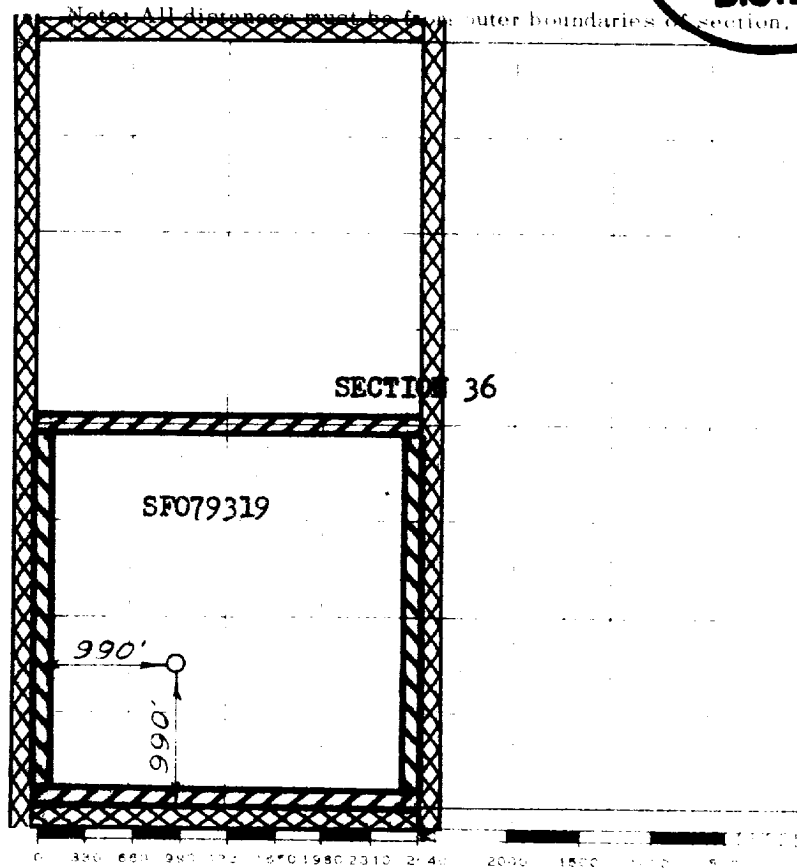
Farmington, New Mexico

Scale 4 inches equal 1 mile

NOTE: THIS PLAT IS RE-ISSUED TO SHOW P.C. DEDICATION. 2 15 60

This is to certify that the above plat was prepared from field notes of a survey made by me or under my supervision and that the same are true and correct to the best of my knowledge and belief.

(Seal)

Date Surveyed **FEBRUARY 17, 1953**

Registered Professional Engineer and Surveyor

Farmington, New Mexico