

(SUBMIT IN TRIPLICATE)

UNITED STATES
DEPARTMENT OF THE INTERIOR
GEOLOGICAL SURVEY

Land Office **Santa Fe**
Lease No. **078329**
Unit **Dura**

SUNDRY NOTICES AND REPORTS ON WELLS

NOTICE OF INTENTION TO DRILL.....	<input checked="" type="checkbox"/>	SUBSEQUENT REPORT OF WATER SHUT-OFF.....
NOTICE OF INTENTION TO CHANGE PLANS.....		SUBSEQUENT REPORT OF SHOOTING OR ACIDIZING.....
NOTICE OF INTENTION TO TEST WATER SHUT-OFF.....		SUBSEQUENT REPORT OF ALTERING CASING.....
NOTICE OF INTENTION TO RE-DRILL OR REPAIR WELL.....		SUBSEQUENT REPORT OF RE-DRILLING OR REPAIR.....
NOTICE OF INTENTION TO SHOOT OR ACIDIZE.....		SUBSEQUENT REPORT OF ABANDONMENT.....
NOTICE OF INTENTION TO PULL OR ALTER CASING.....		SUPPLEMENTARY WELL HISTORY.....
NOTICE OF INTENTION TO ABANDON WELL.....		

(INDICATE ABOVE BY CHECK MARK NATURE OF REPORT, NOTICE, OR OTHER DATA)

January 9, 1957

Well No. **3** is located **1750** ft. from **S** line and **990** ft. from **W** line of sec. **32**
SW Section 32 **26N** **9W** **104PM**
(1/4 Sec. and Sec. No.) (Twp.) (Range) (Meridian)
Blanco **San Juan** **New Mexico**
(Field) (County or Subdivision) (State or Territory)

The elevation of the derrick floor above sea level is **6100** ft.

DETAILS OF WORK

(State names of and expected depths to objective sands; show sizes, weights, and lengths of proposed casings; indicate mudding jobs, cementing points, and all other important proposed work)

It is intended to drill a well with rotary tools thru the Mesa Verde formation. Mud circulation will be used thru the Pictured Cliffs and set intermediate casing. Gas circulation will be used thru the Mesa Verde and production casing will be set. Possible productive intervals will be perforated and fractured. Estimated T.D. 4655'.

Casing Program:

10 3/4" at 170' with 125 sacks cement circulated to the surface.
 7 5/8" at 2260' with 250 sacks cement.
 5 1/2" at 4655' with 150 sacks cement.

The W/2 of Section 32 is dedicated to this well.
 W/2 SF 078329.

I understand that this plan of work must receive approval in writing by the Geological Survey before operation and comment.

Company **El Paso Natural Gas Company**

Address **Box 997**

Farmington, N.M.

By _____

Title **Petroleum Engineer**



ORIGINAL SIGNED & SUBMITTED



NEW MEXICO
OIL CONSERVATION COMMISSION

WELL LOCATION AND DEPTH DATA

JANUARY 7, 1957

EL PASO NATURAL GAS COMPANY

DAUM

SF 078329

3

32

28 N

9 W

1750

SOUTH

990

WEST

~~EL PASO~~

San Juan

6090

MESA VERDE

BLANCO

328.37 AC.
(1916 PLAT)

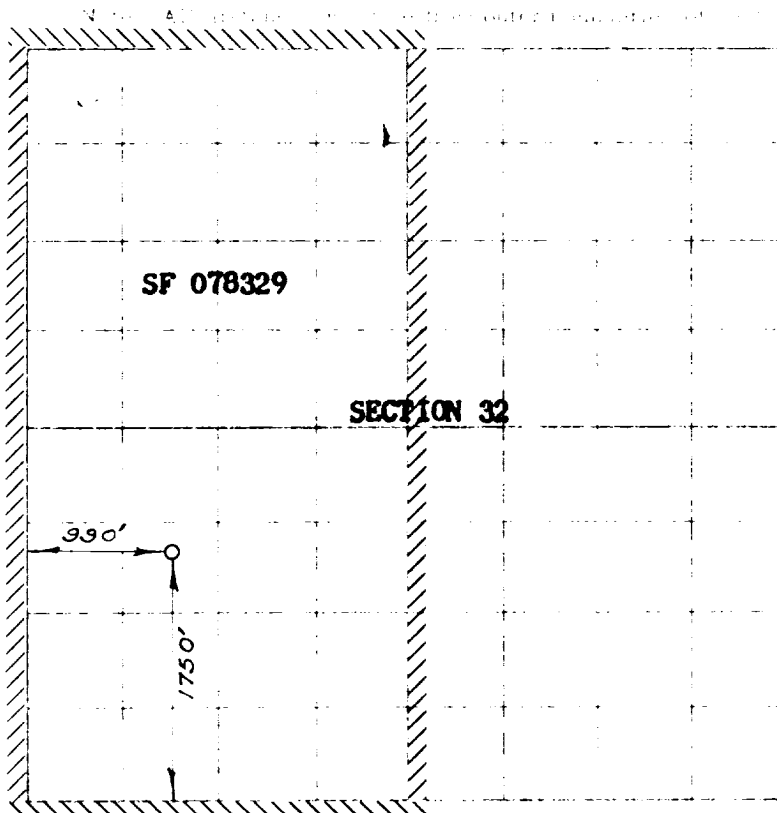

Scale: 1 inch = 400 feet

NOTE

This section of
form is to be used
for this well only

I hereby certify that the above plat was prepared from
field notes of actual surveys made by me or under my
supervision and that the same are true and correct to the
best of my knowledge and belief.

Date Surveyed **DECEMBER 19, 1956**

E. O. Walker
Registered Professional Engineer and/or Land Surveyor

1. Is this well a **X** ☒ **Yes** ☐ **No**
2. If the answer to Question 1 is **Yes**, are there any other fully completed wells on this acre dedicated to mineral?

Name **ORIGINAL SIGNED E. S. OBERLY**

Position **Petroleum Engineer**

representing **El Paso Natural Gas Co.**

Address **Box 997, Farmington, N.M.**

Seal