

(SUBMIT IN TRIPLICATE)

UNITED STATES
DEPARTMENT OF THE INTERIOR
GEOLOGICAL SURVEY

Budget Bureau No. 42-R358.4.
Approval expires 12-31-60.

Land Office **Santa Fe**
Lease No. **078329**
Unit **Dumas**

SUNDRY NOTICES AND REPORTS ON WELLS

NOTICE OF INTENTION TO DRILL	SUBSEQUENT REPORT OF WATER SHUT-OFF
NOTICE OF INTENTION TO CHANGE PLANS	SUBSEQUENT REPORT OF SHOOTING OR ACIDIZING
NOTICE OF INTENTION TO TEST WATER SHUT-OFF	SUBSEQUENT REPORT OF ALTERING CASING
NOTICE OF INTENTION TO RE-DRILL OR REPAIR WELL	SUBSEQUENT REPORT OF RE-DRILLING OR REPAIR
NOTICE OF INTENTION TO SHOOT OR ACIDIZE	SUBSEQUENT REPORT OF ABANDONMENT
NOTICE OF INTENTION TO PULL OR ALTER CASING	SUPPLEMENTARY WELL HISTORY
NOTICE OF INTENTION TO ABANDON WELL	

(INDICATE ABOVE BY CHECK MARK NATURE OF REPORT, NOTICE, OR OTHER DATA)

April 1, 1957

Well No. **3** is located **1750** ft. from **S** line and **990** ft. from **W** line of sec. **32**
SW Section 32 (1/4 Sec. and Sec. No.) **26N** (Twp.) **9W** (Range) **S.M.P.M.** (Meridian)
Blanco (Field) **San Juan** (County or Subdivision) **New Mexico** (State or Territory)

The elevation of the derrick floor above sea level is **6100** ft.

DETAILS OF WORK

(State names of and expected depths to objective sands; show sizes, weights, and lengths of proposed casings; indicate mudding jobs, cementing points, and all other important proposed work)

This plat is re-issued to show correct county.

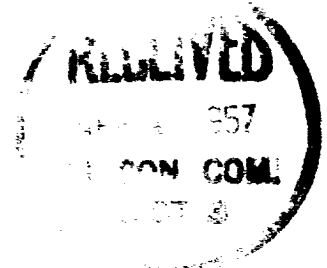

I understand that this plan of work must receive approval in writing by the Geological Survey before operations may be commenced.

Company **El Paso Natural Gas Co.**
Address **Box 997**
Farmington, New Mexico
By **Original Signed EWELL N. WALSH**
Title **Petroleum Engineer**

NEW MEXICO
DEPARTMENT OF MINES AND METALLURGY
WELL LOCATION AND DEED PLAT

JANUARY 7, 1957

EL PASO NATURAL GAS COMPANY

DAIM

SF 078329

3

32

28 N

9 W

1750

SOUTH

990

WEST

SAN JUAN

6090

MESA VERDE

BLANCO

328.37 AC.
(1916 PLAT)

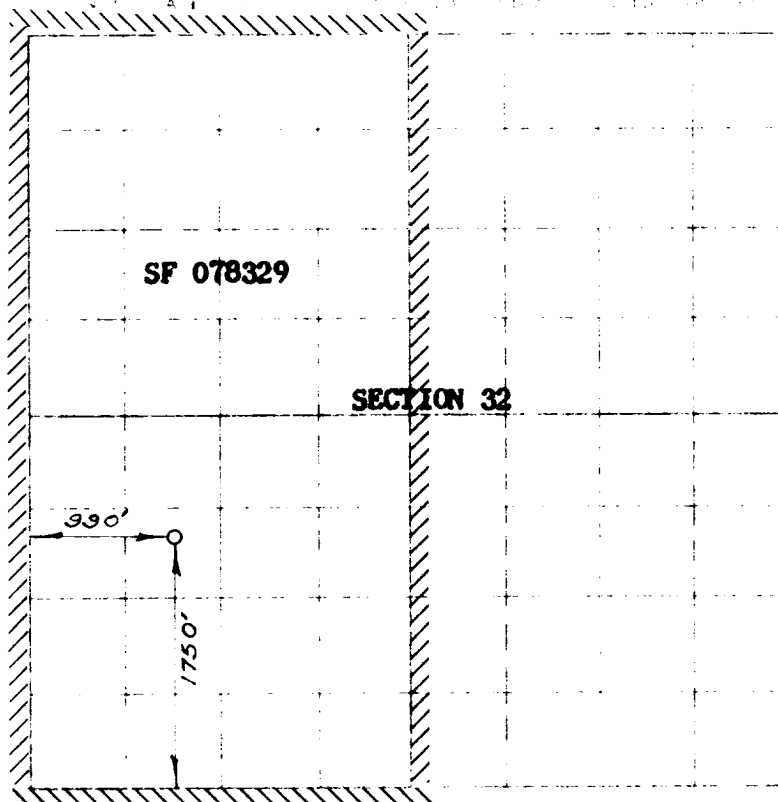

**NOTE: RE-ISSUED TO
SHOW CORRECT COUNTY.**

NOTE

This section of
form is to be used
for gas wells only

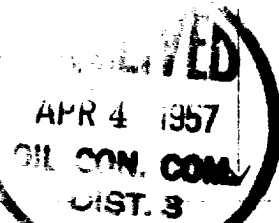

I hereby certify that the above plat was prepared from
field notes of actual survey made by me or under my
supervision, and that the same are true and correct to the
best of my knowledge and belief.

Date Surveyed **DECEMBER 19, 1956**

E. O. Walker
Registered Professional Engineer and/or Land Surveyor

1. Is this well a Productive well?
2. If the answer to Question 1 is yes, are there any other lands completely within the well's drainage field?

Name **Original Signed EWELL N. WALSH**

Position **Petroleum Engineer**

Representing **El Paso Natural Gas**

Address **Box 997 - Farmington, N.M.**

South

Farmington, New Mexico