

(SUBMIT IN TRIPLICATE)

Land Office Santa Fe

Lease No. 046563

UNITED STATES
DEPARTMENT OF THE INTERIOR
GEOLOGICAL SURVEY

Proj. Unit 2414 SEC. 33

SUNDRY NOTICES AND REPORTS ON WELLS

| | | | |
|--|-------------------------------------|--|--|
| NOTICE OF INTENTION TO DRILL | <input checked="" type="checkbox"/> | SUBSEQUENT REPORT OF WATER SHUT-OFF | |
| NOTICE OF INTENTION TO CHANGE PLANS | | SUBSEQUENT REPORT OF SHOOTING OR ACIDIZING | |
| NOTICE OF INTENTION TO TEST WATER SHUT-OFF | | SUBSEQUENT REPORT OF ALTERING CASING | |
| NOTICE OF INTENTION TO RE-DRILL OR REPAIR WELL | | SUBSEQUENT REPORT OF RE-DRILLING OR REPAIR | |
| NOTICE OF INTENTION TO SHOOT OR ACIDIZE | | SUBSEQUENT REPORT OF ABANDONMENT | |
| NOTICE OF INTENTION TO PULL OR ALTER CASING | | SUPPLEMENTARY WELL HISTORY | |
| NOTICE OF INTENTION TO ABANDON WELL | | | |

(INDICATE ABOVE BY CHECK MARK NATURE OF REPORT, NOTICE, OR OTHER DATA)

March 24, 1953

Well No. 1 is located 1560 ft. from N line and 950 ft. from W line of sec. 33

Sec. 33 (1/4 Sec. and Sec. No.) 28 N (Twp.) 10 W (Range) New Mexico Principal (Meridian)

Kutz Canyon (Field) San Juan (County or Subdivision) New Mexico (State or Territory)

The elevation of the derrick floor above sea level is 6292 ft.

DETAILS OF WORK

(State names of and expected depths to objective sands; show sizes, weights, and lengths of proposed casings; indicate mudding jobs, cementing points, and all other important proposed work)

Plan to drill 17 1/2 inch hole and set 100' of 2-5/8 inch 28# surface casing. The surface casing will be cemented to the top. Drill 7-7/8 inch hole under surface to a point about 5' below the top of the pictured cliffs sand expected at 2050' subsurface. Run electric log to confirm top of sand. Set 2050' of 5 1/2" 15# Production pipe into sand and cement with 100 sacks. Drill 1 1/2 inch hole with cable tools through Pictured Cliffs sand. Shoot pay section with approximately 130 quarts. Clean out, install Christmas tree, run approximately 2100' 1.66, 1" tubing, and shut in for pipe line connection.

I understand that this plan of work must receive approval in writing by the Geological Survey before operations may be commenced.

Company KUTZ CANYON OIL AND GAS COMPANY

Address 3. E. National Bank Bldg., Denver, Colo.

By R. P. Martin
Title Secretary



Company.....Texo Oil Company.....

Lease.....Well No.....

Sec.....33....., T.....28 N....., R.....10 W., N.M.P.M..

Location 1660' from the South line and 950' from
the West line.

Elevation 6092 Ungraded ground.....

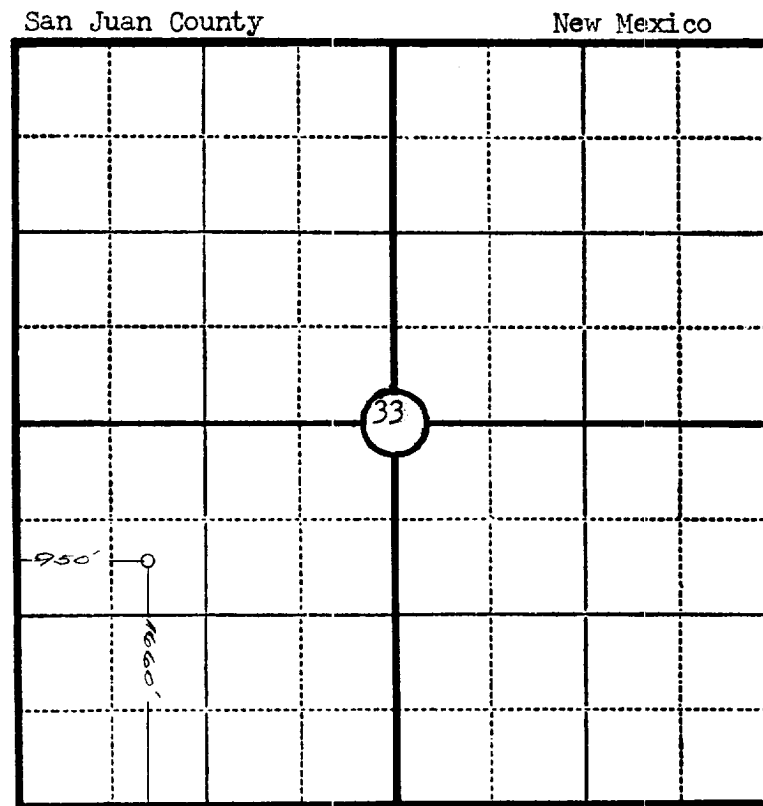

This is to certify that the above plat was prepared from field notes of actual surveys made by me or under my supervision and that the same are true and correct to the best of my knowledge and belief.

Ernest W. Echohawk

Seal:

Registered Professional
Engineer and Land Surveyor.

Ernest W. Echohawk
N. Mex. Reg. No. 1545

Surveyed March 25, 1953