

(SUBMIT IN TRIPLICATE)

UNITED STATES
DEPARTMENT OF THE INTERIOR
GEOLOGICAL SURVEY

Land Office Santa Fe
Lease No. 078329
Unit Deann

SUNDRY NOTICES AND REPORTS ON WELLS

NOTICE OF INTENTION TO DRILL	<input checked="" type="checkbox"/>	SUBSEQUENT REPORT OF WATER SHUT-OFF
NOTICE OF INTENTION TO CHANGE PLANS	<input type="checkbox"/>	SUBSEQUENT REPORT OF SHOOTING OR ACIDIZING
NOTICE OF INTENTION TO TEST WATER SHUT-OFF	<input type="checkbox"/>	SUBSEQUENT REPORT OF ALTERING CASING
NOTICE OF INTENTION TO RE-DRILL OR REPAIR WELL	<input type="checkbox"/>	SUBSEQUENT REPORT OF RE-DRILLING OR REPAIR
NOTICE OF INTENTION TO SHOOT OR ACIDIZE	<input type="checkbox"/>	SUBSEQUENT REPORT OF ABANDONMENT
NOTICE OF INTENTION TO PULL OR ALTER CASING	<input type="checkbox"/>	SUPPLEMENTARY WELL HISTORY
NOTICE OF INTENTION TO ABANDON WELL	<input type="checkbox"/>	

(INDICATE ABOVE BY CHECK MARK NATURE OF REPORT, NOTICE, OR OTHER DATA)

RECEIVED
AUG 2 1961
U.S. GEOLOGICAL SURVEY
DIRECTOR, NEW MEXICO

Well No. 6 is located 1150 ft. from N line and 500 ft. from E line of sec. 32
NW/4 Sec. 32 28N 9E N.M.P.M.
(1/4 Sec. and Sec. No.) (Twp.) (Range) (Meridian)
Basin Dakota San Juan New Mexico
(Field) (County or Subdivision) (State or Territory)

The elevation of the derrick floor above sea level is 6029 ft.

DETAILS OF WORK

(State names of and expected depths to objective sands; show sizes, weights, and lengths of proposed casings; indicate mudlogging jobs, cementing points, and all other important proposed work)

It is intended to drill a well with rotary tools thru the Dakota formation & to perforate and water fracture possible producing zones. Est. T. D. 6710'.

Casing Program:

10 3/4" at 260' with 220 sacks cement circulated to surface.
4 1/2" at 6710' with 2 stage tool set 50' below base of Point Lookout.
Third stage set 50' below base of Pictured Cliffs.
1st Stage - 290 sacks cement - 150% to cover 100' above Gallup top.
2nd Stage - 220 sacks cement - 150% to cover 100' above Cliff House top.
3rd Stage - 160 sacks - 200% to circulate.

The N/2 of Section 32 is dedicated to this well.

I understand that this plan of work must receive approval in writing by the Geological Survey before operations may be commenced.

Company El Paso Natural Gas Company

Address Box 990
Farmington, New Mexico

Original Signed D. W. Meehan
By _____
Title Petroleum Engineer

NEW MEXICO OIL CONSERVATION COMMISSION

Well Location and Acreage Dedication Plat

Section A.

Date **JULY 3, 1961**

Operator **EL PASO NATURAL GAS COMPANY** Lease **DAUM** SF **078329**
 Well No. **6** Unit Letter **D** Section **32** Township **28-N** Range **9-W** NMPM
 Located **1150** Feet From **NORTH** Line, **800** Feet From **WEST** Line
 County **SAN JUAN** G. L. Elevation **6019** Dedicated Acreage **320** Acres
 Name of Producing Formation **DAKOTA** Pool **BASIN DAKOTA**

1. Is the Operator the only owner in the dedicated acreage outlined on the plat below?

Yes ☒ No ☐2. If the answer to question one is "no", have the interests of all the owners been consolidated by communitization agreement or otherwise? Yes ☐ No ☐ If answer is "yes", Type of Consolidation.

3. If the answer to question two is "no", list all the owners and their respective interest below:

Owner

Land Description

Section B.

This is to certify that the information in Section A above is true and complete to the best of my knowledge and belief.

Original Signed D. W. Meehan
 (Operator)
 (Representative)

Box 127
 (Address)

Farmer, New Mexico

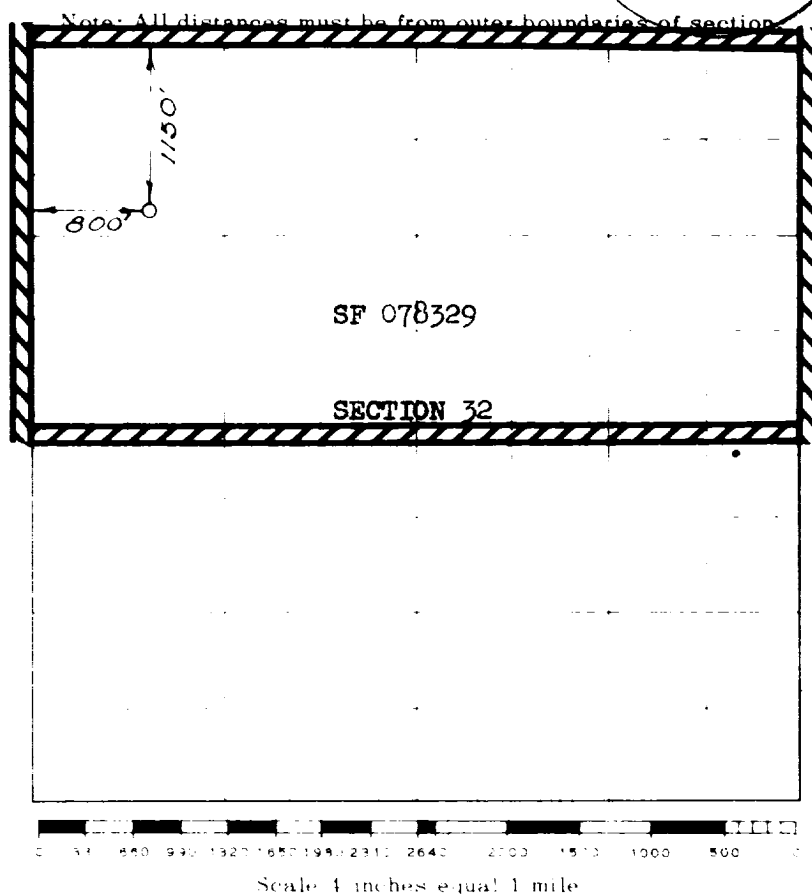

This is to certify that the above plat was prepared from field notes of actual surveys made by me or under my supervision and that the same are true and correct to the best of my knowledge and belief.

(Seal)

Date Surveyed **JUNE 14, 1961**

C. O. Walker
 Registered Professional Engineer and/or Land Surveyor

Farmington, New Mexico