

(SUBMIT IN TRIPLICATE)

UNITED STATES  
DEPARTMENT OF THE INTERIOR  
GEOLOGICAL SURVEY

Land Office Santa Fe  
Lease No. 077106  
Unit Lacey

## SUNDRY NOTICES AND REPORTS ON WELLS

NOTICE OF INTENTION TO DRILL.....	<input checked="" type="checkbox"/>	SUBSEQUENT REPORT OF WATER SHUT-OFF.....
NOTICE OF INTENTION TO CHANGE PLANS.....		SUBSEQUENT REPORT OF SHOOTING OR ACIDIZING.....
NOTICE OF INTENTION TO TEST WATER SHUT-OFF.....		SUBSEQUENT REPORT OF ALTERING CASING.....
NOTICE OF INTENTION TO RE-DRILL OR REPAIR WELL.....		SUBSEQUENT REPORT OF RE-DRILLING OR REPAIR.....
NOTICE OF INTENTION TO SHOOT OR ACIDIZE.....		SUBSEQUENT REPORT OF ABANDONMENT.....
NOTICE OF INTENTION TO PULL OR ALTER CASING.....		SUPPLEMENTARY WELL HISTORY.....
NOTICE OF INTENTION TO ABANDON WELL.....		

(INDICATE ABOVE BY CHECK MARK NATURE OF REPORT, NOTICE, OR OTHER DATA)

January 9, 1957

Well No. 11-B is located 890 ft. from N line and 1180 ft. from E line of sec. 30

NE Section 30  
(1/4 Sec. and Sec. No.) 28N 9W 10TH  
(Twp.) (Range) (Meridian)

Blanco San Juan New Mexico  
(Field) (County or Subdivision) (State or Territory)

The elevation of the derrick floor above sea level is 5956 ft.

### DETAILS OF WORK

(State names of and expected depths to objective sands; show sizes, weights, and lengths of proposed casings; indicate mudding jobs, cementing points, and all other important proposed work)

It is intended to drill a well with rotary tools thru the Mesa Verde formation. Mud circulation will be used thru the Pictured Cliffs and set intermediate casing. Gas circulation will be used thru the Mesa Verde and production casing will be set. Possible productive intervals will be perforated and fractured. Estimated T.D. 4570'.

#### Casing Program:

10 3/4" at 170' with 125 sacks cement circulated to the surface.  
7 5/8" at 2275' with 250 sacks cement.  
5 1/2" at 4570' with 150 sacks cement.

The N/2 of Section 30 is dedicated to this well.  
N/2 SF 077106.

I understand that this plan of work must receive approval in writing by the Geological Survey before operations may be commenced.

Company El Paso Natural Gas Company

Address Box 997

Farmington, N.M.

ORIGINAL SIGNED E. S. OBERLI

By \_\_\_\_\_

Title Petroleum Engineer

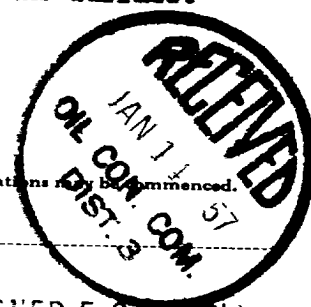



JANUARY 7, 1957

EL PASO NATURAL GAS COMPANY

LACKEY "B"

SF 077106

11

30

28 N

9 W

890

NORTH

1180

EAST

SAN JUAN

5946

MESA VERDE

BLANCO

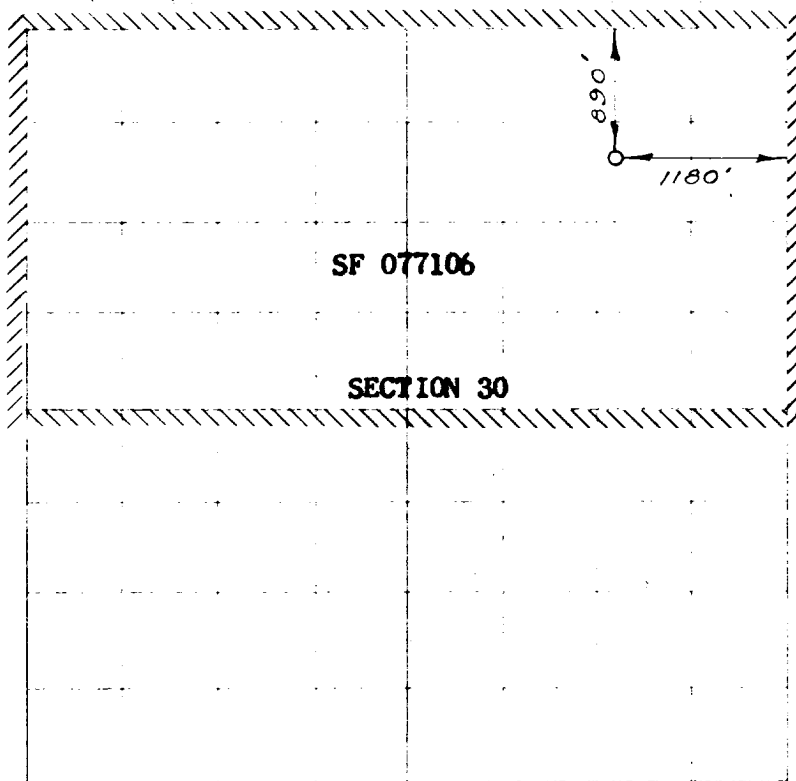
302.62 AC.  
(1916 PLAT)

Scale 1 inch = 40 feet

## NOTE

This plat is of  
 record and is  
 to be used only



I, the undersigned, being a duly qualified and licensed  
 surveyor of said State, do hereby certify that the  
 foregoing is a true and correct copy of the original  
 survey, and that the same is true and correct to the  
 best of my knowledge and belief.

Date Surveyed: **DECEMBER 19, 1956**

*E. O. Walker*  
 Registered Professional Engineer and Land Surveyor

1. Is this a Plat? ☒ Yes ☐ No

2. If this is a Plat, is it a

3. Is there any other land  
 owned by the same owner  
 as the land shown on this  
 plat?

4. Is there any other land  
 owned by the same owner  
 as the land shown on this  
 plat?

5. Is there any other land

6. Is there any other land

7. Is there any other land

8. Is there any other land

9. Is there any other land

10. Is there any other land

ORIGINAL SIGNED E. S. OBERLY

Petroleum Engineer

El Paso Natural Gas Co.

Box 997, Farmington, N.M.