

District I
P O Box 1980, Hobbs, NM

District II
P O Drawer DD, Artesia, NM 88221

District III
1000 Rio Brazos Rd, Aztec, NM 87410

State of New Mexico
Energy, Minerals and Natural Resources Department

OIL CONSERVATION DIVISION

2040 South Pacheco Street
Santa Fe, New Mexico 87505

SUBMIT 1 COPY TO
APPROPRIATE
DISTRICT OFFICE
AND 1 COPY TO
SANTA FE OFFICE

PIT REMEDIATION AND CLOSURE REPORT

Operator: <u>PNM Gas Services (Meridian)</u>		Telephone: <u>324-3764</u>	
Address: <u>603 W. Elm Street Farmington, NM 87401</u>			
Facility or Well Name: <u>Lackey Hubbel #1</u>			
Location:	Unit: <u>D</u>	Sec. <u>29</u>	T. <u>28 N</u> R. <u>10 W</u> County <u>San Juan</u>
Pit Type:	Separator <input type="checkbox"/>	Dehydrator <input type="checkbox"/>	Other <u>No PNM Equipment</u>
Land Type:	BLM <input checked="" type="checkbox"/>	State <input type="checkbox"/>	Fee <input type="checkbox"/> Other <input type="checkbox"/>

Pit Location:	Pit dimensions:	length <u>20</u>	width <u>20</u>	depth <u>3</u>
(Attach diagram)	Reference:	wellhead <input checked="" type="checkbox"/>	other <input type="checkbox"/>	
Footage from reference:		<u>237'</u>		
Direction from reference:		<u>82</u> Degrees	<input type="checkbox"/> East	North <input checked="" type="checkbox"/>
			<input checked="" type="checkbox"/> West	South <input type="checkbox"/>

Depth to Ground Water: (Vertical distance from contaminants to seasonal high water elevation of ground water)	Less than 50 feet	(20 points)	<u>0</u>
	50 feet to 99 feet	(10 points)	
	Greater than 100 feet	(0 points)	
Wellhead Protection Area: (Less than 200 feet from a private domestic water source, or, less than 1,000 feet from all other water sources)	Yes	(20 points)	<u>0</u>
	No	(0 points)	
Distance to Surface Water: (Horizontal distance to perennial lakes, ponds, rivers, streams, creeks, irrigation canals and ditches)	Less than 200 feet	(20 points)	<u>0</u>
	200 feet to 1,000 feet	(10 points)	
	Greater than 1,000 feet	(0 points)	
RANKING SCORE (TOTAL POINTS) :			<u>0</u>

Date Remediation Started:		<u>9/27/96</u>		Date Completed:		<u>9/30/96</u>	
Remediation Method: (Check all appropriate sections)	Excavation	<u>X</u>	Approx. Cubic Yard		<u>222</u>		
	Landfarmed	<u>X</u>	Amount Landfarmed (cubic yds)		<u>162</u>		
	Other	<u></u>					
Remediation Location:		Onsite	<u>X</u>	Offsite	<u></u>		
(i.e., landfarmed onsite, name and location of offsite facility)							
Backfill Material Location: <u></u>							
General Description of Remedial Action:							
Excavated contaminated soil to pit size 22'x13'x21' and landfarmed soil onsite within a bermed area at a depth of 6" to 12'. Soil was aerated by plowing/disking until soil met regulatory levels.							
<u></u>							
<u></u>							
<u></u>							
<u></u>							
<u></u>							
Ground Water Encountered:		No	<u>✓</u>	Yes	<u></u>		
				Depth	<u></u>		

Final Pit Closure Sampling: (if multiple samples, attach sample result and diagram of sample locations and depths.)	Sample Location	<u>5 pt composite-4 side walls and center of pit bottom</u>					
	Sample depth	<u>21'</u>					
	Sample date	<u>9/27/96</u>		Sample time	<u>11:50:00 AM</u>		
	Sample Results						
	Benzene (ppm)	<u>< 0.0002</u>					
	Total BTEX (ppm)	<u>0.1255</u>					
	Field headspace (ppm)	<u></u>					
	TPH	<u><</u>	<u>5.0</u>	Method	<u>8015A</u>		
Vertical Extent (ft)		<u></u>		Risk Assessment form attached	Yes	No	<u>✓</u>
Ground Water Sample:		Yes	<u></u>	No	<u>✓</u>	(If yes, attach sample results)	

I HEREBY CERTIFY THAT THE INFORMATION ABOVE IS TRUE AND COMPLETE TO THE BEST OF MY KNOWLEDGE AND MY BELIEF

DATE January 22, 1997

SIGNATURE

Denver Bearden

PRINTED NAME
AND TITLE

Denver Bearden
Administrator III

Lacey Hubble #1

↑
N

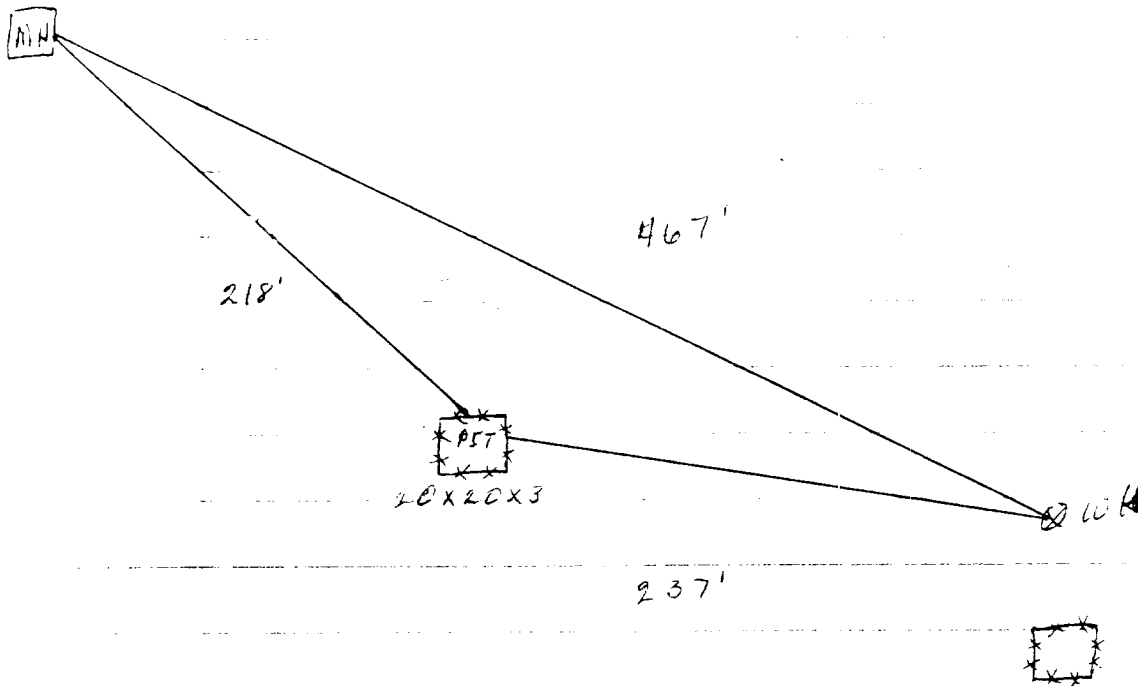

OFF: (505) 325-5667



LAB: (505) 325-1556

Diesel Range Organics

Attn: *Denver Bearden*
 Company: *PNM Gas Services*
 Address: *603 W. Elm*
 City, State: *Farmington, NM 87401*

Date: *1-Oct-96*
 COC No.: *5406*
 Sample No. *12393*
 Job No. *2-1000*

Project Name: ***PNM Gas Services - Lackey Hubble #1***
 Project Location: ***9609271150; Pit Excavation Composite Sample***
 Sampled by: *RH* Date: *27-Sep-96* Time: *1:50*
 Analyzed by: *HR/DC* Date: *1-Oct-96*
 Sample Matrix: *Soil*

Laboratory Analysis

<i>Parameter</i>	<i>Result</i>	<i>Unit of Measure</i>	<i>Detection Limit</i>	<i>Unit of Measure</i>
<i>Diesel Range Organics (C10 - C28)</i>	<i>< 5.0</i>	<i>mg/kg</i>	<i>5.0</i>	<i>mg/kg</i>

Quality Assurance ReportDRO QC No.: *0489-QC****Calibration Check***

<i>Parameter</i>	<i>Method Blank</i>	<i>Unit of Measure</i>	<i>True Value</i>	<i>Analyzed Value</i>	<i>% Diff</i>	<i>Limit</i>
<i>Diesel Range (C10 - C28)</i>	<i>< 5.0</i>	<i>ppm</i>	<i>100</i>	<i>91</i>	<i>9.1</i>	<i>15 %</i>

Matrix Spike

<i>Parameter</i>	<i>1 - Percent Recovered</i>	<i>2 - Percent Recovered</i>	<i>Limit</i>	<i>%RSD</i>	<i>Limit</i>
<i>Diesel Range (C10-C28)</i>	<i>99</i>	<i>100</i>	<i>(70-130)</i>	<i>1</i>	<i>20%</i>

Method - SW-846 EPA Method 8015A mod. - Nonhalogenated Volatile Hydrocarbons by Gas Chromatography

Approved by:
 Date:

OFF: (505) 325-5667



LAB: (505) 325-1556

AROMATIC VOLATILE ORGANICS

Attn: *Denver Bearden*
Company: *PNM Gas Services*
Address: *603 W. Elm*
City, State: *Farmington, NM 87401*

Date: *2-Oct-96*
COC No.: *5406*
Sample No.: *12393*
Job No.: *2-1000*

Project Name: ***PNM Gas Services - Lackey Hubble #1***
Project Location: ***9609271150; Pit Excavation Composite Sample***
Sampled by: *RH* Date: *27-Sep-96* Time: *11:50*
Analyzed by: *DC* Date: *1-Oct-96*
Sample Matrix: *Soil*

Laboratory Analysis

Parameter	Result	Unit of Measure	Detection Limit	Unit of Measure
<i>Benzene</i>	<i><0.2</i>	<i>ug/kg</i>	<i>0.2</i>	<i>ug/kg</i>
<i>Toluene</i>	<i>12.0</i>	<i>ug/kg</i>	<i>0.2</i>	<i>ug/kg</i>
<i>Ethylbenzene</i>	<i>8.0</i>	<i>ug/kg</i>	<i>0.2</i>	<i>ug/kg</i>
<i>m,p-Xylene</i>	<i>68.4</i>	<i>ug/kg</i>	<i>0.2</i>	<i>ug/kg</i>
<i>o-Xylene</i>	<i>37.1</i>	<i>ug/kg</i>	<i>0.2</i>	<i>ug/kg</i>
	<i>TOTAL</i>	<i>125.5</i>		<i>ug/kg</i>

Method - SW-846 EPA Method 8020 Aromatic Volatile Organics by Gas Chromatography

Approved by: *[Signature]*
Date: *10/2/96*

Lackey Hubbell #1
meridian
Sec. 29, 28N, 10W

11-12-96

Land Farm: Newman A-8E
Sec. 19, 28N, 10W

Composite sample # 9611121015

soil vapor headspace PID reading = 6.9 ppm

2"-12" depth

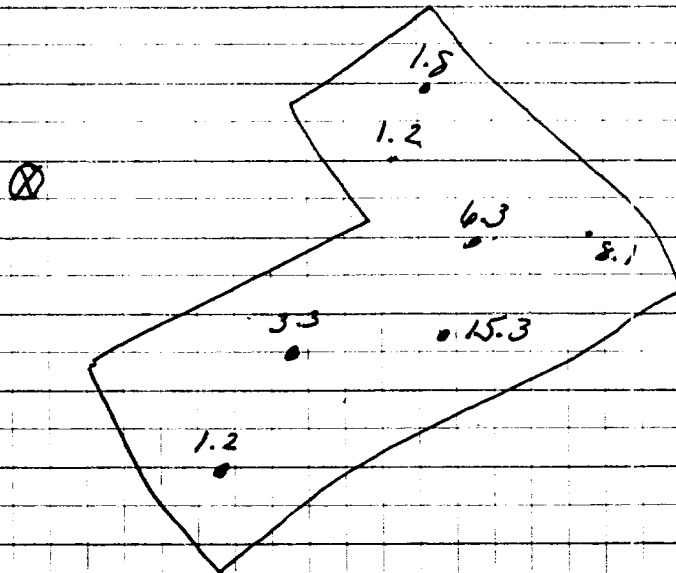

OFF: (505) 325-5667



LAB: (505) 325-1556

Diesel Range Organics

Attn: *Denver Bearden*
Company: *PNM Gas Services*
Address: *603 W. Elm*
City, State: *Farmington, NM 87401*

Date: *14-Nov-96*
COC No.: *5084*
Sample No. *12842*
Job No. *2-1000*

Project Name: ***PNM Gas Services - Lackey Hubbell #1 Landfarm @ Newman A-8E***
Project Location: ***9611121015; 6pt. Composite, 2"-12" depth***
Sampled by: *GC* Date: *12-Nov-96* Time: *10:15*
Analyzed by: *DC/HR* Date: *13-Nov-96*
Sample Matrix: *Soil*

Laboratory Analysis

<i>Parameter</i>	<i>Result</i>	<i>Unit of Measure</i>	<i>Detection Limit</i>	<i>Unit of Measure</i>
<i>Diesel Range Organics (C10 - C28)</i>	<i><5.0</i>	<i>mg/kg</i>	<i>5.0</i>	<i>mg/kg</i>

Quality Assurance Report

DRO QC No.: *0512-QC*

Calibration Check

<i>Parameter</i>	<i>Method Blank</i>	<i>Unit of Measure</i>	<i>True Value</i>	<i>Analyzed Value</i>	<i>% Diff</i>	<i>Limit</i>
<i>Diesel Range (C10 - C28)</i>	<i><5.0</i>	<i>ppm</i>	<i>100</i>	<i>100</i>	<i>0.5</i>	<i>15%</i>

Matrix Spike

<i>Parameter</i>	<i>1 - Percent Recovered</i>	<i>2 - Percent Recovered</i>	<i>Limit</i>	<i>%RSD</i>	<i>Limit</i>
<i>Diesel Range (C10-C28)</i>	<i>93</i>	<i>92</i>	<i>(70-130)</i>	<i>1</i>	<i>20%</i>

Method - SW-846 EPA Method 8015A mod. - Nonhalogenated Volatile Hydrocarbons by Gas Chromatography

Approved by: *[Signature]*
Date: *11/14/96*

P.O. BOX 2606 • FARMINGTON, NM 87499

- TECHNOLOGY BLENDING INDUSTRY WITH THE ENVIRONMENT -