

NEW MEXICO OIL CONSERVATION COMMISSION

SANTA FE, NEW MEXICO

7-3-58

APPLICATION FOR DUAL COMPLETION

Field Name Astec Pictured Cliffs & Blanco Mesa Verde		County San Juan		Date June 9, 1959
Operator El Paso Natural Gas Company		Lease Huncock		Well No. 3 (FM)
Location of Well M	Unit 22	Section 28N	Township 9N	Range 9N

1. Has the New Mexico Oil Conservation Commission heretofore authorized the dual completion of a well in these same pools or in the same zones within one mile of the subject well? YES ☒ NO ☐
2. If answer is yes, identify one such instance: Order No. **DC-468** ; Operator, Lease, and Well No.:

Lackey No. 10-B (FM)

3. The following facts are submitted:	Upper Zone	Lower Zone
a. Name of reservoir	Pictured Cliffs	Mesa Verde
b. Top and Bottom of Pay Section (Perforations)	3258-3290	5274-5454 (Narrowfee) 5546-5706 (Point Lookout)
c. Type of production (Oil or Gas)	Gas	Gas
d. Method of Production (Flowing or Artificial Lift)	Flowing	Flowing

4. The following are attached. (Please mark YES or NO)

- Yes** a. Diagrammatic Sketch of the Dual Completion, showing all casing strings, including size and setting, top of cement, perforated intervals, tubing strings, including diameters and setting depth, location and type of packers and side door chokes, and such other information as may be pertinent.
- Yes** b. Plat showing the location of all wells on applicant's lease, all offset wells on offset leases, and the names and addresses of operators of all leases offsetting applicant's lease.
- No** c. Waivers consenting to such dual completion from each offset operator, or in lieu thereof, evidence that said offset operators have been furnished copies of the application.*
- No** d. Electrical log of the well or other acceptable log with tops and bottoms of producing zones and intervals of perforation indicated thereon. (If such log is not available at the time application is filed, it shall be submitted as provided by Rule 112-A.)

5. List all offset operators to the lease on which this well is located together with their correct mailing address.

Southern Union Gas Company

6. Were all operators listed in Item 5 above notified and furnished a copy of this application? YES ☒ NO ☐ . If answer is yes, give date of such notification _____ .

CERTIFICATE: I, the undersigned, state that I am the **Division Petroleum Engr.** of the **El Paso Natural Gas Co.** (company), and that I am authorized by said company to make this report; and that this report was prepared under my supervision and direction and that the facts stated therein are true, correct and complete to the best of my knowledge.

ORIGINAL SIGNED E. S. OBERLY

Signature

- * Should waivers from all offset operators not accompany an application for administrative approval, the New Mexico Oil Conservation Commission will hold the application for a period of twenty (20) days from date of receipt by the Commission's Santa Fe office. If, after said twenty-day period, no protest nor request for hearing is received by the Santa Fe office, the application will then be processed.
- NOTE: If the proposed dual completion will result in an unorthodox well location and/or a non-standard proration unit in either or both of the producing zones, then separate application for approval of the same should be filed simultaneously with this application.

STATE OF NEW MEXICO)
)
COUNTY OF SAN JUAN)

I, D. H. Oheim, being first duly sworn upon my oath
depose and say as follows:

I am an employee of El Paso Natural Gas Company, and
that on May 13, 1959, I was called to the location of the El Paso
Natural Gas Company Hancock No. 3 (PM) Well located in the SWSW/4 of
Section 22, Township 28 North, Range 9 West, N.M.P.M., for advisory
service in connection with installation of a production packer. In
my presence, a Baker Model "EGJ" Production Packer was set in this
well at 3488 feet in accordance with the usual practices and customs
of the industry.

D. H. Oheim

Subscribed and sworn to before me this 10th day of
June, 1959.

[Signature]
Notary Public in and for San Juan
County, New Mexico

My commission expires February 24, 1960.



**SCHEMATIC DIAGRAM OF DUALY COMPLETED
El Paso Natural Gas Co. Hancock No. 3 (FM)
SWSW Section 22, T-28-N, R-9-W**

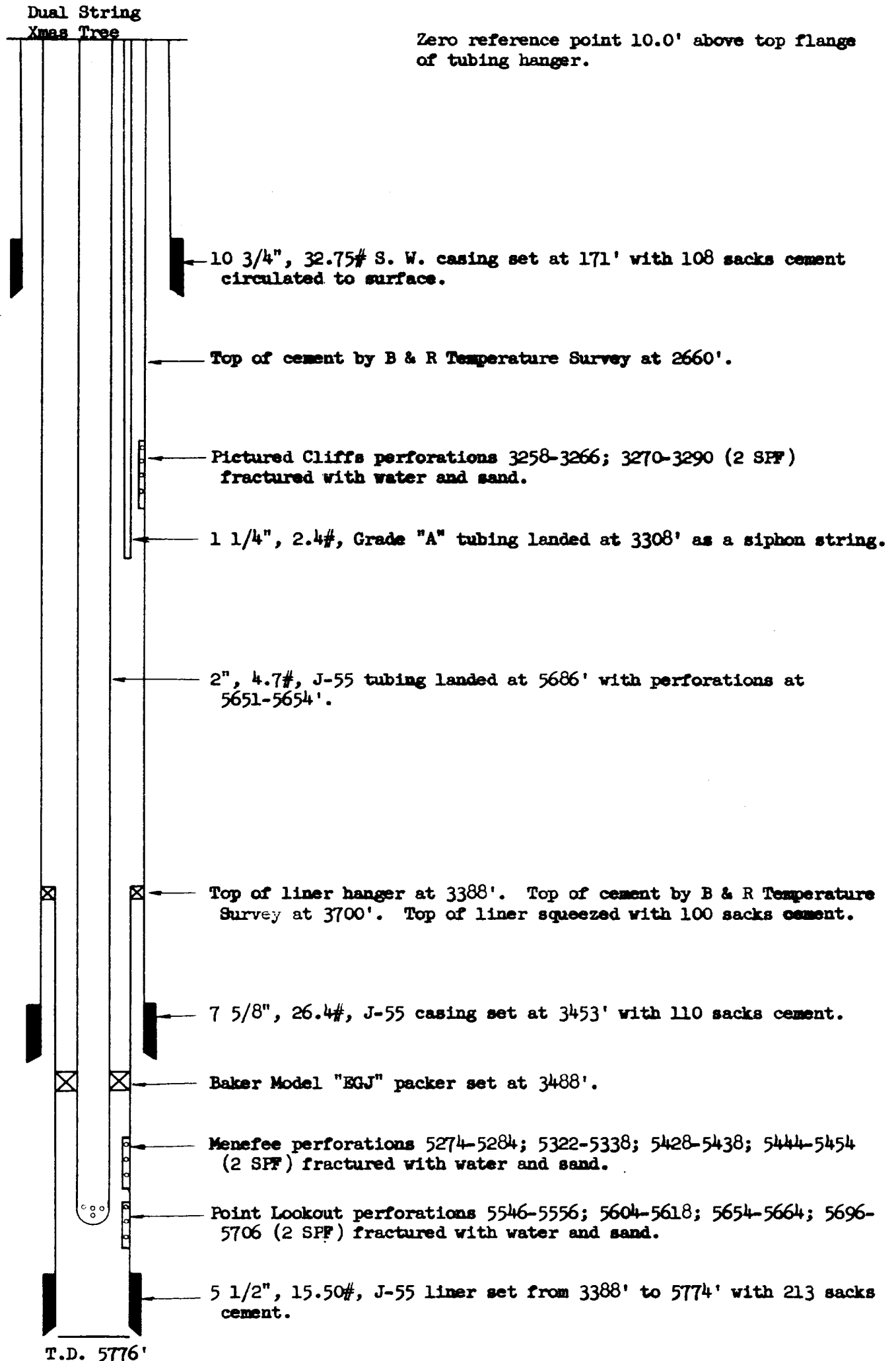

Plat Showing Location of Dually Completed
El Paso Natural Gas Co. Hancock No. 3 (FM)
and Offset Acreage

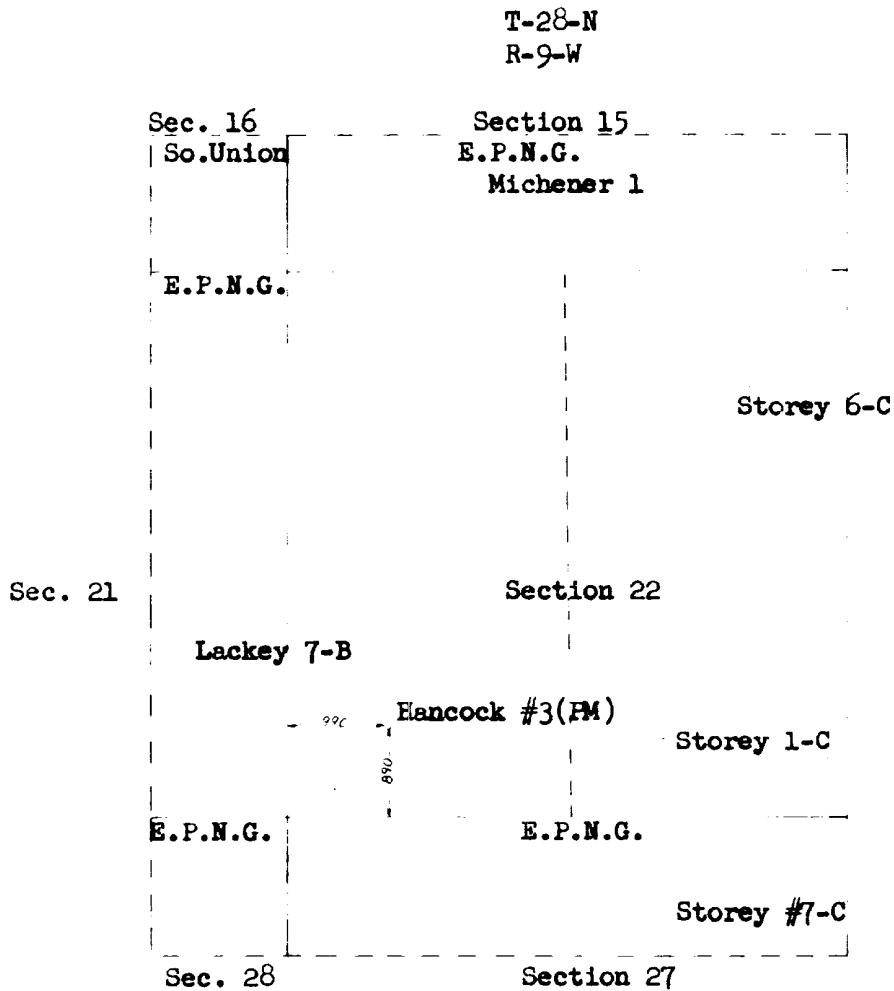

EL PASO NATURAL GAS COMPANY
EL PASO, TEXAS

SCALE

DATE

No.

DRAWN BY

CHECKED BY

OPEN FLOW TEST DATA

DUAL COMPLETION

May 20, 1959

El Paso Natural Gas		Hancock No. 3 (M)	
890S, 990W; 22-28-9		San Juan New Mexico	
Mesa Verde		Blanco	
7-5/8	3353	2"	5677
5274	5706	5776 c/o 5726	Shut In: 5/13/59
Sand Water Frac.		X	

.75	12.365	5-1/2 liner 3388 - 5774	
677 (PC)	689	7	949 (MV) 961
177	189	Calc.	379
61	.75	1.021	.709

Initial SIPT (PC) = 675 psig

Packer at 3488

Final SIPC (PC) = 679 psig

$$12.365 \times 189 \times .9990 \times .9225 \times 1.021$$

2199

923521
779880

$$1.1841^{.75} \times 2199 = 1.1352 \times 2199$$

Unloaded heavy spray after 4 min. continued
slugging liquid through-out test.

2496

M. W. Rischard

Lewis D. Galloway
L. D. Galloway

OPEN FLOW TEST DATA

DUAL COMPLETION

DATE May 27, 1959

El Paso Natural Gas	Hancock No. 3 (P)
890S, 990W; 22-22-9	San Juan New Mexico
Pictured Cliffs	Aztec
7-5/8 3353	1-1/4 3298
3258 3290	5776 c/o 5726 Shut In 5/13/59
Sand Water Frac.	X

.75	12.365	5-1/2 liner 3388-5774
714 726 14	714 726	
230 242	241 253	
65 .85	1.021 .638	

Initial SIPT (MV) = 894 psig
Final SIPT (MV) = 906 psig

Packer at 3488

$$12.365 \times 242 \times .9952 \times .9721 \times 1.021$$

2956

527076
463067

$$1.1382^{.85} \times 2956 = 1.1163 \times 2956$$

3300

Jesse B. Goodwin

Checked By M. W. Rischard

Lewis D. Galloway
L. D. Galloway