

(SUBMIT IN TRIPLICATE)

UNITED STATES  
DEPARTMENT OF THE INTERIOR  
GEOLOGICAL SURVEY

Land Office Santa Fe  
Lease No. 077106  
Unit Lacey

SUNDRY NOTICES AND REPORTS ON WELLS

NOTICE OF INTENTION TO DRILL.....	<input checked="" type="checkbox"/>	SUBSEQUENT REPORT OF WATER SHUT-OFF.....
NOTICE OF INTENTION TO CHANGE PLANS.....	<input type="checkbox"/>	SUBSEQUENT REPORT OF SHOOTING OR ACIDIZING.....
NOTICE OF INTENTION TO TEST WATER SHUT-OFF.....	<input type="checkbox"/>	SUBSEQUENT REPORT OF ALTERING CASING.....
NOTICE OF INTENTION TO RE-DRILL OR REPAIR WELL.....	<input type="checkbox"/>	SUBSEQUENT REPORT OF RE-DRILLING OR REPAIR.....
NOTICE OF INTENTION TO SHOOT OR ACIDIZE.....	<input type="checkbox"/>	SUBSEQUENT REPORT OF ABANDONMENT.....
NOTICE OF INTENTION TO PULL OR ALTER CASING.....	<input type="checkbox"/>	SUPPLEMENTARY WELL HISTORY.....
NOTICE OF INTENTION TO ABANDON WELL.....	<input type="checkbox"/>	

(INDICATE ABOVE BY CHECK MARK NATURE OF REPORT, NOTICE, OR OTHER DATA)

April 20, 1956

Well No. 5-B is located 900 ft. from 144 line and 1000 ft. from E line of sec. 20

1/4 Section 20  
(1/4 Sec. and Sec. No.)

20N  
(Twp.)

7E  
(Range)

NMNM  
(Meridian)

Artec P.C.  
(Field)

San Juan  
(County or Subdivision)

New Mexico  
(State or Territory)

The elevation of the derrick floor above sea level is 5934 ft.

DETAILS OF WORK

(State names of and expected depths to objective sands; show sizes, weights, and lengths of proposed casings; indicate mudding jobs, cementing points, and all other important proposed work)

It is intended to drill a well thru the Pictured Cliff formation using rotary tools to the casing point and to drill the pay section with cable tools and to water fracture the entire pay section. Est. T.D. 2200'.

Casing Program:

9 5/8" at 120' with 125 sacks regular cement circulated to surface  
5 1/2" at 2200' with 75 sacks regular cement, 75 sacks foam

The SE/4 of Section 20 is dedicated to this well.  
SE/4 of 077106.

I understand that this plan of work must receive approval in writing by the Geological Survey before operations may be commenced.

Company El Paso Natural Gas Company

Address Box 907  
Parlington, New Mexico

By [Signature]  
Title Petroleum Engineer

APRIL 19, 1956

EL PASO NATURAL GAS COMPANY

LACKEY "B"

SF 077106

5

20

28-N

2-W

900

**SOUTH**

1050

**EAST**

SAN JUAN

5924

PICTURED CLIFF

AZTEC P.C.

16C  
(1916 PLAT)

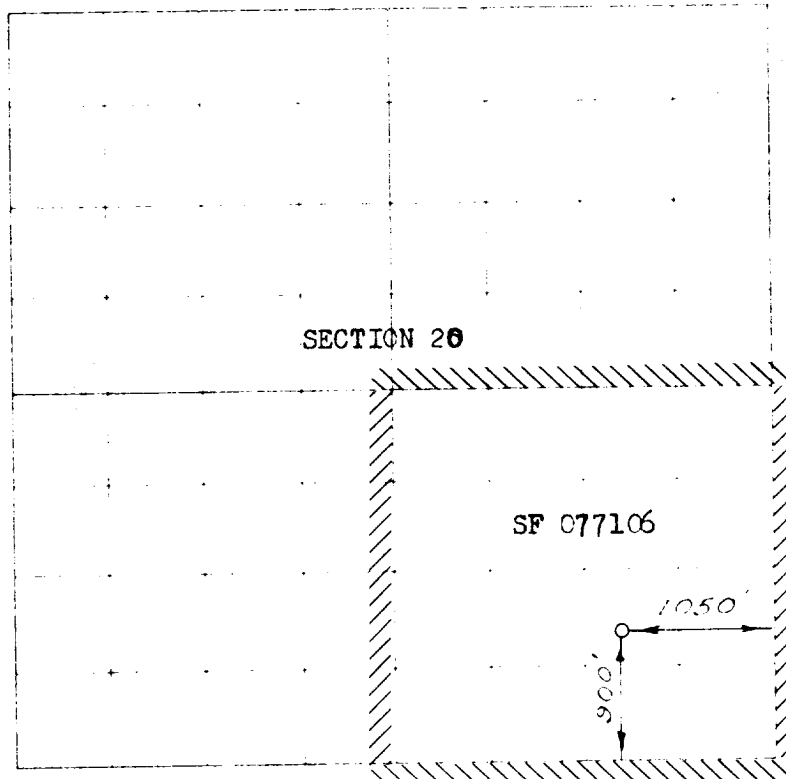

There is a growing emphasis on the importance of the role of the family in the development of the child. The family is the primary socialization agent for the child, and its structure and functioning have a profound influence on the child's development. The family is also the primary source of emotional support and security for the child. The family is the first and most important social environment for the child, and its influence is lifelong. The family is the primary source of the child's identity and self-concept. The family is the primary source of the child's values and beliefs. The family is the primary source of the child's social skills and social behavior. The family is the primary source of the child's emotional and psychological well-being. The family is the primary source of the child's physical and mental health. The family is the primary source of the child's education and learning. The family is the primary source of the child's social and cultural heritage. The family is the primary source of the child's future success and happiness. The family is the primary source of the child's life and meaning. The family is the primary source of the child's love and affection. The family is the primary source of the child's hope and dreams. The family is the primary source of the child's faith and belief. The family is the primary source of the child's strength and courage. The family is the primary source of the child's resilience and perseverance. The family is the primary source of the child's compassion and empathy. The family is the primary source of the child's kindness and generosity. The family is the primary source of the child's honesty and integrity. The family is the primary source of the child's respect and dignity. The family is the primary source of the child's freedom and independence. The family is the primary source of the child's responsibility and accountability. The family is the primary source of the child's leadership and influence. The family is the primary source of the child's creativity and innovation. The family is the primary source of the child's passion and enthusiasm. The family is the primary source of the child's joy and happiness. The family is the primary source of the child's love and life.

APRIL 13, 1956

*C. O. Walker*  
Registered Professional Engineer ~~XXX~~ License No. 15460

[illegible]

Paul H. Walsh

**Petroleum Engineer**

**El Paso Natural Gas Co.**

Box 997, Farmington, N.M.