

(SUBMIT IN TRIPLICATE)

UNITED STATES
DEPARTMENT OF THE INTERIOR
GEOLOGICAL SURVEY

Land Office Santa Fe
Lease No. 077106
Unit Lacey

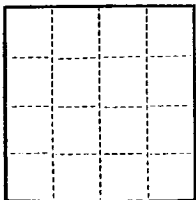

SUNDRY NOTICES AND REPORTS ON WELLS

NOTICE OF INTENTION TO DRILL.....	<input checked="" type="checkbox"/>	SUBSEQUENT REPORT OF WATER SHUT-OFF.....	
NOTICE OF INTENTION TO CHANGE PLANS.....		SUBSEQUENT REPORT OF SHOOTING OR ACIDIZING.....	
NOTICE OF INTENTION TO TEST WATER SHUT-OFF.....		SUBSEQUENT REPORT OF ALTERING CASING.....	
NOTICE OF INTENTION TO RE-DRILL OR REPAIR WELL.....		SUBSEQUENT REPORT OF RE-DRILLING OR REPAIR.....	
NOTICE OF INTENTION TO SHOOT OR ACIDIZE.....		SUBSEQUENT REPORT OF ABANDONMENT.....	
NOTICE OF INTENTION TO PULL OR ALTER CASING.....		SUPPLEMENTARY WELL HISTORY.....	
NOTICE OF INTENTION TO ABANDON WELL.....			

(INDICATE ABOVE BY CHECK MARK NATURE OF REPORT, NOTICE, OR OTHER DATA)

September 5, 1956

Well No. 7-B is located 1700 ft. from S line and 1061 ft. from E line of sec. 21
SE Section 21 20N 9W 106M
 (1/4 Sec. and Sec. No.) (Twp.) (Range) (Meridian)
Astec P.C. San Juan New Mexico
 (Field) (County or Subdivision) (State or Territory)

The elevation of the derrick floor above sea level is 7055 ft.

DETAILS OF WORK

(State names of and expected depths to objective sands; show sizes, weights, and lengths of proposed casings; indicate mudding jobs, cementing points, and all other important proposed work)

It is intended to drill a well thru the Pictured Cliff formation using rotary tools and to perforate and water fracture possible producing zones. Estimated Total Depth 3300'.

Casing Program;

9 5/8" at 120' with 125 sacks regular cement circulated to surface.
5 1/2" at 3300' with 75 sacks regular cement, 75 sacks Pozmix.

The SE/4 of Section 21 is dedicated to this well.
SE/4 (SF 077106).

I understand that this plan of work must receive approval in writing by the Geological Survey before operations may be commenced.

Company El Paso Natural Gas Company

Address Box 997
Farmington, New Mexico

By W. F. Carr
Title Petroleum Engineer

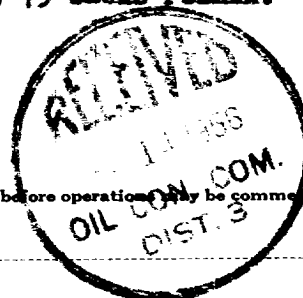

NEW MEXICO
OIL CONSERVATION COMMISSION

Form No. 1

WELL LOCATION AND/OR GAS PRORATION PLAT

AUGUST 23, 1956

EL PASO NATURAL GAS COMPANY

LACKEY "B"

SF 077106

SECTION 7 21 28-N 9-W

1700 SOUTH 1061 EAST

SAN JUAN

6995

PICTURED CLIFF

AZTEC

160 ACRES
(1919 PLAT)

Note: All distances must be from outer boundaries of section.

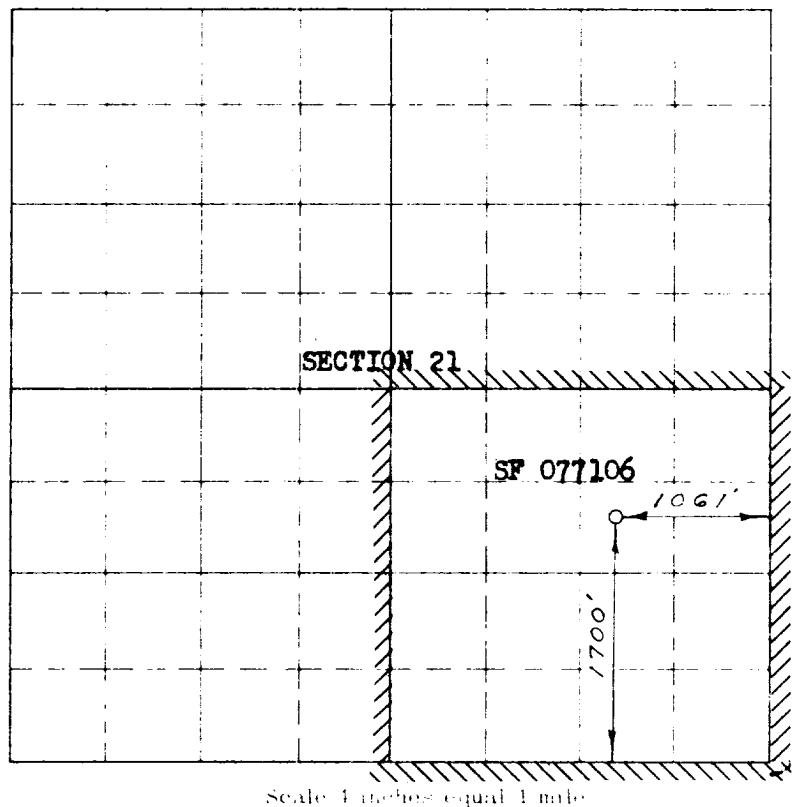

NOTE

This section of
form is to be used
for gas wells only

This is to certify that the above plat was prepared from
field notes of actual surveys made by me or under my
supervision and that the same are true and correct to the
best of my knowledge and belief.

Date Surveyed JULY 6, 1956

E. O. Walker
Registered Professional Engineer and/or Land Surveyor

1. Is this well a Dual Comp.

Yes _____ No X

2. If the answer to Question 1

is yes, are there any other dually
completed wells within the
dedicated acreage.

Yes _____ No _____

Name W. F. Court

Position Petroleum Engineer

Representing El Paso Natural Gas Co.

Address Box 997, Farmington, N.M.

(Seal)

Farmington, New Mexico