

(SUBMIT IN TRIPLICATE)

UNITED STATES
DEPARTMENT OF THE INTERIOR
GEOLOGICAL SURVEY

Land Office Santa Fe
Lease No. SF - 077106
Unit W/2 Sec. 20

SUNDRY NOTICES AND REPORTS ON WELLS

NOTICE OF INTENTION TO DRILL.....	<input checked="" type="checkbox"/>	SUBSEQUENT REPORT OF WATER SHUT-OFF.....	
NOTICE OF INTENTION TO CHANGE PLANS.....		SUBSEQUENT REPORT OF SHOOTING OR ACIDIZING.....	
NOTICE OF INTENTION TO TEST WATER SHUT-OFF.....		SUBSEQUENT REPORT OF ALTERING CASING.....	
NOTICE OF INTENTION TO RE-DRILL OR REPAIR WELL.....		SUBSEQUENT REPORT OF RE-DRILLING OR REPAIR.....	
NOTICE OF INTENTION TO SHOOT OR ACIDIZE.....		SUBSEQUENT REPORT OF ABANDONMENT.....	
NOTICE OF INTENTION TO PULL OR ALTER CASING.....		SUPPLEMENTARY WELL HISTORY.....	
NOTICE OF INTENTION TO ABANDON WELL.....			

(INDICATE ABOVE BY CHECK MARK NATURE OF REPORT, NOTICE, OR OTHER DATA)

July 19, 1960

Delhi-Lacey
Well No. 2 is located 1690 ft. from (N) line and 1690 ft. from (W) line of sec. 20
SW/4 Sec. 20 (1/4 Sec. and Sec. No.) 18-N (Twp.) 9-W (Range) NMPM (Meridian)
Undes. Dakota (Field) San Juan (County or Subdivision) New Mexico (State or Territory)

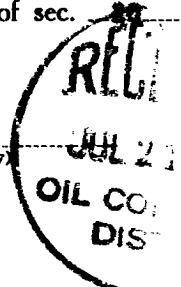

Ungraded G. L.
The elevation of the ~~16111/101~~ above sea level is 5895 ft.

DETAILS OF WORK

(State names of and expected depths to objective sands; show sizes, weights, and lengths of proposed casings; indicate mudding jobs, cementing points, and all other important proposed work)

We propose to drill w/rotary tools using mud to base of Dakota set production string w/DV tool 50' below base of Pictured Cliff formation cement lower stage TD to above Gallup formation and top stage over P. C. Perforate and fracture for completion in Dakota. Casing Program:

- Approx. 250' - 9-5/8" 36# J-55 SS casing - Cemented TD to surface.
- " 7000' - 5-1/2" 17# J-55 SS casing - Cemented w/350 ex.
- " 7000' - 2" EUE Tubing.

I understand that this plan of work must receive approval in writing by the Geological Survey before operations may be commenced.

Company Delhi-Taylor Oil Corporation
Address P. O. Drawer 1198
Farmington, New Mexico
By J. E. Howell
Title Dist. Supt.

NEW MEXICO OIL CONSERVATION COMMISSION
WELL LOCATION AND ACREAGE DEDICATION PLAT

FORM C-128
 Revised 5/1/57

SEE INSTRUCTIONS FOR COMPLETING THIS FORM ON THE REVERSE SIDE

SECTION A

Operator DELHI TAYLOR OIL CORPORATION		Lease DELHI - LACKEY		Well No. 2
Unit Letter K	Section 20	Township 28 NORTH	Range 9 WEST	County SAN JUAN
Actual Footage Location of Well: 1650 feet from the SOUTH line and 1650 feet from the WEST line				
Ground Level Elev. 5855.0	Producing Formation DAKOTA	Pool Undesignated	Dedicated Acreage: 1/3 Sec. 20 Acres	

Ref: GLO plat dated 23 June 1960

- Is the Operator the only owner in the dedicated acreage outlined on the plat below? YES NO ("Owner" means the person who has the right to drill into and to produce from any pool and to appropriate the production either for himself or for himself and another. (65-3-29 (e) NMSA 1935 Comp.)
- If the answer to question one is "no," have the interests of all the owners been consolidated by communitization agreement or otherwise? YES NO . If answer is "yes," Type of Consolidation _____
- If the answer to question two is "no," list all the owners and their respective interests below:

Owner	Land Description

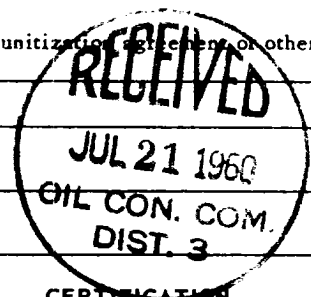

SECTION B

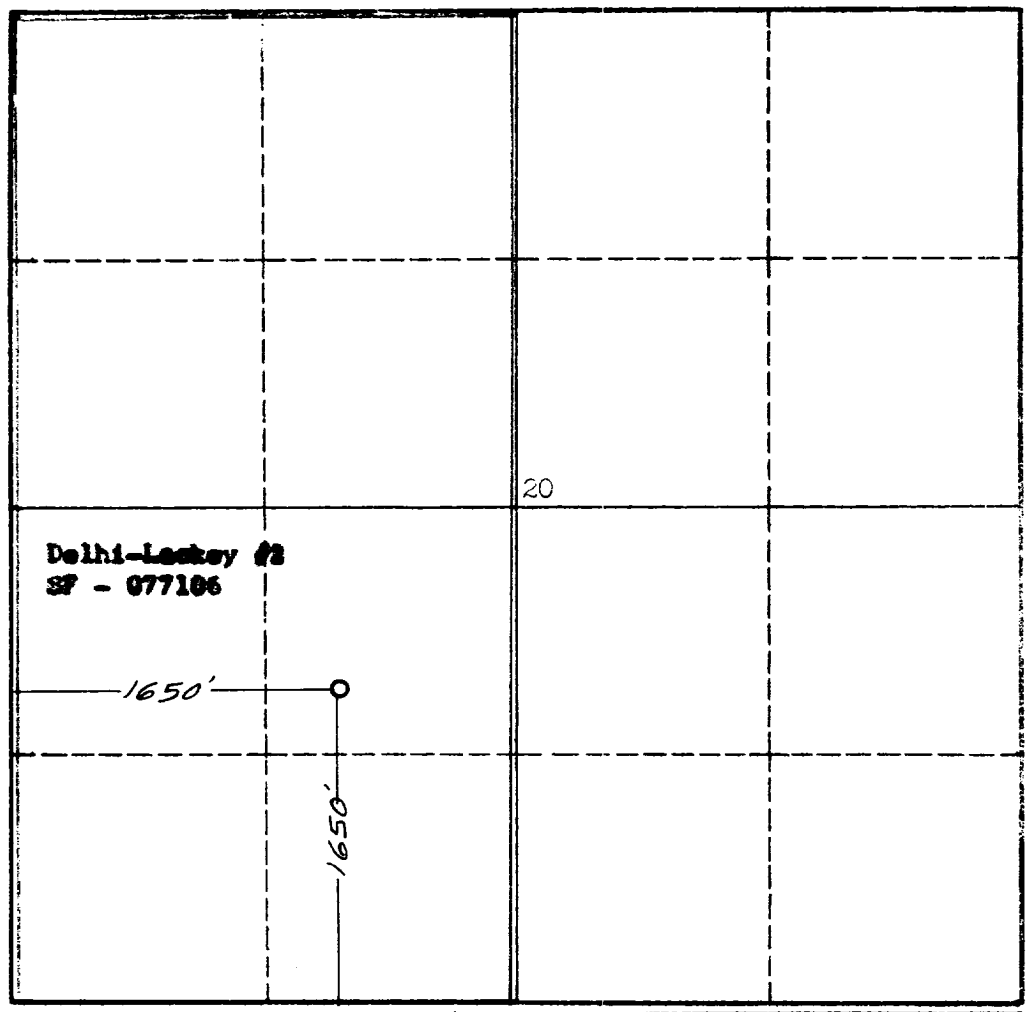

CERTIFICATION

I hereby certify that the information in SECTION A above is true and complete to the best of my knowledge and belief.

Name *J. B. Howell*

Position **J. B. Howell**
District Superintendent

Company
Delhi-Taylor Oil Corp.

Date
July 19, 1960

I hereby certify that the well location shown on the plat in SECTION B was plotted from field notes of actual surveys made by me or under my supervision, and that the same is true and correct to the best of my knowledge and belief.

Date Surveyed
17 July 1960

Registered Professional Engineer and/or Land Surveyor
James P. Leese
James P. Leese

Certificate No. **1463**

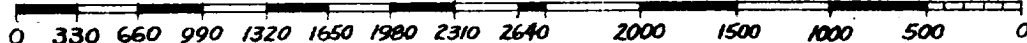

INSTRUCTIONS FOR COMPLETION OF FORM C-128

1. Operator shall furnish and certify to the information called for in Section A.
2. Operator shall outline the dedicated acreage for *both* oil and gas wells on the plat in Section B.
3. A registered professional engineer or land surveyor registered in the State of New Mexico or approved by the Commission shall show on the plat the location of the well and certify this information in the space provided.
4. All distances shown on the plat must be from the outer boundaries of the Section.
5. If additional space is needed for listing owners and their respective interests as required in question 3 of Section A, please use space below.