

(SUBMIT IN TRIPLICATE)

UNITED STATES
DEPARTMENT OF THE INTERIOR
GEOLOGICAL SURVEY

Budget Bureau 42-R358.3.
Approval expires 12-31-55.
Santa Fe
Land Office
Lease No. **077383-A**
Unit **SE/4**

SUNDRY NOTICES AND REPORTS ON WELLS

NOTICE OF INTENTION TO DRILL	<input checked="" type="checkbox"/>	SUBSEQUENT REPORT OF WATER SHUT-OFF	
NOTICE OF INTENTION TO CHANGE PLANS		SUBSEQUENT REPORT OF SHOOTING OR ACIDIZING	
NOTICE OF INTENTION TO TEST WATER SHUT-OFF		SUBSEQUENT REPORT OF ALTERING CASING	
NOTICE OF INTENTION TO RE-DRILL OR REPAIR WELL		SUBSEQUENT REPORT OF RE-DRILLING OR REPAIR	
NOTICE OF INTENTION TO SHOOT OR ACIDIZE		SUBSEQUENT REPORT OF ABANDONMENT	
NOTICE OF INTENTION TO PULL OR ALTER CASING		SUPPLEMENTARY WELL HISTORY	
NOTICE OF INTENTION TO ABANDON WELL			

(INDICATE ABOVE BY CHECK MARK NATURE OF REPORT, NOTICE, OR OTHER DATA)

April 13, 1954, 19

Turner-Kutz Deept Test Inc.
Well No. **1** is located **1,550** ft. from **S** line and **1,850** ft. from **E** line of sec. **22**
SE/4 Sec. 22 **T 28 N** **R 10 W** **N. M. P. M.**
(1/4 Sec. and Sec. No.) (Twp.) (Range) (Meridian)
Fulcher-Kutz **San Juan County** **New Mexico.**
(Field) (County or Subdivision) (State or Territory)

The elevation of the ~~center of the well~~ above sea level is **6,078** ft. (Ungraded)

DETAILS OF WORK

(State names of and expected depths to objective sands; show sizes, weights, and lengths of proposed casings; indicate mudlogging jobs, cementing points, and all other important proposed work)

Propose to drill with rotary tools to the top of the Pictured Cliff formation - expected between 1,900 feet and 2,100 feet below surface - then drill 4-3/4" rat hole through Pictured Cliff formation. Completion with cable tools - and shooting with solidified nitro glycerin.

Casing program: 100 feet of 8-5/8" new H-40 6 rd. thd. 32# casing. Circulate cement to surface.

5-1/2" - 14# seamless casing to be set on top of Pictured Cliff formation, cement with 150 sacks regular cement.

1" tubing to be set within 50 feet of total depth for production.

I understand that this plan of work must receive approval in writing by the Geological Survey before operations may be commenced.

Company **J. Glenn Turner**

Address **c/o San Juan Drilling Company**
Box 727 - Farmington, New Mexico.

Home Office: **1711 Mercantile Bank Bldg.**
Dallas 1, Texas.

By **C. Beason Neal**
Title **Agent in Farmington**

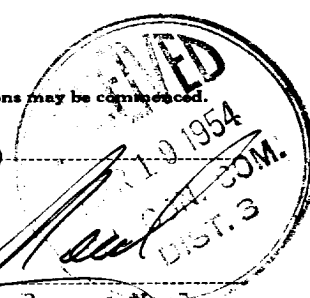

Company.....J. GLENN TURNER.....

Lease.....Turner Ruts Deep Test Inc..... Well No. 1.....

Sec. 22....., T. 28 N....., R. 10 W., N.M.P.M.....

Location.....1550' from the South line and 1850' from the East line.....

Elevation.....6078 Ungraded ground.....

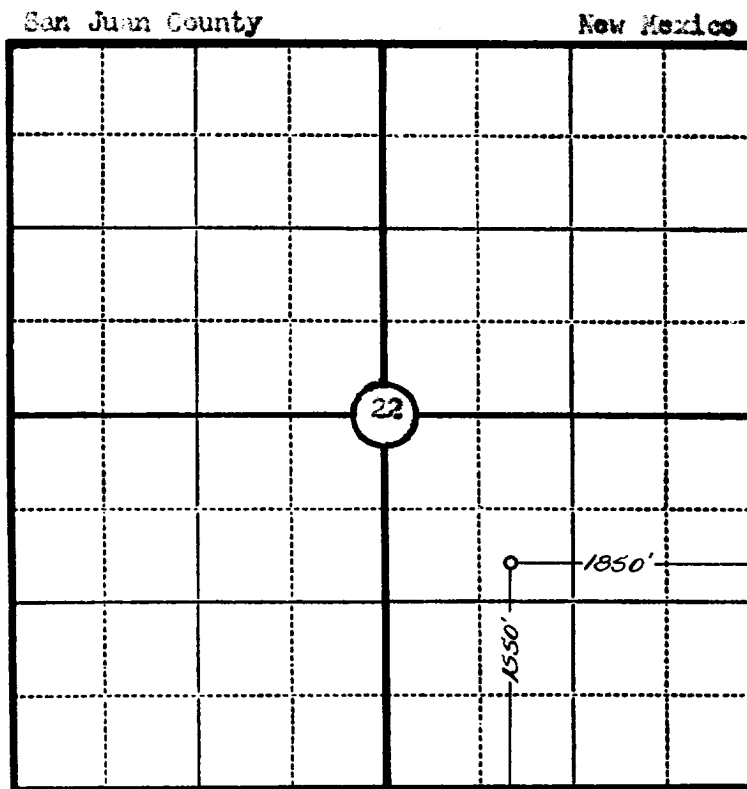

Scale—4 inches equal 1 mile.

This is to certify that the above plat was prepared from field notes of actual surveys made by me or under my supervision and that the same are true and correct to the best of my knowledge and belief.

Charles J. Finkles

Seal:

Registered Professional
Engineer and Land Surveyor.

Charles J. Finkles
N. Mex. Reg. No. 1302

Surveyed 12 April 19 54

