

(SUBMIT IN TRIPLICATE)

UNITED STATES
DEPARTMENT OF THE INTERIOR
GEOLOGICAL SURVEY

Land Office Santa Fe
Lease No. 077106
Unit Lacey

SUNDRY NOTICES AND REPORTS ON WELLS

NOTICE OF INTENTION TO DRILL.....	<input checked="" type="checkbox"/>	SUBSEQUENT REPORT OF WATER SHUT-OFF.....	
NOTICE OF INTENTION TO CHANGE PLANS.....		SUBSEQUENT REPORT OF SHOOTING OR ACIDIZING.....	
NOTICE OF INTENTION TO TEST WATER SHUT-OFF.....		SUBSEQUENT REPORT OF ALTERING CASING.....	
NOTICE OF INTENTION TO RE-DRILL OR REPAIR WELL.....		SUBSEQUENT REPORT OF RE-DRILLING OR REPAIR.....	
NOTICE OF INTENTION TO SHOOT OR ACIDIZE.....		SUBSEQUENT REPORT OF ABANDONMENT.....	
NOTICE OF INTENTION TO PULL OR ALTER CASING.....		SUPPLEMENTARY WELL HISTORY.....	
NOTICE OF INTENTION TO ABANDON WELL.....			

(INDICATE ABOVE BY CHECK MARK NATURE OF REPORT, NOTICE, OR OTHER DATA)

March 15, 19 57

Well No. 10-B (EM) is located 1750 ft. from N line and 1690 ft. from E line of sec. 21

NE Section 21 28N 9W N.M.P.M.
(1/4 Sec. and Sec. No.) (Twp.) (Range) (Meridian)
Artec Ext. & Blanco San Juan New Mexico
(Field) (County or Subdivision) (State or Territory)

The elevation of the derrick floor above sea level is 7002 ft.

DETAILS OF WORK

(State names of and expected depths to objective sands; show sizes, weights, and lengths of proposed casings; indicate mudlogging jobs, cementing points, and all other important proposed work)

It is intended to drill and dual complete a well in the Pictured Cliffs formation & Mesa Verde formation. Mud circulation will be used thru the Pictured Cliffs formation & set intermediate casing. Gas circulation will be used thru the Mesa Verde & a production liner will be set. Possible productive intervals will be perforated & fractured. Estimated Total Depth 5800'.

Casing Program:

10-3/4" at 170' with 125 sacks cement circulated to the surface.

7-5/8" at 5500' with 250 sacks cement.

5-1/2" liner at 5800' with 300 sacks cement.

The E/2 of Section 21 is dedicated to the Mesa Verde.

The NE/4 of Section 21 is dedicated to the Pictured Cliffs.

E/2 & NE/4, SF 077106

I understand that this plan of work must receive approval in writing by the Geological Survey before operations may be commenced.

Company El Paso Natural Gas CompanyAddress Box 997Farmington, New MexicoBy Original Signed EWELL N. WALSHTitle Petroleum Engineer



NEW MEX CO
OIL CONSERVATION COMMISSION

WELL LOCATION AND/OR GAS PRODUCTION PLAT

MARCH 18, 1957

EL PASO NATURAL GAS COMPANY

LACKEY "B"

SF 077106

10 (PM)

21

28 N

9 W

1750

NORTH

1690

EAST

SAN JUAN

6992

P.C. & M.V.

AZTEC EXTEN. P.C.
BLANCO M.V.

160 AC. P.C.
320 AC. M.V.
(1919 PLAT)

Notes: All distances are from the corner of the section.

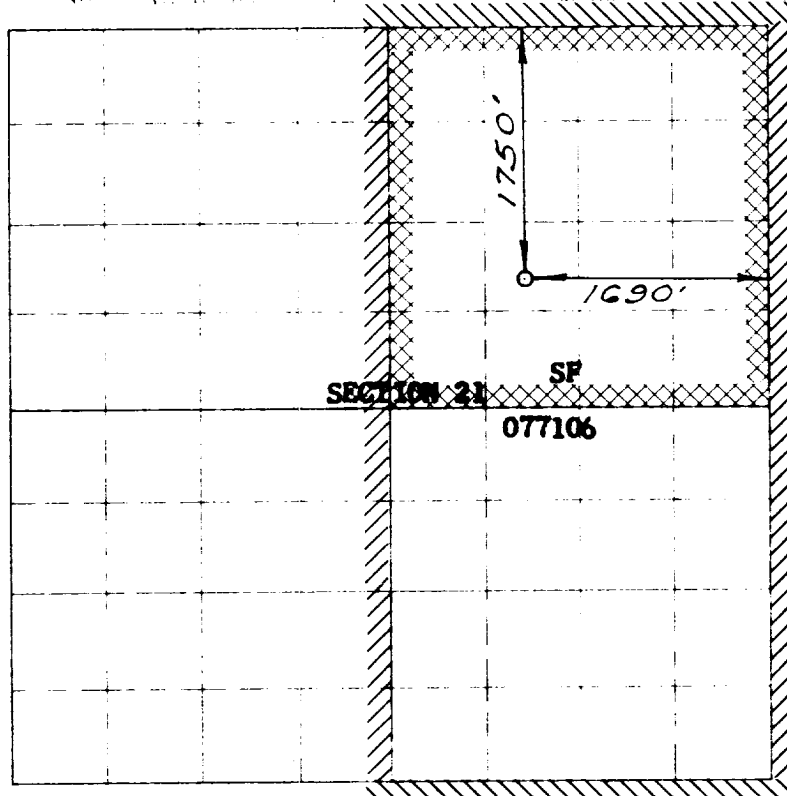

Scale 4 inches equal 1 mile

NOTE

This section of
forms to be used
for gas wells only.

This is to certify that the above plat was prepared from
field notes or actual surveys made by me or under my
supervision and that the same are true and correct to the
best of my knowledge and belief.

Date Surveyed JANUARY 30, 1957

C. O. Walker
Registered Professional Engineer and/or Land Surveyor

1. Is this well a Dual Comp.

Yes X No

2. If the answer to Question 1

is yes, are there any other dually
completed wells within the
dedicated acreage.

Yes No X

Name Original Signed DWELL N. WALSH

Position Petroleum Engineer

Representing El Paso Natural Gas Co.

Address Box 997 - Farmington, N.M.

Seal

Farmington, New Mexico