

(SUBMIT IN TRIPLICATE)

UNITED STATES
DEPARTMENT OF THE INTERIOR
GEOLOGICAL SURVEY

Land Office Santa Fe
Lease No. SP-065546-A
Unit Newman

SUNDRY NOTICES AND REPORTS ON WELLS

NOTICE OF INTENTION TO DRILL	<input checked="" type="checkbox"/>	SUBSEQUENT REPORT OF WATER SHUT-OFF	<input type="checkbox"/>
NOTICE OF INTENTION TO CHANGE PLANS	<input type="checkbox"/>	SUBSEQUENT REPORT OF SHOOTING OR ACIDIZING	<input type="checkbox"/>
NOTICE OF INTENTION TO TEST WATER SHUT-OFF	<input type="checkbox"/>	SUBSEQUENT REPORT OF ALTERING CASING	<input type="checkbox"/>
NOTICE OF INTENTION TO RE-DRILL OR REPAIR WELL	<input type="checkbox"/>	SUBSEQUENT REPORT OF RE-DRILLING OR REPAIR	<input type="checkbox"/>
NOTICE OF INTENTION TO SHOOT OR ACIDIZE	<input type="checkbox"/>	SUBSEQUENT REPORT OF ABANDONMENT	<input type="checkbox"/>
NOTICE OF INTENTION TO PULL OR ALTER CASING	<input type="checkbox"/>	SUPPLEMENTARY WELL HISTORY	<input type="checkbox"/>
NOTICE OF INTENTION TO ABANDON WELL	<input type="checkbox"/>		

(INDICATE ABOVE BY CHECK MARK NATURE OF REPORT, NOTICE, OR OTHER DATA)

RECEIVED
JAN 11 1960
U. S. GEOLOGICAL SURVEY
FARMINGTON, NEW MEXICO

Well No. 8-A is located 1890 ft. from N line and 790 ft. from E line of sec. 19
NE 1/4 Section 19 (Twp. 3-28N) (Range 10W) (County Santa Fe) (State New Mexico)
Angel Peak, Dakota (County Santa Fe) (State New Mexico)

The elevation of the derrick floor above sea level is 5917 ft.

DETAILS OF WORK

(State names of and expected depths to objective sands; show sizes, weights, and lengths of proposed casings; indicate mudding jobs, cementing points, and all other important proposed work)

Propose to:

Set 300' of 8 5/8" casing and cement to surface
Drill with rotary tools to approximate depth of 6600'
Run 4 1/2" casing to total depth with 2-stage cement collar set approximately 100' below Pictured Cliffs formation.
First stage cemented with 225 sacks
Second stage cemented with 125 sacks
Perforate Dakota formation
Sand-water frac with 100,000 gals. water and sand
Run 2 3/8 tubing.

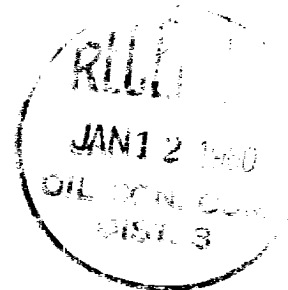

Est. 1 of Section 19 consisting of 320 acres dedicated to well.

Company AT&T OIL & GAS COMPANY

Address Box 786

Farmington, New Mexico

By ORIGINAL SIGNED BY JOE C. SALMON

Title Joe C. Salmon
District Superintendent

NEW MEXICO OIL CONSERVATION COMMISSION

Well Location and Acreage Dedication Plat

Section A.

Date January 7, 1960

Operator ARTEC OIL & GAS COMPANY Lease NEWMAN
Well No. 8-A Unit Letter H Section 19 Township 26N Range 10W NMFM
Located 1850 Feet From North Line, 790 Feet From East Line
County San Juan G. L. Elevation 5917 Dedicated Acreage 320 Acres
Name of Producing Formation Dakota Pool Angel Peak Dakota

1. Is the Operator the only owner* in the dedicated acreage outlined on the plat below?
Yes X No
2. If the answer to question one is "no," have the interests of all the owners been consolidated by communitization agreement or otherwise? Yes No . If answer is "yes,"
Type of Consolidation
3. If the answer to question two is "no," list all the owners and their respective interests below:

Owner

Land Description

Section B

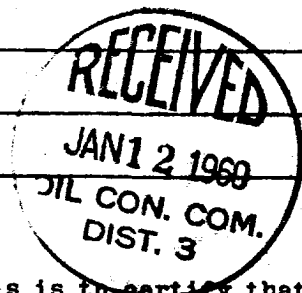
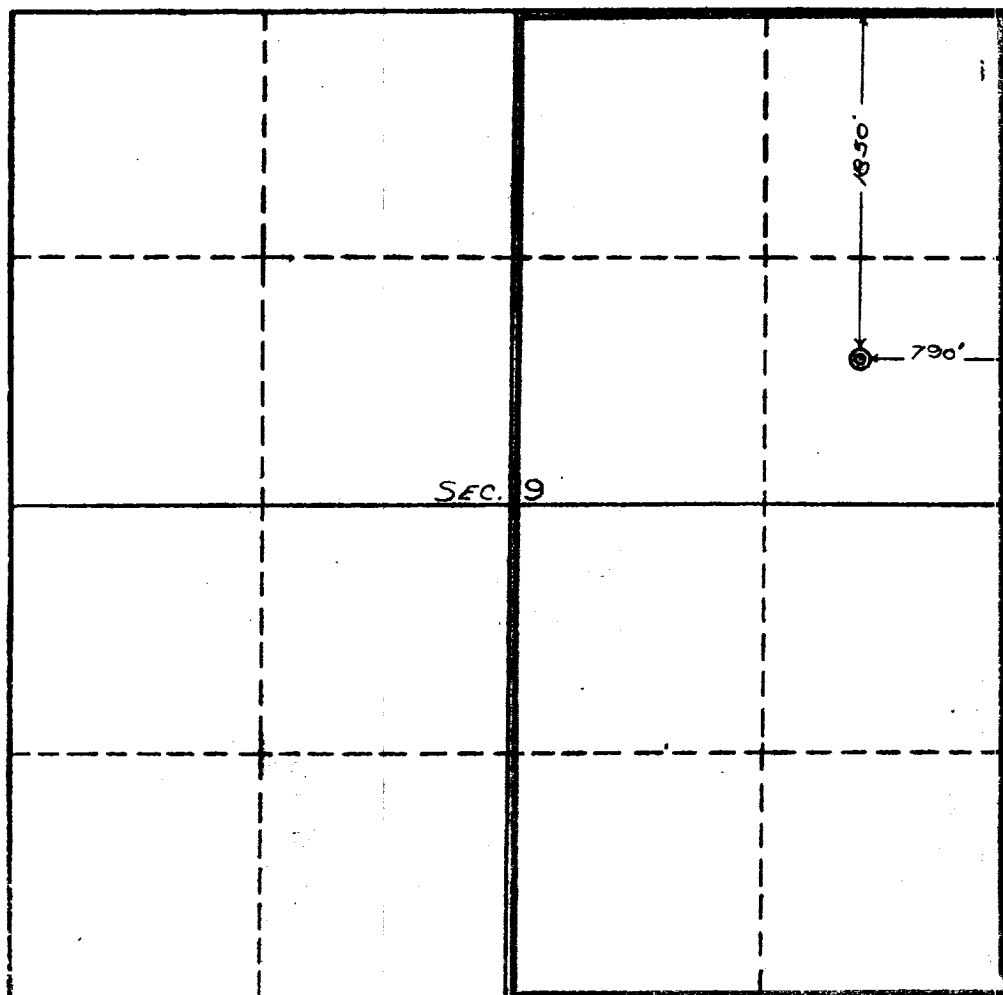

This is to certify that the information in Section A above is true and complete to the best of my knowledge and belief.

ARTEC OIL & GAS COMPANY
(Operator)

ORIGINAL SIGNED BY JOE C. SALMON
(Representative)

BOX 786, FARMINGTON, N.M.
Address

This is to certify that the well located above on the plat in Section B is plotted from of surveys made of under my supervision and that the same is and correct to the best of my knowledge and belief.

Date Surveyed DEC. 31, 1958

Ernest V. Echohawk
Registered Land Surveyor.

Certificate No. 1545