

District I
P.O. Box 1980, Hobbs, NM

District II
P.O. Drawer DD, Artesia, NM 88221

District III
1000 Rio Brazos Rd, Aztec, NM 87410

State of New Mexico
Energy, Minerals and Natural Resources Department

OIL CONSERVATION DIVISION

2040 South Pacheco Street
Santa Fe, New Mexico 87505

OK
SUBMIT 1 COPY TO
APPROPRIATE
DISTRICT OFFICE
AND 1 COPY TO
SANTA FE OFFICE

PIT REMEDIATION AND CLOSURE REPORT

Operator: <u>PNM Gas Services (Williams)</u>		Telephone: <u>324-3764</u>	
Address: <u>603 W. Elm Street Farmington, NM 87401</u>			
Facility or Well Name: <u>Reid #20 Drip</u>			
Location:	Unit <u>A</u>	Sec <u>19</u>	T <u>28 N</u> R <u>9 W</u> County <u>San Juan</u>
Pit Type:	Separator <input type="checkbox"/>	Dehydrator <input type="checkbox"/>	Other <u>Drip</u>
Land Type:	BLM <input checked="" type="checkbox"/>	State <input type="checkbox"/>	Fee <input type="checkbox"/> Other <u> </u>

Pit Location:	Pit dimensions:	length <u>12 ' </u>	width <u>12 ' </u>	depth <u>2 ' </u>
(Attach diagram)	Reference:	wellhead <input checked="" type="checkbox"/>	other <u> </u>	
Footage from reference:		<u>123'</u>		
Direction from reference:		<u>25</u> Degrees	<input type="checkbox"/> East	North <input type="checkbox"/>
			<input checked="" type="checkbox"/> West	South <input checked="" type="checkbox"/>

Depth to Ground Water: <small>(Vertical distance from contaminants to seasonal high water elevation of ground water)</small>	Less than 50 feet	(20 points)	0
	50 feet to 99 feet	(10 points)	
	Greater than 100 feet	(0 points)	
Wellhead Protection Area: <small>(Less than 200 feet from a private domestic water source, or, less than 1,000 feet from all other water sources)</small>	Yes	(20 points)	0
	No	(0 points)	
Distance to Surface Water: <small>(Horizontal distance to perennial lakes, ponds, rivers, streams, creeks, irrigation canals and ditches)</small>	Less than 200 feet	(20 points)	0
	200 feet to 1,000 feet	(10 points)	
	Greater than 1,000 feet	(0 points)	
RANKING SCORE (TOTAL POINTS) :			0

RECEIVED

OIL CON. DIV.

DIST. 3

JAN 5 1 2001

Reid #20 Drip

Date Remediation Started: 09/13/1999

Date Completed: 09/13/1999

Remediation Method: Excavation ☒ Approx. Cubic Yard 270

(Check all appropriate sections)

Landfarmed ☒ Amount Landfarmed (cubic yds) 270

Other

Remediation Location: Onsite ☒ Offsite

(i.e., landfarmed onsite, name and location of offsite facility)

Backfill Material Location:

General Description of Remedial Action:

Excavated contaminated soil to a pit size of 26' X 28' X 10' and landfarmed soil onsite within a bermed area at a depth of 6" to 12". Soil was aerated by disking/plowing until soil met regulatory levels.

Ground Water Encountered: No ☒ Yes ☐ Depth

Final Pit Closure Sampling:

Sample Location 5 pt composite-bottom

(if multiple samples, attach sample result and diagram of sample locations and depths.)

Sample depth 10'

Sample date 09/13/1999

Sample time 3:10:00 PM

Sample Results

Benzene (ppm)

Total BTEX (ppm)

Field headspace (ppm) 58.3

TPH (ppm) 190.00

Method 8015B

Vertical Extent (ft)

Risk Analysis form attached Yes ☐ No ☒

Ground Water Sample:

Yes ☐

No ☒

(If yes, see attached Groundwater Site Summary Report)

I HEREBY CERTIFY THAT THE INFORMATION ABOVE IS TRUE AND COMPLETE TO THE BEST OF MY KNOWLEDGE AND MY BELIEF

DATE January 24, 2000

SIGNATURE

Maureen Gannon

PRINTED NAME Maureen Gannon
AND TITLE Project Manager

Neid du Drip
Sec. 19 T28N R9W Unit A
Burlington

Site Drawing

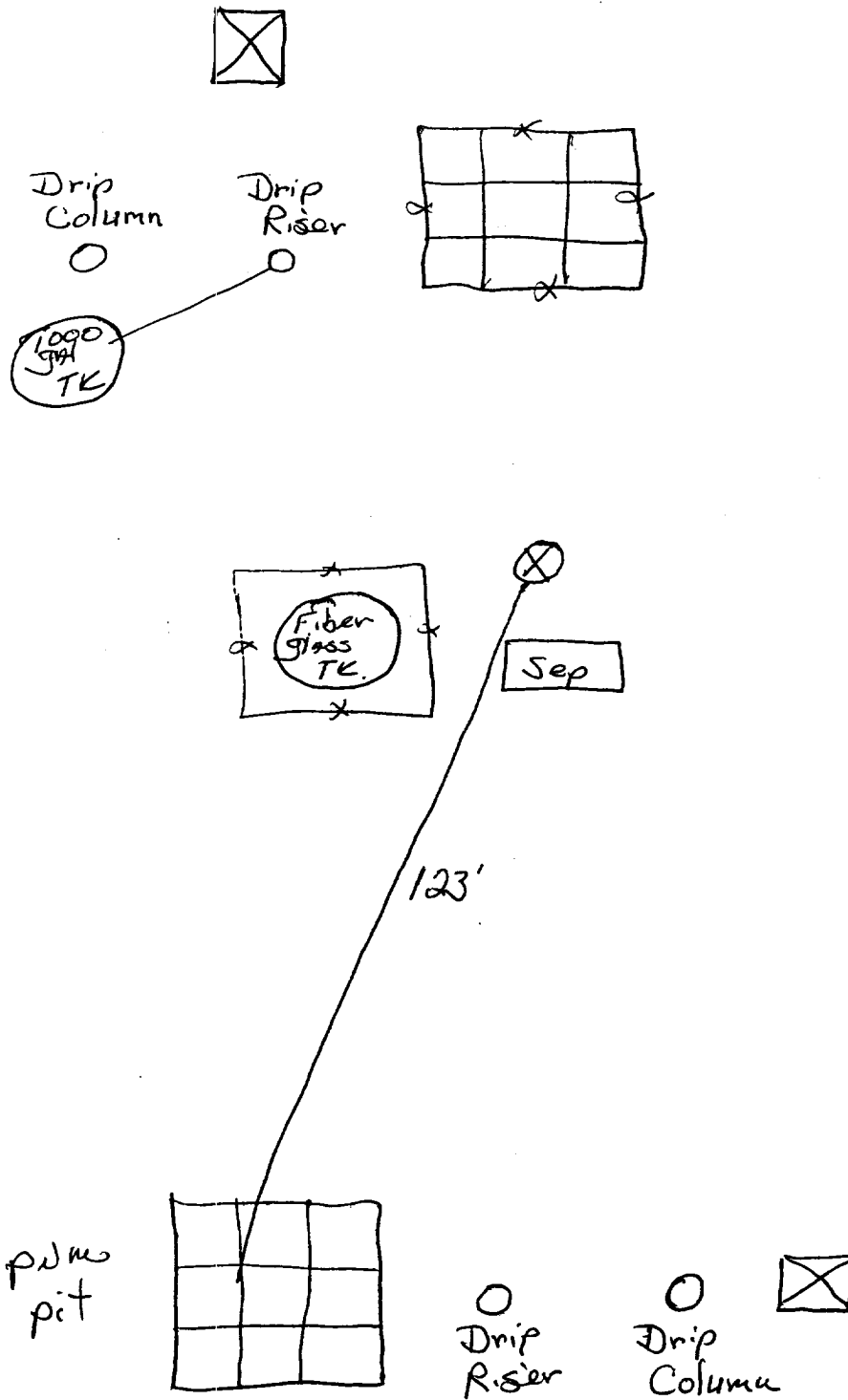

Keid 20 Drip
Sec. 19 T28N R9W Unit A
Burlington

Excavation Drawing

26' x 28' x 10'

North Wall
14.0 pp—
9'

Bottom
58.3 pp—
10'

West Wall
1.3 pp—
9'

East Wall
8.3 pp—
9'

South Wall
4.4 pp—
9'

Field Headspace: 58.3 ppm

OFF: (505) 325-5667



LAB: (505) 325-1556

On Site Technologies, LTD.

Date: 22-Sep-99

CLIENT: PNM - Public Service Company of NM

Project: Reid 20: Dakota & Drip

Lab Order: 9909050

CASE NARRATIVE

Samples were analyzed using the methods outlined in the following references:

Test Methods for Evaluating Solid Waste, Physical/Chemical Methods, SW846, 3rd Edition

All method blanks, laboratory spikes, and/or matrix spikes met quality assurance objectives.

OFF: (505) 325-5667



LAB: (505) 325-1556

ANALYTICAL REPORT

Date: 22-Sep-99

Client:	PNM - Public Service Company of NM	Client Sample Info:	Reid 20 Drip
Work Order:	9909050	Client Sample ID:	9909131510; 5pt. Bottom Comp
Lab ID:	9909050-04A	Matrix:	SOIL
Project:	Reid 20: Dakota & Drip	Collection Date:	9/13/99 3:10:00 PM
		COC Record:	7787

Parameter	Result	PQL	Qual	Units	DF	Date Analyzed
DIESEL RANGE ORGANICS		SW8015B				Analyst: HR
T/R Hydrocarbons: C10-C28	190	25		mg/Kg	1	9/15/99

Qualifiers:

PQL - Practical Quantitation Limit

ND - Not Detected at Practical Quantitation Limit

J - Analyte detected below Practical Quantitation Limit

B - Analyte detected in the associated Method Blank

S - Spike Recovery outside accepted recovery limits

R - RPD outside accepted recovery limits

E - Value above quantitation range

Surr: - Surrogate

1 of 1

P.O. BOX 2606 • FARMINGTON, NM 87499

OFF: (505) 325-5667



LAB: (505) 325-1556

ANALYTICAL REPORT

Date: 22-Sep-99

Client:	PNM - Public Service Company of NM	Client Sample Info:	Reid 20 Drip
Work Order:	9909050	Client Sample ID:	9909131507; 4pt. Wall Comp
Lab ID:	9909050-03A	Matrix:	SOIL
Project:	Reid 20: Dakota & Drip	Collection Date:	9/13/99 3:07:00 PM
		COC Record:	7787

Parameter	Result	PQL	Qual	Units	DF	Date Analyzed
DIESEL RANGE ORGANICS		SW8015B				Analyst: HR
T/R Hydrocarbons: C10-C28	230	25		mg/Kg	1	9/15/99

Qualifiers:

PQL - Practical Quantitation Limit

ND - Not Detected at Practical Quantitation Limit

J - Analyte detected below Practical Quantitation Limit

B - Analyte detected in the associated Method Blank

S - Spike Recovery outside accepted recovery limits

R - RPD outside accepted recovery limits

E - Value above quantitation range

Surr: - Surrogate

1 of 1

P.O. BOX 2606 • FARMINGTON, NM 87499

Sec. 19 T28N R9W Unit A
Burlington

Land farm Drawing

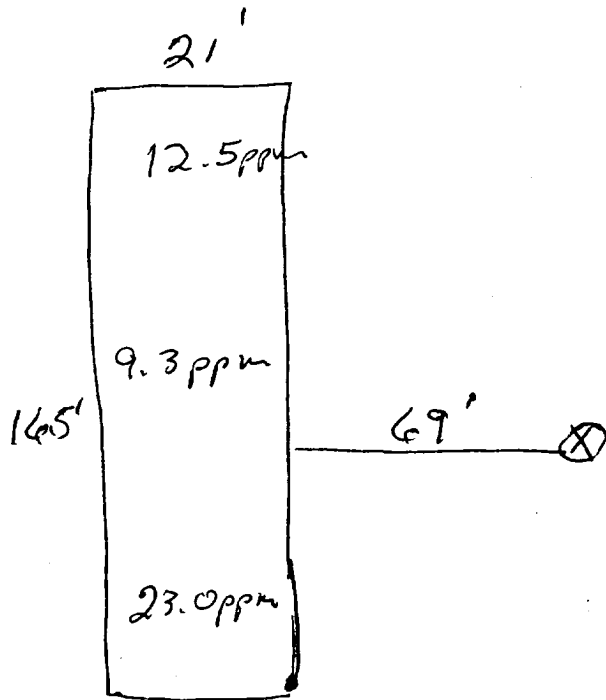

Hill

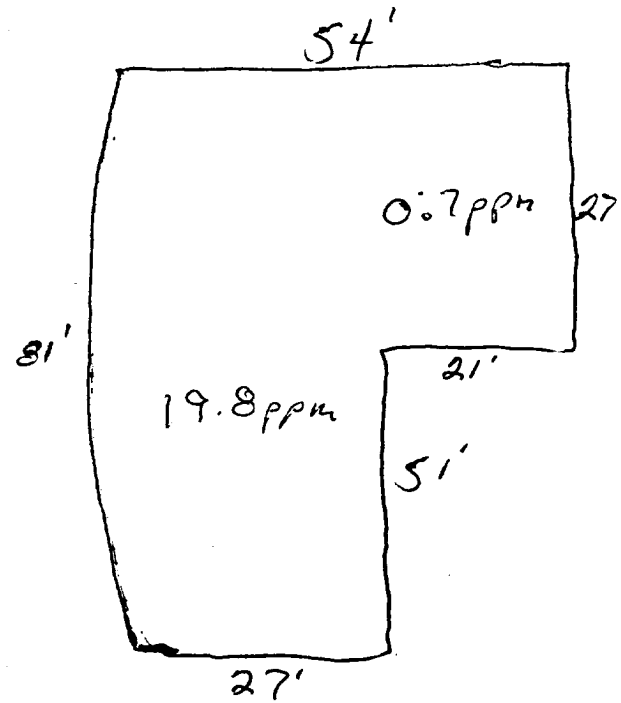

2" to 12" Depth
Headspace 43.5
Sample # 9910051106

Not to Scale

**On Site Technologies, LTD.**

Date: 22-Oct-99

CLIENT: PNM - Public Service Company of NM**Project:** Pritchard #4 & Reid #20 Landfarms**Lab Order:** 9910010**CASE NARRATIVE**

Samples were analyzed using the methods outlined in the following references:

Test Methods for Evaluating Solid Waste, Physical/Chemical Methods, SW846, 3rd Edition

All method blanks, laboratory spikes, and/or matrix spikes met quality assurance objectives.

Analytical Comments for Method BTEX_S, SAMPLE 9910010-03A; Reid #20 DH LF: The reported result for m,p-Xylene, 810 ug/Kg, has the attached qualifier E - Value above quantitation range. Upon re-analysis for confirmation within the calibration range it was observed that the sample had lost volatiles due to volatilization and/or degradation. Therefore the original analysis is reported with the respective qualifier for m,p-Xylene.

OFF: (505) 325-5667



LAB: (505) 325-1556

ANALYTICAL REPORT

Date: 22-Oct-99

Client:	PNM - Public Service Company of NM	Client Sample Info:	Reid #20 Drip LF
Work Order:	9910010	Client Sample ID:	9910051106; 5pt Comp
Lab ID:	9910010-02A	Matrix:	SOIL
Project:	Pritchard #4 & Reid #20 Landfarms	Collection Date:	10/5/99 11:06:00 AM
		COC Record:	7658

Parameter	Result	PQL	Qual	Units	DF	Date Analyzed
DIESEL RANGE ORGANICS		SW8015B				Analyst: DC
T/R Hydrocarbons: C10-C28	1100	25		mg/Kg	1	10/12/99

Qualifiers:

PQL - Practical Quantitation Limit
ND - Not Detected at Practical Quantitation Limit
J - Analyte detected below Practical Quantitation Limit
B - Analyte detected in the associated Method Blank

S - Spike Recovery outside accepted recovery limits
R - RPD outside accepted recovery limits
E - Value above quantitation range
Surr: - Surrogate

1 of 1

P.O. BOX 2606 • FARMINGTON, NM 87499

- TECHNOLOGY BLENDING INDUSTRY WITH THE ENVIRONMENT -