

(SUBMIT IN TRIPLICATE)
**UNITED STATES
DEPARTMENT OF THE INTERIOR
GEOLOGICAL SURVEY**

Land Office Santa Fe
Lease No. 48 047039-0
Unit 34/4 34/4 Sec. 18,
T-20N, R-10W, San Juan
County, N. M., U.S.A.

SUNDRY NOTICES AND REPORTS ON WELLS

NOTICE OF INTENTION TO DRILL	<input checked="" type="checkbox"/>	SUBSEQUENT REPORT OF WATER SHUT-OFF	RECEIVED SEP 4 1962 U.S. GEOLOGICAL SURVEY SANTA FE, N.M.
NOTICE OF INTENTION TO CHANGE PLANS	<input type="checkbox"/>	SUBSEQUENT REPORT OF SHOOTING OR ACIDIZING	
NOTICE OF INTENTION TO TEST WATER SHUT-OFF	<input type="checkbox"/>	SUBSEQUENT REPORT OF ALTERING CASING	
NOTICE OF INTENTION TO RE-DRILL OR REPAIR WELL	<input type="checkbox"/>	SUBSEQUENT REPORT OF RE-DRILLING OR REPAIR	
NOTICE OF INTENTION TO SHOOT OR ACIDIZE	<input type="checkbox"/>	SUBSEQUENT REPORT OF ABANDONMENT	
NOTICE OF INTENTION TO PULL OR ALTER CASING	<input type="checkbox"/>	SUPPLEMENTARY WELL HISTORY	
NOTICE OF INTENTION TO ABANDON WELL	<input type="checkbox"/>		

(INDICATE ABOVE BY CHECK MARK NATURE OF REPORT, NOTICE, OR OTHER DATA)

Congress Section

August 31, 1962

Well No. 4 is located 790 ft. from N line and 790 ft. from W line of sec. 18

34/4 34/4 Sec. 18
(1/4 Sec. and Sec. No.)

20N 10W
(Twp.) (Range)

N.M.
(Meridian)

San Juan
(Field)

San Juan
(County or Subdivision)

New Mexico
(State or Territory)

The elevation of the derrick floor above sea level is 5956 ft. G.L.

DETAILS OF WORK

(State names of and expected depths to objective sands; show sizes, weights, and lengths of proposed casings; indicate mudding jobs, cementing points, and all other important proposed work)

1. The objective sand is the Lakota Formation anticipated at approx. 6710 ft.
2. Proposed casing program: 250' 3-5/8" O.D., 24.00 lb/ft J-55 Cemented to surface.
6710' 4-1/2" O.D., 10.50 lb/ft J-55 Cemented w/250 sacks.
3. Run 4-1/2" stage collar set below Pictured Cliff Formation, cement with 100 sacks.
4. Rotary tools will be employed from surface to T.D. Pipe will be set at approx. 6710'.
5. Estimated T. D. 6710 ft.
6. Well will be sand-fraced in an effort to stimulate production.

I understand that this plan of work must receive approval in writing by the Geological Survey before operations may be commenced.

Company JOINTURE OIL PRODUCTION COMPANY

Address P. O. Box 306

Farmington, N. M.

By

Title

Area Superintendent

Well Location and Acreage Dedication Plat

Section A.

Date August 11, 1962

Operator SOUTHERN UNION PRODUCTION COMPANY Lease Congress Leases
 Well No. 1 Unit Letter M Section 18 Township 28 NORTH Range 10 WEST NMPM
 Located 790 Feet From the SOUTH Line, & 790 Feet From the WEST Line
 County SAN JUAN G. L. Elevation 5956.0 Dedicated Acreage 300 Acres
 Name of Producing Formation Del Norte Pool Spain Del Norte

1. Is the Operator the only owner in the dedicated acreage outlined on the plat below?
 Yes X No
2. If the answer to question one is "no", have the interests of all the owners been consolidated by communitization agreement or otherwise? Yes No . If answer is "yes", Type of Consolidation.

3. If the answer to question two is "no", list all the owners and their respective interests below:

OwnerLand Description

Section B.

This is to certify that the information in Section A above is true and complete to the best of my knowledge and belief.

Southern Union Production Co.

(Operator)

(Representative)

W. A. Hammond

(Address)

P. O. Box 800Farmington, N. M.

Ref. GLO Plat Dated 19 July 1915

Note: All distances must be from outer boundaries of section.

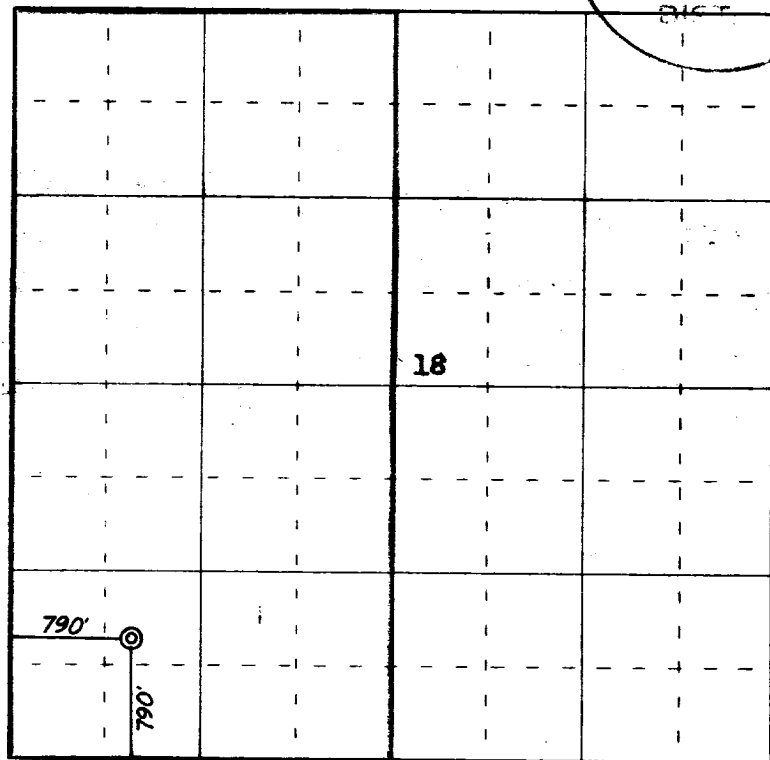

0 330 660 990 1320 1650 1980 2310 2640 2000 1500 1000 500 0

Scale 4 inches equal 1 mile

This is to certify that the above plat was prepared from field notes of actual surveys made by me or under my supervision and that the same are true and correct to the best of my knowledge and belief.

Date Surveyed 22 August 1962

James P. Leese
 Registered Professional Engineer and/or Land Surveyor
 James P. Leese N. Mex. Reg. No. 1463
 San Juan Engineering Company

Farmington, New Mexico