

NEW MEXICO OIL CONSERVATION COMMISSION

FORM C-128
Revised 5/1/57

WELL LOCATION AND ACREAGE DEDICATION PLAT

SEE INSTRUCTIONS FOR COMPLETING THIS FORM ON THE REVERSE SIDE

SECTION A

Operator OHIO OIL COMPANY		Lease RM 020498 SF 044535(5)*		Well No. 2-10
Unit Letter P	Section 15	Township 28 NORTH	Range 11 WEST	County SAN JUAN
Actual Footage Location of Well: 890 feet from the SOUTH line and 990 feet from the EAST line				
Ground Level Elev. 5517.2	Producing Formation DAKOTA	Pool Angels Peak Dakota	Dedicated Acreage: 320 Acres	

Ref. GLO plat dated 19 July 1915

1. Is the Operator the only owner in the dedicated acreage outlined on the plat below? YES ☒ NO ☐ . ("Owner" means the person who has the right to drill into and to produce from any pool and to appropriate the production either for himself or for himself and another. (65-3-29 (e) NMSA 1935 Comp.)
2. If the answer to question one is "no," have the interests of all the owners been consolidated by communitization agreement or otherwise? YES ☐ NO ☐ . If answer is "yes," Type of Consolidation _____
3. If the answer to question two is "no," list all the owners and their respective interests below: * See reverse side.

Owner	Land Description

SECTION B

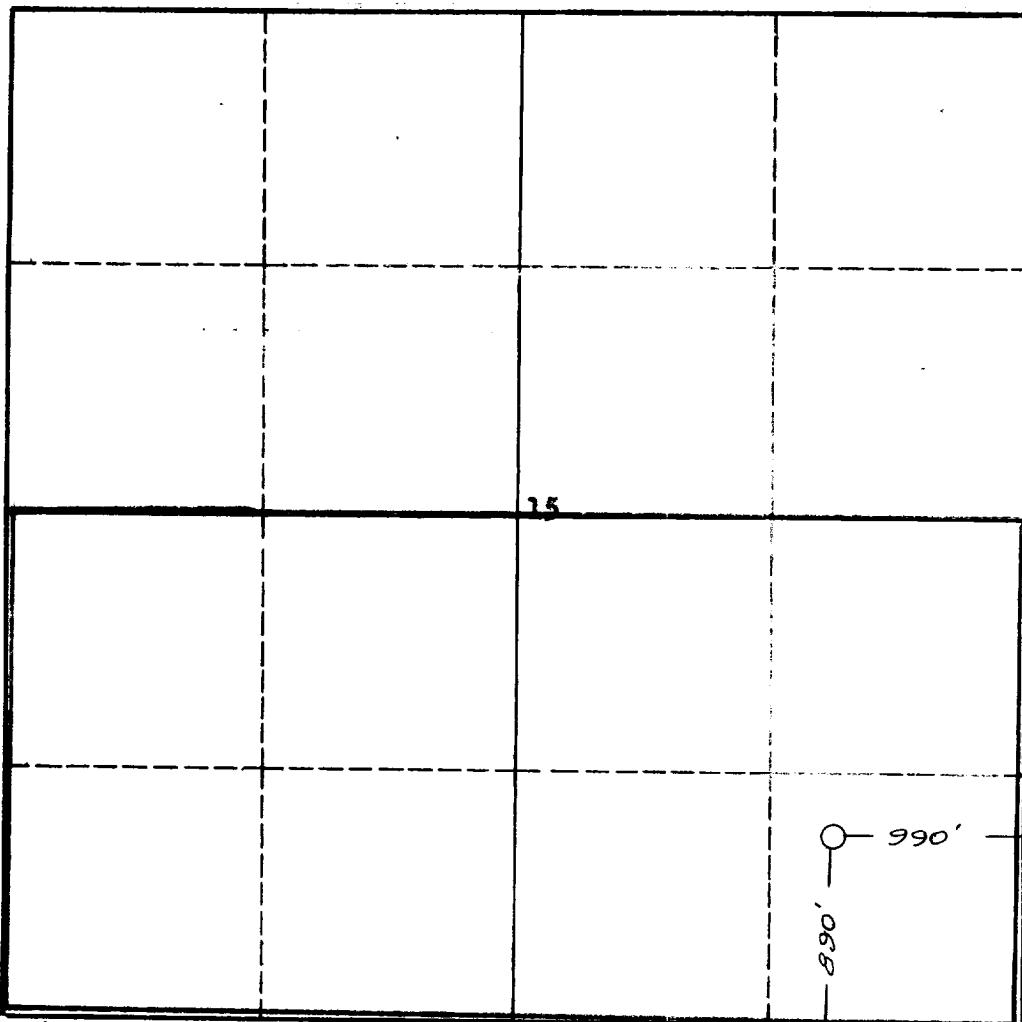

CERTIFICATION

I hereby certify that the information in SECTION A above is true and complete to the best of my knowledge and belief.

Name <i>H. J. Brunter</i>
Position Div. Production Dept.
Company THE OHIO OIL COMPANY
Date September 27, 1960

I hereby certify that the well location shown on the plat in SECTION B was plotted from field notes of actual surveys made by me or under my supervision, and that the same is true and correct to the best of my knowledge and belief.

Date Surveyed 4 August 1960
Registered Professional Engineer and/or Land Surveyor <i>James P. Leese</i> James P. Leese
Certificate No. 1463

INSTRUCTIONS FOR COMPLETION OF FORM C-128

1. Operator shall furnish and certify to the information called for in Section A.
2. Operator shall outline the dedicated acreage for *both* oil and gas wells on the plat in Section B.
3. A registered professional engineer or land surveyor registered in the State of New Mexico or approved by the Commission shall show on the plat the location of the well and certify this information in the space provided.
4. All distances shown on the plat must be from the outer boundaries of the Section.
5. If additional space is needed for listing owners and their respective interests as required in question 3 of Section A, please use space below.

*Federal Oil and Gas Lease Santa Fe 044535 (b) covering the NE $\frac{1}{4}$ SE $\frac{1}{4}$ Section 15, T-28N, R-11W, is being conveyed to The Ohio Oil Company by Southern Union Gas Company. Inasmuch as there are two federal leases covering all of the SE $\frac{1}{4}$ Section 15, said leases are being communitized in order that allocation of production can be made to each of the tracts covered by the two leases. Southern Union Gas Company is presently the owner of operating rights under the NE $\frac{1}{4}$ SE $\frac{1}{4}$ Section 15 by virtue of an operating agreement dated July 10, 1953 between Marquis G. Eaton, et ux and Southern Union Gas Company. For this reason Southern Union Gas Company and Marquis G. Eaton, et ux will become parties to the Communitization Agreement along with The Ohio Oil Company although Southern Union Gas Company will, in fact, no longer have an interest in the tract after the conveyance is made to Ohio. It is expected that the Communitization Agreements signed by all parties in interest and those of record in the BLM office will be filed, for approval by the Director, with the U.S.G.S. in the very near future.