

(SUBMIT IN TRIPLICATE)

UNITED STATES
DEPARTMENT OF THE INTERIOR
GEOLOGICAL SURVEY

Budget Bureau No. 42-R358.4.
Approval expires 12-31-60.

Land Office State of New Mexico
Lease No. 12-12-12
Unit 12-12-12

SUNDRY NOTICES AND REPORTS ON WELLS

NOTICE OF INTENTION TO DRILL.....	<input checked="" type="checkbox"/>	SUBSEQUENT REPORT OF WATER SHUT-OFF.....	<input type="checkbox"/>
NOTICE OF INTENTION TO CHANGE PLANS.....	<input type="checkbox"/>	SUBSEQUENT REPORT OF SHOOTING OR ACIDIZING.....	<input type="checkbox"/>
NOTICE OF INTENTION TO TEST WATER SHUT-OFF.....	<input type="checkbox"/>	SUBSEQUENT REPORT OF ALTERING CASING.....	<input type="checkbox"/>
NOTICE OF INTENTION TO RE-DRILL OR REPAIR WELL.....	<input type="checkbox"/>	SUBSEQUENT REPORT OF RE-DRILLING OR REPAIR.....	<input type="checkbox"/>
NOTICE OF INTENTION TO SHOOT OR ACIDIZE.....	<input type="checkbox"/>	SUBSEQUENT REPORT OF ABANDONMENT.....	<input type="checkbox"/>
NOTICE OF INTENTION TO PULL OR ALTER CASING.....	<input type="checkbox"/>	SUPPLEMENTARY WELL HISTORY.....	<input type="checkbox"/>
NOTICE OF INTENTION TO ABANDON WELL.....	<input type="checkbox"/>		

(INDICATE ABOVE BY CHECK MARK NATURE OF REPORT, NOTICE, OR OTHER DATA)

Well No. 12-12-12 is located 100 ft. from N line and 100 ft. from E line of sec. 1
12-12-12 (Range) 12-12-12 (Meridian)
12-12-12 (Sec. and Sec. No.) 12-12-12 (Twp.)
12-12-12 (Field) 12-12-12 (County or Subdivision) 12-12-12 (State or Territory)

The elevation of the derrick floor above sea level is 2700 ft. (Green elevation)

DETAILS OF WORK

(State names of and expected depths to objective sands; show sizes, weights, and lengths of proposed casings; indicate mudding jobs, cementing points, and all other important proposed work)

Drill 121' to 100' of 2 1/2" surface casing and cement to surface.

Drill with rotary tools to approximate total depth of 400' or through
surface formation. Set 4 1/2" production casing at total depth and cement
with 100 ex. Set 2-stage cement collar approximately 100' below
surface of formation and cement with 150 ex.

Perforate formation with four shots per foot. Test water
flow with 100,000' sand and 100,000 gals. water. Set 2 1/2" tubing.

I understand that this plan of work must receive approval in writing by the Geological Survey before operations may be commenced.

Company 12-12-12

Address 12-12-12

12-12-12, New Mexico

By 12-12-12

Title 12-12-12

NEW MEXICO OIL CONSERVATION COMMISSION
Well Location and Acreage Dedication Plat

Section A.

Date June 10, 1960

Operator Astec Oil and Gas Company Lease McClambert
Well No. 25-2 Unit Letter H Section 13 Township 20N Range 10W NMPM
Located 800 Feet From South Line, 1800 Feet From West Line
County Santa Fe G. L. Elevation 5710 Dedicated Acreage 300 Acres
Name of Producing Formation Bakken Pool Angel Peak Extension

1. Is the Operator the only owner* in the dedicated acreage outlined on the plat below?
Yes XX No
2. If the answer to question one is "no," have the interests of all the owners been consolidated by communitization agreement or otherwise? Yes No . If answer is "yes,"
Type of Consolidation
3. If the answer to question two is "no," list all the owners and their respective interests below:

<u>Owner</u>	<u>Land Description</u>

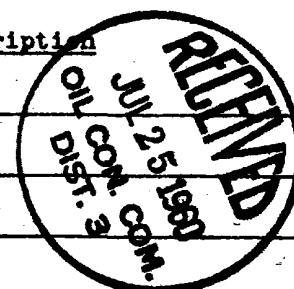

Section B

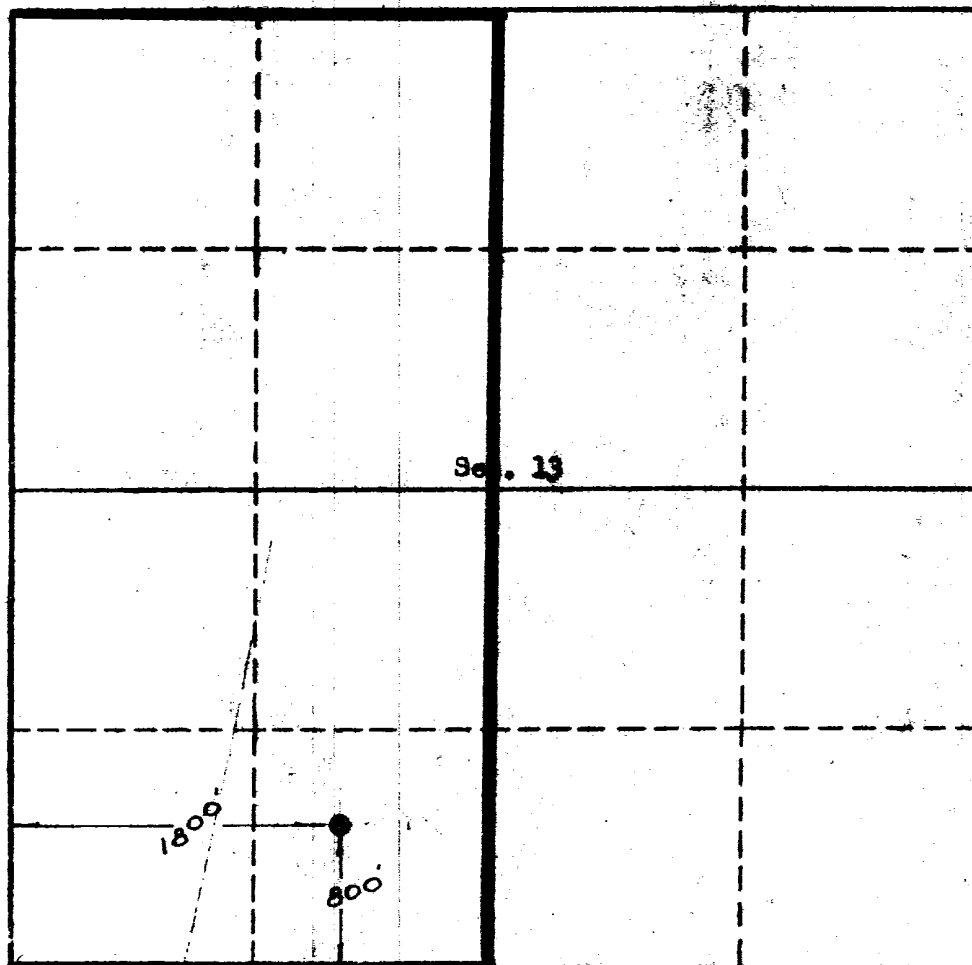

This is to certify that the information in Section A above is true and complete to the best of my knowledge and belief.

Astec Oil and Gas Company
(Operator)

ORIGINAL SIGNED BY JOE C. SALMON
(Representative)
P. O. Drawer 570
Paradise, New Mexico

Address

This is to certify that the well location shown on this plat in accordance with the plat is based on actual surveys made by me or under my supervision and that the same is true to the best of my knowledge and belief.

Date Surveyed June 6, 1960

Ernest V. Echohawk
Registered Land Surveyor.

Certificate No. 1545