

(SUBMIT IN TRIPLICATE)

UNITED STATES  
DEPARTMENT OF THE INTERIOR  
GEOLOGICAL SURVEY

Land Office S.F.Lease No. 0470398Unit 0

RECEIVED

## SUNDRY NOTICES AND REPORTS ON WELLS

NOTICE OF INTENTION TO DRILL.....	<input checked="" type="checkbox"/>	SUBSEQUENT REPORT OF WATER SHUT-OFF.....	
NOTICE OF INTENTION TO CHANGE PLANS.....		SUBSEQUENT REPORT OF SHOOTING OR ACIDIZING.....	
NOTICE OF INTENTION TO TEST WATER SHUT-OFF.....		SUBSEQUENT REPORT OF ALTERING CASING.....	
NOTICE OF INTENTION TO RE-DRILL OR REPAIR WELL.....		SUBSEQUENT REPORT OF RE-DRILLING OR REPAIR.....	
NOTICE OF INTENTION TO SHOOT OR ACIDIZE.....		SUBSEQUENT REPORT OF ABANDONMENT.....	
NOTICE OF INTENTION TO PULL OR ALTER CASING.....		SUPPLEMENTARY WELL HISTORY.....	
NOTICE OF INTENTION TO ABANDON WELL.....			

(INDICATE ABOVE BY CHECK MARK NATURE OF REPORT, NOTICE, OR OTHER DATA)

May 31, 1960

SIPCO Kirtz Federal

Well No. 10-18 is located 1050 ft. from [N] line and 1050 ft. from [E] line of sec. 18

NE/4, Sec. 18 T 28 N R 10 W NMPM  
(1/4 Sec. and Sec. No.) (Twp.) (Range) (Meridian)

Angela Peak Dakota San Juan New Mexico  
(Field) (County or Subdivision) (State or Territory)

Ground Level

The elevation of the ~~surface~~ above sea level is 5853.0 ft.

## DETAILS OF WORK

(State names of and expected depths to objective sands; show sizes, weights, and lengths of proposed casings; indicate mudding jobs, cementing points, and all other important proposed work)

Intend to drill to top of Morrison formation at est. 6600 TD.

1. Set 8 5/8" OD, 250/ft. B-40 csg to approx 250' KB and out to surface.
2. Drill 7 7/8" hole to approx. 6600' KB.
3. Set 4 1/2" OD, 11.60/ft. J-55 ST&C csg w/stage tool below Picture Cliff formation and 2 stage cement.
4. Complete well as a single Dakota gas-condensate well.
5. Expected formation tops:

Picture Cliff	1972	Gallup	5650
Cliff House	3500	Greenhorn	6240
Mances	4430	Dakota	6375
Niobrara	5505	Morrison (TD)	6600

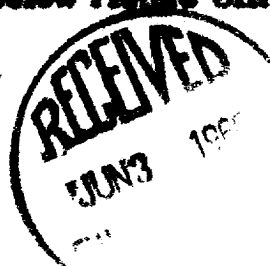

I understand that this plan of work must receive approval in writing by the Geological Survey before operations may be commenced.

Company Sunset International Petroleum CorporationAddress 444 - 17th Street - 5th FloorDenver 2, Colorado

By

Thomas S. F. Papp

Title

Production Engineer

**NEW MEXICO OIL CONSERVATION COMMISSION**  
**WELL LOCATION AND ACREAGE DEDICATION PLAT**

**RECEIVED**  
 FORM C-128  
 Revised 5/1/57

SEE INSTRUCTIONS FOR COMPLETING THIS FORM ON THE REVERSE SIDE

Operator <b>SUNSET INTERNATIONAL PETROLEUM CORPORATION</b>		Lease <b>FEDERAL</b>		U. S. GEOLOGICAL SURVEY <b>SIPCO</b>	
Unit Letter <b>G</b>	Section <b>18</b>	Township <b>28 NORTH</b>	Range <b>10 WEST</b>	County <b>SAN JUAN</b>	

Actual Footage Location of Well: <b>1850</b> feet from the <b>NORTH</b> line and <b>1850</b> feet from the <b>EAST</b> line					
Ground Level Elev. <b>5853.0</b>	Producing Formation <b>Dakota</b>	Pool <b>Angels Peak Dakota</b>	Dedicated Acreage: <b>320</b> Acres		

- Ref: GLO plat dated 19 July 1915
- Is the Operator the only owner in the dedicated acreage outlined on the plat below? YES ☐ NO ☒ ("Owner" means the person who has the right to drill into and to produce from any pool and to appropriate the production either for himself or for himself and another. (65-3-29 (e) NMSA 1935 Comp.)
  - If the answer to question one is "no," have the interests of all the owners been consolidated by communication, agreement or otherwise? YES ☒ NO ☐ If answer is "yes," Type of Consolidation **Utilization agreement**
  - If the answer to question two is "no," list all the owners and their respective interests below:

Owner	Land Description

**RECEIVED**  
**JUN 3 1960**  
**OIL CON. COM.**  
**DIST. 3**  
**CERTIFICATION**

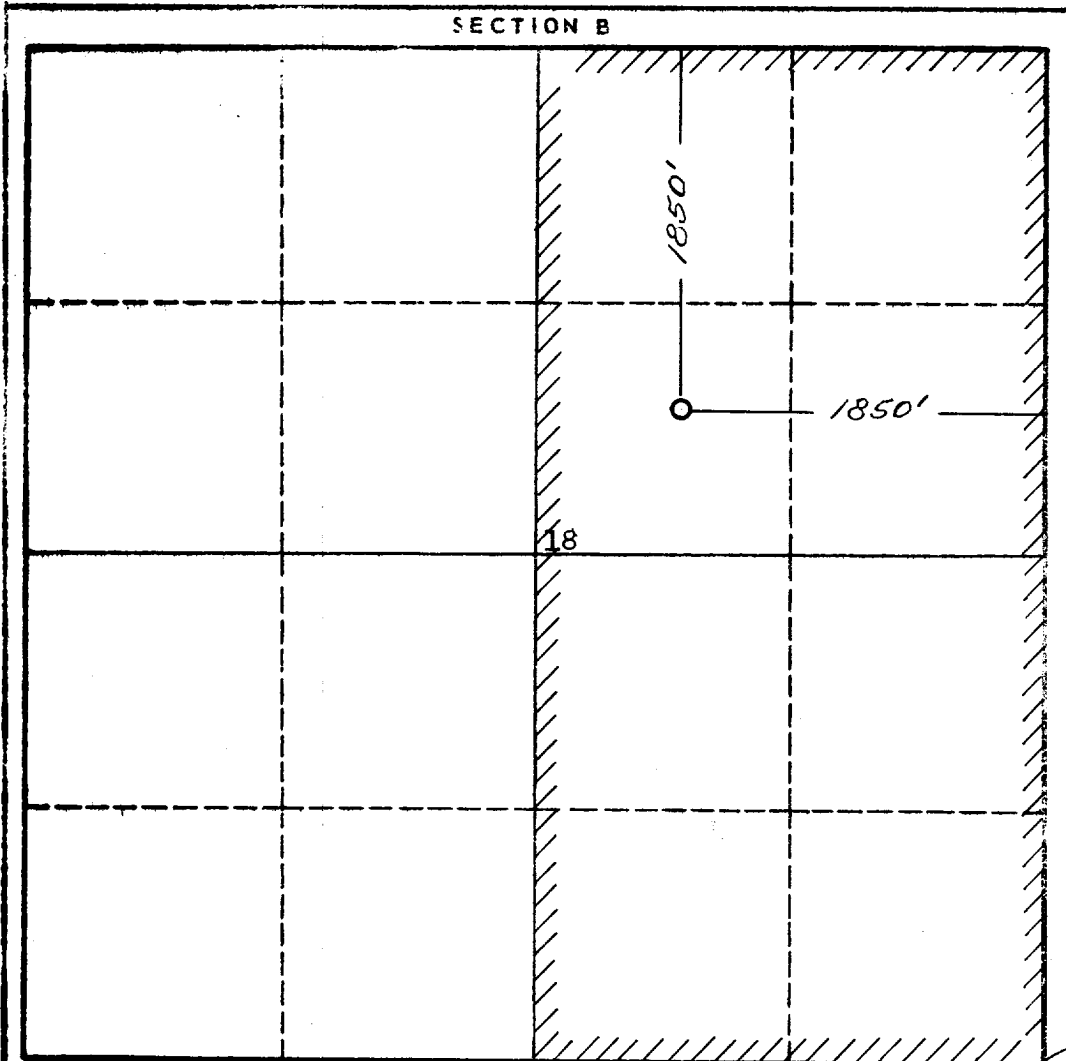

I hereby certify that the information in SECTION A above is true and complete to the best of my knowledge and belief.

**Thomas F. Popp**  
 Name  
**Thomas F. Popp**  
 Position  
**Dist. Supt.**  
 Company  
**Sunset Int'l. Petr. Corp.**  
 Date  
**May 31, 1960**

I hereby certify that the well location shown on the plat in SECTION B was plotted from field notes of actual surveys made by me or under my supervision, and that the same is true and correct to the best of my knowledge and belief.

Date Surveyed  
**20 May 1960**  
 Registered Professional Engineer and/or Land Surveyor  
**James P. Leese**  
 Certificate No.  
**1463**

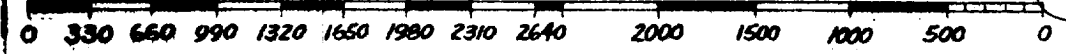

## INSTRUCTIONS FOR COMPLETION OF FORM C-128

1. Operator shall furnish and certify to the information called for in Section A.
2. Operator shall outline the dedicated acreage for *both* oil and gas wells on the plat in Section B.
3. A registered professional engineer or land surveyor registered in the State of New Mexico or approved by the Commission shall show on the plat the location of the well and certify this information in the space provided.
4. All distances shown on the plat must be from the outer boundaries of the Section.
5. If additional space is needed for listing owners and their respective interests as required in question 3 of Section A, please use space below.