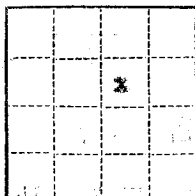

(SUBMIT IN TRIPLICATE)

Land Office Santa FeLease No. 047039 B

Unit _____

UNITED STATES
DEPARTMENT OF THE INTERIOR
GEOLOGICAL SURVEY

ACTING _____

SUNDRY NOTICES AND REPORTS ON WELLS

NOTICE OF INTENTION TO DRILL.....	<input checked="" type="checkbox"/>	SUBSEQUENT REPORT OF WATER SHUT-OFF.....	
NOTICE OF INTENTION TO CHANGE PLANS.....		SUBSEQUENT REPORT OF SHOOTING OR ACIDIZING.....	
NOTICE OF INTENTION TO TEST WATER SHUT-OFF.....		SUBSEQUENT REPORT OF ALTERING CASING.....	
NOTICE OF INTENTION TO RE-DRILL OR REPAIR WELL.....		SUBSEQUENT REPORT OF RE-DRILLING OR REPAIR.....	
NOTICE OF INTENTION TO SHOOT OR ACIDIZE.....		SUBSEQUENT REPORT OF ABANDONMENT.....	
NOTICE OF INTENTION TO PULL OR ALTER CASING.....		SUPPLEMENTARY WELL HISTORY.....	
NOTICE OF INTENTION TO ABANDON WELL.....			

(INDICATE ABOVE BY CHECK MARK NATURE OF REPORT, NOTICE, OR OTHER DATA)

November 7, 1958

SIPCO Kutz "E" Federal

Well No. 1 is located 1848 ft. from N line and 1850 ft. from E line of sec. 17NE/4, Sec. 17
(1/4 Sec. and Sec. No.)29N
(Twp.)10W
(Range)NMPM
(Meridian)Undesignated
(Field)San Juan
(County or Subdivision)New Mexico
(State or Territory)The elevation of the derrick floor above sea level is 5880 ft. (Estimated)

DETAILS OF WORK

(State names of and expected depths to objective sands; show sizes, weights, and lengths of proposed casings; indicate measuring points, and all other important proposed work)

Intend to drill to Dakota at estimated 6650' KB with rotary tools.

1. Set 10 3/4" OD, 32.75#/ft, H-40 csg to 250' KB.
2. Drill to approximately 4500' KB with mud.
3. Set approximately 4500' of 7 5/8" OD, 26.40#/ft, N-80 csg.
4. Drill from 4500' to TD with natural gas.
5. Set approximately 2400' of 5 1/2" OD, 15.5#/ft, J-55 liner from 4000' to TD.
6. Complete well as a Dakota gas well.
7. Expected formation tops:

Kirkland - 1200'

Menciee - 3700'

Gallup - 5600'

Dakota - 6400'

Fruitland - 1700'

Point Lookout - 4300'

Tocito - 5900'

Morrison - 6650'

Pictured Cliffs - 2000'

Mancoos - 4500'

Greenhorn - 6300'

Cliff House - 3600'

Niobrara - 5500'

Graspero - 6350'

I understand that this work will receive approval from the Geological Survey before operations may be commenced.

Company Sunset International Petroleum CorporationAddress P. O. Box 4527Denver 1, ColoradoBy J. A. Jones J. A. JonesTitle Production Engineer

2-11-72

Dear Sir,

I have the pleasure to acknowledge the receipt of your letter of the 2nd inst. in relation to the above matter.

The information you have provided is being reviewed and a decision will be made as soon as possible.

Very truly yours,

John Doe



Enclosed for your information are two copies of the report of the investigation conducted by the relevant authorities.

The report contains details of the findings and recommendations for further action.

Please advise me of any further steps you wish to take.

Yours faithfully,

John Doe

NEW MEXICO OIL CONSERVATION COMMISSION
Well Location and Acreage Dedication Plat

Section A.

Date November 7, 1958

Operator SUNSET INTERNATIONAL PETROLEUM CORP. Lease SIPCO-KUTZ-FEDERAL
Well No. 1-E Unit Letter G Section 17 Township 28 NORTH Range 10 WEST NMPM
Located 1846' Feet From THE NORTH Line, 1850' Feet From THE EAST Line
County SAN JUAN G. L. Elevation 5868.0 Dedicated Acreage 160 Acres
Name of Producing Formation Dakota Sand Pool Undesignated

1. Is the Operator the only owner* in the dedicated acreage outlined on the plat below?
Yes X No .
2. If the answer to question one is "no," have the interests of all the owners been consolidated by communitization agreement or otherwise? Yes No . If answer is "yes," Type of Consolidation
3. If the answer to question two is "no," list all the owners and their respective interests below:
Ref: GLO Plat dated 19 July 1915

Owner

Land Description

Section B

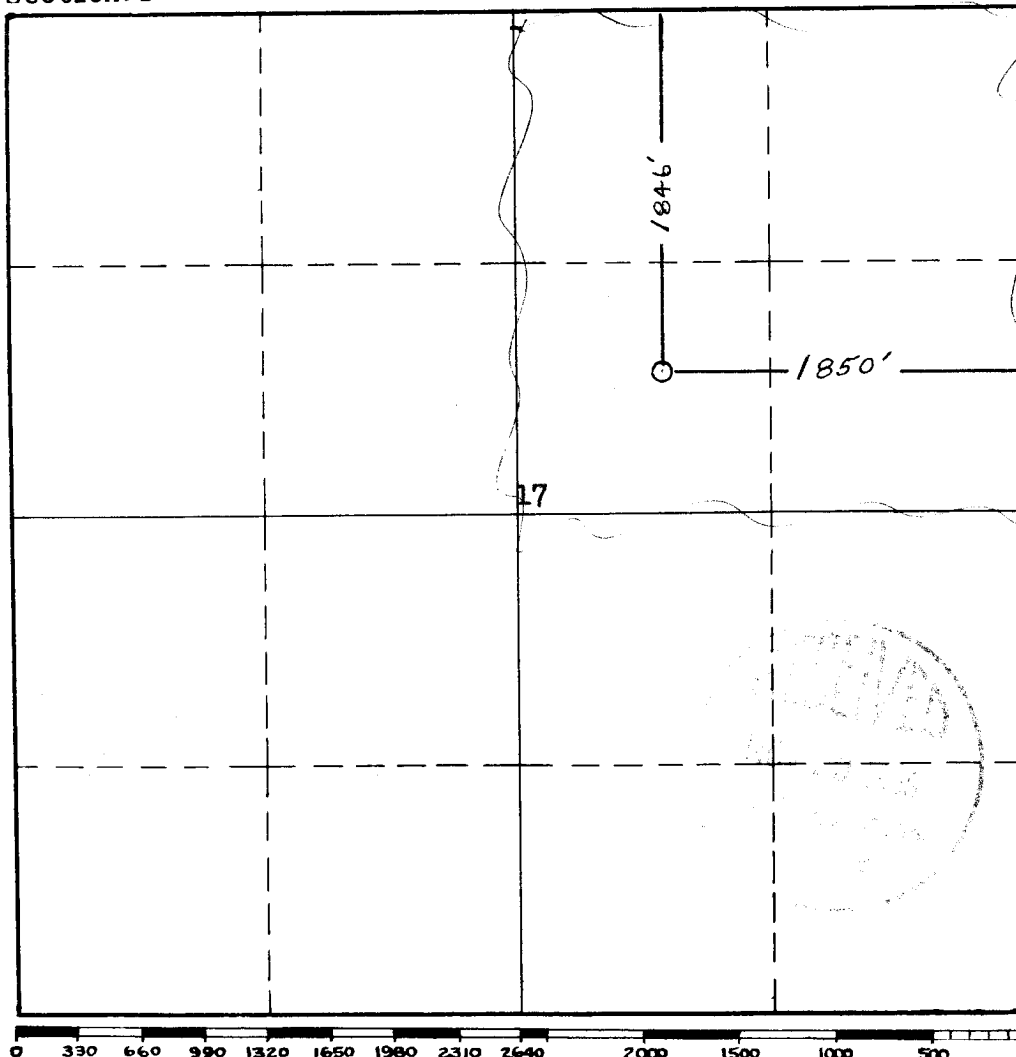

This is to certify that the information in Section A above is true and complete to the best of my knowledge and belief.

Sunset International Pet. Corp.
(Operator)

J. A. Jones
(Representative)

P. O. Box 1527, Denver, Colo.
Address

This is to certify that the well location shown on the plat in Section B was plotted from field notes of actual surveys made by me or under my supervision and that the same is true and correct to the best of my knowledge and belief.

Date Surveyed 4 Nov. 1958

James P. Leese
Registered Professional
Engineer and/or Land Surveyor.

James P. Leese
Certificate No. 1463

(See instructions for completing this form on the reverse side)

INSTRUCTIONS FOR COMPLETION:

1. Operator shall furnish and certify to the information called for in Section A.
2. Operator shall outline the dedicated acreage for both oil and gas wells on the plat in Section B.
3. A registered professional engineer or land surveyor registered in the State of New Mexico or approved by the Commission shall show on the plat the location of the well and certify this information in the space provided.
4. All distances shown on the plat must be from the outer boundaries of Section.
5. If additional space is needed for listing owners and their respective interests as required in question 3, Section A, please use space below

* "Owner" means the person who has the right to drill into and to produce from any pool and to appropriate the production either for himself or for himself and another. (65-3-29 (e) NMSA 1953 Comp.)