

Form 9-381a
(Feb. 1951)

(SUBMIT IN TRIPLICATE)

Land Office Santa Fe
Lease No. 047039 B
Unit _____

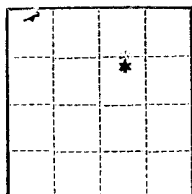

UNITED STATES
DEPARTMENT OF THE INTERIOR
GEOLOGICAL SURVEY

SUNDRY NOTICES AND REPORTS ON WELLS

NOTICE OF INTENTION TO DRILL.....	<input checked="" type="checkbox"/>	SUBSEQUENT REPORT OF WATER SHUT-OFF.....	
NOTICE OF INTENTION TO CHANGE PLANS.....		SUBSEQUENT REPORT OF SHOOTING OR ACIDIZING.....	
NOTICE OF INTENTION TO TEST WATER SHUT-OFF.....		SUBSEQUENT REPORT OF ALTERING CASING.....	
NOTICE OF INTENTION TO RE-DRILL OR REPAIR WELL.....		SUBSEQUENT REPORT OF RE-DRILLING OR REPAIR.....	
NOTICE OF INTENTION TO SHOOT OR ACIDIZE.....		SUBSEQUENT REPORT OF ABANDONMENT.....	
NOTICE OF INTENTION TO PULL OR ALTER CASING.....		SUPPLEMENTARY WELL HISTORY.....	
NOTICE OF INTENTION TO ABANDON WELL.....			

(INDICATE ABOVE BY CHECK MARK NATURE OF REPORT, NOTICE, OR OTHER DATA)

October 5, 19 55

Well No. Kutz 2-H is located 1440 ft. from N line and 845 ft. from E line of sec. 17

NE 1/4 28N 10W New Mexico PM
(1/4 Sec. and Sec. No.) (Twp.) (Range) (Meridian)
Fulcher Kutz San Juan New Mexico
(Field) (County or Subdivision) (State or Territory)

The elevation of the ~~derrick floor~~ ^{Ground Level} above sea level is 5823.3 ft.

DETAILS OF WORK

(State names of and expected depths to objective sands; show sizes, weights, and lengths of proposed casings; indicate mudding jobs, cementing points, and all other important proposed work)

Pictured Cliff Sand well. Approximate depth 2000 feet. Set 8 5/8 inch new surge pipe, cemented top to bottom. Drill with rotary to top of PC sand set 5 1/2, 14 lb J55 casing cement with 100 sacks. Drill thru PC sand with cable tools. Sand Frac with 10,000 gallons oil and 10,000 lbs sand. Run 1" tubing to complete. Smith Drilling Co. contractor.

I understand that this plan of work must receive approval in writing by the Geological Survey before operations may be commenced.

Company Kutz Canon Oil and Gas Co.

Address U. S. National Bank Bldg.

Denver, Colorado

By R. H. Martin

Title Secretary

Indicated Average 160

Company KUTZ CANYON OIL AND GAS COMPANY

Lease Day S. 7. 047039 'B" Well No. 2-H

Sec. 17, T. 28 N., R. 10 W. N.M.P.M.

Location 1440' FROM THE NORTH LINE AND 845' FROM
THE EAST LINE.

Elevation 5823.3 UNGRADED GROUND.

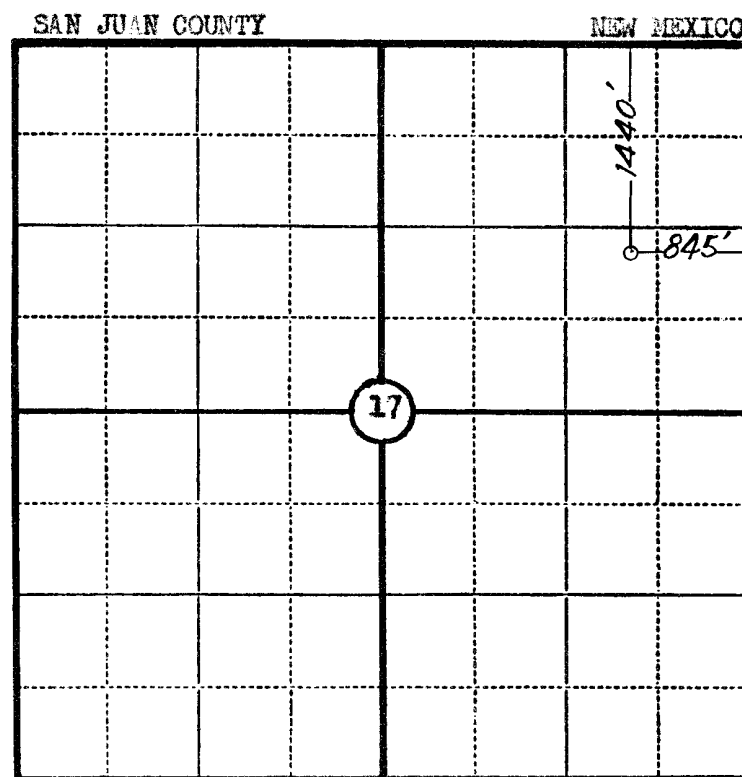

Scale—4 inches equal 1 mile.

This is to certify that the above plat was prepared from field notes of actual surveys made by me or under my supervision and that the same are true and correct to the best of my knowledge and belief.

Seal:

James P. Leese

Registered Land Surveyor.

James P. Leese

N. Mex. Reg. No. 1463

Surveyed 26 September, 19 55

SAN JUAN ENGINEERING COMPANY, FARMINGTON, N. M.

NO. OF COPIES RECEIVED	5
DISTRIBUTION	
SANTA FE	1
FILE	1
U.S.G.S.	
LAND OFFICE	
TRANSPORTER	OIL
	GAS
OPERATOR	2
PRORATION OFFICE	

NEW MEXICO OIL CONSERVATION COMMISSION
REQUEST FOR ALLOWABLE
AND
AUTHORIZATION TO TRANSPORT OIL AND NATURAL GAS

Form C-104
Supersedes Old C-104 and C-110
Effective 1-1-65

I.

Operator Petroleum Corporation of Texas	
Address P. O. Box 752, Breckenridge, Texas 76024	
Reason(s) for filing (Check proper box)	Other (Please explain)
New Well <input type="checkbox"/>	Change in Transporter of:
Recompletion <input type="checkbox"/>	Oil <input type="checkbox"/> Dry Gas <input type="checkbox"/>
Change in Ownership <input checked="" type="checkbox"/>	Casinghead Gas <input type="checkbox"/> Condensate <input type="checkbox"/>
If change of ownership give name and address of previous owner King Oil, Inc., Davis Bldg., Dallas, Texas 75200	

II. DESCRIPTION OF WELL AND LEASE

Lease Name Day "H"	Well No. 2	Pool Name, Including Formation Fulcher-Kutz(Pictured Cliffs)	Kind of Lease State, Federal or Fee Federal
Location Unit Letter H ; 1440 Feet From The North Line and 845 Feet From The East			
Line of Section 17 Township 28N Range 10W, NMPM, San Juan County			

III. DESIGNATION OF TRANSPORTER OF OIL AND NATURAL GAS

Name of Authorized Transporter of Oil <input type="checkbox"/> or Condensate <input type="checkbox"/>	Address (Give address to which approved copy of this form is to be sent)	
Name of Authorized Transporter of Casinghead Gas <input type="checkbox"/> or Dry Gas <input checked="" type="checkbox"/>	Address (Give address to which approved copy of this form is to be sent)	
Southern Union Gas Company	Fidelity Union Tower, Dallas, Texas 75201	
If well produces oil or liquids, give location of tanks.	Unit	Sec.
	Twp.	Rge.
	Is gas actually connected? When	
	Yes 4/5/56	

If this production is commingled with that from any other lease or pool, give commingling order number:

IV. COMPLETION DATA

Designate Type of Completion - (X)	Oil Well	Gas Well	New Well	Workover	Deepen	Plug Back	Same Res'v.	Diff. Res'v.
Date Spudded	Date Compl. Ready to Prod.		Total Depth		P.B.T.D.			
Pool	Name of Producing Formation		Top Oil/Gas Pay		Tubing Depth			
Perforations					Depth Casing Shoe			
TUBING, CASING, AND CEMENTING RECORD								
HOLE SIZE	CASING & TUBING SIZE		DEPTH SET		SACKS CEMENT			

V. TEST DATA AND REQUEST FOR ALLOWABLE OIL WELL

(Test must be after recovery of total volume of load oil and must be equal to or exceed top allowable for this depth or be for full 24 hours)

Date First New Oil Run To Tanks	Date of Test	Producing Method (Flow, pump, gas lift, etc.)	
Length of Test	Tubing Pressure	Casing Pressure	Choke Size
Actual Prod. During Test	Oil-Bbbls.	Water-Bbbls.	Gas-MCF

GAS WELL

Actual Prod. Test-MCF/D	Length of Test	Bbbls. Condensate/MMCF	Gravity of Condensate
Testing Method (pitot, back pr.)	Tubing Pressure	Casing Pressure	Choke Size

VI. CERTIFICATE OF COMPLIANCE

I hereby certify that the rules and regulations of the Oil Conservation Commission have been complied with and that the information given above is true and complete to the best of my knowledge and belief.

Mary D. Taylor
(Signature)
Production Clerk
(Title)
April 4, 1967
(Date)

OIL CONSERVATION COMMISSION

APPROVED _____, 19____
BY Original Signed by Emory C. Arnold
TITLE

This form is to be filed in compliance with RULE 1104.

If this is a request for allowable for a newly drilled or deepened well, this form must be accompanied by a tabulation of the deviation tests taken on the well in accordance with RULE 111.

All sections of this form must be filled out completely for allowable on new and recompleted wells.

Fill out Sections I, II, III, and VI only for changes of owner, well name or number, or transporter, or other such change of condition.

Separate Forms C-104 must be filed for each pool in multiply completed wells.

NO. OF COPIES RECEIVED		4
DISTRIBUTION		
SANTA FE		/
FILE		/
U.S.G.S.		
LAND OFFICE		
TRANSPORTER	OIL	
	GAS	/
OPERATOR		
PRORATION OFFICE		

NEW MEXICO OIL CONSERVATION COMMISSION
REQUEST FOR ALLOWABLE
AND
AUTHORIZATION TO TRANSPORT OIL AND NATURAL GAS

Form C-104
Supersedes Old C-104 and C-110
Effective 1-1-65

I.

Operator Petroleum Corporation of Texas		
Address Box 911, Breckenridge, Texas 76024		
Reason(s) for filing (Check proper box)		Other (Please explain)
New Well <input type="checkbox"/>	Change in Transporter of:	Effective 8-1-70
Recompletion <input type="checkbox"/>	Oil <input type="checkbox"/> Dry Gas <input checked="" type="checkbox"/>	
Change in Ownership <input type="checkbox"/>	Casinghead Gas <input type="checkbox"/> Condensate <input type="checkbox"/>	

If change of ownership give name
and address of previous owner -----

II. DESCRIPTION OF WELL AND LEASE

Lease Name Day "H"	Well No. 2	Pool Name, including Formation Fulcher-Kutz (Pictured Cliffs)	Kind of Lease State, Federal or Fee Federal
Location Unit Letter H ; 1440 Feet From The North Line and 845 Feet From The East Line of Section 17 , Township 28N Range 10W , NMPM, San Juan County			

III. DESIGNATION OF TRANSPORTER OF OIL AND NATURAL GAS

Name of Authorized Transporter of Oil <input type="checkbox"/> or Condensate <input type="checkbox"/>	Address (Give address to which approved copy of this form is to be sent)	
Name of Authorized Transporter of Casinghead Gas <input type="checkbox"/> or Dry Gas <input checked="" type="checkbox"/>	Address (Give address to which approved copy of this form is to be sent)	
Southern Union Gathering Company	Fidelity Union Tower, Dallas, Texas 75201	
If well produces oil or liquids, give location of tanks.	Unit Sec. Twp. Rge.	Is gas actually connected? When Yes 4/5/56

If this production is commingled with that from any other lease or pool, give commingling order number: _____

IV. COMPLETION DATA

Designate Type of Completion - (X)	Oil Well	Gas Well	New Well	Workover	Deepen	Plug Back	Same Res'v.	Diff. Res'v.
Date Spudded	Date Compl. Ready to Prod.		Total Depth			P.B.T.D.		
Pool	Name of Producing Formation		Top Oil/Gas Pay			Tubing Depth		
Perforations						Depth Casing Shoe		
TUBING, CASING, AND CEMENTING RECORD								
HOLE SIZE	CASING & TUBING SIZE		DEPTH SET			SACKS CEMENT		

V. TEST DATA AND REQUEST FOR ALLOWABLE
OIL WELL

(Test must be after recovery of total volume of load oil and must be equal to or exceed top allowable for this depth or be for full 24 hours)

Date First New Oil Run To Tanks	Date of Test	Producing Method (Flow, pump, gas lift, etc.)	
Length of Test	Tubing Pressure	Casing Pressure	Choke Size
Actual Prod. During Test	Oil-Bbls.	Water-Bbls.	Gas-MCF

GAS WELL

Actual Prod. Test-MCF/D	Length of Test	Bbls. Condensate/MMCF	Gravity of Condensate
Testing Method (pitot, back pr.)	Tubing Pressure	Casing Pressure	Choke Size

VI. CERTIFICATE OF COMPLIANCE

I hereby certify that the rules and regulations of the Oil Conservation Commission have been complied with and that the information given above is true and complete to the best of my knowledge and belief.

Mary B. Taylor
(Signature)

Production Clerk

(Title)

August 7, 1970

(Date)

OIL CONSERVATION COMMISSION
AUG 10 1970

APPROVED _____, 19

BY _____

TITLE **SUPERVISOR DIST. #3**

This form is to be filed in compliance with RULE 1104.

If this is a request for allowable for a newly drilled or deepened well, this form must be accompanied by a tabulation of the deviation tests taken on the well in accordance with RULE 111.

All sections of this form must be filled out completely for allowable on new and recompleted wells.

Fill out Sections I, II, III, and VI only for changes of owner, well name or number, or transporter, or other such change of condition.

Separate Forms C-104 must be filed for each pool in multiply completed wells.