

(SUBMIT IN TRIPLICATE)

UNITED STATES
DEPARTMENT OF THE INTERIOR
GEOLOGICAL SURVEY

Land Office _____

Lease No. _____

Unit _____

SUNDRY NOTICES AND REPORTS ON WELLS

NOTICE OF INTENTION TO DRILL	SUBSEQUENT REPORT OF WATER SHUT-OFF
NOTICE OF INTENTION TO CHANGE PLANS	SUBSEQUENT REPORT OF SHOOTING OR ACIDIZING
NOTICE OF INTENTION TO TEST WATER SHUT-OFF	SUBSEQUENT REPORT OF ALTERING CASING
NOTICE OF INTENTION TO RE-DRILL OR REPAIR WELL	SUBSEQUENT REPORT OF RE-DRILLING OR REPAIR
NOTICE OF INTENTION TO SHOOT OR ACIDIZE	SUBSEQUENT REPORT OF ABANDONMENT
NOTICE OF INTENTION TO PULL OR ALTER CASING	SUPPLEMENTARY WELL HISTORY
NOTICE OF INTENTION TO ABANDON WELL	

(INDICATE ABOVE BY CHECK MARK NATURE OF REPORT) **Oct. 5, 1955**

1140
2-8

1140

X

845

I

179

Well **N2 Section 17** located **100** ft. from **N** line and **845** ft. from **E** line of sec.

Fulcher-Kuts Canyon

San Juan

New Mexico.

(1/4 Sec. and Sec. No.)

(Twp.)

(Range)

(Meridian)

(Field)

(County or Subdivision)

(State or Territory)

The elevation of the derrick floor above sea level is _____ ft.

DETAILS OF WORK

(State of New Mexico) **Surface pipe, cemented top to bottom. Drill with rotary to top of PC Sand and set 3 1/2 inch, 14 lb J55 Casing cement with 100 sacks. Drill thru PC sand with cable tools. Sand-Frac with 10,000 gallons oil and 10,000 lbs sand. Run 1" tubing to complete. Smith Drilling Co., contractors.**

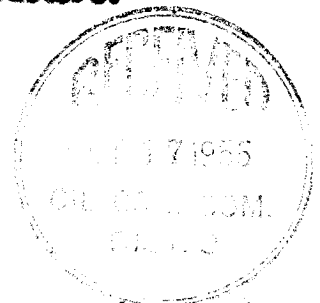

KUTS CANYON OIL & GAS CO.

I understand that this plan of work must receive approval in writing by the Geological Survey before operations may be commenced.

Company **U. S. National Bank Bldg.**
Denver, Colo.

Address _____

By *[Signature]*

Title **Secretary**

Company KUTZ CANYON OIL AND GAS COMPANY

Lease S.F. 047039-B Well No. Z-H

Sec. 17, T. 28 N., R. 10 W., N.M.P.M.

Location 1/40° FROM THE NORTH LINE AND 845° FROM THE EAST LINE.

Elevation 5823.3 UNGRADED GROUND.

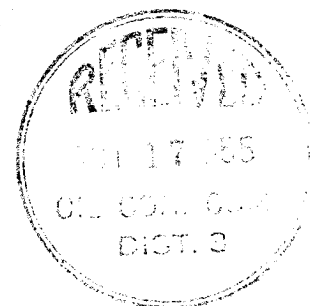
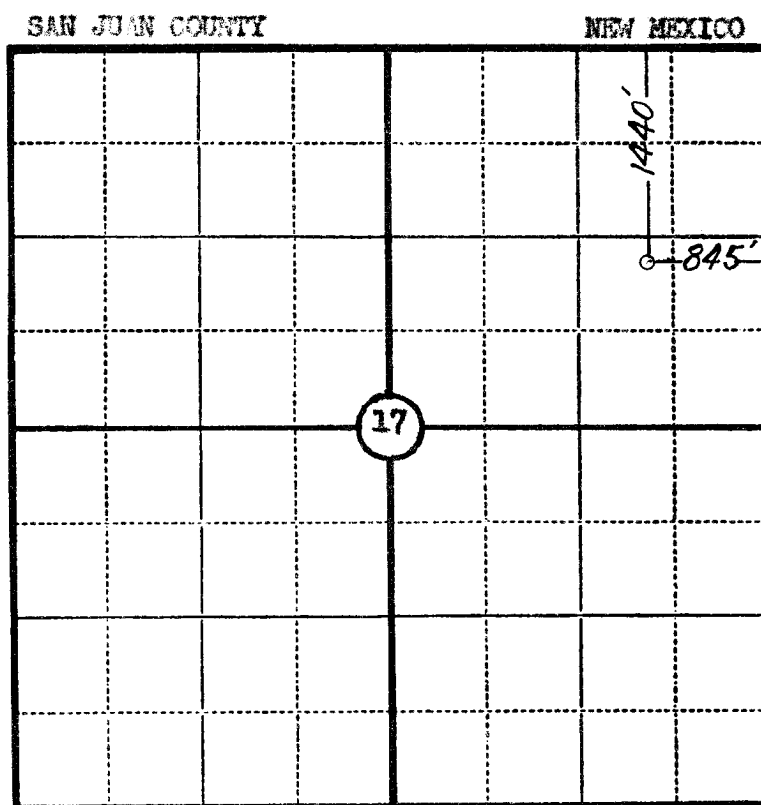

Scale—4 inches equal 1 mile.

This is to certify that the above plat was prepared from field notes of actual surveys made by me or under my supervision and that the same are true and correct to the best of my knowledge and belief.

Seal:

James P. Leese
Registered Land Surveyor.
James P. Leese
N. Mex. Reg. No. 1463

Surveyed 26 September, 1955

SAN JUAN ENGINEERING COMPANY, FARMINGTON, N. M.