

Form 9-381a
(Feb. 1951)

(SUBMIT IN TRIPLICATE)

Land Office _____

Lease No. SF 047039B

Unit _____

UNITED STATES
DEPARTMENT OF THE INTERIOR
GEOLOGICAL SURVEY

SUNDRY NOTICES AND REPORTS ON WELLS

NOTICE OF INTENTION TO DRILL	<input checked="" type="checkbox"/>	SUBSEQUENT REPORT OF WATER SHUT-OFF	
NOTICE OF INTENTION TO CHANGE PLANS		SUBSEQUENT REPORT OF SHOOTING OR ACIDIZING	
NOTICE OF INTENTION TO TEST WATER SHUT-OFF		SUBSEQUENT REPORT OF ALTERING CASING	
NOTICE OF INTENTION TO RE-DRILL OR REPAIR WELL		SUBSEQUENT REPORT OF RE-DRILLING OR REPAIR	
NOTICE OF INTENTION TO SHOOT OR ACIDIZE		SUBSEQUENT REPORT OF ABANDONMENT	
NOTICE OF INTENTION TO PULL OR ALTER CASING		SUPPLEMENTARY WELL HISTORY	
NOTICE OF INTENTION TO ABANDON WELL			

(INDICATE ABOVE BY CHECK MARK NATURE OF REPORT, NOTICE, OR OTHER DATA)

December 21, 1959

Well No. 1 is located 760' ft. from N line and 1586 ft. from W line of sec. 17

NW/4 Sec. 17 (1/4 Sec. and Sec. No.) T 28 N R 10 W (Twp.) (Range) NMPM (Meridian)
Fulcher-Kutz BC (Field) San Juan (County or Subdivision) New Mexico (State or Territory)

The elevation of the derrick floor above sea level is 5354 ft.

DETAILS OF WORK

(State names of and expected depths to objective sands; show sizes, weights, and lengths of proposed casings; indicate mudding jobs, cementing points, and all other important proposed work)

Objective sand is the Pictured Cliffs
Expected total depth is 2100' approx.
Surface Casing proposed is 100' 8 5/8" J-55, 24# cemented w/ 75sacks
Production casing proposed is 2100' 5 1/2" J-55, 15.50# cemented w/ 100sacks.

The well name is EPROC Associates No. 1 Binson-Federal



I understand that this plan of work must receive approval in writing by the Geological Survey before operations may be commenced.

Company EPROC Associates

Address BOX 1710

Durango, Colorado

By EPROC Associates
RE Launch

Title General Partner

Approved subject to state approval of wellhead location.

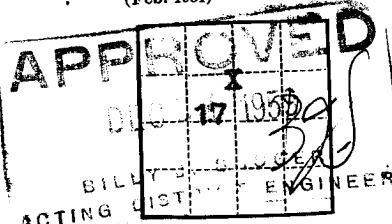



NEW MEXICO OIL CONSERVATION COMMISSION
WELL LOCATION AND ACREAGE DEDICATION PLAT

FORM C-128
Revised 3/1/57

SEE INSTRUCTIONS FOR COMPLETING THIS FORM ON THE REVERSE SIDE

SECTION A

Operator E P R O C Associates		Lease		Well No. 1 Bimson-Federal	
Unit Letter	Section 17	Township 28 North	Range 10 West	County San Juan	

Actual Footage Location of Well:

760 feet from the **North** line and **1586** feet from the **West** line

Ground Level Elev. 5846 ft.	Producing Formation Pictured Cliffs	Pool Fulcher - Kutz	Dedicated Acreage: 160 Acres
---------------------------------------	---	-------------------------------	--

1. Is the Operator the only owner in the dedicated acreage outlined on the plat below? YES ☒ NO ☐ ("Owner" means the person who has the right to drill into and to produce from any pool and to appropriate the production either for himself or for himself and another. (65-3-29 (e) NMSA 1935 Comp.)
2. If the answer to question one is "no," have the interests of all the owners been consolidated by communication agreement or otherwise? YES ☐ NO ☐ . If answer is "yes," Type of Consolidation ☐
3. If the answer to question two is "no," list all the owners and their respective interests below:

Owner	Land Description
-------	------------------

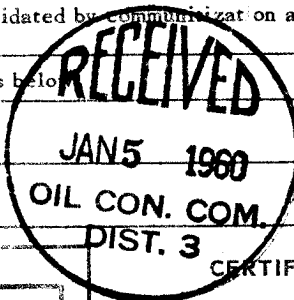

SECTION B

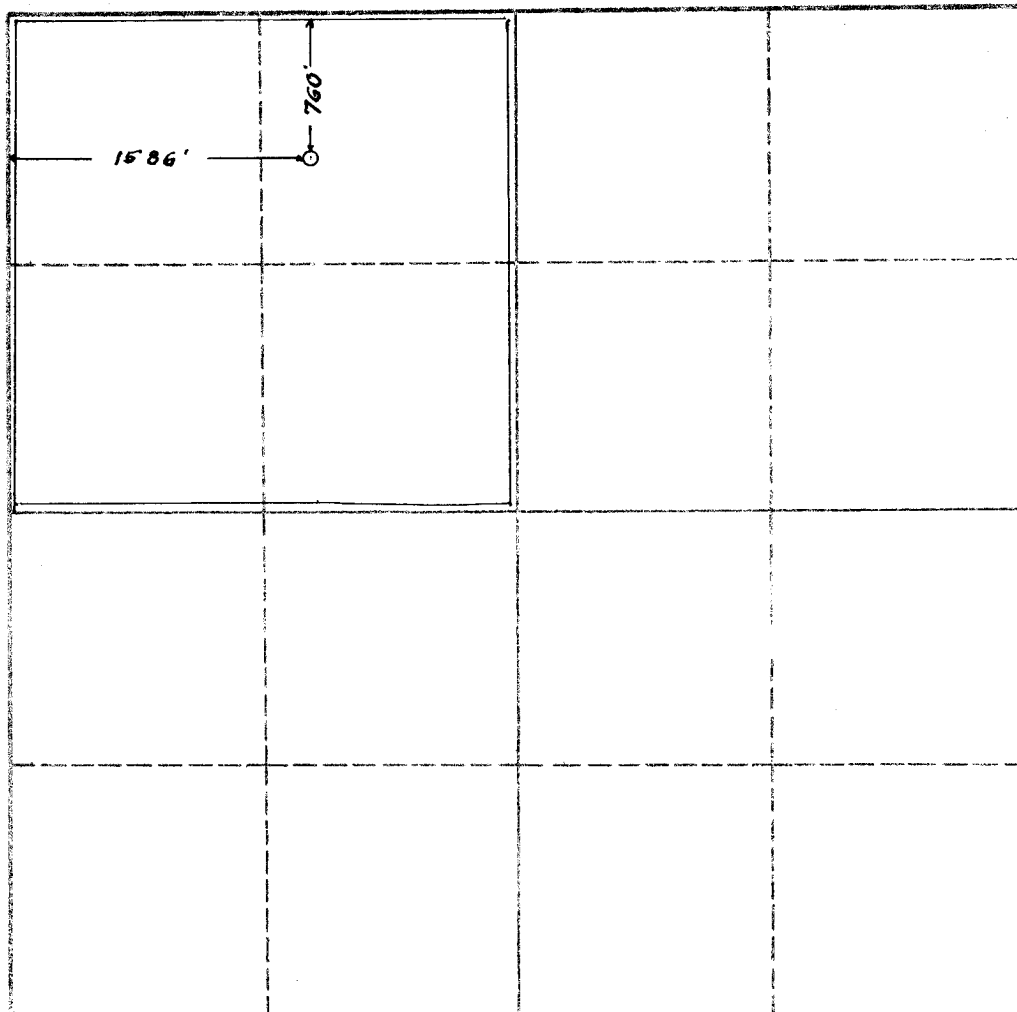

CERTIFICATION

I hereby certify that the information in SECTION A above is true and complete to the best of my knowledge and belief.

Name **Robert E. Lauth**
Position **General Partner**
Company **EPROC Associates**
Date **December 31, 1959**

I hereby certify that the well location shown on map in SECTION B was plotted from field notes of actual surveys made by me or under my supervision, and that the same is true and correct to the best of my knowledge and belief.

Date Surveyed
December 15, 1959
Registered Professional Engineer
and/or Land Surveyor

Arthur E. Brown
Certificate No. **1643**

0 330 660 990 1320 1650 1980 2310 2640 2000 1500 1000 500 0

INSTRUCTIONS FOR COMPLETION OF FORM C-128

1. Operator shall furnish and certify to the information called for in Section A.
2. Operator shall outline the dedicated acreage for *both* oil and gas wells on the plat in Section B.
3. A registered professional engineer or land surveyor registered in the State of New Mexico or approved by the Commission shall show on the plat the location of the well and certify this information in the space provided.
4. All distances shown on the plat must be from the outer boundaries of the Section.
5. If additional space is needed for listing owners and their respective interests as required in question 3 of Section A, please use space below.

