

(SUBMIT IN TRIPLICATE)

Indian Agency Navajo Agency
Window Rock, ArizonaUNITED STATES
DEPARTMENT OF THE INTERIOR
GEOLOGICAL SURVEYAllottee _____
Lease No. 14-20-603-779

SUNDRY NOTICES AND REPORTS ON WELLS

NOTICE OF INTENTION TO DRILL	<input checked="" type="checkbox"/>	SUBSEQUENT REPORT OF WATER SHUT-OFF	
NOTICE OF INTENTION TO CHANGE PLANS		SUBSEQUENT REPORT OF SHOOTING OR ACIDIZING	
NOTICE OF INTENTION TO TEST WATER SHUT-OFF		SUBSEQUENT REPORT OF ALTERING CASING	
NOTICE OF INTENTION TO REDRILL OR REPAIR WELL		SUBSEQUENT REPORT OF REDRILLING OR REPAIR	
NOTICE OF INTENTION TO SHOOT OR ACIDIZE		SUBSEQUENT REPORT OF ABANDONMENT	
NOTICE OF INTENTION TO PULL OR ALTER CASING		SUPPLEMENTARY WELL HISTORY	
NOTICE OF INTENTION TO ABANDON WELL			

(INDICATE ABOVE BY CHECK MARK NATURE OF REPORT, NOTICE, OR OTHER DATA)

Navajo Allotted Gas Unit "A"

Farmington, New Mexico April 30, 1957Well No. 1 is located 990 ft. from [N] line and 1700 ft. from [E] line of sec. 25NE/4 of Section 25
(1/4 Sec. and Sec. No.)T-28-N
(Twp.)R-9-W
(Range)N.M.P.M.
(Meridian)Blanco Mesaverde
(Field)San Juan

(County or Subdivision)

New Mexico

(State or Territory)

The elevation of the derrick floor above sea level is 5855 ft.

DETAILS OF WORK

(State names of and expected depths to objective sands; show sizes, weights, and lengths of proposed casings; indicate mudding jobs, cementing points, and all other important proposed work)

We propose to drill the above well to approximately 4799' and complete in the Mesaverde zone. Stimulation will be as indicated upon reaching this depth.

Casing Program:

Size	Amount	Cement	Remarks
10-3/4"	200'	150 Sx	200% theoretical bill
7-5/8"	2440'	150 Sx	150% theoretical amount to top of Fruitland.
5-1/2"	4700'	100 Sx	

I understand that this plan of work must receive approval in writing by the Geological Survey before operations may be commenced.

Company Pan American Petroleum CorporationAddress Box 487Farmington, New MexicoBy [Signature]
Field Superintendent

Title _____

TO THE DIRECTOR, FBI
FROM THE DIRECTOR, FBI
SUBJECT: [Illegible]

100-36-10-15

[Illegible text block]

100-36-10-15

[Illegible text block]

[Illegible text block]

DATE	TIME	LOCATION	STATUS
100-36-10-15	10:00	FBI	Active
100-36-10-15	11:00	FBI	Active
100-36-10-15	12:00	FBI	Active
100-36-10-15	13:00	FBI	Active
100-36-10-15	14:00	FBI	Active
100-36-10-15	15:00	FBI	Active
100-36-10-15	16:00	FBI	Active
100-36-10-15	17:00	FBI	Active
100-36-10-15	18:00	FBI	Active
100-36-10-15	19:00	FBI	Active
100-36-10-15	20:00	FBI	Active
100-36-10-15	21:00	FBI	Active
100-36-10-15	22:00	FBI	Active
100-36-10-15	23:00	FBI	Active
100-36-10-15	00:00	FBI	Active

[Illegible text block]

OIL CONSERVATION COMMISSION

WELL LOCATION AND/OR GAS PRODUCTION PLAT

April 23, 1957

STANOLIND OIL AND GAS CO.

Share Allotted Gas Unit "A"

Well No. 1 SECTION 25 T40N. 28 NORTH T10W. 9 WEST,
DISTANCE 990 FEET FROM the NORTH CORNER 1700 FEET FROM the EAST
SAN JUAN COUNTY, NEW MEXICO

WELL OR PRODUCTION LOCATION Monterey Monterey 320

Note: All distances must be from outer boundary of section.

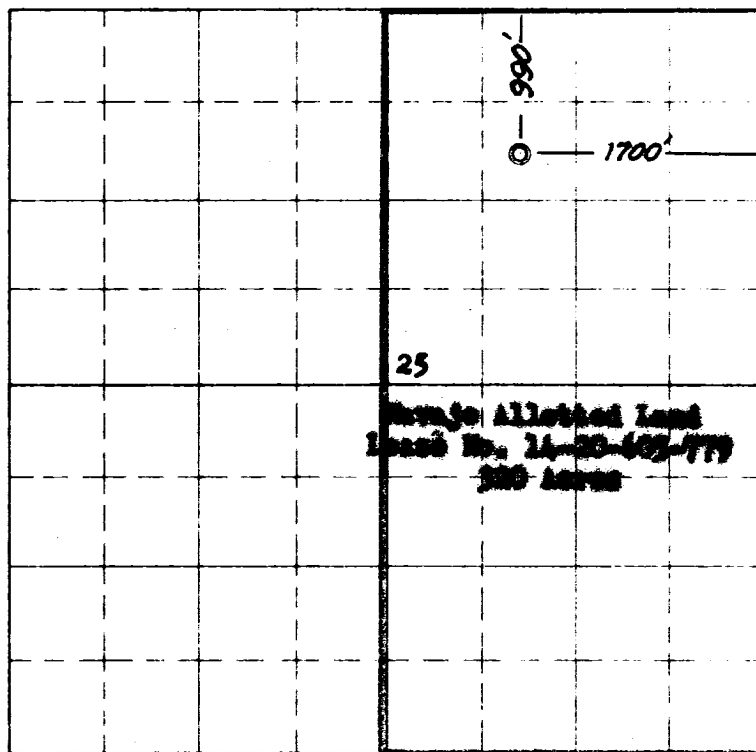

1/4 Cor. East Side of S. 2640' North, in Place.

MAY 1 1957



Sec. Cor. in place

Scale 1 inch equals 1 mile

This is to certify that the above plat was prepared from field notes of actual surveys made by me or under my supervision and that the same are true and correct to the best of my knowledge and belief.

Date Surveyed 14 JANUARY 1957

James P. Leese
Registered Professional Engineer and/or Land Surveyor

JAMES P. LEESE
N. MEX. REG. NO. 1463

1. Is this well a Dual Comp? Yes _____ No X
2. If the answer to Question 1 is yes, are there any other dual completed wells within the dedicated acreage?

Yes _____
Name R. H. Bauer, Jr.

Position Field Engineer
Pan American Petroleum Corporation
Representing _____
Box 467, Farmington, New Mexico
Address _____