

(SUBMIT IN TRIPLICATE)

UNITED STATES  
DEPARTMENT OF THE INTERIOR  
GEOLOGICAL SURVEY

Land Office Santa Fe  
Lease No. 077123  
Unit Warren

## SUNDRY NOTICES AND REPORTS ON WELLS

NOTICE OF INTENTION TO DRILL.....	<input checked="" type="checkbox"/>	SUBSEQUENT REPORT OF WATER SHUT-OFF.....
NOTICE OF INTENTION TO CHANGE PLANS.....		SUBSEQUENT REPORT OF SHOOTING OR ACIDIZING.....
NOTICE OF INTENTION TO TEST WATER SHUT-OFF.....		SUBSEQUENT REPORT OF ALTERING CASING.....
NOTICE OF INTENTION TO RE-DRILL OR REPAIR WELL.....		SUBSEQUENT REPORT OF RE-DRILLING OR REPAIR.....
NOTICE OF INTENTION TO SHOOT OR ACIDIZE.....		SUBSEQUENT REPORT OF ABANDONMENT.....
NOTICE OF INTENTION TO PULL OR ALTER CASING.....		SUPPLEMENTARY WELL HISTORY.....
NOTICE OF INTENTION TO ABANDON WELL.....		

(INDICATE ABOVE BY CHECK MARK NATURE OF REPORT, NOTICE, OR OTHER DATA)

January 29, 1957

Well No. 5 (FM) is located 1450 ft. from N line and 1750 ft. from E line of sec. 24  
NE Section 24 2N 5W 101M  
(1/4 Sec. and Sec. No.) (Twp.) (Range) (Meridian)  
So. Blanco Ext. & Blanco San Juan New Mexico  
(Field) (County or Subdivision) (State or Territory)

The elevation of the derrick floor above sea level is 5906 ft.

### DETAILS OF WORK

(State names of and expected depths to objective sands; show sizes, weights, and lengths of proposed casings; indicate mudding jobs, cementing points, and all other important proposed work)

It is intended to drill & dual complete a well in the Pictured Cliffs formation & Mesa Verde formation. Mud circulation will be used thru the Pictured Cliffs formation & set intermediate casing. Gas circulation will be used thru the Mesa Verde & a production liner will be set. Possible productive intervals will be perforated & fractured. Estimated Total Depth 4913'.

#### Casing Program:

10 3/4" at 170' with 125 sacks cement circulated to the surface.

7 5/8" at 2405' with 250 sacks cement.

5 1/2" liner at 4913' with 300 sacks cement.

The E/2 of Section 24 is dedicated to the Mesa Verde.

The NE/4 of Section 24 is dedicated to the Pictured Cliffs.

E/2 SF 077123.

I understand that this plan of work must receive approval in writing by the Geological Survey before operations may be commenced.

Company El Paso Natural Gas Company

Address Box 997

Farmington, New Mexico

By W. F. Connel

Title Petroleum Engineer





NEW MEXICO  
OIL CONSERVATION COMMISSION  
WELL LOCATION AND PRODUCTION PLAT

JANUARY 22, 1957

EL PASO NATURAL GAS COMPANY

WARREN

SF 077123

5 (PM)

24

28-N

9-M

1850

NORTH

1750

EAST

SAN JUAN

M.V. & P.C.

SO. BLANCO EXT. P.C.  
BLANCO M.V.

58%  
160 ACRES (P.C.)  
320 ACRES (M.V.)  
(1919 PLAT)

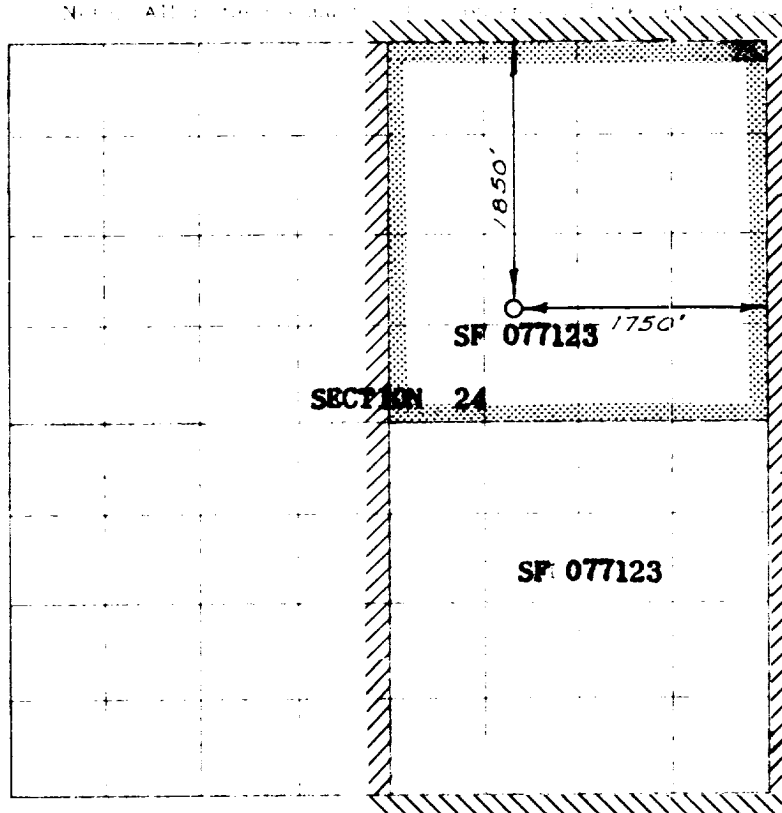

NOTE

This section of  
lands to be used  
for gas wells only

This is to certify that the above plat was correctly made  
for the purpose of actual survey made to the satisfaction of  
the Commission, and that the same are true and correct to the  
best of my knowledge and belief.

Date Surveyed MARCH 20, 1952

Registered Professional Engineer and/or Land Surveyor

1. Is this well a coal camp?

Yes ☒ No ☐

2. If the answer to question 1 is

as you have to any other lands  
completed wells within the  
indicated acreage.

Yes ☒ No ☐

Name W. T. Court

Position Petroleum Engineer

El Paso Natural Gas Co.

Box 997, Farmington, N.M.

Address