

UNITED STATES
DEPARTMENT OF THE INTERIOR
GEOLOGICAL SURVEY

SUBMIT IN TRIPLICATE
(Other instructions on
reverse side)

Form 100-100-1
Budget 100-100-1

30-045-2075-1

3. LEASE DESIGNATION AND SURVEY NO.

SE-047017 A

4. IS INDIAN, ALLOTTEE OR LEASE WELL

7. UNIT AGREEMENT NAME

8. FARM OR LEASE NAME

Christie

9. WELL NO.

#1

10. FIELD AND POOL, OR WELLS

Fulcher
Kutz Pictured Cliffs

11. SEC., T., R., M., OR BLM.
AND SURVEY OR AREA

Section 13-28N-11W

12. COUNTY OR PARISH 13. STATE

San Juan

N.M.

APPLICATION FOR PERMIT TO DRILL, DEEPEN, OR PLUG BACK

1. TYPE OF WORK
DRILL ☒ DEEPEN ☐ PLUG BACK ☐

2. WELL NO.
WELL ☒ OTHER ☐ SINGLE ZONE ☒ MULTIPLE ZONE ☐

3. NAME OF OPERATOR

Marshall Oil & Gas Company

4. NAME OF OPERATOR

P. O. B. Aztec, New Mexico

LOCATION OF WELL (Report location clearly and in accordance with any State requirements.)*

1820 FNL & 1650 FWL, Section 13-28N-11W

At proposed prod. zone

14. DISTANCE IN MILES AND DIRECTION FROM NEAREST TOWN OR POST OFFICE*

15. DISTANCE FROM PROPOSED*
LOCATION TO NEAREST
PROPERTY OR LEASE LINE, FT.
(Also to nearest grg. unit line, if any)

16. NO. OF ACRES IN LEASE
160

17. NO. OF ACRES ASSIGNED
TO THIS WELL
160 Acres

18. DISTANCE FROM PROPOSED LOCATION*
TO NEAREST WELL, DRILLING, COMPLETED,
OR APPLIED FOR, ON THIS LEASE, FT.

19. PROPOSED DEPTH
1990'

20. ROTARY OR CABLE TOOLS
Rotary

21. ELEVATIONS (Show whether DF, RT, GR, etc.)

22. APPROX. DATE WORK WILL START*

Gr.

PROPOSED CASING AND CEMENTING PROGRAM

SIZE OF HOLE	SIZE OF CASING	WEIGHT PER FOOT	SETTING DEPTH	QUANTITY OF CEMENT
9-7/8"	7"	23#	100'	100 sxs.
6-1/4"	3-1/2"	7.7#	1990'	150 sxs.

PROPOSE TO:

- (1) Drill 9-7/8" hole to 100', set 7" surface casing with 100 sxs of cement.
- (2) Drill 6-1/4" hole to T.D. of 1990', set 3-1/2" casing with 150 sxs of cement.
- (3) Perforate Pictured Cliffs formation.
- (4) Sand/water frac with 30,000# sand and 30,000 gals water.
- (5) Run 1" tubing and complete.

Lease Dedication: NW 1/4, Section 13-28N-11W, 160 acres

1. DESCRIBE PROPOSED PROGRAM: If proposal is to deepen or plug back, give data on present productive zone and proposed new productive zone. If proposal is to drill or deepen directionally, give pertinent data on subsurface locations and measured and true vertical depths. Give blowout prevention program, if any.

2. SIGNATURE
Eric E. Evers TITLE Vice-President DATE March 18, 1971

(This space for Federal or State office use)

3. APPROVAL NO. APPROVAL DATE

4. TITLE DATE

5. REVISIONS OF APPROVAL, IF ANY:

*See Instructions On Reverse Side

**NEW MEXICO OIL CONSERVATION COMMISSION
WELL LOCATION AND ACREAGE DEDICATION PLAT**

Form C-102
Supersedes C-128
Effective 1-1-65

All distances must be from the outer boundaries of the Section

Operator Chaparral Oil & Gas Co.			Lease Christie		Well No. #1
Unit Letter F	Section 13	Township 28N	Range 11W	County San Juan	
Actual Footage Location of Well: 1820 feet from the North line and 1650 feet from the West line					
Ground Level Elev. 5814 Gr	Producing Formation Pictured Cliffs		Pool Fowler-Kutz	Dedicated Acreage 160 Acres	

1. Outline the acreage dedicated to the subject well by colored pencil or hatchure marks on the plat below.
2. If more than one lease is dedicated to the well, outline each and identify the ownership thereof (including working interest and royalty).
3. If more than one lease of different ownership is dedicated to the well, have the interests of all owners been consolidated by communitization, unitization, force-pooling, etc?

☐ Yes ☐ No If answer is "yes," type of consolidation _____

If answer is "no," list the owners and tract descriptions which have actually been consolidated. (Use reverse side of this form if necessary.) _____

No allowable will be assigned to the well until all interests have been consolidated (by communitization, unitization, forced-pooling, or otherwise) or until a non-standard unit, eliminating such interests, has been approved by the Commission.

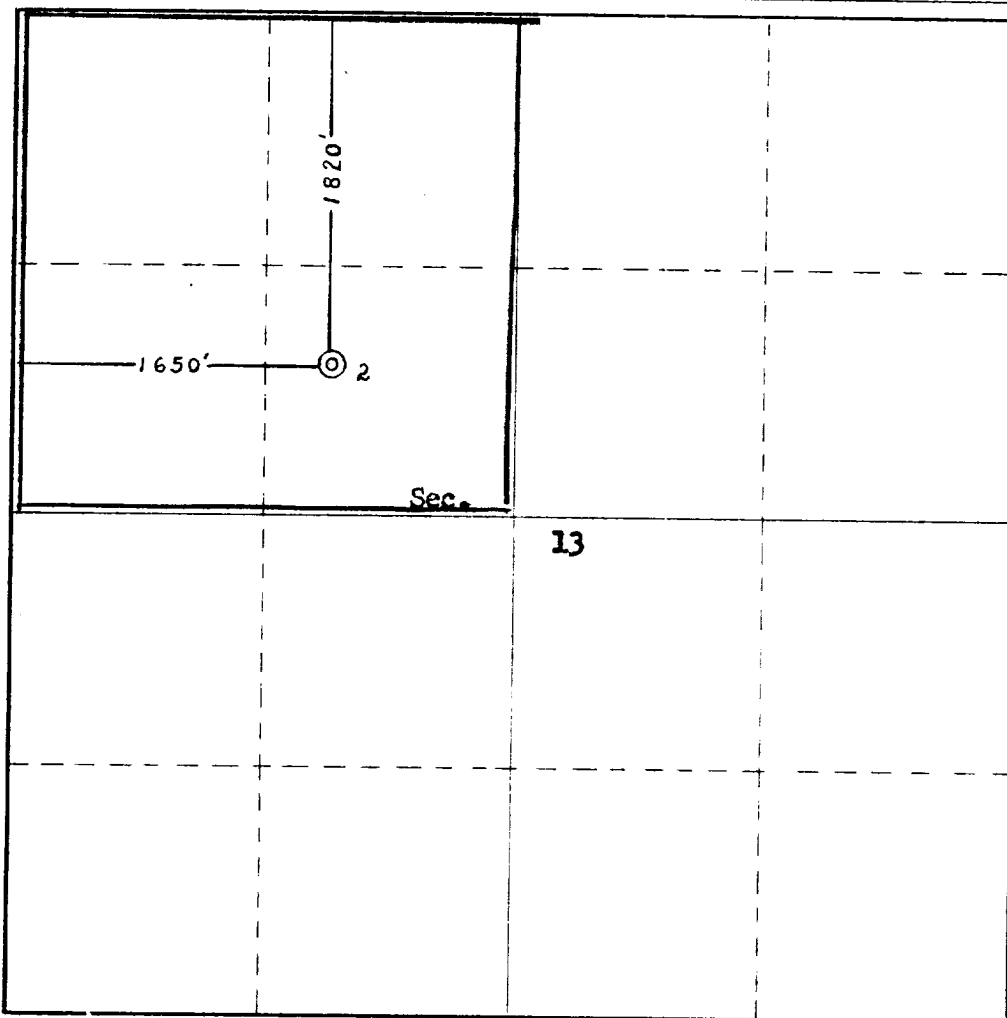
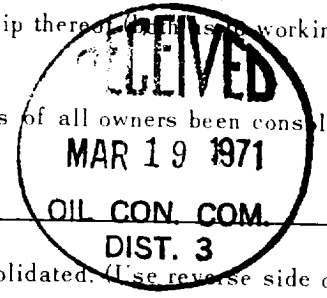

CERTIFICATION

I hereby certify that the information contained herein is true and complete to the best of my knowledge and belief.

Joe C. Eaves

Name
Joe C. Eaves

Position
Vice President

Company
Chaparral Oil & Gas

Date
March 18, 1971

I hereby certify that the well location shown on this plat was plotted from field notes of actual surveys made by me or under my supervision, and that the same is true and correct to the best of my knowledge and belief.

Date
March 16, 1971

Professional Engineer
State of New Mexico

Fred B. Herro
Fred B. Herro

Certification
3090

