

UNITED STATES
DEPARTMENT OF THE INTERIOR
GEOLOGICAL SURVEY

APPLICATION FOR PERMIT TO DRILL, DEEPEN, OR PLUG BACK

1a. TYPE OF WORK DRILL <input checked="" type="checkbox"/> DEEPEN <input type="checkbox"/> PLUG BACK <input type="checkbox"/>		5. LEASE DESIGNATION AND SERIAL NO. SF 077111	
b. TYPE OF WELL OIL WELL <input type="checkbox"/> GAS WELL <input checked="" type="checkbox"/> OTHER <input type="checkbox"/>		6. IF INDIAN, ALLOTTEE OR TRIBE NAME	
2. NAME OF OPERATOR El Paso Natural Gas Company		7. UNIT AGREEMENT NAME	
3. ADDRESS OF OPERATOR P. O. Box 990, Farmington, N. M. 87401		8. FARM OR LEASE NAME Lackey	
4. LOCATION OF WELL (Report location clearly and in accordance with any State requirements.)* At surface 1050'S, 1150'W At proposed prod. zone		9. WELL NO. 5	
14. DISTANCE IN MILES AND DIRECTION FROM NEAREST TOWN OR POST OFFICE*		10. FIELD AND POOL, OR WILDCAT So. Blanco P.C.	
15. DISTANCE FROM PROPOSED* LOCATION TO NEAREST PROPERTY OR LEASE LINE, FT. (Also to nearest drlg. unit line, if any)		11. SEC., T., R., M., OR BLK. AND SURVEY OR AREA Sec. 26, T-28-N, R-9-W N.M.P.M.	
18. DISTANCE FROM PROPOSED LOCATION* TO NEAREST WELL, DRILLING, COMPLETED, OR APPLIED FOR, ON THIS LEASE, FT.		12. COUNTY OR PARISH San Juan	
19. PROPOSED DEPTH 2350'		13. STATE N.M.	
20. ROTARY OR CABLE TOOLS Rotary		17. NO. OF ACRES ASSIGNED TO THIS WELL 160.00	
21. ELEVATIONS (Show whether DF, RT, GR, etc.) 5992' GL		22. APPROX. DATE WORK WILL START*	

23. PROPOSED CASING AND CEMENTING PROGRAM

SIZE OF HOLE	SIZE OF CASING	WEIGHT PER FOOT	SETTING DEPTH	QUANTITY OF CEMENT
12-1/4"	8-5/8"	24.0 lb.	130'	110 Cu. Ft. to Circulate
6-3/4"	2-7/8"	6.4 lb.	2350'	225 Cu. Ft. to cover the O.A.

Selectively perforate and Sandwater fracture the Pictured Cliffs formation.

The SW/4 of Section 26 is dedicated to this well.

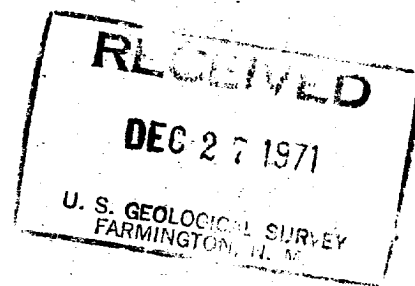

IN ABOVE SPACE DESCRIBE PROPOSED PROGRAM: If proposal is to deepen or plug back, give data on present productive zone and proposed new productive zone. If proposal is to drill or deepen directionally, give pertinent data on absolute locations and measured and true vertical depths. Give blowout preventer program, if any.

24. SIGNED Original Signed F. H. WOOD TITLE Div. Petroleum Engineer DATE 12-27-71

(This space for Federal or State office use)

PERMIT NO. APPROVAL DATE

APPROVED BY DATE
CONDITIONS OF APPROVAL, IF ANY:

NEW MEXICO OIL CONSERVATION COMMISSION
WELL LOCATION AND ACREAGE DEDICATION PLAT

Form C-102
Supersedes C-128
Effective 1-1-65

All distances must be from the outer boundaries of the Section.

Operator EL PASO NATURAL GAS COMPANY		Lessee LACKEY		Well No. (SF-077111) 5	
Tract Letter M	Section 26	Township 28-N	Range 9-W	County SAN JUAN	
Actual Location of Well: 1050 feet from the SOUTH line and 1150 feet from the WEST line					
Ground Level Elev. 5992	Producing Formation PICTURED CLIFFS		Pool SO. BLANCO PICTURED CLIFFS		Dedicated Acreage: 160.00 Acres

1. Outline the acreage dedicated to the subject well by colored pencil or hachure marks on the plat below.
2. If more than one lease is dedicated to the well, outline each and identify the ownership thereof (both as to working interest and royalty).
3. If more than one lease of different ownership is dedicated to the well, have the interests of all owners been consolidated by communitization, unitization, force-pooling, etc?

☐ Yes ☐ No If answer is "yes," type of consolidation _____

If answer is "no," list the owners and tract descriptions which have actually been consolidated. (DIST. Reverse side of this form if necessary.) _____

No allowable will be assigned to the well until all interests have been consolidated (by communitization, unitization, forced-pooling, or otherwise) or until a non-standard unit, eliminating such interests, has been approved by the Commission.

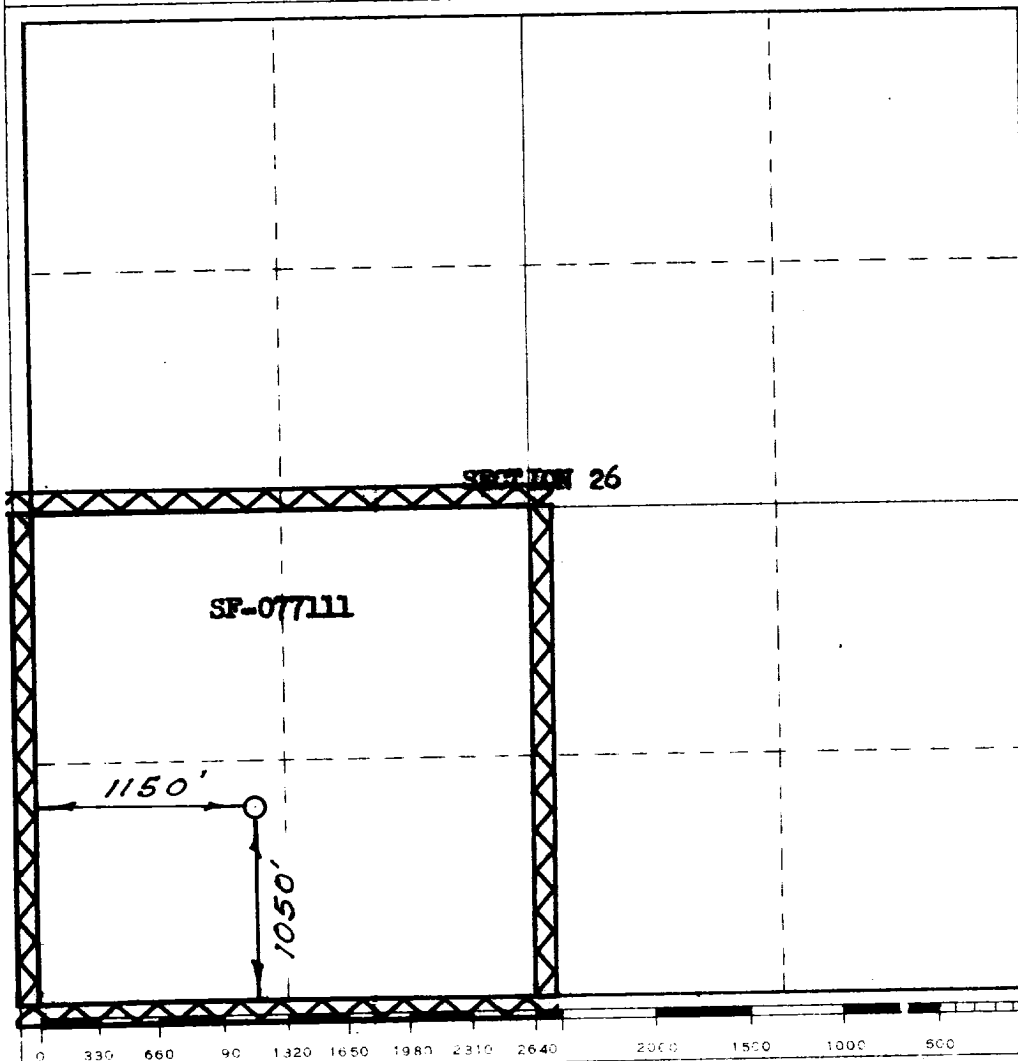
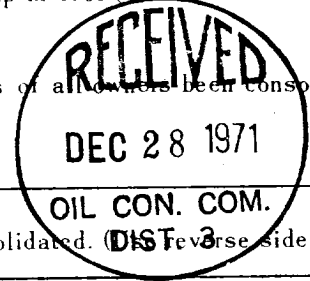

CERTIFICATION

I hereby certify that the information contained herein is true and complete to the best of my knowledge and belief.

Original Signed F. H. WOOD

Name _____
Position **Div. Petroleum Engineer**
Company **El Paso Natural Gas Co.**
Date **December 27, 1971**

I hereby certify that the well location shown on this plat was plotted from field notes of actual surveys made by me or under my supervision and that the same is true and correct to the best of my knowledge and belief.

Date Surveyed **NOVEMBER 24, 1958**
Registered Professional Engineer and/or Land Surveyor
Paul K. Kline
Certificate No. **1760**