

✓

OIL CONSERVATION COMMISSION
Albuquerque DISTRICT

OIL CONSERVATION COMMISSION
BOX 2088
SANTA FE, NEW MEXICO

DATE 8-20-79

RE: Proposed MC _____
Proposed DHC _____
Proposed NSL ✓ _____
Proposed SWD _____
Proposed WFX _____
Proposed PMX _____

Gentlemen:

I have examined the application dated 8-17-79
for the Glendon Oil Co. Mexico-Deer Creek 15 #1E N-8-28N-10W
Operator Lease and Well No. Unit, S-T-R

and my recommendations are as follows:

Approve

Yours very truly,

AK Kendrick

NEW MEXICO OIL CONSERVATION COMMISSION
WELL LOCATION AND ACREAGE DEDICATION PLAT

Form O-102
Supersedes O-128
Effective 1-1-65

All distances must be from the outer boundaries of the Section

Operator GETTY OIL COMPANY			Lease MEXICO-FEDERAL "K"		Well No. 1-E
Unit Letter N	Section 8	Township 28N	Range 13W	County San Juan	
Actual Footage Location of Well:					
1190 feet from the South line and		2020 feet from the West line			
Ground Level Elev. 5713	Producing Formation Dakota	Pool Basin Dakota		Dedicated Acreage: Acres	

1. Outline the acreage dedicated to the subject well by colored pencil or hachure marks on the plat below.
2. If more than one lease is dedicated to the well, outline each and identify the ownership thereof (both as to working interest and royalty).
3. If more than one lease of different ownership is dedicated to the well, have the interests of all owners been consolidated by communitization, unitization, force-pooling, etc?

☐ Yes ☐ No If answer is "yes," type of consolidation _____

If answer is "no," list the owners and tract descriptions which have actually been consolidated. (Use reverse side of this form if necessary.) _____

No allowable will be assigned to the well until all interests have been consolidated (by communitization, unitization, forced-pooling, or otherwise) or until a non-standard unit, eliminating such interests, has been approved by the Commission.

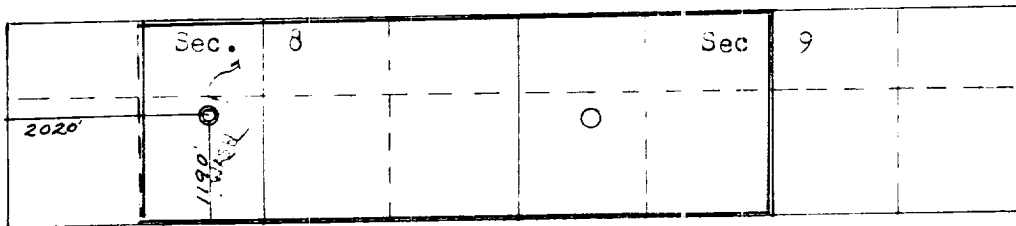

Location moved by Company Representative

See 1" = 2000'

CERTIFICATION

I hereby certify that the information contained herein is true and complete to the best of my knowledge and belief.

PAUL D BERTHOSE

Name **Paul D Berthost**

Position **Field Technician IV**

Company **Getty Oil Co**

Date **August 18 1979**

I hereby certify that the well location shown on this plat was plotted from field notes of actual surveys made by me or under my supervision, and that the same is true and correct to the best of my knowledge and belief.

Date Surveyed **August 17, 1979**

Registered Professional Engineer and Land Surveyor

Fred R. Kerr Jr.

Certification No. **1950** JR.



Getty Oil Company | Three Park Central, Suite 700, 1515 Arapahoe St., Denver, CO 80202 • 303/623-4200

W. J. Newman, District Production Manager
Denver Exploration and Production District

August 17, 1979

RE: ADMINISTRATIVE APPROVAL
UNORTHODOX LOCATION

Energy and Minerals Department
Oil Conservation Division
P.O. Box 2088
Santa Fe, New Mexico 87501

Attention: Mr. Joe D. Ramey
Oil Director

Gentlemen:

We request administrative approval to drill our proposed Mexico Federal "K" No. 1E Basin Dakota well at a location 1190 feet from the south line and 2020 feet from the west line of the "short" Section 8, T28N, R10W, San Juan County, New Mexico. An orthodox location would be 1190 feet from the south and 2120 feet from the west line.

This unorthodox location is required due to the topography. An unnamed wash runs directly through the orthodox drilling location and the wash is butted up next to a bluff.

All offset operators have been notified by certified mail of this application.

We have asked Mr. Al Kendrick of your Aztec office to forward a copy of the surveyor plat. Attached is a plat showing offset ownership.

Very truly yours,

W. J. Newman

GEB:clm
attachs.

cc: Mr. Al Kendrick, Supervisor ✓
1000 Rio Brazos Road
Aztec, New Mexico 87410

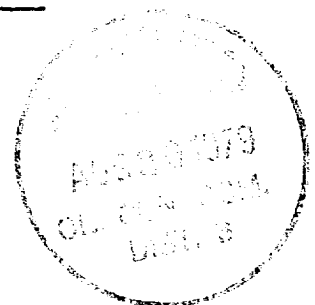

MAILING LIST
Unorthodox Location
Mexico Federal "K" No. 1E

Amoco Production Company
Mr. M.S. Kraemer
Security Life Bldg.
Denver, CO 80202

Amoco Production Company
Mr. L.O. Speer, Jr.
501 Airport Road
Farmington, NM 87401

Crown Central Petroleum Corp.
Mr. Jim Chalcraft
Box 1096
Morton, Wyoming 82522

Southland Royalty Co.
410 17th Street, Ste. 1000
Denver, CO 80202

Supron Energy Corp.
Box 808
Farmington, New Mexico 87401

Texaco
Box 2100
Denver, CO 80201