

District I  
P.O. Box 1944 Hobbs, NM 88240

District II  
P.O. Drawer 100 Artesia, NM 88221

District III  
1000 Rio Brazos Rd. Aztec, NM 87412

State of New Mexico  
Energy, Minerals and Natural Resources Department

SUBMIT 1 COPY TO  
APPROPRIATE  
DISTRICT OFFICE  
AND 1 COPY TO  
SANTA FE OFFICE

OIL CONSERVATION DIVISION

2040 South Pacheco Street  
Santa Fe, New Mexico 87505

FEB 28 1997

PIT REMEDIATION AND CLOSURE REPORT

RECEIVED  
OCT 1 1997

Operator: PNM Gas Services (Amoco) Telephone: 324-3764

Address: 603 W. Elm Street Farmington, NM 87401

Facility or Well Name: Omler A #3E

Location: Unit: O Sec. 26 T. 28 N R. 10 W County San Juan

Pit Type: Separator ☒ Dehydrator ☐ Other ☐

Land Type: BLM ☒ State ☐ Fee ☐ Other ☐

Pit Location: Pit dimensions: length 18 width 18 depth 4

(Attach diagram) Reference: wellhead ☒ other ☐

Footage from reference: 81'

Direction from reference: 45 Degrees ☒ East ☐ North ☒  
of  
☐ West ☐ South

|   |                         |             |          |
|---|-------------------------|-------------|----------|
| <b>Depth to Ground Water:</b><br><br><small>(Vertical distance from contaminants to seasonal high water elevation of ground water)</small>                                  | Less than 50 feet       | (20 points) |          |
|   | 50 feet to 99 feet      | (10 points) |          |
|   | Greater than 100 feet   | (0 points)  | <u>0</u> |
| <br><b>Wellhead Protection Area:</b><br><br><small>(Less than 200 feet from a private domestic water source, or, less than 1,000 feet from all other water sources)</small> |                         |             |          |
|   | Yes                     | (20 points) |          |
|   | No                      | (0 points)  | <u>0</u> |
| <br><b>Distance to Surface Water:</b><br><br><small>(Horizontal distance to perennial lakes, ponds, rivers, streams, creeks, irrigation canals and ditches)</small>         |                         |             |          |
|   | Less than 200 feet      | (20 points) |          |
|   | 200 feet to 1,000 feet  | (10 points) |          |
|   | Greater than 1,000 feet | (0 points)  | <u>0</u> |
| <b>RANKING SCORE (TOTAL POINTS):</b>  |                         |             | <u>0</u> |

|  |                       |                       |   |                               |              |                                 |                    |
|--|-----------------------|-----------------------|---|-------------------------------|--------------|---------------------------------|--------------------|
| <b>Date Remediation Started:</b>   |                       | <u>8/21/96</u>        |   | <b>Date Completed:</b>        |              | <u>8/21/96</u>                  |                    |
| <b>Remediation Method:</b><br><br>(Check all appropriate sections)   | Excavation            | <u>X</u>              | Approx. Cubic Yard  |                               | <u>57</u>    |                                 |                    |
|  | Landfarmed            | <u>X</u>              | Amount Landfarmed (cubic yds)                               |                               | <u>57</u>    |                                 |                    |
|  | Other _____           |                       |   |                               |              |                                 |                    |
| <b>Remediation Location:</b>   |                       | Onsite                | <u>X</u>  | Offsite                       | _____        |                                 |                    |
| (i.e., landfarmed onsite, name and location of offsite facility)   |                       |                       |   |                               |              |                                 |                    |
| <b>Backfill Material Location:</b> _____   |                       |                       |   |                               |              |                                 |                    |
| <b>General Description of Remedial Action:</b>   |                       |                       |   |                               |              |                                 |                    |
| Excavated contaminated soil to pit size of 20'x11'x7' and landfarmed soil onsite within a bermed area at a depth of 6" to 12". Soil was aerated by plowing/disking until soil met regulatory levels. |                       |                       |   |                               |              |                                 |                    |
| _____  |                       |                       |   |                               |              |                                 |                    |
| _____  |                       |                       |   |                               |              |                                 |                    |
| _____  |                       |                       |   |                               |              |                                 |                    |
| _____  |                       |                       |   |                               |              |                                 |                    |
| <b>Ground Water Encountered:</b>   |                       |                       |   |                               |              |                                 |                    |
| No   |                       | <u>✓</u>              | Yes   |                               | _____        |                                 |                    |
|  |                       |                       | Depth   |                               | _____        |                                 |                    |
| <b>Final Pit Closure Sampling:</b>   |                       |                       |   |                               |              |                                 |                    |
| (if multiple samples, attach sample result and diagram of sample locations and depths.)  | Sample Location       |                       | <u>5 pt composite-4 side walls and center of pit bottom</u> |                               |              |                                 |                    |
|  | Sample depth          |                       | <u>7'</u>   |                               |              |                                 |                    |
|  | Sample date           |                       | <u>8/21/96</u>  |                               | Sample time  |                                 | <u>11:15:00 AM</u> |
|  | <b>Sample Results</b> |                       |   |                               |              |                                 |                    |
|  |                       | Benzene (ppm)         |   | <u>0.0561</u>                 |              |                                 |                    |
|  |                       | Total BTEX (ppm)      |   | <u>0.2846</u>                 |              |                                 |                    |
|  |                       | Field headspace (ppm) |   | _____                         |              |                                 |                    |
|  |                       | TPH                   | <u>&lt; 5.00</u>  | Method                        | <u>8015A</u> |                                 |                    |
| Vertical Extent (ft)   |                       | _____                 |   | Risk Assessment form attached |              | Yes                             | No <u>✓</u>        |
| <b>Ground Water Sample:</b>  |                       | Yes                   | _____   | No                            | <u>✓</u>     | (If yes, attach sample results) |                    |
| I HEREBY CERTIFY THAT THE INFORMATION ABOVE IS TRUE AND COMPLETE TO THE BEST OF MY KNOWLEDGE AND MY BELIEF   |                       |                       |   |                               |              |                                 |                    |
| DATE   |                       | October 25, 1996      |   | PRINTED NAME                  |              | Maureen Gannon                  |                    |
| SIGNATURE  |                       | <u>Maureen Gannon</u> |   | AND TITLE                     |              | Environmental Engineer          |                    |

↑  
N



SEP  
JEF

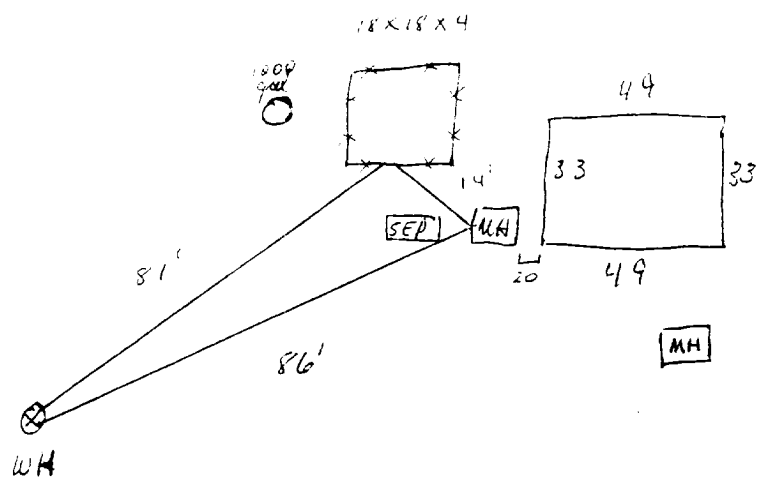

***Diesel Range Organics***

Attn: *Denver Bearden*  
Company: *PNM Gas Services*  
Address: *603 W. Elm*  
City, State: *Farmington, NM 87401*

Date: *23-Aug-96*  
COC No.: *4948*  
Sample No. *11876*  
Job No. *2-1000*

Project Name: ***PNM Gas Services - Olmer A #3E***  
Project Location: ***9608211115; Pit Excavation Composite Sample***  
Sampled by: *RH* Date: *21-Aug-96* Time: *11:15*  
Analyzed by: *DC/HR* Date: *23-Aug-96*  
Sample Matrix: *Soil*

***Laboratory Analysis***

| <i>Parameter</i>                         | <i>Result</i>  | <i>Unit of Measure</i> | <i>Detection Limit</i> | <i>Unit of Measure</i> |
|--|----------------|------------------------|------------------------|------------------------|
| <i>Diesel Range Organics (C10 - C28)</i> | <i>&lt;5.0</i> | <i>mg/kg</i>           | <i>5.0</i>             | <i>mg/kg</i>           |

***Quality Assurance Report***

DRO QC No.: *0489-QC*

***Calibration Check***

| <i>Parameter</i>                | <i>Method Blank</i> | <i>Unit of Measure</i> | <i>True Value</i> | <i>Analyzed Value</i> | <i>% Diff</i> | <i>Limit</i> |
|---------------------------------|---------------------|------------------------|-------------------|-----------------------|---------------|--------------|
| <i>Diesel Range (C10 - C28)</i> | <i>&lt;5.0</i>      | <i>ppm</i>             | <i>100</i>        | <i>112</i>            | <i>12.0</i>   | <i>15%</i>   |

***Matrix Spike***

| <i>Parameter</i>              | <i>1- Percent Recovered</i> | <i>2- Percent Recovered</i> | <i>Limit</i>    | <i>%RSD</i> | <i>Limit</i> |
|-------------------------------|-----------------------------|-----------------------------|-----------------|-------------|--------------|
| <i>Diesel Range (C10-C28)</i> | <i>112</i>                  | <i>114</i>                  | <i>(70-130)</i> | <i>1</i>    | <i>20%</i>   |

***Method*** - SW-846 EPA Method 8015A mod. - Nonhalogenated Volatile Hydrocarbons by Gas Chromatography

Approved by: *[Signature]*  
Date: *8/23/96*

**AROMATIC VOLATILE ORGANICS**

Attn: *Denver Bearden*  
Company: *PNM Gas Services*  
Address: *603 W. Elm*  
City, State: *Farmington, NM 87401*

Date: *23-Aug-96*  
COC No.: *4948*  
Sample No.: *11876*  
Job No.: *2-1000*

Project Name: *PNM Gas Services - Olmer A #3E*  
Project Location: *9608211115; Pit Excavation Composite Sample*  
Sampled by: *RH* Date: *21-Aug-96* Time: *11:15*  
Analyzed by: *HR* Date: *22-Aug-96*  
Sample Matrix: *Soil*

**Laboratory Analysis**

| Parameter    | Result | Unit of Measure | Detection Limit | Unit of Measure |
|--------------|--------|-----------------|-----------------|-----------------|
| Benzene      | 56.1   | ug/kg           | 0.2             | ug/kg           |
| Toluene      | 22.5   | ug/kg           | 0.2             | ug/kg           |
| Ethylbenzene | 12.1   | ug/kg           | 0.2             | ug/kg           |
| m,p-Xylene   | 144.7  | ug/kg           | 0.2             | ug/kg           |
| o-Xylene     | 49.2   | ug/kg           | 0.2             | ug/kg           |
| TOTAL        |        | 284.6           | ug/kg           |                 |

**Method** - SW-846 EPA Method 8020 Aromatic Volatile Organics by Gas Chromatography

Approved by: *[Signature]*  
Date: *8/23/96*

Omler A3E

9-12-96

Amoco

Sec. 26, 28N, 10W

Landfarm: On location

Composite sample # 9609121400      6pt.

Soil Vapor PID reading: 9.5 ppm



2"-12" depth  
sand

|     |    |
|-----|----|
| .8  | .7 |
| 1.6 | .0 |
| .3  | .0 |

OFF: (505) 325-5667



LAB: (505) 325-1556

***Diesel Range Organics***

Attn: *Denver Bearden*  
 Company: *PNM Gas Services*  
 Address: *603 W. Elm*  
 City, State: *Farmington, NM 87401*

Date: *16-Sep-96*  
 COC No.: *5038*  
 Sample No. *12141*  
 Job No. *2-1000*

Project Name: ***PNM Gas Services - Omler A3E Landfarm***  
 Project Location: ***9609121400; 6pt. Composite, 2"-12" depth***  
 Sampled by: GC Date: *12-Sep-96* Time: *14:00*  
 Analyzed by: HR Date: *14-Sep-96*  
 Sample Matrix: *Soil*

***Laboratory Analysis***

| <b><i>Parameter</i></b>                  | <b><i>Result</i></b> | <b><i>Unit of Measure</i></b> | <b><i>Detection Limit</i></b> | <b><i>Unit of Measure</i></b> |
|--|----------------------|-------------------------------|-------------------------------|-------------------------------|
| <i>Diesel Range Organics (C10 - C28)</i> | 22.9                 | mg/kg                         | 5.0                           | mg/kg                         |

***Quality Assurance Report***DRO QC No.: *0489-QC****Calibration Check***

| <b><i>Parameter</i></b>         | <b><i>Method Blank</i></b> | <b><i>Unit of Measure</i></b> | <b><i>True Value</i></b> | <b><i>Analyzed Value</i></b> | <b><i>% Diff</i></b> | <b><i>Limit</i></b> |
|---------------------------------|----------------------------|-------------------------------|--------------------------|------------------------------|----------------------|---------------------|
| <i>Diesel Range (C10 - C28)</i> | <5.0                       | ppm                           | 100                      | 104                          | 3.8                  | 15%                 |

***Matrix Spike***

| <b><i>Parameter</i></b>       | <b><i>1- Percent Recovered</i></b> | <b><i>2 - Percent Recovered</i></b> | <b><i>Limit</i></b> | <b><i>%RSD</i></b> | <b><i>Limit</i></b> |
|-------------------------------|------------------------------------|-------------------------------------|---------------------|--------------------|---------------------|
| <i>Diesel Range (C10-C28)</i> | 82                                 | 96                                  | (70-130)            | 11                 | 20%                 |

***Method*** - SW-846 EPA Method 8015A mod. - Nonhalogenated Volatile Hydrocarbons by Gas ChromatographyApproved by: *Jack*Date: *9/14/96*

P.O. BOX 2606 • FARMINGTON, NM 87499

- TECHNOLOGY BLENDING INDUSTRY WITH THE ENVIRONMENT -