

UNITED STATES  
DEPARTMENT OF THE INTERIOR  
GEOLOGICAL SURVEY

SUNDRY NOTICES AND REPORTS ON WELLS

(Do not use this form for proposals to drill or to deepen or plug back to a different reservoir. Use Form 9-331-C for such proposals.)

1. oil ☐ well gas ☒ well other ☐
2. NAME OF OPERATOR  
*SUPRON ENERGY CORPORATION*
3. ADDRESS OF OPERATOR  
*P.O. Box 808, Farmington, New Mexico 87401*
4. LOCATION OF WELL (REPORT LOCATION CLEARLY. See space 17 below.)  
AT SURFACE: *960 ft./S ; 1455 ft./E line*  
AT TOP PROD. INTERVAL: *Same as above*  
AT TOTAL DEPTH: *Same as above.*
16. CHECK APPROPRIATE BOX TO INDICATE NATURE OF NOTICE, REPORT, OR OTHER DATA

REQUEST FOR APPROVAL TO:

- TEST WATER SHUT-OFF ☐  
FRACTURE TREAT ☐  
SHOOT OR ACIDIZE ☐  
REPAIR WELL ☐  
PULL OR ALTER CASING ☐  
MULTIPLE COMPLETE ☐  
CHANGE ZONES ☐  
ABANDON\* ☐

SUBSEQUENT REPORT OF:

- ☐  
☐  
☐  
☐  
☐  
☐  
☐  
☐

(other) *Run and cement 4-1/2" casing*

RECEIVED

MAR 31 1980

U. S. GEOLOGICAL SURVEY  
FARMINGTON, N. M.

(NOTE: Report results of multiple completion or zone change on Form 9-330.)

17. DESCRIBE PROPOSED OR COMPLETED OPERATIONS (Clearly state all pertinent details, and give pertinent dates, including estimated date of starting any proposed work. If well is directionally drilled, give subsurface locations and measured and true vertical depths for all markers and zones pertinent to this work).\*

1. *Drilled 7-7/8" hole with mud to T.D. of 6450 ft. R.K.B. T.D. reached on 3-1-80.*
2. *Ran 156 joints (6439 ft.) of 5-1/2", 15.50#, K-55 casing. Landed at 6450 ft. R.K.B. with float collar at 6407 ft. R.K.B. and D.V. tools set @ 2986 ft. and 1310 ft. R.K.B.*
3. *Cemented first stage with 335 sx 50-50 POZ w/2% gel. Plug down at 7:30 a.m. 3-4-80. Cemented second stage w/500 sx Howco Lite and 50 sx of class "B". Plug down at 10:45 a.m. 3-4-80. Cemented third stage w/675 sx Howco Lite and 50 sx of class "B". Plug down at 2:15 p.m. 3-4-80. Cement circulated to surface on third stage.*

Subsurface Safety Valve: Manu. and Type \_\_\_\_\_

18. I hereby certify that the foregoing is true and correct

SIGNED *Kenneth E. Roddy* TITLE *Production Supt.* DATE *March 28, 1980*

(This space for Federal or State office use)

APPROVED BY \_\_\_\_\_ TITLE \_\_\_\_\_ DATE \_\_\_\_\_  
CONDITIONS OF APPROVAL, IF ANY:

ACCEPTED FOR RECORD

NMOCC

\*See Instructions on Reverse Side

APR 28 1980

FARMINGTON, N.M.  
BY *[Signature]*

NEW MEXICO OIL CONSERVATION COMMISSION  
WELL LOCATION AND ACREAGE DEDICATION PLAT

Form C-102  
Supersedes C-  
Effective 1-1-6

All distances must be from the outer boundaries of the Section.

Operator <b>SUPRON ENERGY CORPORATION</b>		Lease <b>ZACHRY</b>		Well No. <b>18-E</b>
Unit Letter <b>0</b>	Section <b>11</b>	Township <b>28 NORTH</b>	Range <b>10 WEST</b>	County <b>SAN JUAN</b>
Actual Footage Location of Well: <b>960</b> feet from the <b>SOUTH</b> line and <b>1455</b> feet from the <b>EAST</b> line				
Ground Level Elev. <b>5594</b>	Producing Formation <b>CHACRA DAKOTA</b>	Pool <b>WILDCAT BASIN</b>	Predicted Acreage: <b>131.6</b> <b>- E/2 Sec. 10 - All Sec 14</b>	

1. Outline the acreage dedicated to the subject well by colored pencil or hachure marks on the plat below. **327.29**
2. If more than one lease is dedicated to the well, outline each and identify the ownership thereof (both as to working interest and royalty).
3. If more than one lease of different ownership is dedicated to the well, have the interests of all owners been consolidated by communitization, unitization, force-pooling, etc?

☐ Yes ☐ No If answer is "yes," type of consolidation \_\_\_\_\_

If answer is "no," list the owners and tract descriptions which have actually been consolidated. (Use reverse side of this form if necessary.) \_\_\_\_\_

No allowable will be assigned to the well until all interests have been consolidated (by communitization, unitization, forced-pooling, or otherwise) or until a non-standard unit, eliminating such interests, has been approved by the Commission.

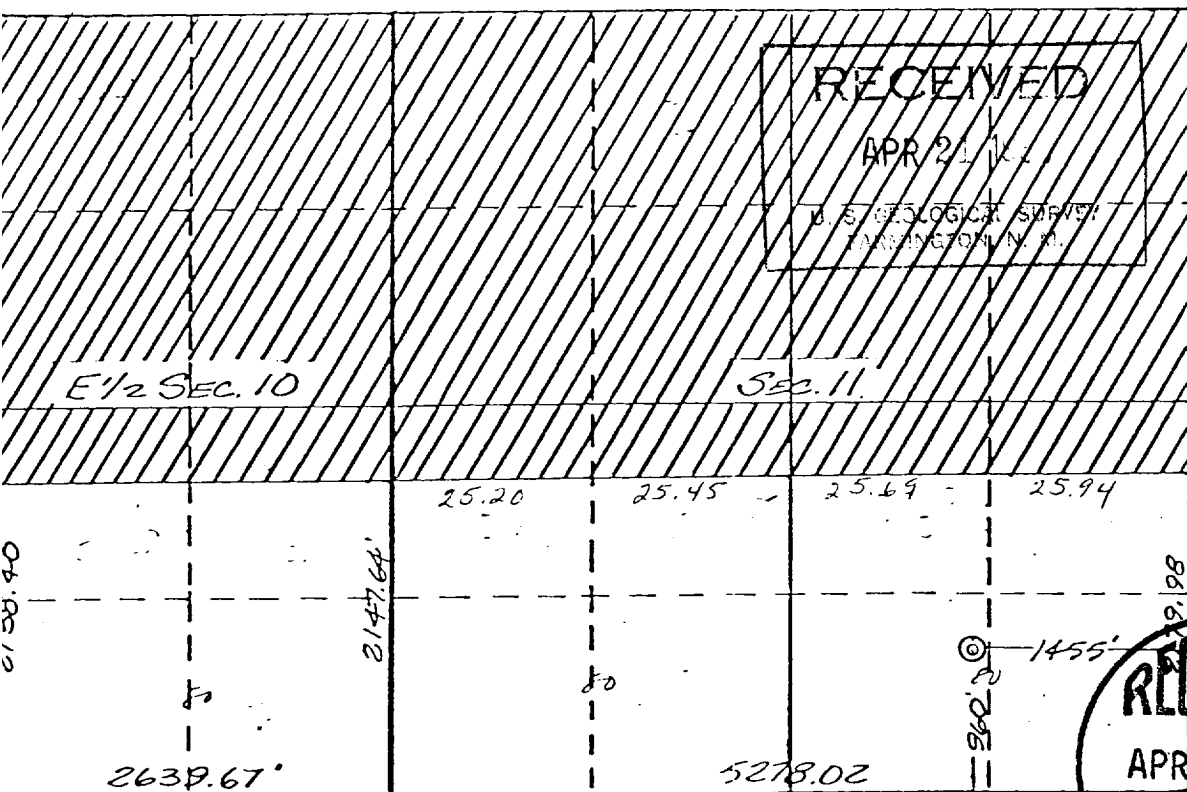

SCALE: 4" = 1 MILE

CERTIFICATION

I hereby certify that the information contained herein is true and complete to the best of my knowledge and belief.

*Kenneth E. Roddy*  
me  
Kenneth E. Roddy

Position  
Production Superintendent

Company  
SUPRON ENERGY CORPORATION

Date  
April 16, 1980

Professional Engineer & Surveyor  
STATE OF NEW MEXICO  
No. 1463  
JAMES P. LEESE

RECEIVED  
APR 29 1980  
OIL CON. COM.  
Dis Surveyed  
5 July 1979

Registered Professional Engineer  
and/or Land Surveyor  
*James P. Leese*  
James P. Leese  
Certificate No. 1463