

District I
P.O. Box 1980 Hobbs, NM
District II
P.O. Drawer DD, Artesia, NM 88221

DEPUTY OIL & GAS INSPECTOR

District III
1300 Rio Brazos Rd. Aztec, NM 87410

State of New Mexico
Energy, Minerals and Natural Resources Department

OIL CONSERVATION DIVISION

2040 South Pacheco Street
Santa Fe, New Mexico 87505

SUBMIT 1 COPY TO
APPROPRIATE
DISTRICT OFFICE
AND 1 COPY TO
SANTA FE OFFICE

FEB 28 1997

PIT REMEDIATION AND CLOSURE REPORT

RECEIVED
OCT 31 1996

OIL CON. DIV.
SANTA FE

Operator: PNM Gas Services (Amoco) Telephone: 324-3764
Address: 603 W. Elm Street Farmington, NM 87401
Facility or Well Name: Omler A #5E
Location: Unit: E Sec. 25 T. 28 N R. 10 W County San Juan
Pit Type: Separator ☒ Dehydrator ☐ Other ☐
Land Type: BLM ☒ State ☐ Fee ☐ Other ☐

Pit Location: Pit dimensions: length 18 width 18 depth 3
(Attach diagram) Reference: wellhead ☒ other ☐
Footage from reference: 79
Direction from reference: 85 Degrees ☒ East ☐ North ☒
of ☐ West ☐ South ☐

Depth to Ground Water: Less than 50 feet (20 points)
50 feet to 99 feet (10 points)
Greater than 100 feet (0 points) 0

(Vertical distance from contaminants to
seasonal high water elevation of ground
water)

Wellhead Protection Area: Yes (20 points)
No (0 points) 0

(Less than 200 feet from a private
domestic water source, or, less than 1,000
feet from all other water sources)

Distance to Surface Water: Less than 200 feet (20 points)
200 feet to 1,000 feet (10 points)
Greater than 1,000 feet (0 points) 0

(Horizontal distance to perennial lakes,
ponds, rivers, streams, creeks, irrigation
canals and ditches)

RANKING SCORE (TOTAL POINTS): 0

Date Remediation Started: 8/21/96 **Date Completed:** 8/21/96

Remediation Method: Excavation X Approx. Cubic Yard 182

(Check all appropriate sections) Landfarmed X Amount Landfarmed (cubic yds) 182

Other _____

Remediation Location: Onsite X - 100 cu yds Offsite Omler #6 (26-28N-10W) - 82 cu yds
(i.e., landfarmed onsite, name and location of offsite facility)

Backfill Material Location: _____

General Description of Remedial Action:

Excavated contaminated soil to pit size of 21'x18'x13' and landfarmed soil onsite/offsite within a bermed area at a depth of 6" to 12". Soil was aerated by plowing/disking until soil met regulatory levels.

Ground Water Encountered: No ✓ Yes — Depth —

Final Pit Closure Sampling:

Sample Location 5 pt composite-4 side walls and center of pit bottom

(if multiple samples, attach sample result and diagram of sample locations and depths.)

Sample depth 13'

Sample date 8/21/96 Sample time 3:15:00 PM

Sample Results

Benzene (ppm) < 0.0002

Total BTEX (ppm) 0.0043

Field headspace (ppm) —

TPH < 5.00 Method 8015A

Vertical Extent (ft) — Risk Assessment form attached Yes — No ✓

Ground Water Sample: Yes — No ✓ (If yes, attach sample results)

I HEREBY CERTIFY THAT THE INFORMATION ABOVE IS TRUE AND COMPLETE TO THE BEST OF MY KNOWLEDGE AND MY BELIEF

DATE October 25, 1996

SIGNATURE Maureen Gannon

PRINTED NAME Maureen Gannon
AND TITLE Environmental Engineer

↑
N

14M

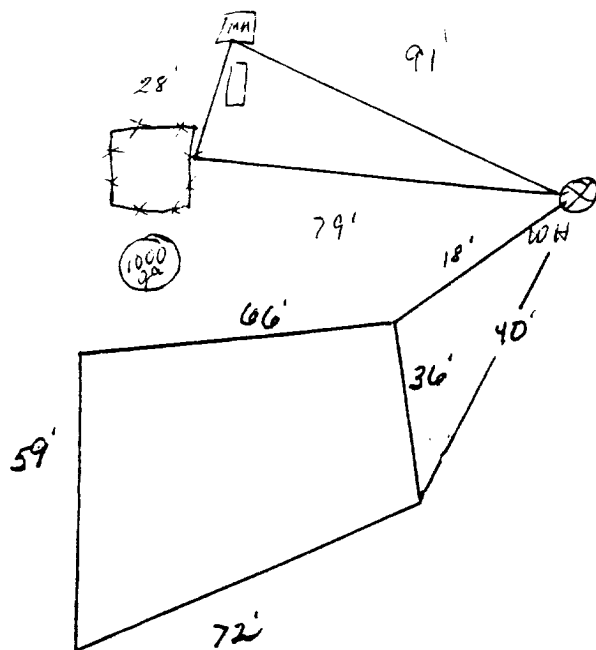

310

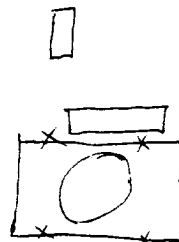

OFF: (505) 325-5667



LAB: (505) 325-1556

Diesel Range Organics

Attn: *Denver Bearden*
 Company: *PNM Gas Services*
 Address: *603 W. Elm*
 City, State: *Farmington, NM 87401*

Date: *23-Aug-96*
 COC No.: *4949*
 Sample No. *11877*
 Job No. *2-1000*

Project Name: *PNM Gas Services - Olmer A #5E*
 Project Location: *9608211515; Pit Excavation Composite Sample*
 Sampled by: *RH* Date: *21-Aug-96* Time: *15:15*
 Analyzed by: *DC/HR* Date: *23-Aug-96*
 Sample Matrix: *Soil*

Laboratory Analysis

| <i>Parameter</i> | <i>Result</i> | <i>Unit of Measure</i> | <i>Detection Limit</i> | <i>Unit of Measure</i> |
|--|----------------|------------------------|------------------------|------------------------|
| <i>Diesel Range Organics (C10 - C28)</i> | <i><5.0</i> | <i>mg/kg</i> | <i>5.0</i> | <i>mg/kg</i> |

Quality Assurance ReportDRO QC No.: *0489-QC****Calibration Check***

| <i>Parameter</i> | <i>Method Blank</i> | <i>Unit of Measure</i> | <i>True Value</i> | <i>Analyzed Value</i> | <i>% Diff</i> | <i>Limit</i> |
|---------------------------------|---------------------|------------------------|-------------------|-----------------------|---------------|--------------|
| <i>Diesel Range (C10 - C28)</i> | <i><5.0</i> | <i>ppm</i> | <i>100</i> | <i>112</i> | <i>12.0</i> | <i>15%</i> |

Matrix Spike

| <i>Parameter</i> | <i>1 - Percent Recovered</i> | <i>2 - Percent Recovered</i> | <i>Limit</i> | <i>%RSD</i> | <i>Limit</i> |
|-------------------------------|------------------------------|------------------------------|-----------------|-------------|--------------|
| <i>Diesel Range (C10-C28)</i> | <i>112</i> | <i>114</i> | <i>(70-130)</i> | <i>1</i> | <i>20%</i> |

Method - SW-846 EPA Method 8015A mod. - Nonhalogenated Volatile Hydrocarbons by Gas Chromatography

Approved by: *[Signature]*
 Date: *8/23/96*

P.O. BOX 2606 • FARMINGTON, NM 87499

- TECHNOLOGY BLENDING INDUSTRY WITH THE ENVIRONMENT -

OFF: (505) 323-5667



LAB: (505) 325-1556

AROMATIC VOLATILE ORGANICS

Attn: *Denver Bearden*
Company: *PNM Gas Services*
Address: *603 W. Elm*
City, State: *Farmington, NM 87401*

Date: *23-Aug-96*
COC No.: *4949*
Sample No.: *11877*
Job No.: *2-1000*

Project Name: *PNM Gas Services - Olmer A #5E*
Project Location: *9608211515; Pit Excavation Composite Sample*
Sampled by: *RH* Date: *21-Aug-96* Time: *15:15*
Analyzed by: *HR* Date: *22-Aug-96*
Sample Matrix: *Soil*

Laboratory Analysis

| Parameter | Result | Unit of Measure | Detection Limit | Unit of Measure |
|---------------------|----------------|-----------------|-----------------|-----------------|
| <i>Benzene</i> | <i><0.2</i> | <i>ug/kg</i> | <i>0.2</i> | <i>ug/kg</i> |
| <i>Toluene</i> | <i><0.2</i> | <i>ug/kg</i> | <i>0.2</i> | <i>ug/kg</i> |
| <i>Ethylbenzene</i> | <i><0.2</i> | <i>ug/kg</i> | <i>0.2</i> | <i>ug/kg</i> |
| <i>m,p-Xylene</i> | <i>3.4</i> | <i>ug/kg</i> | <i>0.2</i> | <i>ug/kg</i> |
| <i>o-Xylene</i> | <i>0.9</i> | <i>ug/kg</i> | <i>0.2</i> | <i>ug/kg</i> |
| | <i>TOTAL</i> | <i>4.3</i> | | <i>ug/kg</i> |

Method - SW-846 EPA Method 8020 Aromatic Volatile Organics by Gas Chromatography

Approved by: *[Signature]*
Date: *8/23/96*

P.O. BOX 2606 • FARMINGTON, NM 87499

- TECHNOLOGY BLENDING INDUSTRY WITH THE ENVIRONMENT -

Omler ASE

9-12-96

Amoco

Sec. 25, 28 N, 10 W

Land Farm : On location

Composite sample # 9609121345 6pt.

soil vapor PID reading : 9.9 ppm

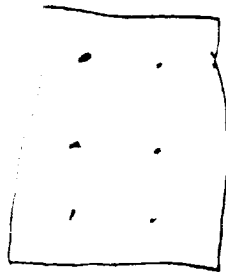

⊗

2"-12" depth
sand

Land Farm: Omler Federal #6

sec. 26, 28 N, 10 W

Amoco

Composite sample # 9609121355 6pt

soil vapor PID reading = 6.1 ppm

⊗

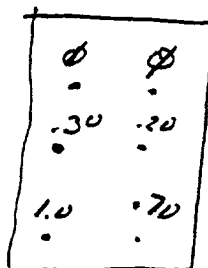

2"-12" depth
sand

OFF: (505) 325-5667



LAB: (505) 325-1556

Diesel Range Organics

Attn: *Denver Bearden*
Company: *PNM Gas Services*
Address: *603 W. Elm*
City, State: *Farmington, NM 87401*

Date: *16-Sep-96*
COC No.: *5039*
Sample No. *12142*
Job No. *2-1000*

Project Name: *PNM Gas Services - Omler A5E Landfarm: Omler Fed #6*
Project Location: *9609121345 on location; 6pt. Composite, 2"-12" depth*
Sampled by: *GC* Date: *12-Sep-96* Time: *13:45*
Analyzed by: *HR* Date: *14-Sep-96*
Sample Matrix: *Soil*

Laboratory Analysis

| <i>Parameter</i> | <i>Result</i> | <i>Unit of Measure</i> | <i>Detection Limit</i> | <i>Unit of Measure</i> |
|--|----------------|------------------------|------------------------|------------------------|
| <i>Diesel Range Organics (C10 - C28)</i> | <i><5.0</i> | <i>mg/kg</i> | <i>5.0</i> | <i>mg/kg</i> |

Quality Assurance Report

DRO QC No.: *0489-QC*

Calibration Check

| <i>Parameter</i> | <i>Method Blank</i> | <i>Unit of Measure</i> | <i>True Value</i> | <i>Analyzed Value</i> | <i>% Diff</i> | <i>Limit</i> |
|---------------------------------|---------------------|------------------------|-------------------|-----------------------|---------------|--------------|
| <i>Diesel Range (C10 - C28)</i> | <i><5.0</i> | <i>ppm</i> | <i>100</i> | <i>104</i> | <i>3.8</i> | <i>15%</i> |

Matrix Spike

| <i>Parameter</i> | <i>1- Percent Recovered</i> | <i>2- Percent Recovered</i> | <i>Limit</i> | <i>%RSD</i> | <i>Limit</i> |
|-------------------------------|-----------------------------|-----------------------------|-----------------|-------------|--------------|
| <i>Diesel Range (C10-C28)</i> | <i>82</i> | <i>96</i> | <i>(70-130)</i> | <i>11</i> | <i>20%</i> |

Method - SW-846 EPA Method 8015A mod. - Nonhalogenated Volatile Hydrocarbons by Gas Chromatography

Approved by: *[Signature]*
Date: *9/16/96*

P.O. BOX 2606 • FARMINGTON, NM 87499

- TECHNOLOGY BLENDING INDUSTRY WITH THE ENVIRONMENT -