

UNITED STATES
DEPARTMENT OF THE INTERIOR
GEOLOGICAL SURVEY30-045-24115
5. LEASE DESIGNATION AND SERIAL NO.
SF-079583

6. IF INDIAN, ALLOTTEE OR TRIBE NAME

7. UNIT AGREEMENT NAME

8. FARM OR LEASE NAME

Newman "C"

9. WELL NO.

#1E

10. FIELD AND POOL, OR WILDCAT

Basin Dakota

Undesignated Fruitland

11. SEC., T., R., M., OR BLK.
AND SURVEY OR AREA

Section 30, T28N, R10W

12. COUNTY OR PARISH

San Juan

13. STATE

New Mexico

APPLICATION FOR PERMIT TO DRILL, DEEPEN, OR PLUG BACK

1a. TYPE OF WORK

DRILL ☒DEEPEN ☐PLUG BACK ☐

b. TYPE OF WELL

OIL
WELL ☐GAS
WELL ☒

OTHER

SINGLE
ZONE ☐MULTIPLE
ZONE ☒

2. NAME OF OPERATOR

Southland Royalty Company

3. ADDRESS OF OPERATOR

P. O. Drawer 570, Farmington, NM 87401

4. LOCATION OF WELL (Report location clearly and in accordance with any State requirements.)*

At surface

E 1555' FNL & 790' FWL

At proposed prod. zone

14. DISTANCE IN MILES AND DIRECTION FROM NEAREST TOWN OR POST OFFICE*

Approximately 4 1/2 miles south of Bloomfield

15. DISTANCE FROM PROPOSED*

LOCATION TO NEAREST
PROPERTY OR LEASE LINE, FT.
(Also to nearest drlg. unit line, if any)

235'

16. NO. OF ACRES IN LEASE

202.34

18. DISTANCE FROM PROPOSED LOCATION*
TO NEAREST WELL, DRILLING COMPLETED,
OR APPLIED FOR, ON THIS LEASE, FT.

750'

19. PROPOSED DEPTH

6468'

17. NO. OF ACRES ASSIGNED
TO THIS WELL

320/160 164.65

20. ROTARY OR CABLE TOOLS

Rotary

21. ELEVATIONS (Show whether DP, RT, GR, etc.)

5791' GR

22. APPROX. DATE WORK WILL START*

March 31, 1980

23. PROPOSED CASING AND CEMENTING PROGRAM

SIZE OF HOLE	SIZE OF CASING	WEIGHT PER FOOT	SETTING DEPTH	QUANTITY OF CEMENT
12 1/4"	8 5/8"	24#	200'	140 Sacks
7 7/8"	5 1/2"	15.5#	6468'	215 Sacks (Stage One)
				260 Sacks (Stage Two)
				155 Sacks (Stage Three)

Surface formation is Nacimiento.

Top of Ojo Alamo sand is at 1103'.

Top of Mesa Verde sand is at 3303'.

Fresh water mud will be used to drill from surface to Total Depth.

It is anticipated that an IES and GR-Density log will be run at Total Depth.

No abnormal pressures or poisonous gases are anticipated in this well.

It is expected that this well will be drilled before August 31, 1980.

Gas is dedicated.

IN ABOVE SPACE DESCRIBE PROPOSED PROGRAM: If proposal is to deepen or plug back, give data on present productive zone and proposed new productive zone. If proposal is to drill or deepen directionally, give pertinent data on subsurface locations and measured and true vertical depths. Give blowout preventer program, if any.

24.

SIGNED

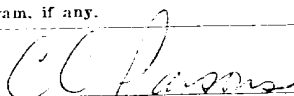

TITLE

District Engineer

DATE

12-4-79

(This space for Federal or State office use)

PERMIT NO.

APPROVAL DATE

APPROVED BY

TITLE

DATE

CONDITIONS OF APPROVAL, IF ANY:

DE NW 443

ok Smith

All distances must be from the outer boundaries of the Section.

Operator SOUTHLAND ROYALTY COMPANY			Lease NEWMAN "C"		Well No. 1-E
Unit Letter E	Section 30	Township 28N	Range 10W	County San Juan	
Actual Footage Location of Well: 1555 feet from the North line and 790 feet from the West line					
Ground Level Elev. 5791	Producing Formation Dakota / Fruitland		Pool Basin / Undesignated	Dedicated Acreage: 324.65 320/160 / 64.65 Acres	

1. Outline the acreage dedicated to the subject well by colored pencil or hachure marks on the plat below.
2. If more than one lease is dedicated to the well, outline each and identify the ownership thereof (both as to working interest and royalty).
3. If more than one lease of different ownership is dedicated to the well, have the interests of all owners been consolidated by communitization, unitization, force-pooling, etc?

☒ Yes ☐ No If answer is "yes," type of consolidation Communitized

If answer is "no," list the owners and tract descriptions which have actually been consolidated. (Use reverse side of this form if necessary.)

No allowable will be assigned to the well until all interests have been consolidated (by communitization, unitization, forced-pooling, or otherwise) or until a non-standard unit, eliminating such interests, has been approved by the Commission.

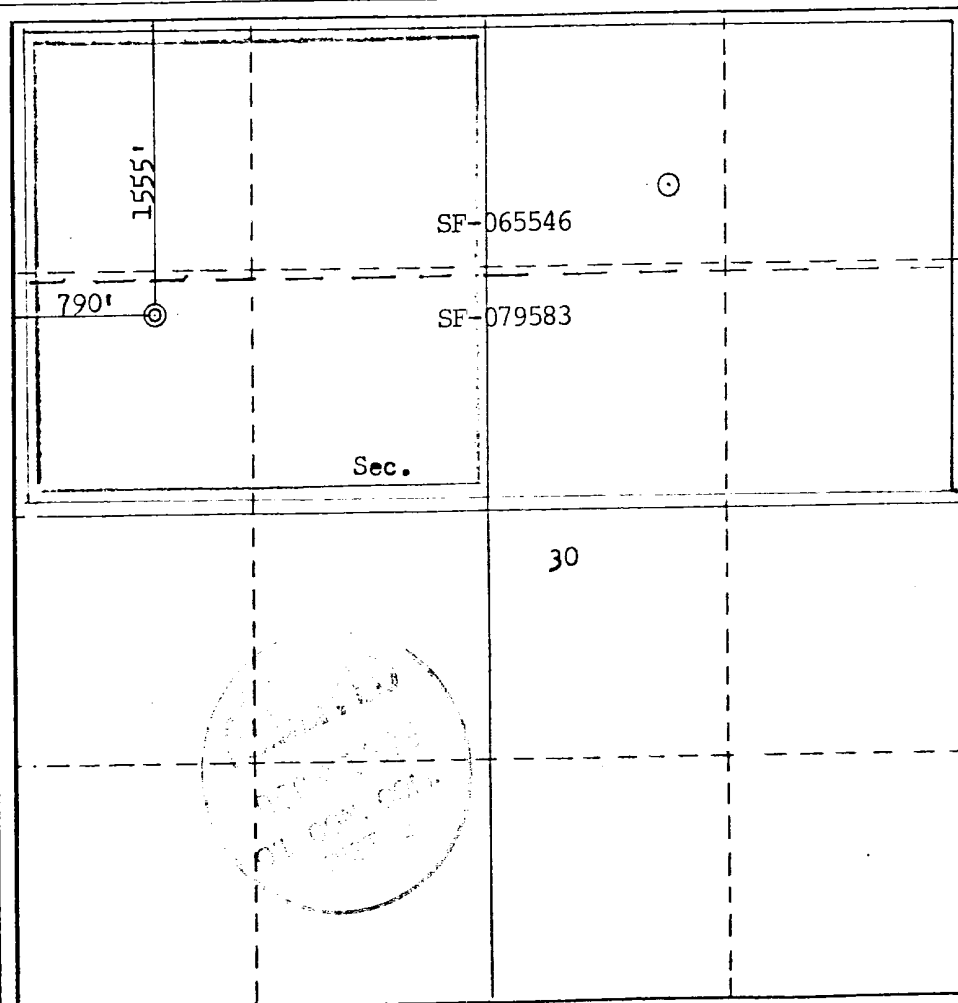

CERTIFICATION

I hereby certify that the information contained herein is true and complete to the best of my knowledge and belief.

CC Parsons

Name
Curtis C. Parsons

Position
District Engineer

Company
Southland Royalty Company

Date
December 4, 1979

I hereby certify that the well location shown on this plat was plotted from field notes of actual surveys made by me or under my supervision, and that the same is true and correct to the best of my knowledge and belief.

Date Surveyed
October 15, 1979

Registered Professional Engineer and/or Land Surveyor No.

Fred B. Kerr Jr.
Fred B. Kerr Jr.

Certificate No.
3950

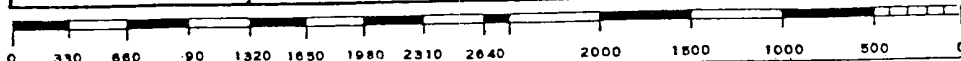

SOUTHLAND ROYALTY COMPANY - DRILLING SCHEDULE

N E W M A N " C " # 1 E

1555' FNL & 790' FWL
Section 30, T28N, R10W
San Juan County, New Mexico

Field: Basin Dakota/Undes. Fruitland Elevation: 5791' GR

Geology:

Formation Tops:	Ojo Alamo	1103'	Gallup	5328'
	Fruitland	1543'	Graneros	6148'
	Pictured Cliffs	1773'	Dakota	6268'
	Cliff House	3303'	Total Depth	6468'
	Point Lookout	4118'		

Logging Program: IES and GR-Density from Total Depth to surface casing.

Drilling:

Contractor: Tool Pusher:

SRC Representative: SRC Answering Service: 325-1841
Dispatch Number: 325-7391

Mud Program: Fresh water to 5300'. Mud up at 5300'. Maintain mud weight of 8.9 to 9.3, viscosity of 35 to 40, water loss of 10 to 12 cc. Anticipate losing some mud in the lower Gallup formation at approximately 5700'. Have LCM available on location.

Materials:

Casing Program:	Hole Size	Depth	Casing Size	Wt. & Grade
	12 1/4"	200'	8 5/8"	24# K-55
	7 7/8"	6468'	5 1/2"	15.5# K-55

Float Equipment:

8 5/8" Surface Casing: Pathfinder type "A" guide shoe.

5 1/2" Production Casing: Pathfinder type "A" guide shoe. Self-fill, flapper type collar run one joint above shoe. 5 Pathfinder bow-type stabilizers run every other joint above shoe. Run Dowell stage tools at 4500' and 1980'. Run one cement basket below and 5 Pathfinder rigid stabilizers above each tool.

Wellhead Equipment: 8 5/8" x 10", 2000# casing head with 5 1/2" casing hanger 6", 2000# x 10", 2000# tubing head and tree

Cementing:

8 5/8" Surface Casing: 140 sacks (165 cu. ft.) of Class "B" with 1/4# gel flake per sack and 3% CaCl_2 . WOC 12 hours. Test to 600# prior to drilling out. (Volume is 100% excess.)

5 1/2" Production Casing: STAGE ONE: 165 sacks (247 cu. ft.) of 50/50 Poz with 6% gel, 1/4# gel flake per sack, followed by 50 sacks of neat with 2% CaCl_2 . (Volume is 25% excess to cover top of Gallup.)

STAGE TWO: 210 sacks (311 cu. ft.) of 50/50 Poz with 6% gel followed by 50 sacks of neat with 2% CaCl_2 . (Volume is 50% excess to cover top of Cliff House.)

STAGE THREE: 155 sacks (228 cu. ft.) of 50/50 Poz with 6% gel. (Volume is 50% excess to cover top of Ojo Alamo.)

WOC and circulate between stages as required by well conditions.

L. O. Van Rayan
District Production Manager



Southland Royalty Company

December 4, 1979

United States Geological Survey
Mr. James Sims
P. O. Box 959
Farmington, NM 87401

Dear Sir:

Enclosed please find a map showing existing roads and planned access roads to Southland Royalty Company's Newman "C" #1E well.

The locations of tank batteries and flow lines will be on location with well. A burn pit will be provided for disposal of trash. Cuttings, drilling fluid and produced fluids will be put into the reserve pit and properly disposed of depending on amount and type of fluids.

There will be no camps or airstrips.

Also, enclosed is a location layout showing approximate location of rig, pits and pipe racks.

Water supply will be The San Juan River.

The location will be restored according to Bureau of Land Management standards. This work will begin when all related construction is finished.

Mr. Ross Lankford will be Southland Royalty Company's field representative supervising these operations.

Yours truly,

C. C. Parsons
Curtis C. Parsons
District Engineer

CCP/ke



Southland Royalty Company

United States Geological Survey
Mr. James Sims
P. O. Box 595
Farmington, NM 87401

Dear Sir:

I hereby certify that I, or persons under my direct supervision, have inspected the proposed drillsite and access route; that I am familiar with the conditions which presently exist; that the statements made in this plan are, to the best of my knowledge, true and correct; and, that the work associated with the operations proposed herein will be performed by Southland Royalty Company and its contractors and subcontractors in conformity with this plan and the terms and conditions under which it is approved.

Date: December 4, 1979

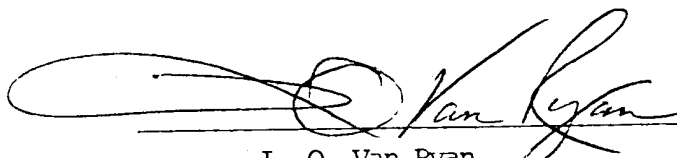
L. O. Van Ryan
District Production Manager

LOVR/ke



Southland Royalty Company

December 4, 1979

United States Geological Survey
Mr. James Sims
P. O. Box 959
Farmington, NM 87401

RE: Blowout Preventer Plan

Dear Sir:

All drilling and completion rigs will be equipped with 6" or larger double hydraulic blowout preventers and a hydraulic closing unit with steel lines.

The preventer is 3000# working pressure and 6000# test pressure.

All crews will be thoroughly trained in the operation of this preventer. The preventer will be tested frequently enough to insure proper operation.

Yours truly,

Curtis C. Parsons
District Engineer

CCP/ke

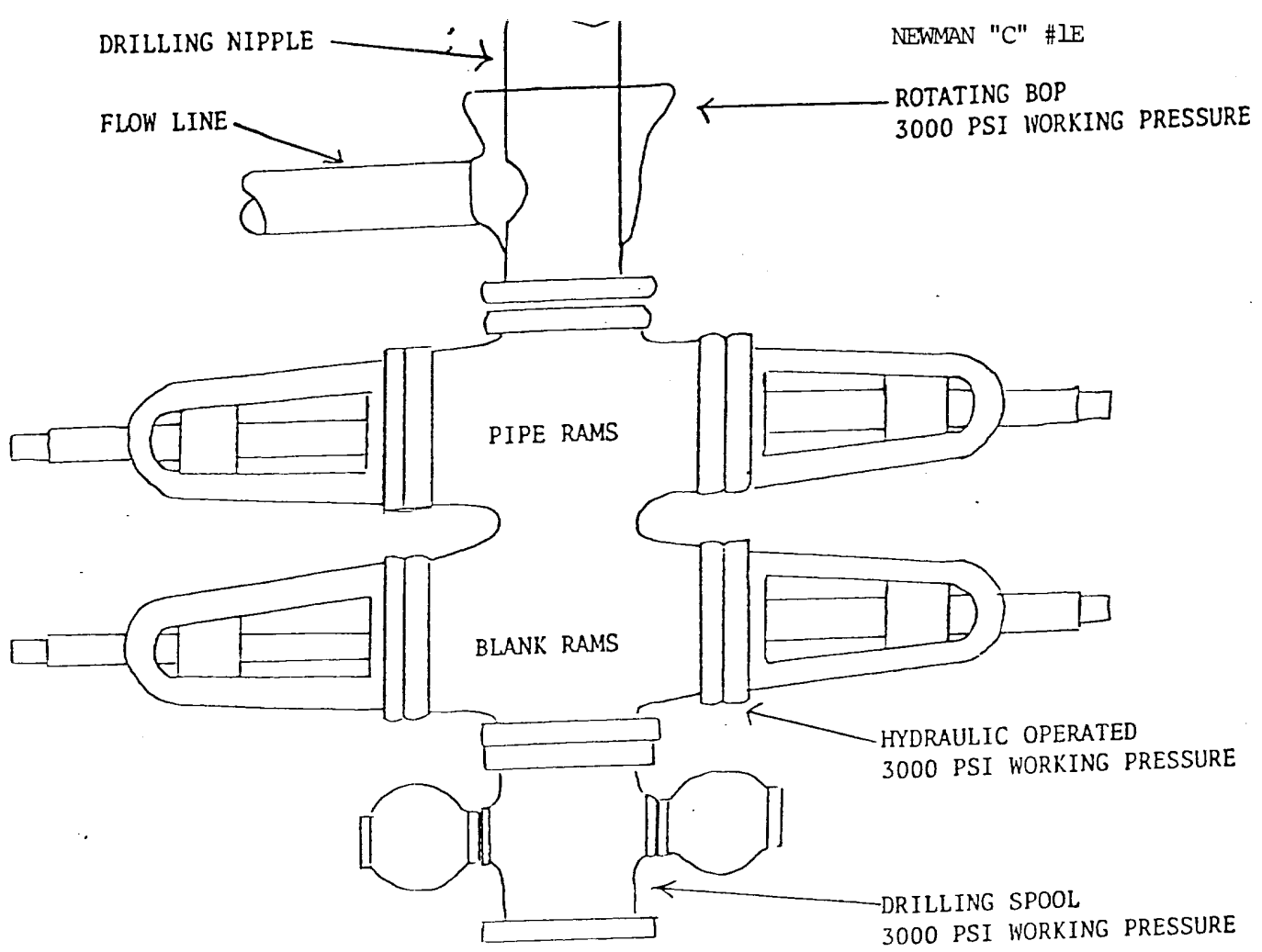

PREVENTERS AND SPOOLS ARE TO HAVE
THROUGH BORE OF 6" - 3000 PSI OR LARGER

Location Profile for
SOUTHLAND ROYALTY CO. #1E NEWMAN C
1555' FNL 790' FWL Sec 30-T28N-R10W SAN JUAN COUNTY, NEW MEXICO

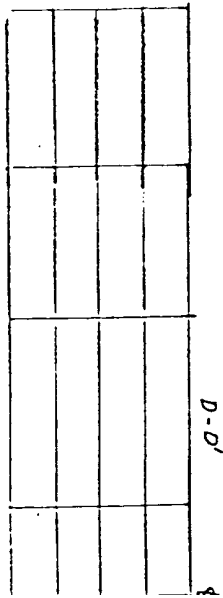
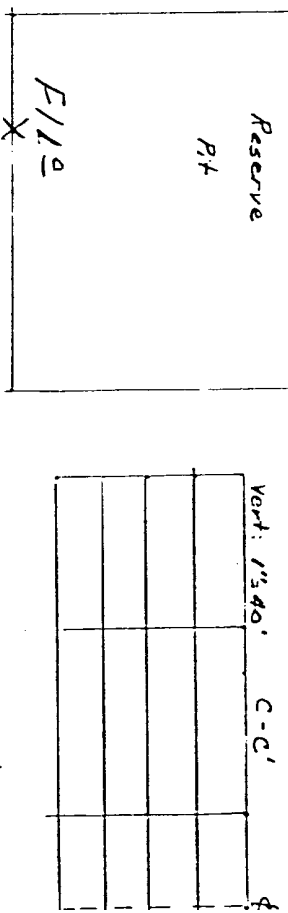
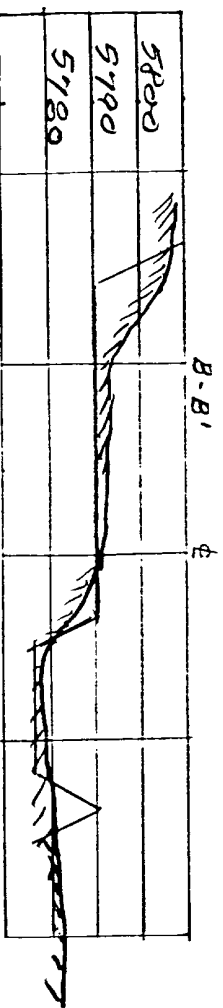
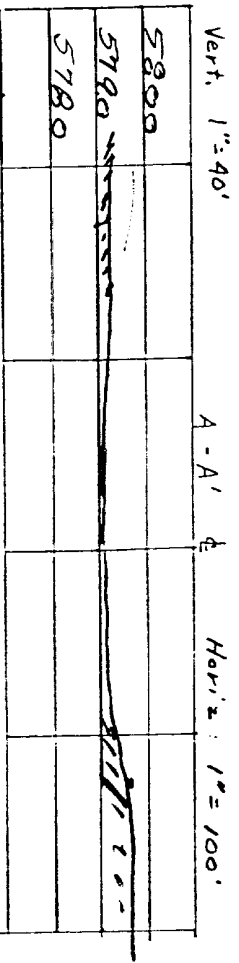
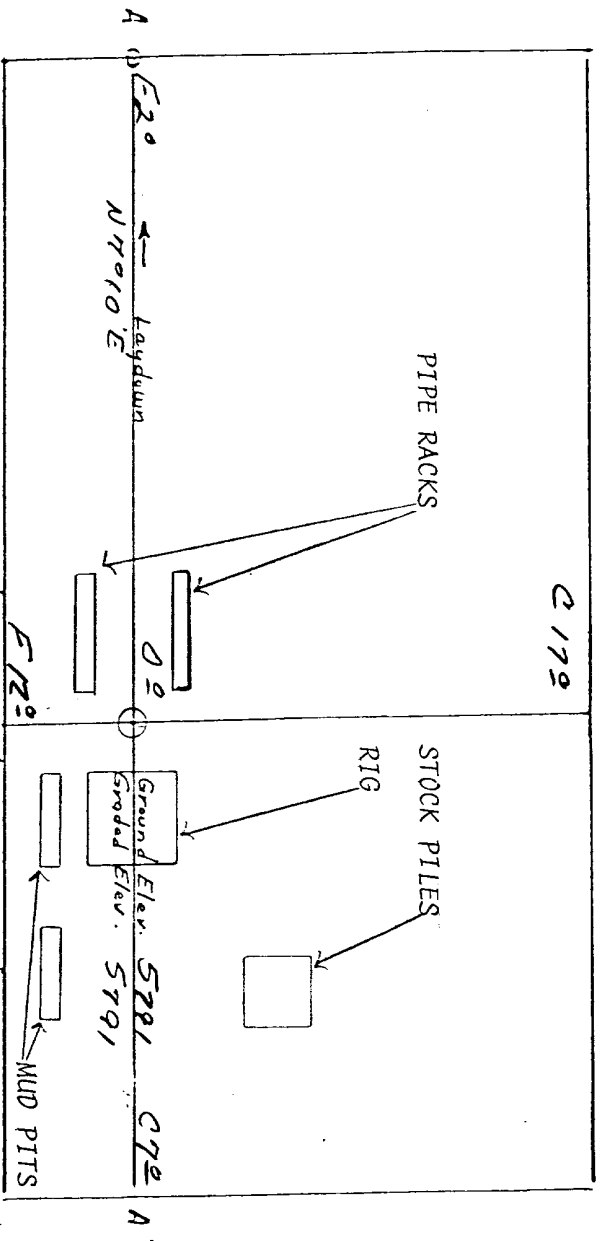

KERR LAND SURVEYING
Date: _____

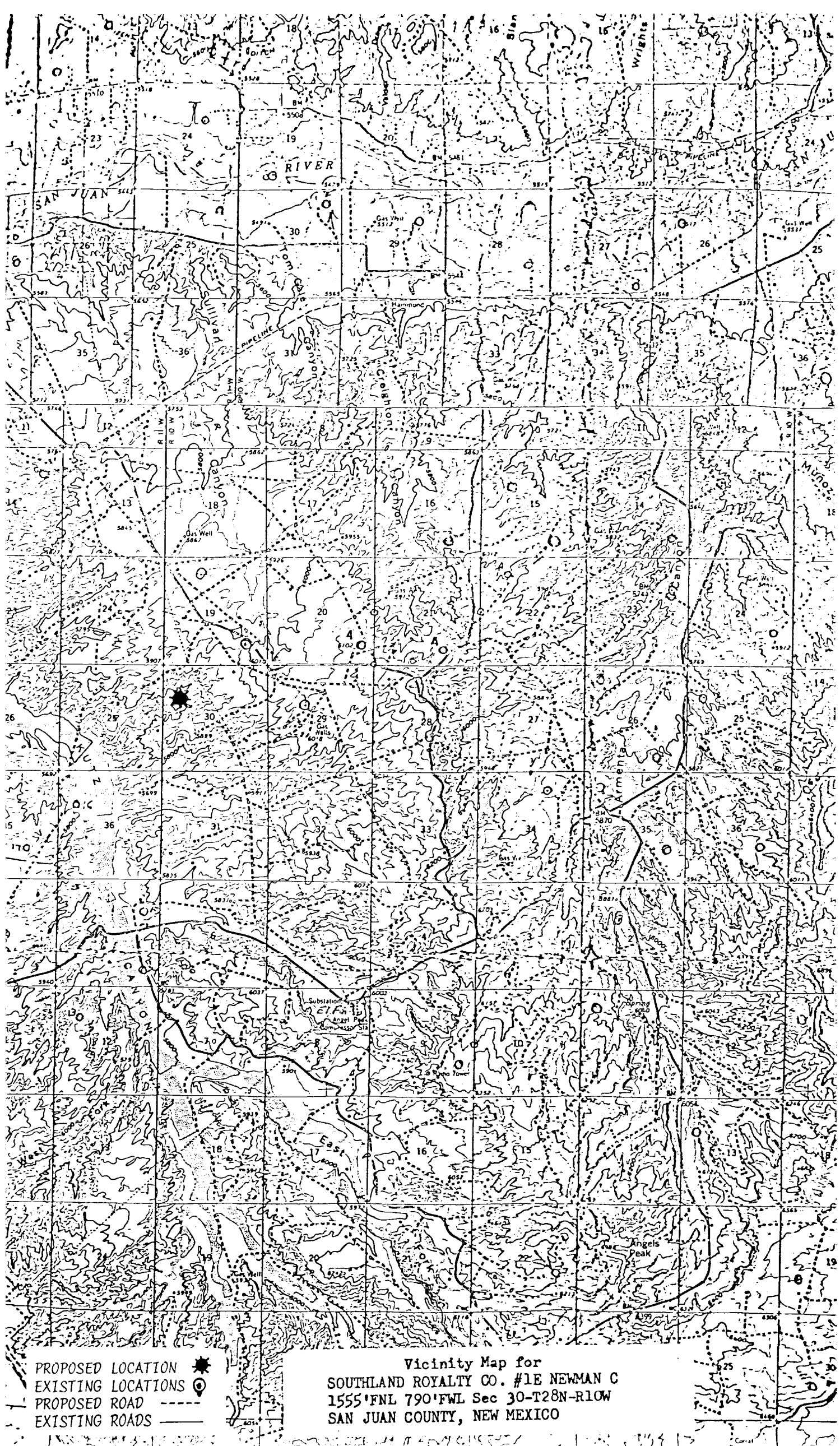

- PROPOSED LOCATION
- EXISTING LOCATIONS
- PROPOSED ROAD
- EXISTING ROADS

Vicinity Map for
SOUTHLAND ROYALTY CO. #1E NEWMAN C
1555'FNL 790'FWL Sec 30-T28N-R10W
SAN JUAN COUNTY, NEW MEXICO