

All distances must be from the outer boundaries of the Section.

Operator SUPRON ENERGY CORPORATION			Lease ANGEL PEAK		Well No. 22
Unit Letter M	Section 7	Township 28 NORTH	Range 10 WEST	County SAN JUAN	
Actual Footage Location of Well:					
1105	feet from the	SOUTH	line and	790	feet from the
					WEST
Ground Level Elev. 5752	Producing Formation BLOOMFIELD		Pool CHACRA		Dedicated Acreage: W/2 129.78 Acres

1. Outline the acreage dedicated to the subject well by colored pencil or hatchure marks on the plat below.
2. If more than one lease is dedicated to the well, outline each and identify the ownership thereof (both as to working interest and royalty).
3. If more than one lease of different ownership is dedicated to the well, have the interests of all owners been consolidated by communitization, unitization, force-pooling, etc?

☐ Yes ☐ No If answer is "yes," type of consolidation _____

If answer is "no," list the owners and tract descriptions which have actually been consolidated. (Use reverse side of this form if necessary.) _____

No allowable will be assigned to the well until all interests have been consolidated (by communitization, unitization, forced-pooling, or otherwise) or until a non-standard unit, eliminating such interests, has been approved by the Division.

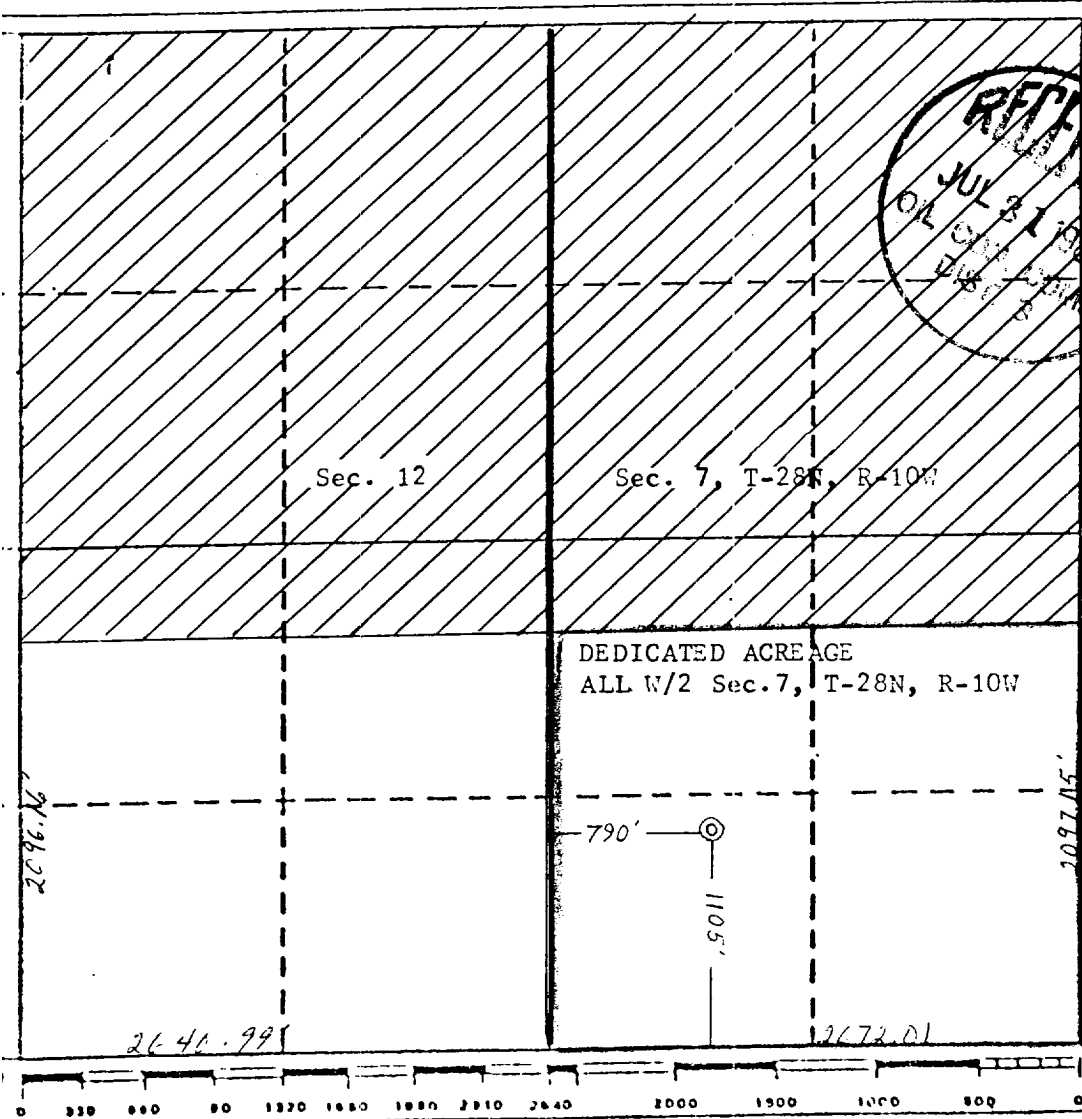

CERTIFICATION

I hereby certify that the information contained herein is true and complete to the best of my knowledge and belief.

Kenneth E. Roddy
Name

Kenneth E. Roddy

Position

Production Superintendent

Company

Supron Energy Corporation

Date

July 31, 1980

I hereby certify that the well location shown on this plat was plotted from field notes, if actual surveys made by me or under my supervision, and that the same is true and correct to the best of my knowledge and belief.

Date Surveyed

July 10, 1979

Registered Professional Engineer and/or Land Surveyor

Certificate No.

1463