

UNITED STATES  
DEPARTMENT OF THE INTERIOR  
GEOLOGICAL SURVEY

## APPLICATION FOR PERMIT TO DRILL, DEEPEN, OR PLUG BACK

## 1a. TYPE OF WORK

DRILL ☒DEEPEN ☐PLUG BACK ☐

## b. TYPE OF WELL

OIL  
WELL ☐GAS  
WELL ☒

OTHER

SINGLE  
ZONE ☐MULTIPLE  
ZONE ☐

## 2. NAME OF OPERATOR

Pioneer Production Corp.

## 3. ADDRESS OF OPERATOR

Box 208, Farmington, NM 87401

## 4. LOCATION OF WELL (Report location clearly and in accordance with any State requirements.\*)

At surface

1100' FSL - 1540' FEL

At proposed prod. zone

## 14. DISTANCE IN MILES AND DIRECTION FROM NEAREST TOWN OR POST OFFICE\*

2 miles southwest of Bloomfield, NM

## 15. DISTANCE FROM PROPOSED\*

LOCATION TO NEAREST  
PROPERTY OR LEASE LINE, FT.  
(Also to nearest drlg. unit line, if any)

1100'

## 18. DISTANCE FROM PROPOSED LOCATION\*

TO NEAREST WELL, DRILLING, COMPLETED,  
OR APPLIED FOR, ON THIS LEASE, FT.

2750'

## 16. NO. OF ACRES IN LEASE

## 19. PROPOSED DEPTH

6360'

## 17. NO. OF ACRES ASSIGNED

TO THIS WELL  
333.55

## 20. ROTARY OR CABLE TOOLS

Rotary

## 21. ELEVATIONS (Show whether DF, RT, GR, etc.)

5555' GL

## 22. APPROX. DATE WORK WILL START\*

ASAP

## 23.

## PROPOSED CASING AND CEMENTING PROGRAM

SIZE OF HOLE	SIZE OF CASING	WEIGHT PER FOOT	SETTING DEPTH	QUANTITY OF CEMENT
12-1/4"	8-5/8"	24#	500'	275 sx class "B" CEMENT
7-7/8"	4-1/2"	11.6#	6360'	920 sx in two stages

Plan to drill with mud to test Basin Dakota Formation. Plan to run IES log to TD  
If productive, plan to set 4-1/2" casing, cement in two stages, selectively perforate,  
frac, clean out after frac, run 1-1/2" tbq and complete well.

Plan to use BOP furnished by rig while drilling (10" 3000 psi hydraulic)

Plan to use BOP rental while completing (6" 3000 psi double gate manual)

NMERB: Gas dedicated

RECEIVED

APR 1 1980

U. S. GEOLOGICAL SURVEY  
FARMINGTON, N. M.

IN ABOVE SPACE DESCRIBE PROPOSED PROGRAM: If proposal is to deepen or plug back, give data on present productive zone and proposed new productive zone. If proposal is to drill or deepen directionally, give pertinent data on subsurface locations and measured and true vertical depths. Give blowout preventer program, if any.

## 24.

SIGNED

Thomas A. Dugan

TITLE

Agent

DATE

3-31-80

(This space for Federal or State office use)

PERMIT NO.

APPROVAL DATE

APPROVED BY

TITLE

CONDITIONS OF APPROVAL, IF ANY:

APPROVED  
DATE

MAY 20 1980

DISTRICT ENGINEER

\*See Instructions On Reverse Side

All partial Sec 8 and  
Lot 4 (SW/4 SW/4) of partial  
Sec 9 - B-1814 (11)

**NEW MEXICO OIL CONSERVATION COMMISSION**  
**WELL LOCATION AND ACREAGE DEDICATION PLAT**

Form O-102  
 Supersedes O-124  
 Effective 1-1-65

All distances must be from the outer boundaries of the Section.

Operator <b>Pioneer Production Corporation</b>			Lease <b>Lucerne</b>		Well No. <b>1-E</b>
Unit Letter <b>0</b>	Section <b>8</b>	Township <b>28 North</b>	Range <b>11 West</b>	County <b>San Juan</b>	
Actual Footage Location of Well: <b>1100</b> feet from the <b>South</b> line and <b>1540</b> feet from the <b>East</b> line					
Ground Level Elev. <b>5555</b>	Producing Formation <b>Dakota</b>	Pool <b>Basin</b>		Dedicated Acreage: <b>333.55</b> Acres	

1. Outline the acreage dedicated to the subject well by colored pencil or hachure marks on the plat below.
2. If more than one lease is dedicated to the well, outline each and identify the ownership thereof (both as to working interest and royalty).
3. If more than one lease of different ownership is dedicated to the well, have the interests of all owners been consolidated by communitization, unitization, force-pooling, etc?

☐ Yes    ☐ No    If answer is "yes," type of consolidation \_\_\_\_\_

If answer is "no," list the owners and tract descriptions which have actually been consolidated. (Use reverse side of this form if necessary.) \_\_\_\_\_

No allowable will be assigned to the well until all interests have been consolidated (by communitization, unitization, forced-pooling, or otherwise) or until a non-standard unit, eliminating such interests, has been approved by the Commission.

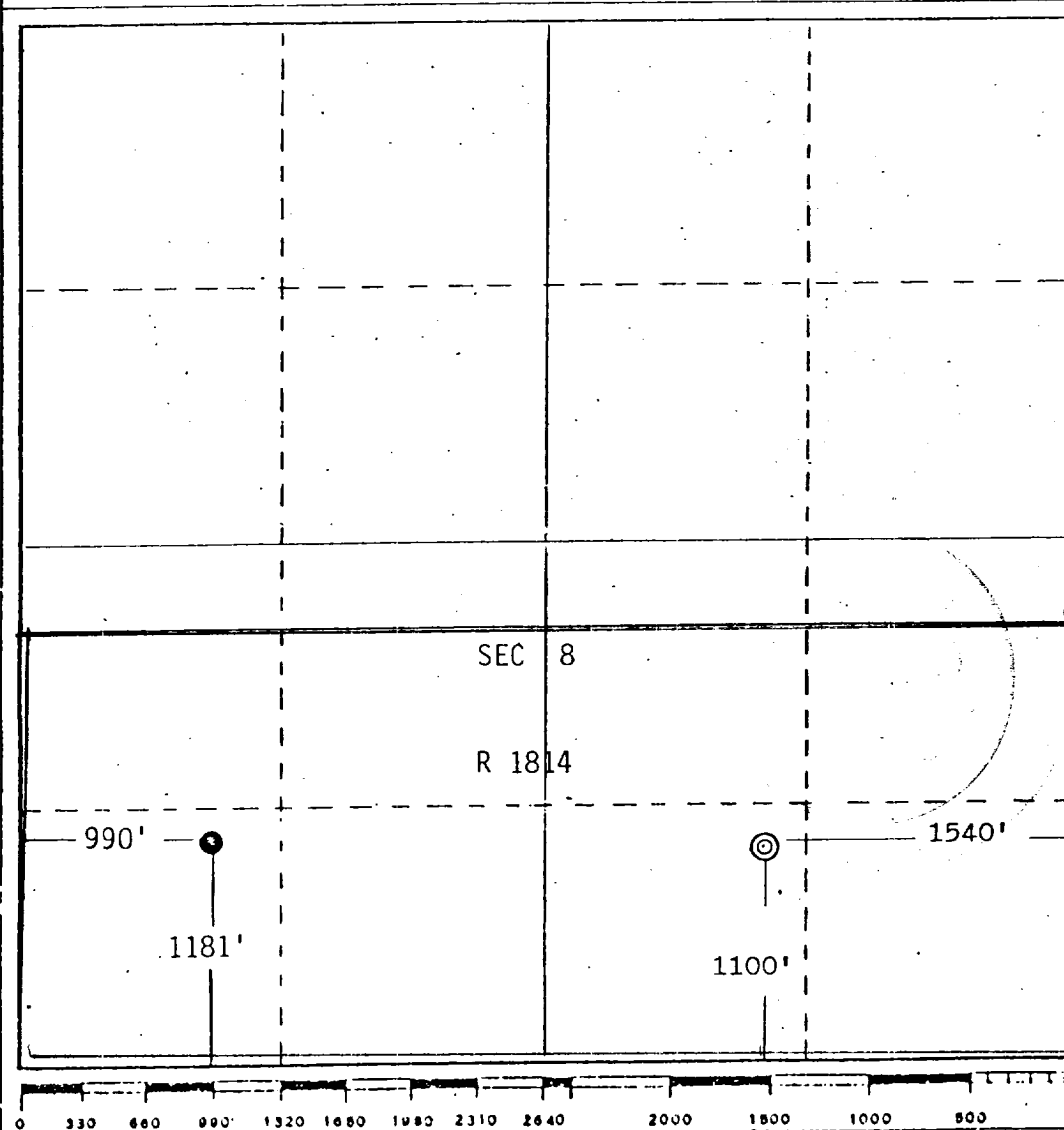

<b>CERTIFICATION</b>	
I hereby certify that the information contained herein is true and complete to the best of my knowledge and belief.	
<i>Thomas A. Dugan</i>	
Name	Thomas A. Dugan
Position	Agent
Company	Pioneer Production Corp.
Date	3-31-80
I hereby certify that the well location shown by this plat was plotted from field notes of actual surveys made by me or under my supervision, and that the same is true and correct to the best of my knowledge and belief.	
Date Surveyed	March 27, 1980
Registered Professional Engineer and/or Land Surveyor	
<i>Edgar L. Risenhoover</i>	
Certificate No.	5979
Edgar L. Risenhoover, L.S.	