

UNITED STATES
DEPARTMENT OF THE INTERIOR
GEOLOGICAL SURVEY

APPLICATION FOR PERMIT TO DRILL, DEEPEN, OR PLUG BACK

1a. TYPE OF WORK

DRILL ☒DEEPEN ☐PLUG BACK ☐

b. TYPE OF WELL

OIL
WELL ☐GAS
WELL ☒

OTHER

SINGLE
ZONE ☐MULTIPLE
ZONE ☒

2. NAME OF OPERATOR

Southland Royalty Company

3. ADDRESS OF OPERATOR

P. O. Drawer 570, Farmington, NM 87401

4. LOCATION OF WELL (Report location clearly and in accordance with any State requirements.)*

At surface

1540' FSL & 930' FWL

At proposed prod. zone

14. DISTANCE IN MILES AND DIRECTION FROM NEAREST TOWN OR POST OFFICE*

Approximately 2 1/2 miles south of Bloomfield, NM

15. DISTANCE FROM PROPOSED*

LOCATION TO NEAREST

PROPERTY OR LEASE LINE, FT.

(Also to nearest drlg. unit line, if any)

930'

18. DISTANCE FROM PROPOSED LOCATION*

TO NEAREST WELL, DRILLING, COMPLETED,

OR APPLIED FOR, ON THIS LEASE, FT.

1400'

16. NO. OF ACRES IN LEASE

440

19. PROPOSED DEPTH

6340'

17. NO. OF ACRES ASSIGNED
TO THIS WELL

N 320

8 160

20. ROTARY OR CABLE TOOLS

Rotary

21. ELEVATIONS (Show whether DF, RT, GR, etc.)

5581' GR

22. APPROX. DATE WORK WILL START*

September 15, 1980

23.

PROPOSED CASING AND CEMENTING PROGRAM

SIZE OF HOLE	SIZE OF CASING	WEIGHT PER FOOT	SETTING DEPTH	QUANTITY OF CEMENT
12 1/4"	8 5/8"	24#	200'	140 sacks
7 7/8"	5 1/2"	15.5#	6340'	180 sacks - Stage One
				203 sacks - Stage Two
				316 sacks - Stage Three

Surface formation is Nacimiento.

Top of Ojo Alamo Sand is at 400'. The Top of the Kirtland shale is at 612'.

Top of Pictured Cliffs sand is at 1607'.

Fresh water mud will be used to drill from surface to total depth.

It is anticipated that an IES and GR-Density log will be run at total depth.

No abnormal pressures or poisonous gases are anticipated in this well.

It is expected that this well will be drilled before December 31, 1980. This depends on time required for approval, rig availability and the weather.

Gas is dedicated.

IN ABOVE SPACE DESCRIBE PROPOSED PROGRAM: If proposal is to deepen or plug back, give data on present productive zone and proposed new productive zone. If proposal is to drill or deepen directionally, give pertinent data on subsurface locations and measured and true vertical depths. Give blowout preventer program, if any.

24.

SIGNED

Curtis C. Parsons

TITLE District Engineer

DATE

4-11-80

(This space for Federal or State office use)

PERMIT NO.

APPROVAL DATE

APPROVED BY

CONDITIONS OF APPROVAL, IF ANY:

DRILLING OPERATIONS AUTHORIZED ARE
SUBJECT TO COMPLIANCE WITH ATTACHED
"GENERAL REQUIREMENTS"APPROVED
AS AMENDED

DATE

JUN 24 1980

James F. Sims
JAMES F. SIMS
DISTRICT ENGINEER

All distances must be from the outer boundaries of the Section

Operator SOUTHLAND ROYALTY COMPANY			Lease AZTEC		Well No. 7-E
Unit Letter L	Section 14	Township 28N	Range 11W	County San Juan	
Actual Footage Location of Well: 1540 feet from the South line and 930 feet from the West line					
Ground Level Elev. 5581	Producing Formation Dakota - Pictured Cliffs		Pool Basin-Fulcher Kutz		Dedicated Acreage: 320 -160 Acres

1. Outline the acreage dedicated to the subject well by colored pencil or hatchure marks on the plat below.
2. If more than one lease is dedicated to the well, outline each and identify the ownership thereof (both as to working interest and royalty).
3. If more than one lease of different ownership is dedicated to the well, have the interests of all owners been consolidated by communitization, unitization, force-pooling, etc?

☐ Yes ☐ No If answer is "yes," type of consolidation _____

If answer is "no," list the owners and tract descriptions which have actually been consolidated. (Use reverse side of this form if necessary.) _____

No allowable will be assigned to the well until all interests have been consolidated (by communitization, unitization, forced-pooling, or otherwise) or until a non-standard unit, eliminating such interests, has been approved by the Commission.

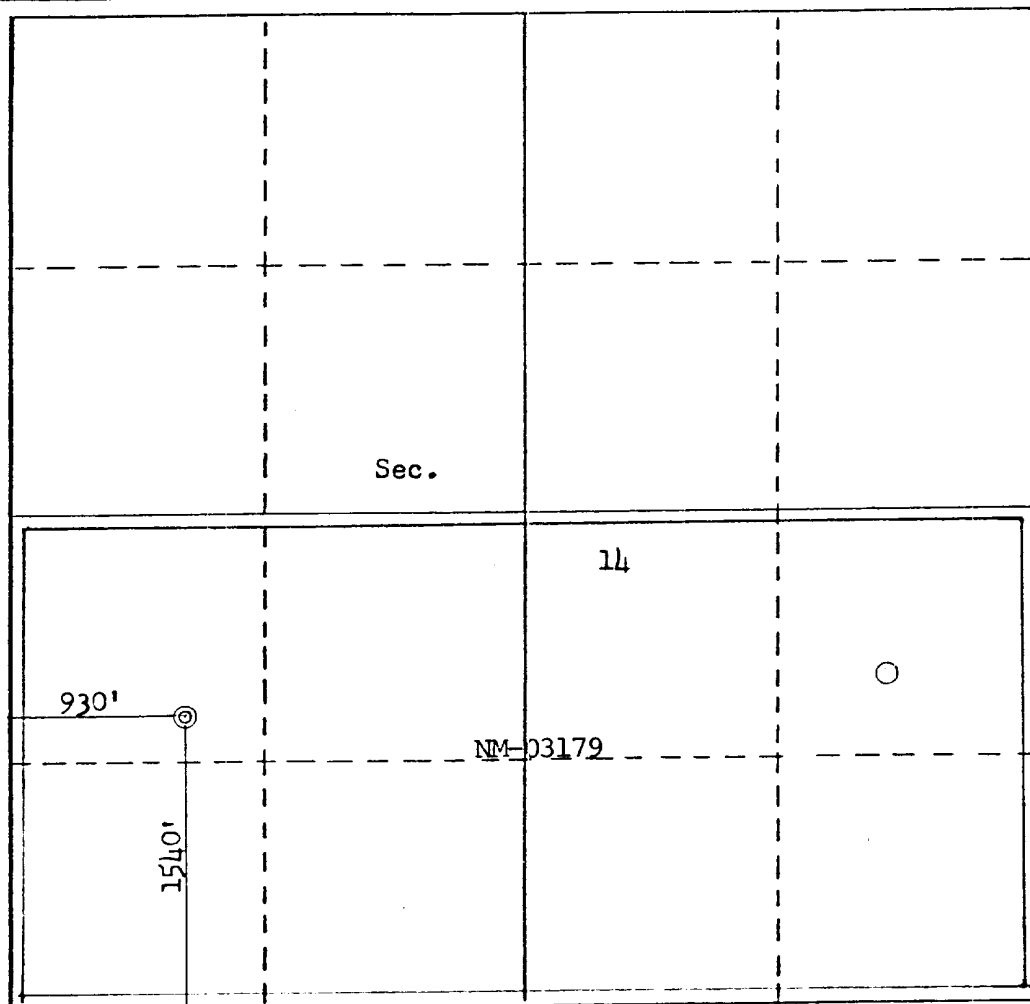

CERTIFICATION

I hereby certify that the information contained herein is true and complete to the best of my knowledge and belief.

Curtis C. Parsons

Name

Curtis C. Parsons

Position

District Engineer

Company

Southland Royalty Company

Date

April 11, 1980

I hereby certify that the well location shown on this plat was plotted from field notes of actual surveys made by me or under my supervision, and that the same is true and correct to the best of my knowledge and belief.

Date Surveyed

February 25, 1980

Registered Professional Engineer and/or Land Surveyor

Fred B. Kerr, Jr.
Fred B. Kerr, Jr.

Certificate No.

3950

SOUTHLAND ROYALTY COMPANY - DRILLING SCHEDULE

AZTEC #7E
1540' FSL & 930' FWL
Section 14, T28N, R11W
San Juan County, New Mexico

Field: Basin Dakota/Fulcher Kutz
Pictured Cliffs

Elevation: 5581' GR

Geology:

Formation Tops:	Ojo Alamo	400'	Greenhorn	5949'
	Fruitland	1394'	Graneros	6011'
	Pictured Cliffs	1607'	Dakota	6120'
	Cliff House	3142'	Total Depth	6340'
	Gallup	5172'		

Logging Program: IES and GR-Density from Total Depth to surface casing.

Drilling:

Contractor:

Tool Pusher:

SRC Representative:

SRC Answering Service: 325-1841
Dispatch Number: 325-7391

Mud Program: Drill to 5500' with water and benex. Mud up at 5500' to 40 sec. viscosity and pretreat with 10% LCM.

Materials:

Casing Program:	Hole Size	Depth	Casing Size	Wt. & Grade
	12 1/4"	200'	8 5/8"	24# H-40
	7 7/8"	6340'	5 1/2"	15.5# K-55

Float Equipment:

8 5/8" Surface Casing: Pathfinder type "A" guide shoe.

5 1/2" Production Casing: Pathfinder type "A" guide shoe. Self-fill flapper type float collar run one joint above shoe. Five Pathfinder bow-type centralizers (run every other joint above shoe). Run Dowell stage tools at 1800' and 4300' with one cement basket below and five centralizers above each tool.

Wellhead Equipment: 8 5/8" X 10" 2000 psi casing head with 5 1/2" slips
10" 2000 X 6" 2000 tubing head with 1 1/2" IJ X 1 1/2" EUE hanger

Cementing:

8 5/8" Surface Casing: 140 sacks (165 cu. ft.) of Class "B" with 1/4# gel flake per sack and 3% CaCl₂. WOC for 12 hours. Test to 600# prior to drilling out. (Volume is 100% excess.)

5 1/2" Production Casing: STAGE ONE
130 sacks (194 cu. ft.) of 50/50 Poz with 6% gel, 1/4# gel flake per sack, followed by 50 sacks of Neat with 2% CaCl₂. (Volume is 25% excess to cover top of Gallup.)

STAGE TWO
203 sacks (301 cu. ft.) of 50/50 Poz with 6% gel. (Volume is 50% excess to cover top of Cliff House.)

STAGE THREE
316 sacks (468 cu. ft.) of 50/50 Poz with 6% gel. (Volume is 50% excess to cover top of surface.)

WOC and circulate between stages as required by well conditions.

L. O. Van Ryan
District Production Manager

LOVR/ke



Southland Royalty Company

April 11, 1980

United States Geological Survey
Mr. James Sims
P. O. Box 959
Farmington, NM 87401

RE: Blowout Preventer Plan

Dear Sir:

All drilling and completion rigs will be equipped with 6" or larger double hydraulic blowout preventers and a hydraulic closing unit with steel lines.

The preventer is 3000# working pressure and 6000# test pressure.

All crews will be thoroughly trained in the operation of this preventer. The preventer will be tested frequently enough to insure proper operation.

Yours truly,

Curtis C. Parsons
District Engineer

CCP/ke

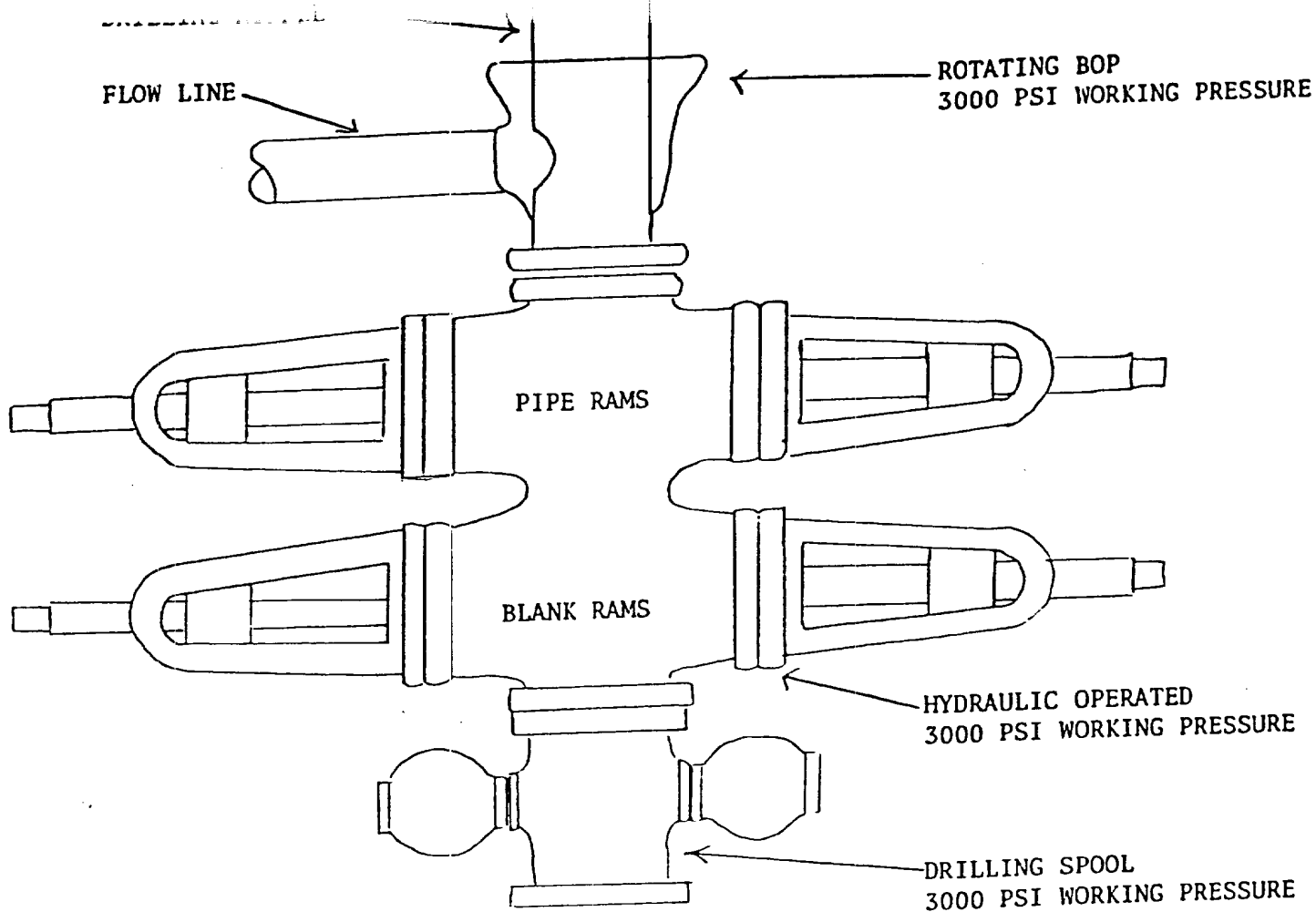

PREVENTERS AND SPOOLS ARE TO HAVE
THROUGH BORE OF 6" - 3000 PSI OR LARGER

Southland Royalty Company
Aztec #7E
1540' FSL & 930' FWL
Section 14, T28N, R11W
San Juan County, New Mexico



Southland Royalty Company

April 11, 1980

United States Geological Survey
Mr. James Sims
P. O. Box 959
Farmington, NM 87401

Dear Sir:

Enclosed please find a map showing existing roads and planned access roads to Southland Royalty Company's Aztec #7E well.

The locations of tank batteries and flow lines will be on location with well. A burn pit will be provided for disposal of trash. Cuttings, drilling fluid and produced fluids will be put into the reserve pit and properly disposed of depending on amount and type of fluids.

There will be no camps or airstrips.

Also, enclosed is a location layout showing approximate location of rig, pits and pipe racks.

Water supply will be The San Juan River.

The location will be restored according to Bureau of Land Management standards. This work will begin when all related construction is finished.

Mr. Ross Lankford will be Southland Royalty Company's field representative supervising these operations.

Yours truly,

Curtis C. Parsons
Curtis C. Parsons
District Engineer

OCP/ke



Southland Royalty Company

April 11, 1980

United States Geological Survey
Mr. James Sims
P. O. Box 595
Farmington, NM 87401

Dear Sir:

I hereby certify that I, or persons under my direct supervision, have inspected the proposed drillsite and access route; that I am familiar with the conditions which presently exist; that the statements made in this plan are, to the best of my knowledge, true and correct; and, that the work associated with the operations proposed herein will be performed by Southland Royalty Company and its contractors and subcontractors in conformity with this plan and the terms and conditions under which it is approved.

Date:

L. O. Van Ryan
District Production Manager

LOVR/ke

Location Profile for
 SOUTHLAND ROYALTY COMPANY #7-E AZTEC
 15401 FSL 9301 TWT, Sec. 14-T28N-R11W San Juan County, New Mexico

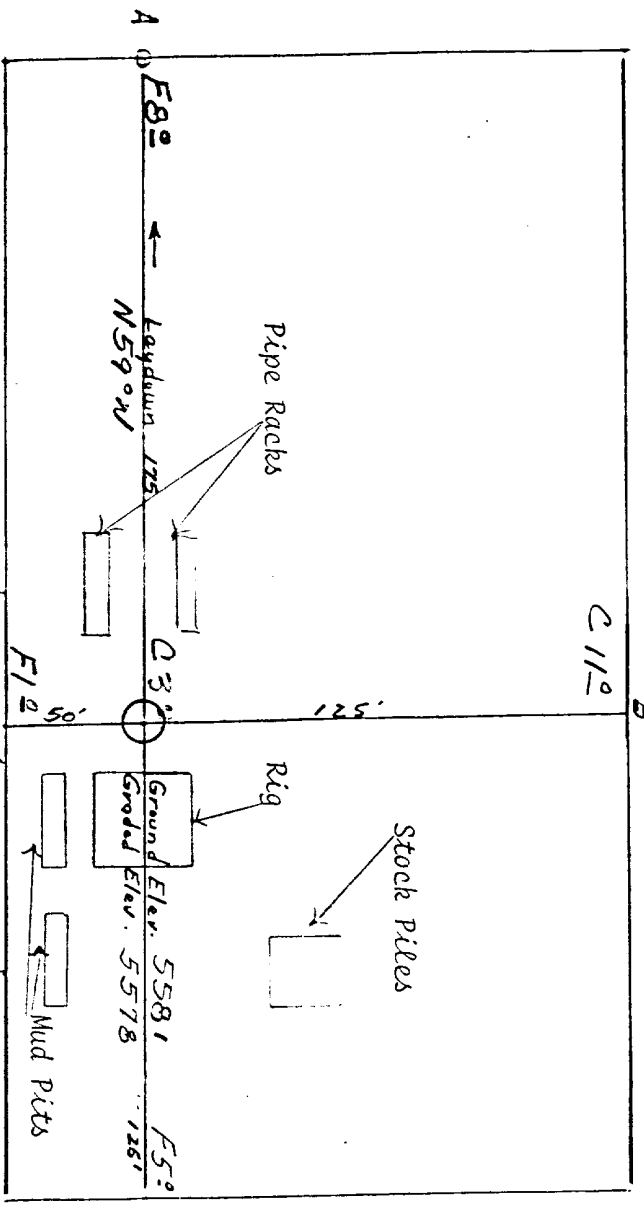
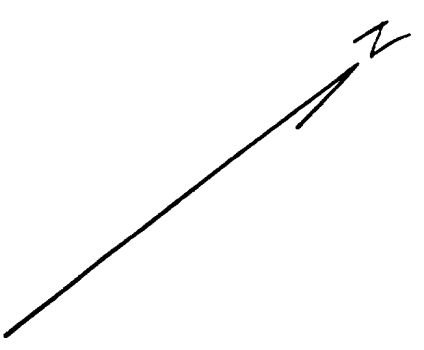

Scale: 1" = 50'

Vert. 1" = 40' A-A' Horiz. 1" = 100'

5590				
5580				
5570				

B-B' Horiz. 1" = 100'

5590				
5580				
5570				

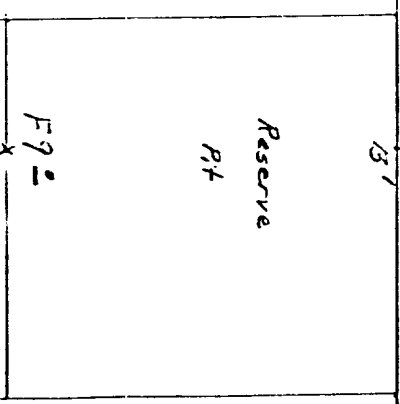

Vert. 1" = 40' C-C' Horiz. 1" = 100'

D-D' Horiz. 1" = 100'

KERR LAND SURVEYING
 Date: 2/27/2021
 [Signature]

4337 I SE
FLORA VISTA
1:25 000

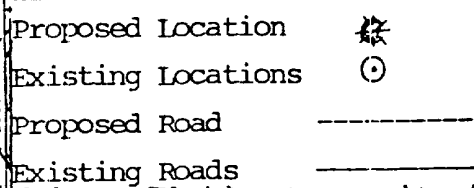

Vicinity Map for
SOUTHLAND ROYALTY COMPANY #7-E AZTEC
1540' FSL 930' FWL Sec 14-T28N-R11W
SAN JUAN COUNTY, NEW MEXICO