

UNITED STATES  
DEPARTMENT OF THE INTERIOR  
GEOLOGICAL SURVEY

APPLICATION FOR PERMIT TO DRILL, DEEPEN, OR PLUG BACK

1a. TYPE OF WORK

DRILL ☒

DEEPEN ☐

PLUG BACK ☐

b. TYPE OF WELL

OIL WELL ☒

GAS WELL ☐

OTHER ☐

2. NAME OF OPERATOR

Union Texas Petroleum Corporation

3. ADDRESS OF OPERATOR

P.O. Box 808, Farmington, New Mexico 87401

4. LOCATION OF WELL (Report location clearly and in accordance with any State requirements.)\*

At surface

1650 ft./South line and 720 ft./East line

At proposed prod. zone

Same as above

14. DISTANCE IN MILES AND DIRECTION FROM NEAREST TOWN OR POST OFFICE\*

8 miles Southeast of Bloomfield, New Mexico, 87413

15. DISTANCE FROM PROPOSED\*

LOCATION TO NEAREST PROPERTY OR LEASE LINE, FT. 720 ft.  
(Also to nearest drlg. unit line, if any) 720 ft.

18. DISTANCE FROM PROPOSED LOCATION\*

TO NEAREST WELL, DRILLING, COMPLETED, OR APPLIED FOR, ON THIS LEASE, FT. 450 ft.

16. NO. OF ACRES IN LEASE

2,284.30

19. PROPOSED DEPTH

6,036 ft.

17. NO. OF ACRES ASSIGNED TO THIS WELL

Lot 1 25.01

20. ROTARY OR CABLE TOOLS

Rotary

21. ELEVATIONS (Show whether DF, RT, GR, etc.)

5737 GR.

22. APPROX. DATE WORK WILL START\*

September 30, 1982

23.

PROPOSED CASING AND CEMENTING PROGRAM

SIZE OF HOLE	SIZE OF CASING	WEIGHT PER FOOT	SETTING DEPTH	QUANTITY OF CEMENT
13-3/4"	10-3/4" K55	40.50	300 (+)	245 cu. ft. (Circulated)
9-7/8"	7-5/8" K55	26.40	4715	1440 cu. ft. (Cover the Ojo Alamo)
6-3/4"	5-1/2" J55	15.50	4515' to 6036'	142 cu. ft. (Top of the liner)

We desire to drill 13-3/4" surface hole to approx. 300 ft. Run new 10-3/4" surface pipe to T.D. using natural mud as a circulating medium. Cement with approx. 245 cu. ft. of Class "B" cement circulated to the surface. W.O.C. Pressure test the pipe to 800 PSIG for 10 minutes. Drill 9-7/8" hole to approx. 4715 ft. using a starch base, permaloid, non-dispersed mud as the circulating medium. Log the well. Run new 7-5/8" pipe to T.D. with a D.V. tool at approx. 2000 ft. Cement the first stage with approx. 620 cu. ft. of 65/35/6 cement followed by approx. 90 cu. ft. of Class "B" cement. Second stage with approximately 640 cu. ft. of 65/35/12 followed by approx. 90 cu. ft. of Class "B" cement. W.O.C. Drill out the D.V. tool. Pressure test the casing to 1500 PSIG for 10 minutes. Drill 6-3/4" hole to approx. 6036 ft. using natural gas as a circulating medium. Log the well. Run new 5-1/2" casing to T.D. with a liner hanger at approx. 4515 ft. Cement with approx. 142 cu. ft. of 50/50 poz. W.O.C. Test the casing. Perf. and frac. the Gallup zone. Clean the well up. Run new 2-3/8", 4.7#, E.U.E. J55 tbg. to the Gallup zone. Nipple down the well head. Run a pump and rods. Set a pumping unit and tanks. Connect to a gathering system. Test the well.

The gas from this well has been dedicated to a transporter.

IN ABOVE SPACE DESCRIBE PROPOSED PROGRAM: If proposal is to deepen or plug back, give data on present productive zone and proposed new productive zone. If proposal is to drill or deepen directionally, give pertinent data on subsurface locations and measured and true vertical depths. Give blowout preventer program, if any.

24.

SIGNED

RUDY D. MOTTO

TITLE Field Operations Manager

DATE September 10, 1982

(This space for Federal or State office use)

PERMIT NO.

APPROVAL DATE

APPROVED BY

TITLE

CONDITIONS OF APPROVAL, IF ANY:

APPROVED  
AS AMENDED

OCT 12 1982

JAMES F. SIMS  
DISTRICT ENGINEER

NM000

All distances must be from the outer boundaries of the Section.

Operator <b>UNION TEXAS PETROLEUM CORP.</b>		Lease <b>ZACHRY</b>		Well No. <b>40</b>
Unit Letter <b>I</b>	Section <b>10</b>	Township <b>28 NORTH</b>	Range <b>10 WEST</b>	County <b>SAN JUAN</b>
Actual Wellbore Location of Well:				
1650 feet from the <b>SOUTH</b> line and		720 feet from the <b>EAST</b> line		
Ground Level Elev. <b>5737</b>	Producing Formation <b>GALLUP</b>	Pool <b>Armenta Extension</b>		Dedicated Acres Lot 1 <b>25.01</b> Acres

1. Outline the acreage dedicated to the subject well by colored pencil or hatchure marks on the plat below.
2. If more than one lease is dedicated to the well, outline each and identify the ownership thereof (both as to working interest and royalty).
3. If more than one lease of different ownership is dedicated to the well, have the interests of all owners been consolidated by communitization, unitization, force-pooling, etc?

☐ Yes ☒ No If answer is "yes," type of consolidation \_\_\_\_\_

If answer is "no," list the owners and tract descriptions which have actually been consolidated. (Use reverse side of this form if necessary.) \_\_\_\_\_

No allowable will be assigned to the well until all interests have been consolidated (by communitization, unitization, forced-pooling, or otherwise) or until a non-standard unit, eliminating such interests, has been approved by the Division.

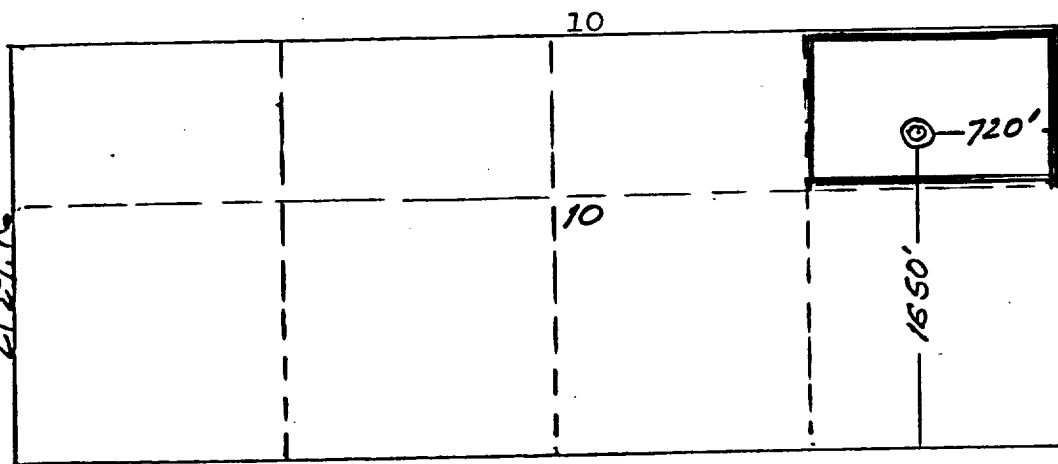
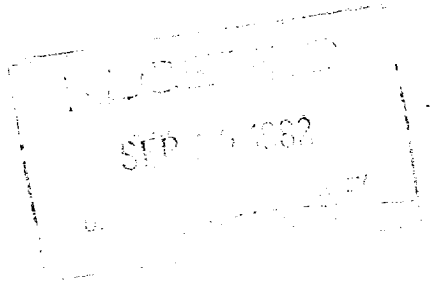
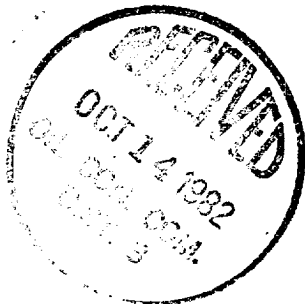

CERTIFICATION

I hereby certify that the information contained herein is true and complete to the best of my knowledge and belief.

*Rudy D. Motto*  
Name

**RUDY D. MOTTO**  
Position

**Field Operations Manager**  
Company

**Union Texas Petroleum**  
Date

**September 9, 1982**

I hereby certify that the location shown on this plat was plotted in the field notes of actual surveys made by me or under my supervision, and that the same is true and correct to the best of my knowledge and belief.

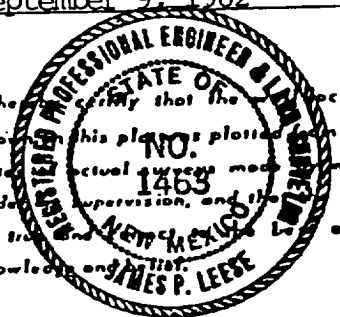

Date Surveyed  
**August 2, 1982**

Registered Professional Engineer  
and/or Land Surveyor

*James P. Lease*  
**James P. Lease**

Certificate No.  
**1463**

UNION TEXAS PETROLEUM CORP.  
Zachry #40  
NE $\frac{1}{4}$ SE $\frac{1}{4}$ , Sec. 10, T28N, R10W, NMPM  
San Juan County, New Mexico

