

UNITED STATES
DEPARTMENT OF THE INTERIOR
GEOLOGICAL SURVEY

APPLICATION FOR PERMIT TO DRILL, DEEPEN, OR PLUG BACK

1a. TYPE OF WORK

DRILL ☒DEEPEN ☐PLUG BACK ☐

b. TYPE OF WELL

OIL
WELL ☒GAS
WELL ☐

OTHER

SINGLE
ZONE ☒MULTIPLE
ZONE ☐

2. NAME OF OPERATOR

Union Texas Petroleum Corporation

3. ADDRESS OF OPERATOR

P.O. Box 808, Farmington, New Mexico 87401

4. LOCATION OF WELL (Report location clearly and in accordance with any State requirements.)

At surface

1695 ft./South line and 1750 ft./West line

At proposed prod. zone

Same as above

14. DISTANCE IN MILES AND DIRECTION FROM NEAREST TOWN OR POST OFFICE*

Six miles Southeast of Bloomfield, New Mexico

15. DISTANCE FROM PROPOSED*

LOCATION TO NEAREST

PROPERTY OR LEASE LINE, FT.

(Also to nearest drg. unit line, if any) 890 ft.

18. DISTANCE FROM PROPOSED LOCATION*

TO NEAREST WELL, DRILLING, COMPLETED,

OR APPLIED FOR, ON THIS LEASE, FT.

763 ft.

21. ELEVATIONS (Show whether DF, RT, GR, etc.)

5459 Gr.

23.

PROPOSED CASING AND CEMENTING PROGRAM

SIZE OF HOLE	SIZE OF CASING	WEIGHT PER FOOT	SETTING DEPTH	QUANTITY OF CEMENT
13-3/4"	10-3/4" New	40.55 K55	300 ft.	240 cu. ft. (circulated)
9-7/8"	7-5/8" New	26.40 K55	4630 ft.	1440 cu. ft. (Cover the Ojo Alamo)
6-3/4"	5-1/2" New	15.50 J55	4430' to 5610'	142 cu. ft. (Top of the liner)

We desire to drill 13-3/4" surface hole to T.D. of approx. 300 ft. using natural mud as the circulating medium. Run new 10-3/4" surface pipe to T.D. Cement with approx 240 cu. ft. of Class "B" cement circulated to surface. W.O.C. Pressure test the casing to 800 PSIG for 10 minutes. Drill 9-7/8" hole to approx. 4630 ft. using a starch base, permaloid, non-dispersed mud as the circulating medium. Log the well. Run new 7-5/8" casing to T.D. with a D.V. tool at approx. 2000 ft. Cement the first stage with approx. 620 cu. ft. of 65/35/6 followed by approx. 90 cu. ft. of Class "B" cement. 2nd stage cement with approx 640 cu. ft. of 65/35/12 followed by approx. 90 cu. ft. of Class "B" cement. Drill out D.V. tool. Pressure test the csg. to 1500 PSIG for 10 minutes. Drill 6-3/4" hole to approx. 5610 ft. using natural gas as a circulating medium. Log the well. Run new 5-1/2" csg. to T.D. with a liner hanger at approx. 4430 ft. Cement with approx. 142 cu. ft. of 50-50 poz to cover the liner. Perf and frac the Gallup zone. Clean the well up. Run new 2-3/8", 4.7#, F.U.E. J55 tbg. to the Gallup zone. Nipple down the well head. Run a pump and rods. Set pumping unit and tanks. Connect to a gathering system. Test the well. The gas from this well has previously been dedicated to a transporter.

IN ABOVE SPACE DESCRIBE PROPOSED PROGRAM: If proposal is to deepen or plug back, give data on present productive zone and proposed new productive zone. If proposal is to drill or deepen directionally, give pertinent data on subsurface locations and measured and true vertical depths. Give blowout preventer program, if any.

24.

SIGNED

RUDY D. MOTTO

Field Operations Manager

DATE 9-28-82

(This space for Federal or State office use)

PERMIT NO.

APPROVAL DATE

APPROVED BY

CONDITIONS OF APPROVAL, IF ANY:

APPROVED
AS AMENDED

DATE

OCT 26 1982

JAMES F. SIMS
DISTRICT ENGINEER

All distances must be from the outer boundaries of the Section.

Operator UNION TEXAS PETROLEUM CORP.			Lease ZACHRY		Well No. 39
Unit Letter K	Section 11	Township 28 NORTH	Range 10 WEST	County SAN JUAN	
Actual Postage Location of Well: 1695 feet from the SOUTH line and 1750 feet from the WEST line					
Ground Level Elev. 5459	Producing Formation GALLUP	Pool WILDCAT Armenta Ext.		Dedicated Acreage: LOT 3 25.45 Acres	

1. Outline the acreage dedicated to the subject well by colored pencil or hatchure marks on the plat below.
2. If more than one lease is dedicated to the well, outline each and identify the ownership thereof (both as to working interest and royalty).
3. If more than one lease of different ownership is dedicated to the well, have the interests of all owners been consolidated by communitization, unitization, force-pooling, etc?

☐ Yes ☒ No If answer is "yes," type of consolidation _____

If answer is "no," list the owners and tract descriptions which have actually been consolidated. (Use reverse side of this form if necessary.) _____

No allowable will be assigned to the well until all interests have been consolidated (by communitization, unitization, forced-pooling, or otherwise) or until a non-standard unit, eliminating such interests, has been approved by the Division.

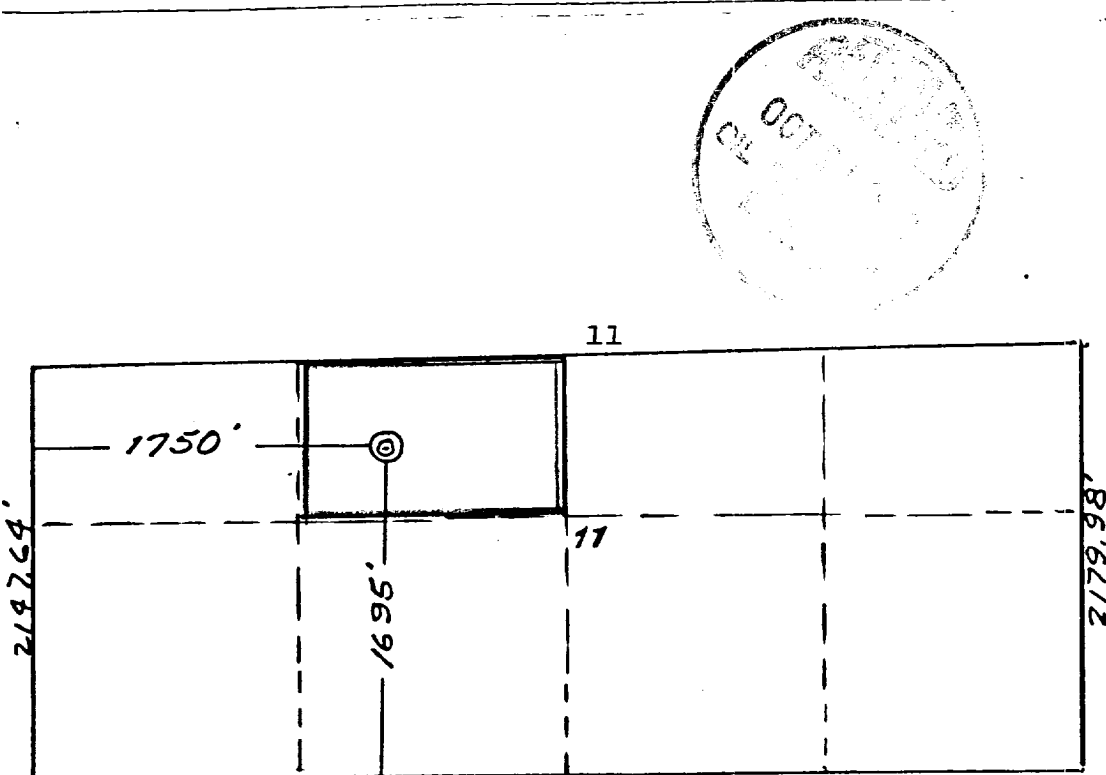

CERTIFICATION

I hereby certify that the information contained herein is true and complete to the best of my knowledge and belief.

Name
Rudy D. Motto
Position
Field Operations Manager
Company
Union Texas Petroleum

Date
August 13, 1982

I hereby certify that the information shown on this plat was plotted from field notes of equal survey, made by me or under my supervision, and that the same is true and correct to the best of my knowledge and belief.

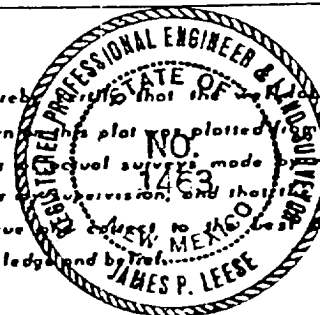

Date Surveyed
July 29, 1982

Registered Professional Engineer and Surveyor

James P. Leese

Certificate No.
1463

UNION TEXAS PETROLEUM CORP
Zachry #39
NE $\frac{1}{4}$ SW $\frac{1}{4}$, Sec. 11, T28N, R10W, NMPM
San Juan County, New Mexico

