

UNITED STATES
DEPARTMENT OF THE INTERIOR
GEOLOGICAL SURVEY

Form 1000-10 (Rev. 1-78)
Budget Category: D-10-01-0000

30-045-25491

APPLICATION FOR PERMIT TO DRILL, DEEPEN, OR PLUG BACK

1a. TYPE OF WORK

DRILL ☒

DEEPEN ☐

b. TYPE OF WELL

OIL
WELL ☒

GAR
WELL ☐

OTHER ☐

SINGLE
ZONE ☒

2. NAME OF OPERATOR

Union Texas Petroleum Corporation

3. ADDRESS OF OPERATOR

P. O. Box 808, Farmington, New Mexico 87499

4. LOCATION OF WELL (Report location clearly and in accordance with any State or Federal requirements)

At surface 1670 ft./South line & 710 ft./East line

At proposed prod. zone same as above

OCT 13 1982

14. DISTANCE IN MILES AND DIRECTION FROM NEAREST TOWN OR POST OFFICE*

3 miles Southeast of Bloomfield, New Mexico

U. S. GEOLOGICAL SURVEY
FARMINGTON, N. M.

15. DISTANCE FROM PROPOSED*

710 feet

16. NO. OF ACRES IN LEASE

1894.08

17. NO. OF ACRES ASSIGNED TO THIS WELL

Lot 1 23.19

18. DISTANCE FROM PROPOSED LOCATION*

2170 feet

19. PROPOSED DEPTH

6024 feet

20. ROTARY OR CABLE TOOLS

Rotary

21. ELEVATIONS (Show whether DF, RT, GK, etc.)

5757 GR

22. APPROX. DATE WORK WILL START*

October 25, 1982

23.

PROPOSED CASING AND CEMENTING PROGRAM

SIZE OF HOLE	SIZE OF CASING	WEIGHT PER FOOT	SETTING DEPTH	QUANTITY OF CEMENT
13-3/4"	NEW 10-3/4"	40.55, K55	300 ft.	245 cu. ft. (circulated)
9-7/8"	NEW 7-5/8"	26.40, K55	4755 ft.	1440 cu. ft. (to the top of the Ojo)
6-3/4"	NEW 5-1/2"	15.50, J55	4555' to 6024'	142 cu. ft. (to the top of liner)

We desire to drill surface hole to approx. 300 ft. Run 10-3/4" pipe and cement with Class "B" cement circulated to the surface. Pressure test the casing to 800 PSIG for 15 minutes. Drill out with 9-7/8" bit to intermediate T.D. of approx. 4755 ft. using a starch base, permaloid non-dispersed mud as the circulating medium. Log the well. Run pipe to T.D. Cement 1st stage with approx. 620 cu. ft. of 65/35/6 poz mix followed by approx. 90 cu. ft. of Class "B" cement. 2nd stage with approx. 640 cu. ft. of 65/35/12 followed by approx. 90 cu. ft. of Class "B" cement. W.O.C. Drill out D.V. tool. Pressure test the casing to 1500# for 10 minutes. Drill out with 6-3/4" bit, using natural gas as a circulation medium to approx. 6044 ft. Log well. Run new 5-1/2", J-55, 15.50# ST&C casing to T.D. and cement with approx. 142 cu. ft. of 50-50 poz mix to cover the liner hanger. Top of hanger at approx. 5044 ft. W.O.C. Perforate and frac the Gallup zone. Clean the well up. Run rods, pump and set the pumping unit. Set stock tanks. Connect to a gathering system. Test the well. (Well to have new 2-3/8", 4.7#, E.U.E., J55 tubing set in the Gallup zone.) The gas from this well has previously been dedicated to a transporter.

IN ABOVE SPACE DESCRIBE PROPOSED PROGRAM: If proposal is to deepen or plug back, give data on present productive zone and proposed new productive zone. If proposal is to drill or deepen directionally, give pertinent data on subsurface locations and measured and true vertical depths. Give blowout preventer program, if any.

24.

SIGNED Rudy D. Motto TITLE Field Operations Manager DATE October 8, 1982

(This space for Federal or State office use)

PERMIT NO.

APPROVAL DATE

APPROVED BY

TITLE

CONDITIONS OF APPROVAL, IF ANY:

APPROVED
AS AMENDED
DATE

OCT 26 1982

JAMES F. SIMS
DISTRICT ENGINEER

NN000

WATER WELL RECORDING

All distances must be from the center of the well

Section		Twp.		Range		County	
12		28 NORTH		11 WEST		SAN JUAN	
Nearest Postage Location of Well:				Well No.			
1670		SOUTH		710		EAST	
Ground Level Elev.		Producing Formation		Pool		Dedicated Acreage	
5757		GALLUP		TILSON		23.19 Acres	

1. Outline the acreage dedicated to the subject well by colored pencil or hatchure marks on the plat below.

2. If more than one lease is dedicated to the well, outline each and identify the ownership thereof (both as to working interest and royalty).

3. If more than one lease of different ownership is dedicated to the well, have the interests of all owners been consolidated by communitization, unitization, force-pooling, etc?

☐ Yes ☒ No If answer is "yes," type of consolidation _____

If answer is "no," list the owners and tract descriptions which have actually been consolidated. (Use reverse side of this form if necessary.) _____

No allowable will be assigned to the well until all interests have been consolidated (by communitization, unitization, forced-pooling, or otherwise) or until a non-standard unit, eliminating such interests, has been approved by the Division.

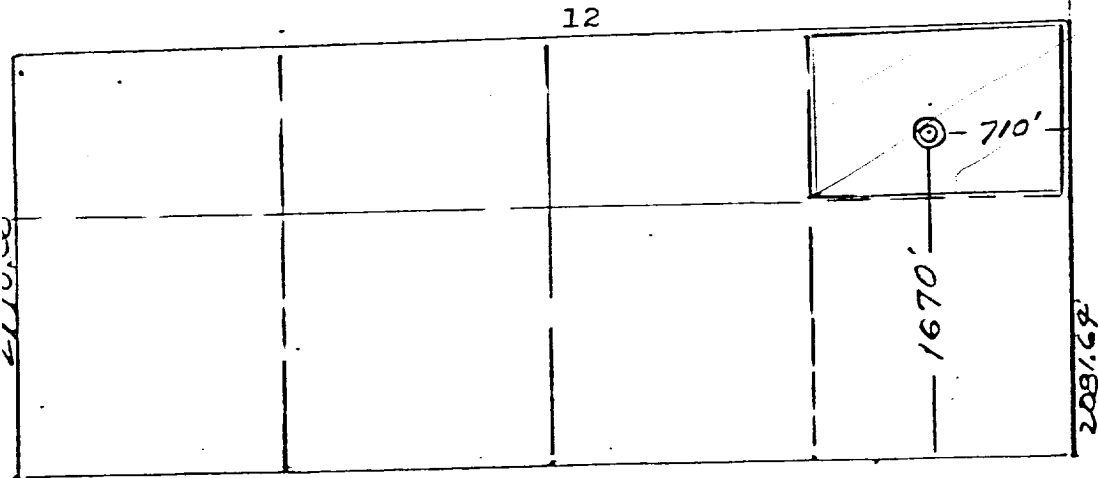
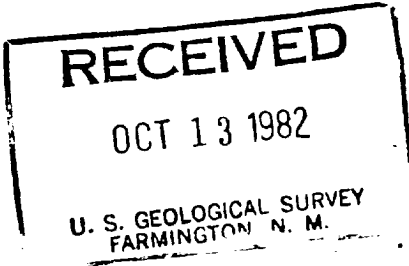

CERTIFICATION

I hereby certify that the information contained herein is true and complete to the best of my knowledge and belief.

Name Paul D. Hutto

Position Field Operations Manager

Company Union Texas Petroleum

Date August 17, 1982

I hereby certify that the well location shown on this plat was plotted from field notes or other survey made by me or under my supervision, and that the same is true and correct to the best of my knowledge and belief.

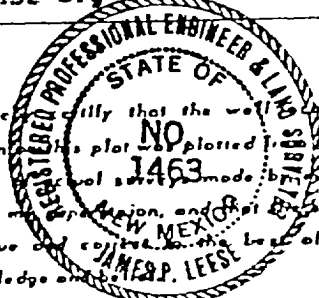

Date Surveyed JULY 27, 1982

Registered Professional Engineer and Land Surveyor

James P. Lease
James P. Lease

Certificate No. 1463