

UNITED STATES
DEPARTMENT OF THE INTERIOR
BUREAU OF LAND MANAGEMENT

APPLICATION FOR PERMIT TO DRILL, DEEPEN, OR PLUG BACK

1a. TYPE OF WORK
DRILL ☒ DEEPEN ☐ PLUG BACK ☐
b. TYPE OF WELL
OIL WELL ☐ GAS WELL ☒ OTHER ☐
2. NAME OF OPERATOR
Meridian Oil Inc.
3. ADDRESS OF OPERATOR
PO Box 4289, Farmington, NM 87499
4. LOCATION OF WELL (Report location clearly and in accordance with any State requirements.)
At 1705'S, 1550'W
At proposed prod. zone

5. LEASE DESIGNATION AND SERIAL NO.
NM-04209
6. IF INDIAN, ALLOTTEE OR TRIBE NAME
7. UNIT AGREEMENT NAME
8. FARM OR LEASE NAME
Hancock
9. WELL NO.
707
10. FIELD AND POOL, OR WILDCAT
Basin Fruitland Coal
11. SEC., T., R., M., OR BLK.
AND SURVEY OR AREA
Sec. 23, T-28-N, R- 9-W
NMPM K
12. COUNTY OR PARISH
San Juan
13. STATE
NM

14. DISTANCE IN MILES AND DIRECTION FROM NEAREST TOWN OR POST OFFICE*
15 miles from Blanco, NM
15. DISTANCE FROM PROPOSED*
LOCATION TO NEAREST
PROPERTY OR LEASE LINE, FT.
(Also to nearest drilg. unit line, if any)
1550'
16. NO. OF ACRES IN LEASE
960.15
17. NO. OF ACRES ASSIGNED
TO THIS WELL
320.0
18. DISTANCE FROM PROPOSED LOCATION*
TO NEAREST WELL, DRILLING, COMPLETED,
OR APPLIED FOR, ON THIS LEASE, FT.
2000'
19. PROPOSED DEPTH
3275'
20. ROTARY OR CABLE TOOLS
Rotary
21. ELEVATIONS (Show whether DF, RT, GR, etc.)
7006' GL
22. APPROX. DATE WORK WILL START*
23. PROPOSED CASING AND CEMENTING PROGRAM
SUBJECT TO COMPLETION OF WITH ATTACHED
"GENERAL INFORMATION"

| SIZE OF HOLE | SIZE OF CASING | WEIGHT PER FOOT | SETTING DEPTH | QUANTITY OF CEMENT |
|--------------|----------------|-----------------|---------------|----------------------|
| 12 1/4" | 9 5/8" | 32.3# | 200' | 125 cf. circulated |
| 8 3/4" | 7" | 20.0# | 3140' | 268 cf circ. surface |
| 6 1/4" | 5 1/2" liner | 15.5# | 3275' | do not cement |

The Fruitland coal formation will be completed.

A 3000 psi WP and 6000 psi test double gate preventer equipped with blind and pipe rams will be used for blow out prevention on this well.

This gas is dedicated.

The W/2 of Section 23 is dedicated to this well.

RECEIVED

JAN 3 0 1989

OIL CON. DIV.
DIST. 3

IN ABOVE SPACE DESCRIBE PROPOSED PROGRAM: If proposal is to deepen or plug back, give data on present productive zone and proposed new productive zone. If proposal is to drill or deepen directionally, give pertinent data on subsurface locations and measured and true vertical depths. Give blowout preventer program, if any.

24. SIGNED [Signature] TITLE Regulatory Affairs DATE 01-17-89

(This space for Federal or State office use)

PERMIT NO. _____ APPROVAL DATE _____
APPROVED BY _____ TITLE _____
CONDITIONS OF APPROVAL, IF ANY:

APPROVED
AS AMENDED

JAN 24 1989

[Signature]
AREA MANAGER

*See Instructions On Reverse Side

Title 18 U.S.C. Section 1001, makes it a crime for any person knowingly and willfully to make to any department or agency of the United States any false, fictitious or fraudulent statements or representations as to any matter within its jurisdiction.

All distances must be from the outer boundaries of the Section.

| | | | | |
|--|--|------------------------------------|---|---------------------------|
| Operator Meridian Oil Inc. | | Lease Hancock (NM-04209) | | Well No. 707 |
| Unit Letter A | Section 23 | Township 28 North | Range 9 West | County San Juan |
| Actual Footage Location of Well: 1705 feet from the South line and 1550 feet from the West line | | | | |
| Ground Level Elev. 7006 | Producing Formation Fruitland Coal | Pool Basin | Dedicated Acreage: 320.00 Acres | |

1. Outline the acreage dedicated to the subject well by colored pencil or hachure marks on the plat below.
2. If more than one lease is dedicated to the well, outline each and identify the ownership thereof (both as to working interest and royalty).
3. If more than one lease of different ownership is dedicated to the well, have the interests of all owners been consolidated by communitization, unitization, force-pooling, etc?

☐ Yes ☐ No If answer is "yes," type of consolidation _____

If answer is "no," list the owners and tract descriptions which have actually been consolidated. (Use reverse side of this form if necessary.) _____

No allowable will be assigned to the well until all interests have been consolidated (by communitization, unitization, forced-pooling, or otherwise) or until a non-standard unit, eliminating such interests, has been approved by the Division.

CERTIFICATION

I hereby certify that the information contained herein is true and complete to the best of my knowledge and belief.

Neale C. Edwards
Name

Regulatory Affairs

Position

Meridian Oil Inc.

Company

1-19-89

Date

RECEIVED

JAN 30 1989

OIL CON. DIV
DIST 2

I hereby certify that the well location shown on this plat was plotted from field notes of actual surveys made by me under my supervision, and that the same is true and correct to the best of my knowledge and belief.

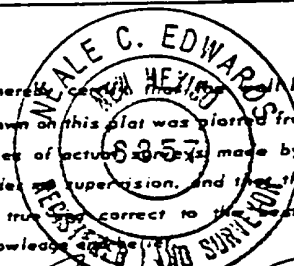

Date Surveyed

12-3-88

Registered Professional Engineer
and/or Land Surveyor

Neale C. Edwards

Certificate No.

6857

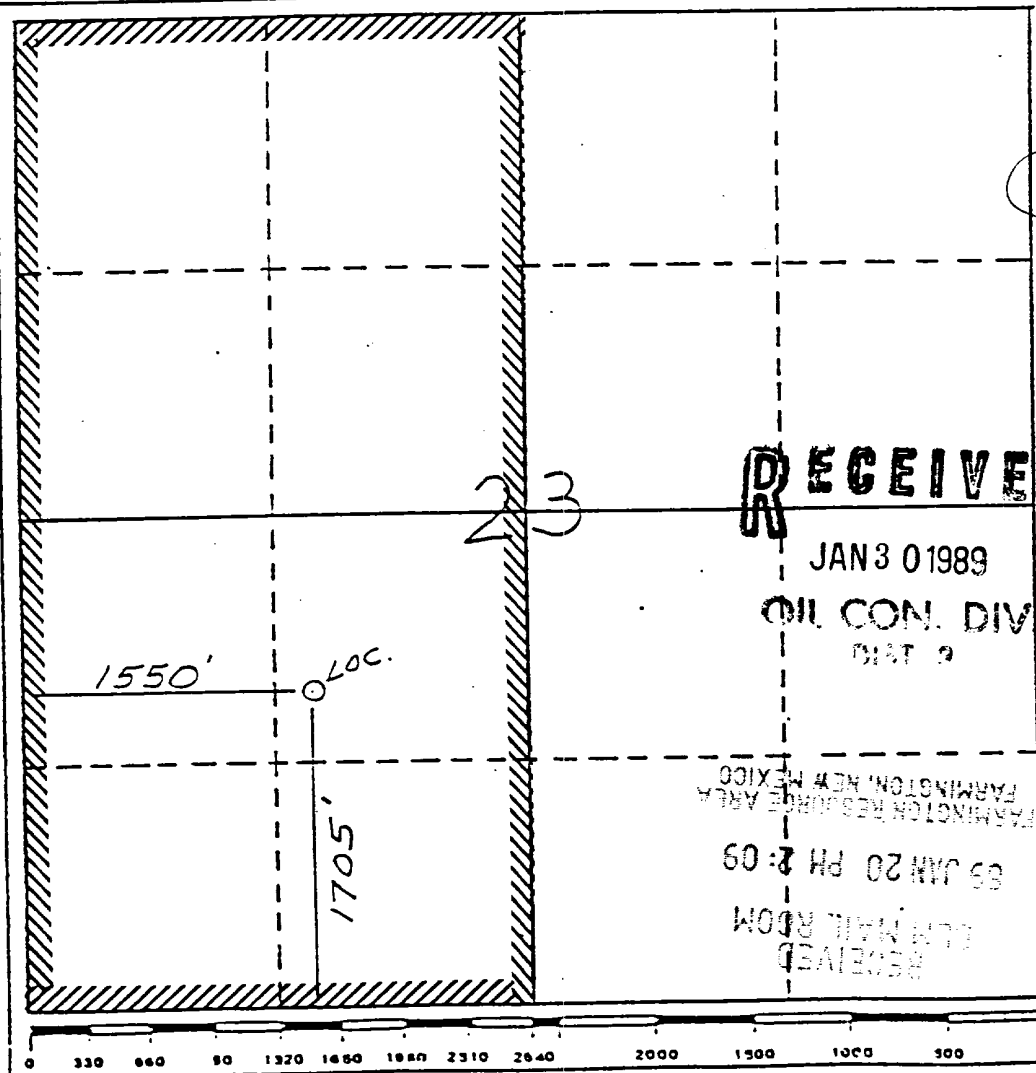

NM04209

HANCOCK
707

UNITED STATES
DEPARTMENT OF THE INTERIOR
BUREAU OF LAND MANAGEMENT
BIOLOGICAL SURVEY

BLM ROW

50000 FEET

255000

State
Lands

BLM ROW

128N, R9W

Section 22: S2SE 2800'
S2SW 2100'

27: NWNW 1300'

28: E2NE 1900'
E2SE 1800'
SWSE 800'

33: W2NE 2100'
SE NW 600'
NE SW 350'
NWSE 1700'
SESE 1500'

34: SWNW 700'

127W, R9W

Section 1: NENE 1400'

3: N2NW 2200'
SE NW 500'
SW NE 1500'
SE NE 300'
NESE 1100'

Indian Lands

MAP 2