

UNITED STATES  
DEPARTMENT OF THE INTERIOR  
BUREAU OF LAND MANAGEMENT

3-045-28303

APPLICATION FOR PERMIT TO DRILL, DEEPEN, OR PLUG BACK

1a. TYPE OF WORK

DRILL ☒

DEEPEN ☐

PLUG BACK ☐

b. TYPE OF WELL

OIL  
WELL ☐

GAS  
WELL ☒

OTHER

SINGLE  
ZONE ☒

MULTIPLE  
ZONE ☐

2. NAME OF OPERATOR

D.J. Simmons Co.

3. ADDRESS OF OPERATOR

P.O. Box 1469, Farmington, NM 87499

4. LOCATION OF WELL (Report location clearly and in accordance with any State requirements.)  
At surface

1450' FSL, 790' FWL

At proposed prod. zone

5. LEASE DESIGNATION AND SERIAL NO.

SF047039 - C

6. IF INDIAN, ALLOTTEE OR TRIBE NAME

7. UNIT AGREEMENT NAME

8. FARM OR LEASE NAME

Cap Com 7

9. WELL NO.

#1

10. FIELD AND POOL, OR WILDCAT

Basin Fruitland

11. SEC., T., R., M., OR BLK.  
AND SURVEY OR AREA

Sec. 7, T28N, R10W

12. COUNTY OR PARISH

San Juan

13. STATE

N.M.

14. DISTANCE IN MILES AND DIRECTION FROM NEAREST TOWN OR POST OFFICE\*

Three miles southeast of Bloomfield, N.M.

15. DISTANCE FROM PROPOSED\*

LOCATION TO NEAREST  
PROPERTY OR LEASE LINE, FT.  
(Also to nearest drig. unit line, if any)

790'

16. NO. OF ACRES IN LEASE

497.86

17. NO. OF ACRES ASSIGNED  
TO THIS WELL

257.85

18. DISTANCE FROM PROPOSED LOCATION\*  
TO NEAREST WELL, DRILLING, COMPLETED,  
OR APPLIED FOR, ON THIS LEASE, FT.

345'

19. PROPOSED DEPTH

1934'

20. ROTARY OR CABLE TOOLS

Rotary

21. ELEVATIONS (Show whether DF, RT, GR, etc.)

This section is subject to technical and  
5746' procedural review pursuant to 43 CFR 3165.3  
and appeal pursuant to 43 CFR 3165.4.

22. APPROX. DATE WORK WILL START\*

ASAP

23. PROPOSED CASING AND CEMENTING PROGRAM

DRILLING OPERATIONS AUTHORIZED ARE  
SUBJECT TO COMPLIANCE WITH ATTACHED  
"GENERAL REQUIREMENTS"

SIZE OF HOLE	SIZE OF CASING	WEIGHT PER FOOT	SETTING DEPTH	
12 1/4"	8 5/8"	24.0#	200'	140 sks. (circ.)
	4 1/2"	10.5#	1934'	482 sks. (circ.)

THE FRUITLAND FORMATION WILL BE COMPLETED

A 3000 PSI WP AND 6000 PSI TEST DOUBLE GATE PREVENTER EQUIPPED WITH  
BLIND AND PIPE RAMS WILL BE USED FOR BLOWOUT PREVENTION ON THIS WELL.

THIS GAS IS DEDICATED

THE W/2 OF SECTION 23 IS DEDICATED TO THIS WELL.

RECEIVED  
OCT 1 1990  
OIL CON. DIV.  
DIST. 3

IN ABOVE SPACE DESCRIBE PROPOSED PROGRAM: If proposal is to deepen or plug back, give data on present productive zone and proposed new productive zone. If proposal is to drill or deepen directionally, give pertinent data on subsurface locations and measured and true vertical depths. Give blowout preventer program, if any.

SIGNED [Signature] TITLE Petroleum Engineer DATE 6-18-90

(This space for Federal or State office use)

PERMIT NO. \_\_\_\_\_ APPROVAL DATE \_\_\_\_\_

APPROVED BY \_\_\_\_\_ TITLE \_\_\_\_\_ DATE [Signature]  
CONDITIONS OF APPROVAL, IF ANY:

Weld 2-104 N5C + Off [Signature]

\*See Instructions On Reverse Side

# OIL CONSERVATION DIVISION

P.O. Box 2088

Santa Fe, New Mexico 87504-2088

## DISTRICT I

P.O. Box 1980, Hobbs, NM 88240

## DISTRICT II

P.O. Drawer DD, Artesia, NM 88210

## DISTRICT III

1000 Rio Brazos Rd., Aztec, NM 87410

## WELL LOCATION AND ACREAGE DEDICATION PLAT

All Distances must be from the outer boundaries of the section

Operator D. J. Simmons			Lease Cap Com.		Well No. 7 #1
Unit Letter L	Section 7	Township 28 North	Range 10 West	NMPM	County San Juan
Actual Footage Location of Well: 1450 feet from the South line and 790 feet from the West line					
Ground level Elev. 5746	Producing Formation Fruitland	Pool Basin Fruitland		Dedicated Acreage: 256.61 Acres	

1. Outline the acreage dedicated to the subject well by colored pencil or hatchure marks on the plat below.
2. If more than one lease is dedicated to the well, outline each and identify the ownership thereof (both as to working interest and royalty).
3. If more than one lease of different ownership is dedicated to the well, have the interest of all owners been consolidated by communitization, unitization, force-pooling, etc.?  
☐ Yes ☒ No If answer is "yes" type of consolidation \_\_\_\_\_  
If answer is "no" list the owners and tract descriptions which have actually been consolidated. (Use reverse side of this form if necessary.) \_\_\_\_\_  
No allowable will be assigned to the well until all interests have been consolidated (by communitization, unitization, forced-pooling, or otherwise) or until a non-standard unit, eliminating such interest, has been approved by the Division.

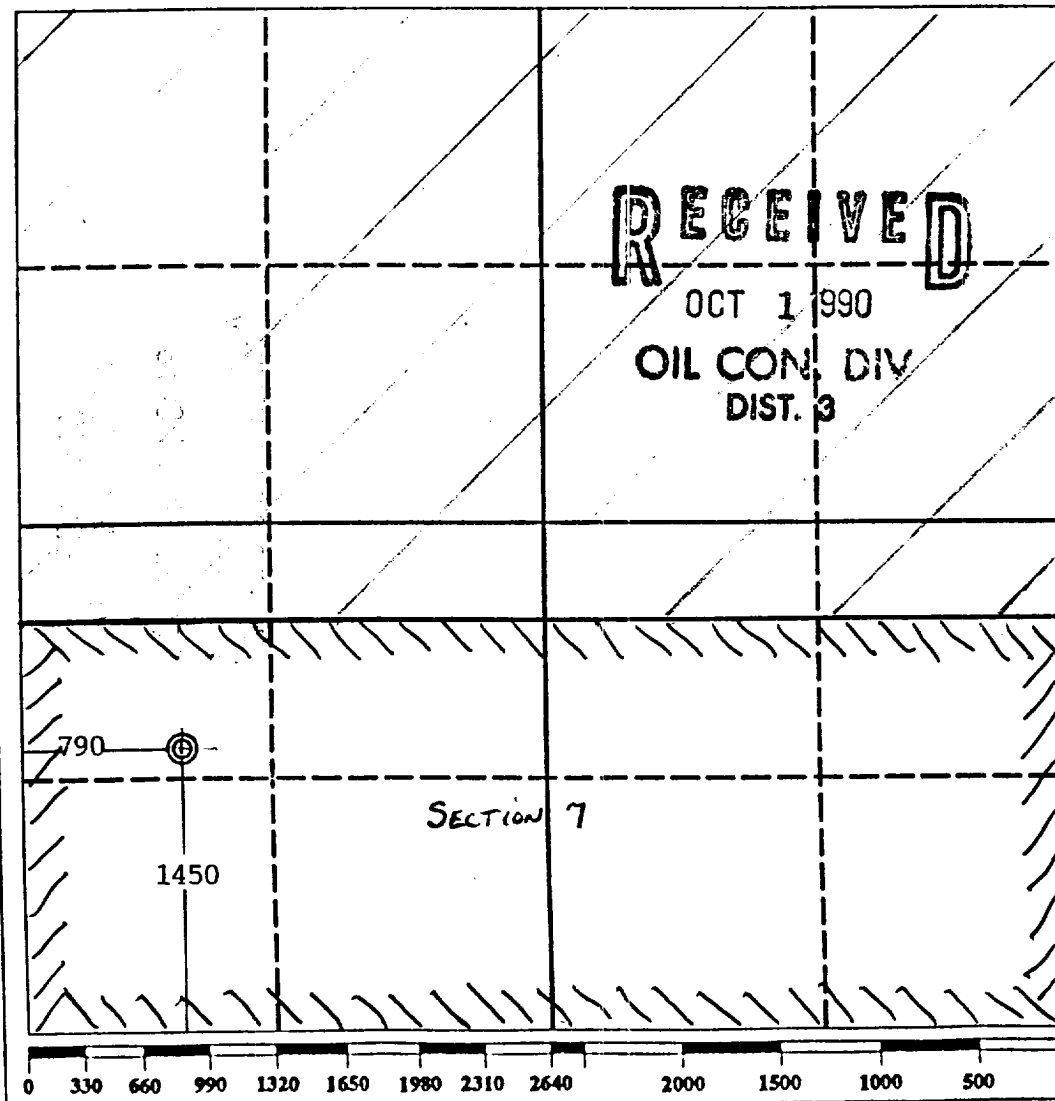

### OPERATOR CERTIFICATION

I hereby certify that the information contained herein is true and complete to the best of my knowledge and belief.

Signature  
Rod Pinkett  
Printed Name  
Petroleum Engineer  
Position  
D. J. Simmons Co.  
Company  
June 13, 1990  
Date

### SURVEYOR CERTIFICATION

I hereby certify that the well location shown on this plat was plotted from field notes or actual surveys made by me or under my supervision, and that the same is true and correct to the best of my knowledge and belief.

June 8, 1990  
Date Surveyed

Signature  
Professional Surveyor  
4624  
Certification No. 4624  
State of New Mexico

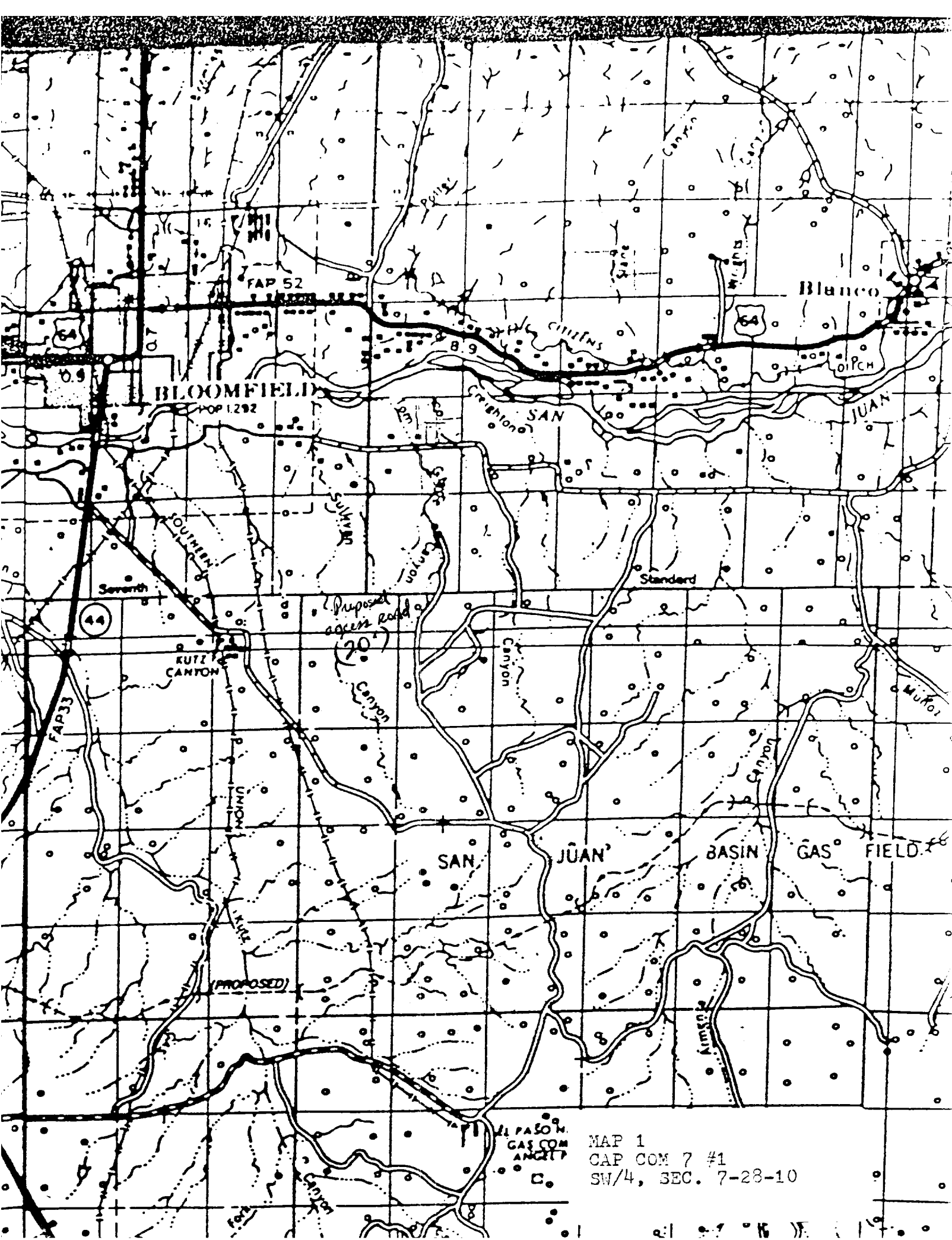

MAP 1  
CAP COM 7 #1  
SW/4, SEC. 7-28-10