

UNITED STATES  
DEPARTMENT OF THE INTERIOR  
BUREAU OF LAND MANAGEMENT

30-045-28816

APPLICATION FOR PERMIT TO DRILL OR DEEPEN

1a. TYPE OF WORK

DRILL ☒

DEEPEN ☐

b. TYPE OF WELL

OIL  
WELL ☐

GAS  
WELL ☒

OTHER

SINGLE  
ZONE ☒

MULTIPLE  
ZONE ☐

2. NAME OF OPERATOR

SG Interests I, Ltd. Attn: A. M. O'Hare

3. ADDRESS AND TELEPHONE NO.

P. O. Box 421 Blanco, N.M. 87412-0421 (505) 325-5599

4. LOCATION OF WELL (Report location clearly and in accordance with any State requirements.)\*

At surface

1505'FNL 2570'FEL

At proposed prod. zone

Same

14. DISTANCE IN MILES AND DIRECTION FROM NEAREST TOWN OR POST OFFICE\*

7 Miles South of Blanco, N.M.

OIL CON. DIV.

15. DISTANCE FROM PROPOSED\*

LOCATION TO NEAREST  
PROPERTY OR LEASE LINE, FT.  
(Also to nearest drlg. unit line, if any)

70'

16. NO. OF ACRES IN LEASE

783.22

18. DISTANCE FROM PROPOSED LOCATION\*  
TO NEAREST WELL, DRILLING, COMPLETED,  
OR APPLIED FOR, ON THIS LEASE, FT.

300'

19. PROPOSED DEPTH

2703'

21. ELEVATIONS (Show whether DF, RT, GR, etc.)

6360'GR

This action is subject to technical and  
procedural review pursuant to 43 CFR 3165.3  
and appeal pursuant to 43 CFR 3165.4.

17. NO. OF ACRES ASSIGNED  
TO THIS WELL

N/320

20. ROTARY OR CABLE TOOLS

Rotary

22. APPROX. DATE WORK WILL START\*

As Soon As Permitted

23.

PROPOSED CASING AND CEMENTING PROGRAM

DRILLING OPERATIONS AUTHORIZED ARE  
SUBJECT TO COMPLIANCE WITH ATTACHED

SIZE OF HOLE	GRADE SIZE OF CASING	WEIGHT PER FOOT	SETTING DEPTH	GENERAL REQUIREMENTS
12-1/4"	8-5/8"	24# J-55	250'	236 ft. Class B w/2% CaCl
7-7/8"	5-1/2"	15.5# J-55	2703'	561 ft. 65/35 Pozmix w/6% Gel
				118 ft. Class B Neat Tail

SG Interests I, Ltd. proposes to drill a vertical well to develop the Fruitland Coal formation at the above described site in accordance with the attached drilling and surface use programs.

This APD is also serving as application to obtain BLM road Right-of-Way. The right-of-way will be an existing road extending from Largo Canyon Road. The requested right-of-way is approximately 5.5 miles long and 30 feet wide. The right-of-way crosses NW/SE, NE/SW and S2/SW Sec. 35, T29N, R9W, NE/SW and S2/SW of Sec. 11, NW/NW of Sec. 14, NE/NE, SE/NE, SW/NE, NW/SE, SE/NW, NW/SW of Sec. 15, NE/SE & W2/SE of Sec. 16, The E2/W2 and the SW/SE of Sec. 21, and the W2/NE of Sec. 28, T28N, R9W all of San Juan County, New Mexico.

IN ABOVE SPACE DESCRIBE PROPOSED PROGRAM: If proposal is to deepen, give data on present productive zone and proposed new productive zone. If proposal is to drill or deepen directionally, give pertinent data on subsurface locations and measured and true vertical depths. Give blowout preventer program, if any.

24.

SIGNED A. M. O'Hare

TITLE Agent SG Interests I, Ltd. DATE 11/2/92

(This space for Federal or State office use)

PERMIT NO.

APPROVAL DATE

Application approval does not warrant or certify that the applicant holds legal or equitable title to those rights in the subject lease which would entitle the applicant to conduct operations thereon.  
CONDITIONS OF APPROVAL, IF ANY:

APPROVED BY

TITLE

\*See Instructions On Reverse Side

NMOC

APPROVED  
AS AMENDED

NOV 11 1992

AREA MANAGER

# OIL CONSERVATION DIVISION

DISTRICT I  
P.O. Box 1980, Hobbs, NM 88240

P.O. Box 2088  
Santa Fe, New Mexico 87504-2088

DISTRICT II  
P.O. Drawer DD, Artesia, NM 88210

DISTRICT III  
1000 Rio Brazos Rd., Aztec, NM 87410

## WELL LOCATION AND ACREAGE DEDICATION PLAT

All Distances must be from the outer boundaries of the section

Operator S G INTERESTS I, LTD.		Lease FEDERAL 28-9-28		Well No. 1	
Unit Letter G	Section 28	Township 28 N	Range 9 W	County San Juan	
Actual Footage Location of Well: 1505 feet from the North line and 2570 feet from the East line					
Ground level Elev. 6360	Producing Formation Fruitland Coal		Pool Basin Fruitland Coal	Dedicated Acreage: 320.0 Acres	
<p>1. Outline the acreage dedicated to the subject well by colored pencil or hatchure marks on the plat below.</p> <p>2. If more than one lease is dedicated to the well, outline each and identify the ownership thereof (both as to working interest and royalty).</p> <p>3. If more than one lease of different ownership is dedicated to the well, have the interest of all owners been consolidated by communitization, unitization, force-pooling, etc.?  <input type="checkbox"/> Yes      <input type="checkbox"/> No      If answer is "yes" type of consolidation _____</p> <p>If answer is "no" list the owners and tract descriptions which have actually been consolidated. (Use reverse side of this form if necessary). _____</p> <p>No allowable will be assigned to the well until all interests have been consolidated (by communitization, unitization, forced-pooling, or otherwise) or until a non-standard unit, eliminating such interest, has been approved by the Division.</p>					

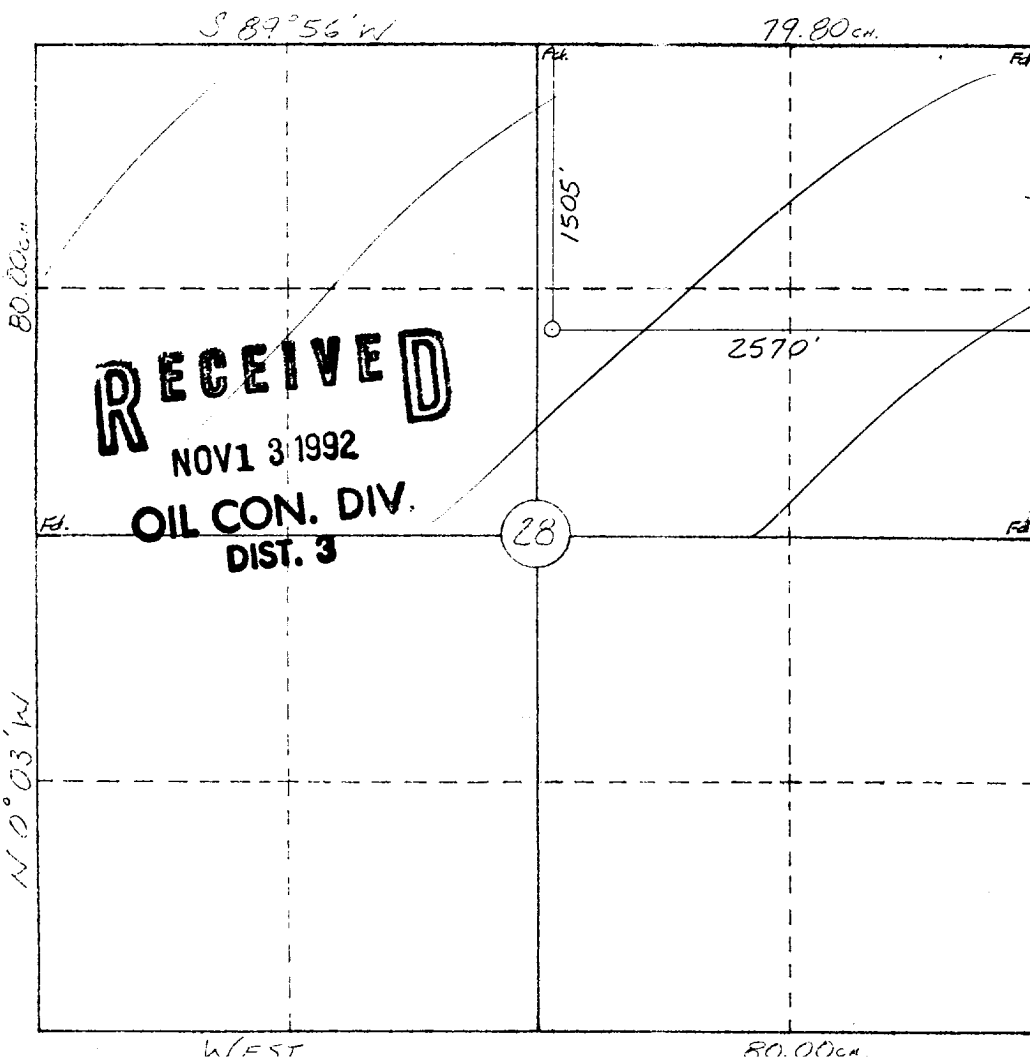
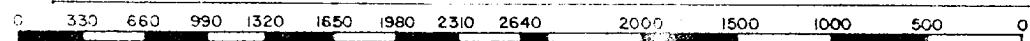

### OPERATOR CERTIFICATION

I hereby certify that the information contained herein is true and complete to the best of my knowledge and belief.

Signature \_\_\_\_\_

Printed Name \_\_\_\_\_

A. M. O'Hare

Position

President/Agent

Company Maralex Resources Inc  
Agent SG Interests I, Ltd.

Date \_\_\_\_\_

11/2/92

### SURVEYOR CERTIFICATION

I hereby certify that the well location shown on this plat was plotted from field notes of actual surveys made by me or under my supervision, and that the same is true and correct to the best of my knowledge and belief.

9-23-92

Date Surveyed

~~William E. Mahake II~~

Signature & Seal of  
Professional Surveyor

Certificate No. B466

SG Interests I, Ltd.  
FEDERAL 28-9-28 #1  
1505' FNL & 2570' FEL  
Sec. 28, T28N, R9W  
San Juan Co., N.M.  
BLM Road Right-of-Way  
Route

