

NEW MEXICO OIL CONSERVATION COMMISSION
Santa Fe, New Mexico

Form C-101
Revised (12/1/55)

NOTICE OF INTENTION TO DRILL

Notice must be given to the District Office of the Oil Conservation Commission and approval obtained before drilling or recompletion begins. If changes in the proposed plan are considered advisable, a copy of this notice showing such changes will be returned to the sender. Submit this notice in QUINTUPLICATE. One copy will be returned following approval. See additional instructions in Rules and Regulations of the Commission. If State Land submit 6 Copies Attach Form C- 128 in triplicate to first 3 copies of form C-101 on all wells

Farmington, New Mexico
(Place)

July 17, 1962
(Date)

OIL CONSERVATION COMMISSION
SANTA FE, NEW MEXICO

Gentlemen:

You are hereby notified that it is our intention to commence the Drilling of a well to be known as

BENSON-MONTIN-GREER DRILLING CORP.

(Company or Operator)

EL POZO RANCH

(Lease)

Well No. I-35, in

I

(Unit)

The well is

located 2045 feet from the south line and 355 feet from the east line of Section 35, T. 29N, R. 1E, NMPM.

(GIVE LOCATION FROM SECTION LINE)

Wildcat Pool,

Rio Arriba County

If State Land the Oil and Gas Lease is No. _____

If patented land the owner is

Dr. W. A. Maddox

Address

Amarillo, Texas

We propose to drill well with drilling equipment as follows:

Rotary Air Drill

The status of plugging bond is

In effect

Drilling Contractor

S & B Drilling Company

Farmington, New Mexico

We intend to complete this well in the

Gallup

formation at an approximate depth of

900

feet.

CASING PROGRAM

We propose to use the following strings of Casing and to cement them as indicated:

Size of Hole	Size of Casing	Weight per Foot	New or Second Hand	Depth	Sacks Cement
<u>6-3/4"</u>	<u>5-1/2"</u>	<u>14#</u>	<u>New</u>	<u>100'</u>	<u>40</u>
<u>4-3/4"</u>	<u>3"</u>	<u>6.3#</u>	<u>New</u>	<u>900'</u>	<u>50</u>

If changes in the above plans become advisable we will notify you immediately.

ADDITIONAL INFORMATION

Approved _____
Except as follows:

OIL CONSERVATION COMMISSION

By

Sincerely yours,

BENSON-MONTIN-GREER DRILLING CORP.

(Company or Operator)

By

Position

Vice-President

Send Communications regarding well to

Albert R. Greer

Name

Address

158 Petroleum Center Building

Farmington, New Mexico



STATE OF NEW MEXICO		
OIL CONSERVATION COMMISSION		
DISTRICT OFFICE		
NUMBER OF COPIES RECEIVED <i>6</i>		
SUBJECT		
FILE	<i>1</i>	<input checked="" type="checkbox"/>
DATE	<i>2</i>	
REPORT		
TRANSPORT	OIL	
	GAS	
PREPARED BY		
OPERATOR	<i>2</i>	

NEW MEXICO OIL CONSERVATION COMMISSION

Well Location and Acreage Dedication Plat

Date July 17, 1962

Section A.

Operator BENSON-MONTIN-GREER DRILLING CORP. Lease KL POBO RANCH
 Well No. I-35 Unit Letter I Section 35 Township 29 NORTH Range 1 EAST NMPM
 Located 2045 Feet From the SOUTH Line, 355 Feet From the EAST Line
 County RIO ARriba G. L. Elevation 7142.0 Dedicated Acreage 40 Acres
 Name of Producing Formation Gallup Pool Wildcat

1. Is the Operator the only owner in the dedicated acreage outlined on the plat below?
 Yes X No _____

2. If the answer to question one is "no", have the interests of all the owners been consolidated by communitization agreement or otherwise? Yes _____ No _____. If answer is "yes", Type of Consolidation.

3. If the answer to question two is "no", list all the owners and their respective interests below:

Owner

Land Description

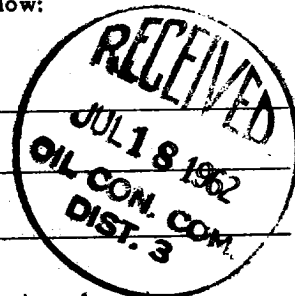

Section B.

Note: All distances must be from outer boundaries of section.

This is to certify that the information in Section A above is true and complete to the best of my knowledge and belief.

BENSON-MONTIN-GREER DRILLING
 (Operator) CORP.

(Operator)

(Representative)

158 Petroleum Center Bldg.
 (Address)
Farmington, New Mexico

(Address)

Ref. GLO Plat Dated 29 June 1887

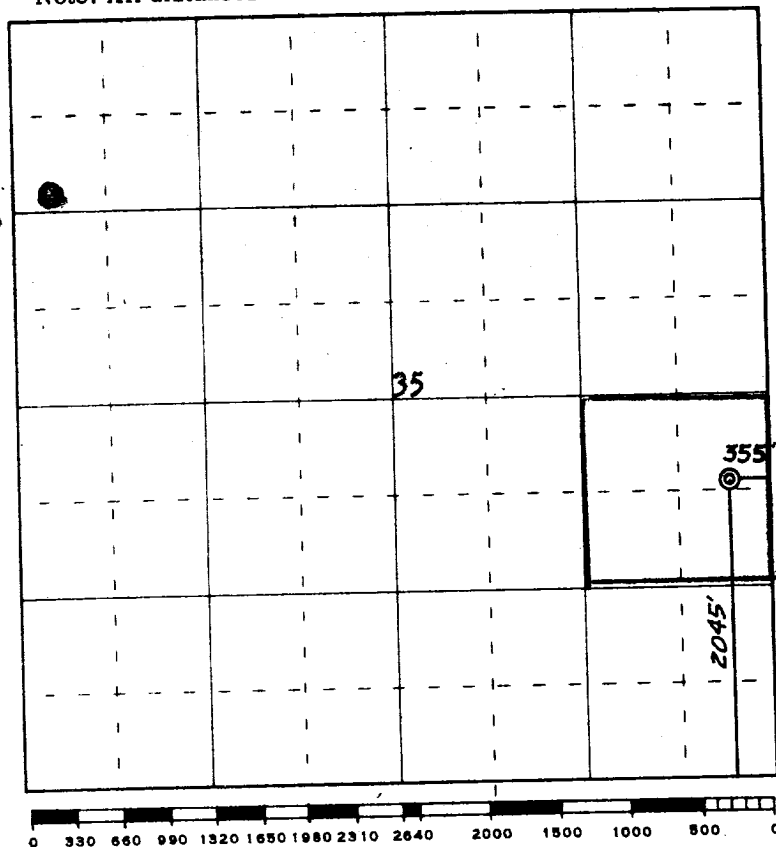

Scale 4 inches equal 1 mile

This is to certify that the above plat was prepared from field notes of actual surveys made by me or under my supervision and that the same are true and correct to the best of my knowledge and belief.

Date Surveyed 10 July 1962

James P. Lease
 Registered Professional Engineer and/or Land Surveyor

Farmington, New Mexico

